

CREDLE ENGINEERING COMPANY, INC.

ENGINEERING \ PLANNING \ LAND SURVEYING

"SERVING THE COMMUNITY SINCE 1920"

COMMUNITY MEETING REPORT

TIME WARNERCABLE

FOR

TIME WARNER –

ADVANCE/NEWHOUSE PARTNERS

1500 N Sharron Amity Road

Parcel ID: 16307101

OCTOBER 25, 2012

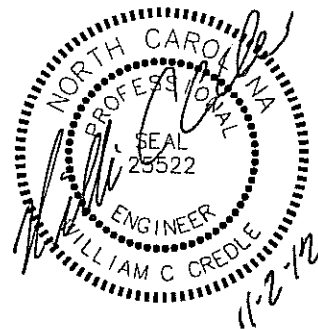

204 E MARKHAM AVENUE, DURHAM, NORTH CAROLINA 27701

TELEPHONE (919) 682-2006

FAX (919) 682-2005

COMMUNITY MEETING REPORT

INTRODUCTION

This is a report for the community meeting that was held on October 25, 2012. The meeting was to inform the residents in the vicinity of the Time Warner site located at 1500 N Sharon Amity Road of the proposed improvements.

MAILING LIST

The mailing list for the community meeting was provided by Penny Cothran of the City of Charlotte Planning department. The adjacent property owners and the neighborhood leaders were provided in Excel form. The spread sheets were converted to mailing labels. A copy of the list have been included.

MAILING INFORMATION

The information that was provided in the mailing packets was a copy of the proposed plans and a letter of invitation to the community meeting. A copy of the packet has been included.

MAILINGS

The information packets were mailed by parcel post on October 15, 2012, at the main post office Durham, N.C.

MEETING SITE

The site for the community meeting was the
Fairfield Inn & Suites (by Marriott)
8540 E. Independence Blvd
Charlotte, NC 28227
P) 980-245-9200
Sales Mgr: Marieta Bryan.

The room was theater style with an overhead projector. The meeting was held from 5:30 to 6:30

ATTENDEES

The attendees to community meeting were :

Cliff Credle	Credle Engineering Company, Inc
Dee Jones	Time Warner Cable
Lisa & Bernard Smit	1435 Havencrest Drive
Chris & Jody Para	1426 Havencrest Drive

QUESTIONS FROM ATTENDEES

The questions from the attendees were together and dealt with where on the site the construction was to take place. The next questions were in dealing with specifically when the construction was to start and how long was the construction to take place. The only other question pertaining to this project was if any traffic was going to come down Havencrest drive. The questions were both answered by myself and Dee Jones to the satisfaction of the attendees.

CONCLUSION

The community meeting was concluded at 6:30 pm

ATTACHEMENTS

- Reduced copy of plans
- Invitation letter
- Location of Fairfield Inn
- Mailing list
- Sign in sheet for meeting

REZONING

SWITCHING STATION BUILDING

1500 N SHARON AMITY ROAD, CHARLOTTE, NORTH CAROLINA 28211

FOR

TIME WARNER ENTERTAINMENT

(OWNER)

P.O. BOX 7467, CHARLOTTE, N.C. 28241

(919) 573-7119

■ VICINITY MAP

NO SCALE

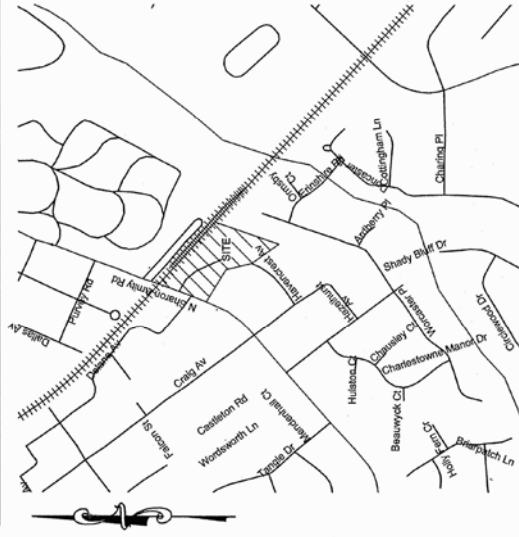

CREDLE ENGINEERING COMPANY, INC

ENGINEERS/PLANNERS/SURVEYORS
204 E. MARKHAM AVE, DURHAM, N.C. 27701 (919) 682-2006 PH (919) 682-2005 FX

■ INDEX

<u>SHEET #</u>	<u>DESCRIPTION</u>
C0.1	COVER
L-1	EXISTING ZONING SITE
L-2	EXISTING ZONING SITE DETAIL

■ PROJECT INFORMATION

PARCEL DATA
PARCEL ID: 16307101
PLAN: CHARLOTTE
PLAN JURIS: 1500 N. Sharon Amity Road
SITE ADDRESS: Time Warner Entertainment Advance Newhouse
OWNER: P.O. Box 7467, Charlotte, N.C.28241
AUD: (919) 573-7119
PHONE: des.jones@twcable.com
EMAIL:

ZONING: 0-15 (CD) Petition 79-15
Ex Zoning: 2,200 s.f.
Building data: 3,500 s.f.
Ex. Use: Electrical & Phone (No water and sewer)
Pro. Bldg: Switching Station Bldg replacement
Utilities: 12' Eaves
Use: Building height:

Proposed Zoning: 0-1(CD)

■ INDEX

<u>SHEET #</u>	<u>DESCRIPTION</u>
C0.1	COVER
L-1	EXISTING ZONING SITE
L-2	EXISTING ZONING SITE DETAIL

Petition Number: 2012-097



XJ 5002-FX

CREDLE ENGINEERING COMPANY, INC
PLANNERS/SURVEYORS
204 E. MARKHAM AVE. DURHAM, N.C. 27701 (919) 682-2006 P6

COVER ■

SWITCHING STATION ADDITION

TIME WARNER
1500 N. SHARON AMITY ROAD, CHARLOTTE, N.C. 28211

[illegible]

DATE	8/27/12
SCALE:	AS SHOWN
DRAWN	WEC
JOB	Charlotte\N Sharon Anelly\Bose 120731
SHEET NUMBER	

CO.1

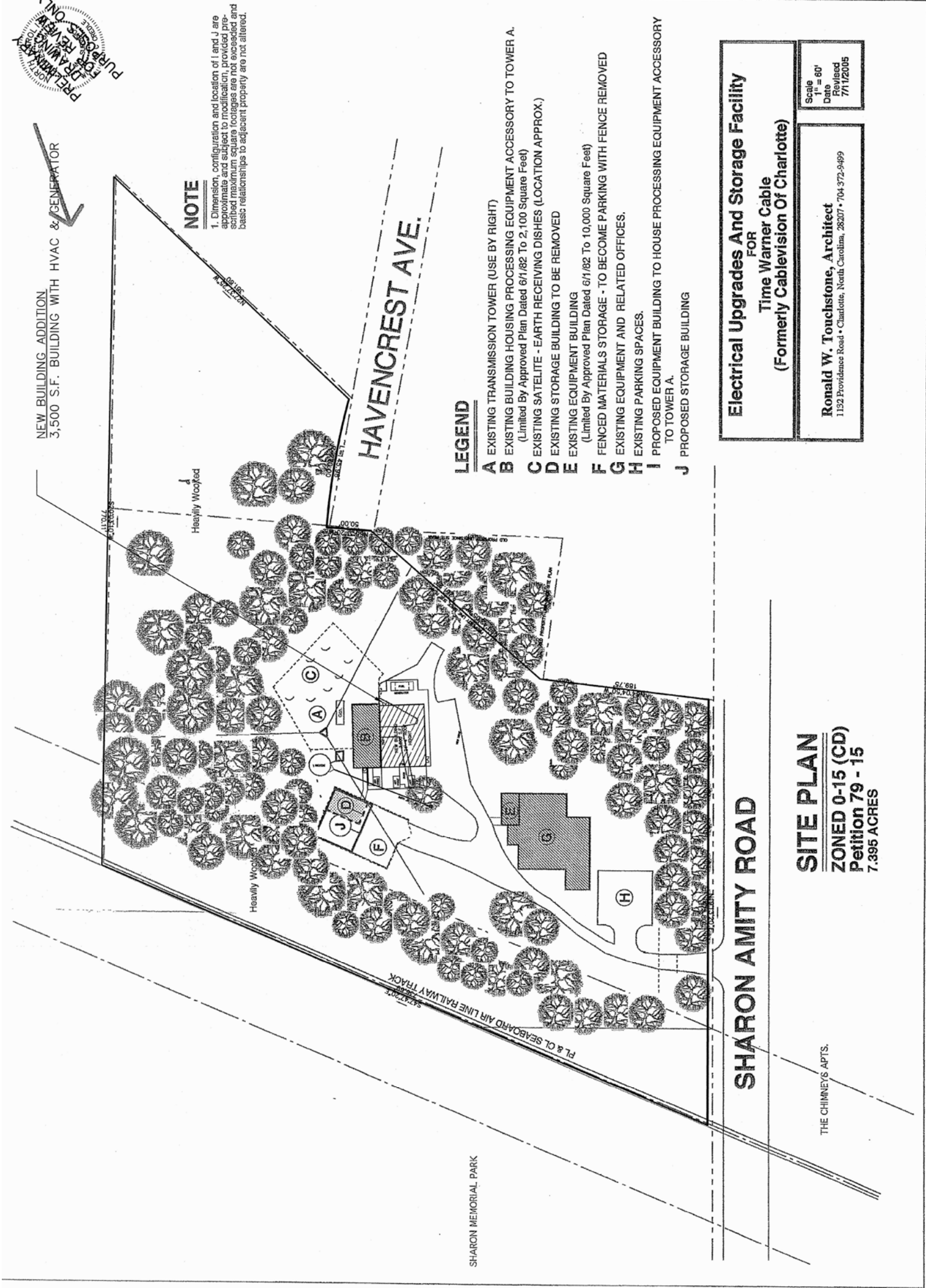

SITE ACREAGE: 7.02 ac
TAX PARCEL NUMBER(S): 16307101
EXISTING ZONING: 0-15 (CD)
PROPOSED ZONING: 0-1 (CD)
EXISTING USE: Utility Switching Station, Office
PROPOSED USE: Utility Switching Station, Office Expansion
EXPANSION sq. footage: 3,500 square feet

Note

B 2,100 Square Feet
E 700 Square Feet - Equipment
G 6,663 Square Feet - 2,076± Office, 4,587± Equipment
I 80 Square Feet - Equipment
J 2,557 Square Feet - Storage
E, G, I, J = 10,000 Square Feet

2 Zoning Plan

1 Location Plan

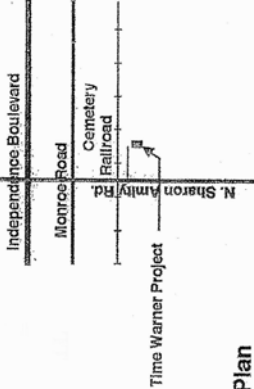

Location Plan, Zoning Plan

Time Warner Cable

1500 North Sharon Amity Road - Charlotte, North Carolina

Date: 7/11/05

Sheet: L-1

Job No: 05061

Ronald W. Touchstone, Architect
1132 Providence Road • Charlotte, North Carolina 28207 • 704-372-9499



10/25/12

NAME

ADDRESS

CLIFF CREED

204 E MARKHAM AVE

DORHAM NC

Lisa Ross Smit

1435 Havencrest Dr

Chit, NC

Bernard Smit

Chris + Jody Para

1426 Havencrest Ave.

Chit, NC

DEE JONES

4200 PARAMOUNT PKWY

MORRISVILLE, NC