

March 16, 2007 - 6:23pm By: brattipawr

P:\018253_IKEA\001 Charlotte VHW CAD\ rezoning plans\ rezoning SUBMITTAL 03-16-07\REZONING SHEETS (CSN) PKG\AE23.dwg

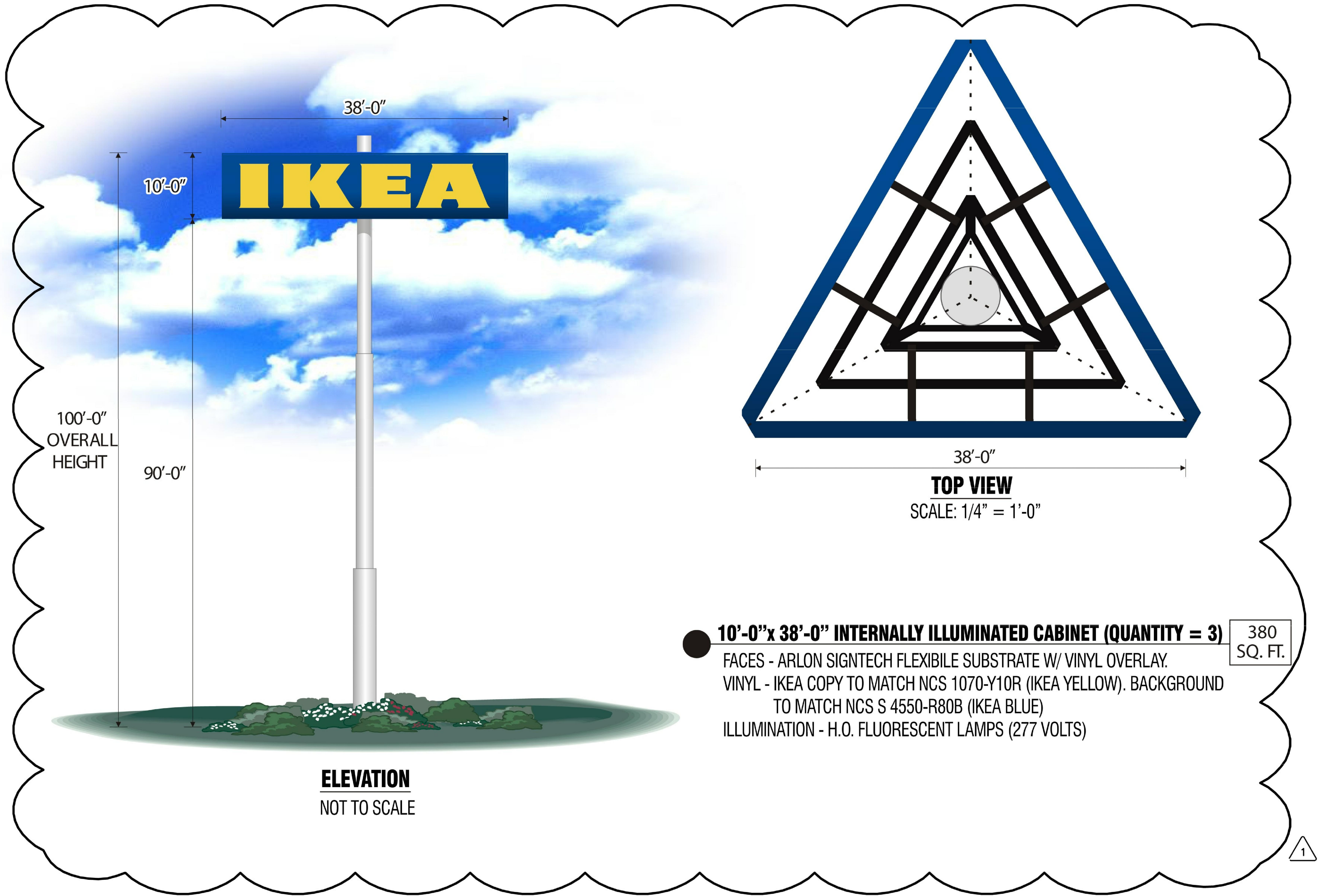

REVISIONS	
1	REVISED PER STAFF COMMENTS

CITY BLVD - NORTH REZONING

CHARLOTTE, NORTH CAROLINA
MECKLENBURG COUNTY, 28201
(NEC) I-85 AND CITY BLVD.

PETITIONERS:
IKEA PROPERTY, INC. AND
CRESCENT RESOURCES, LLC

**FOR PUBLIC
HEARING
PETITION NO.
2006-155**

DESIGNED BY: GF
DRAWN BY: GF
CHECKED BY: GF
DATE: 03-16-07

**IKEA
NAVIGATIONAL
TOWER
RZ-8**

P:\08593 IKEA 001 Charlotte WHV CAD\0 rezoning plans REZONING SUBMITTAL 03-16-07 REZONING SHEETS SIGN PACKAGE.dwg P:\08593 IKEA 001 Charlotte WHV CAD\0 rezoning plans REZONING SUBMITTAL 03-16-07 REZONING SHEETS SIGN PACKAGE.dwg March 28, 2007 - Boleyn By Brett Perry

● = power needed for lighting

● = no lighting

NOTE:
Location of signs
is subject to change.

1

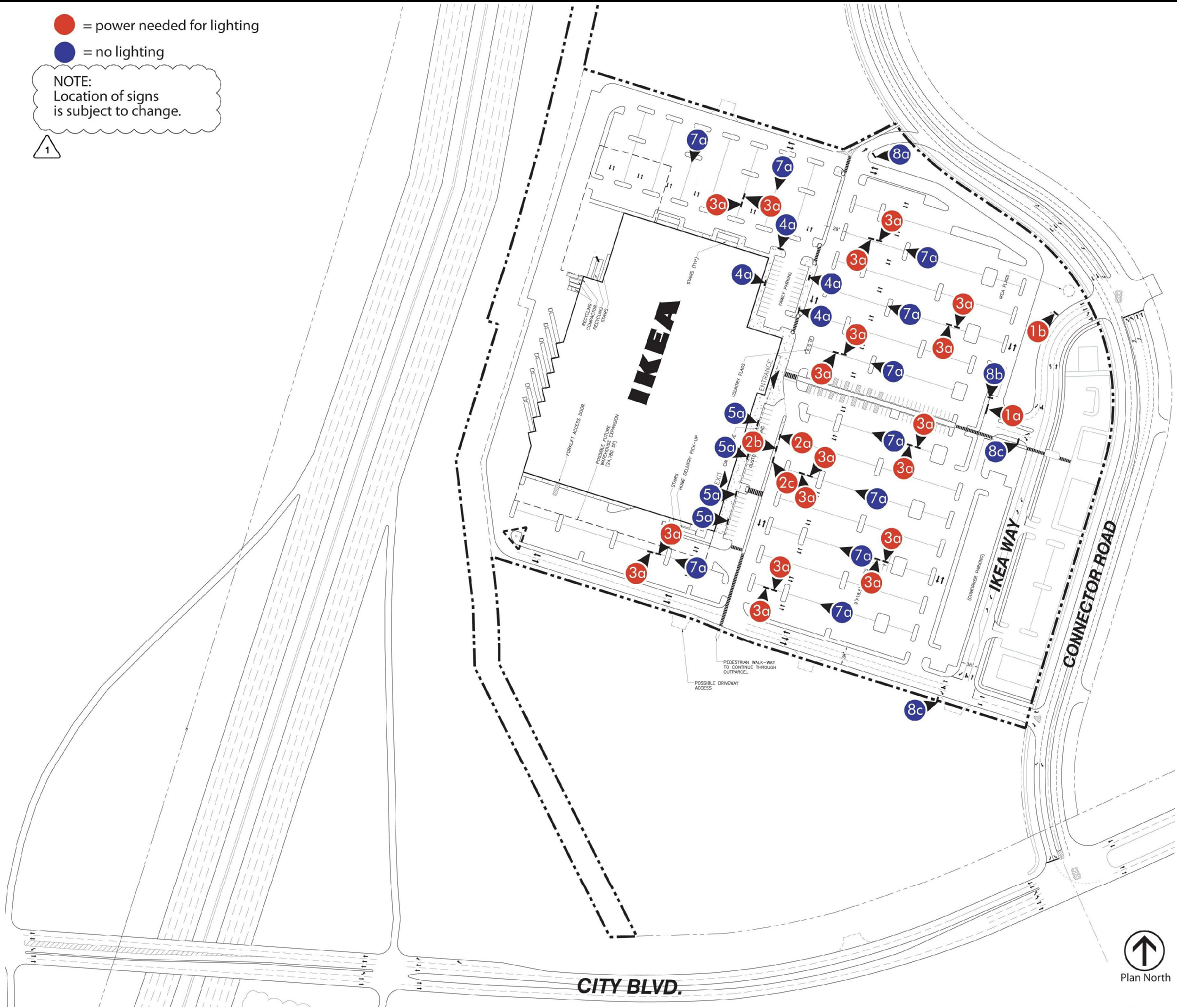

GreenbergFarrow

1755 The Exchange
Atlanta, GA 30339
t: 770 303 1033 f: 770 303 2333

REVISIONS

03/16/07

1 REVISED PER STAFF COMMENTS

CITY BLVD - NORTH REZONING

CHARLOTTE, NORTH CAROLINA
MECKLENBURG COUNTY, 28201
(NEC) I-85 AND CITY BLVD.

PETITIONERS:
IKEA PROPERTY, INC. AND
CRESCENT RESOURCES, LLC

FOR PUBLIC
HEARING
PETITION NO.
2006-155

DESIGNED BY: GF
DRAWN BY: GF
CHECKED BY: GF
DATE: 03-16-07

IKEA
SIGNAGE DETAILS
COMM 100
RZ-9

P:\018253 IKEA\001 Charlotte VWV CAD\ Rezoning plans\ Rezoning SUBMITTAL 03-16-07\REZONING SHEETS (SIGN PACKAGED).dwg
March 16, 2007 - 6:22pm By: brattipawr

NOTE:
Location of signs
is subject to change.

1

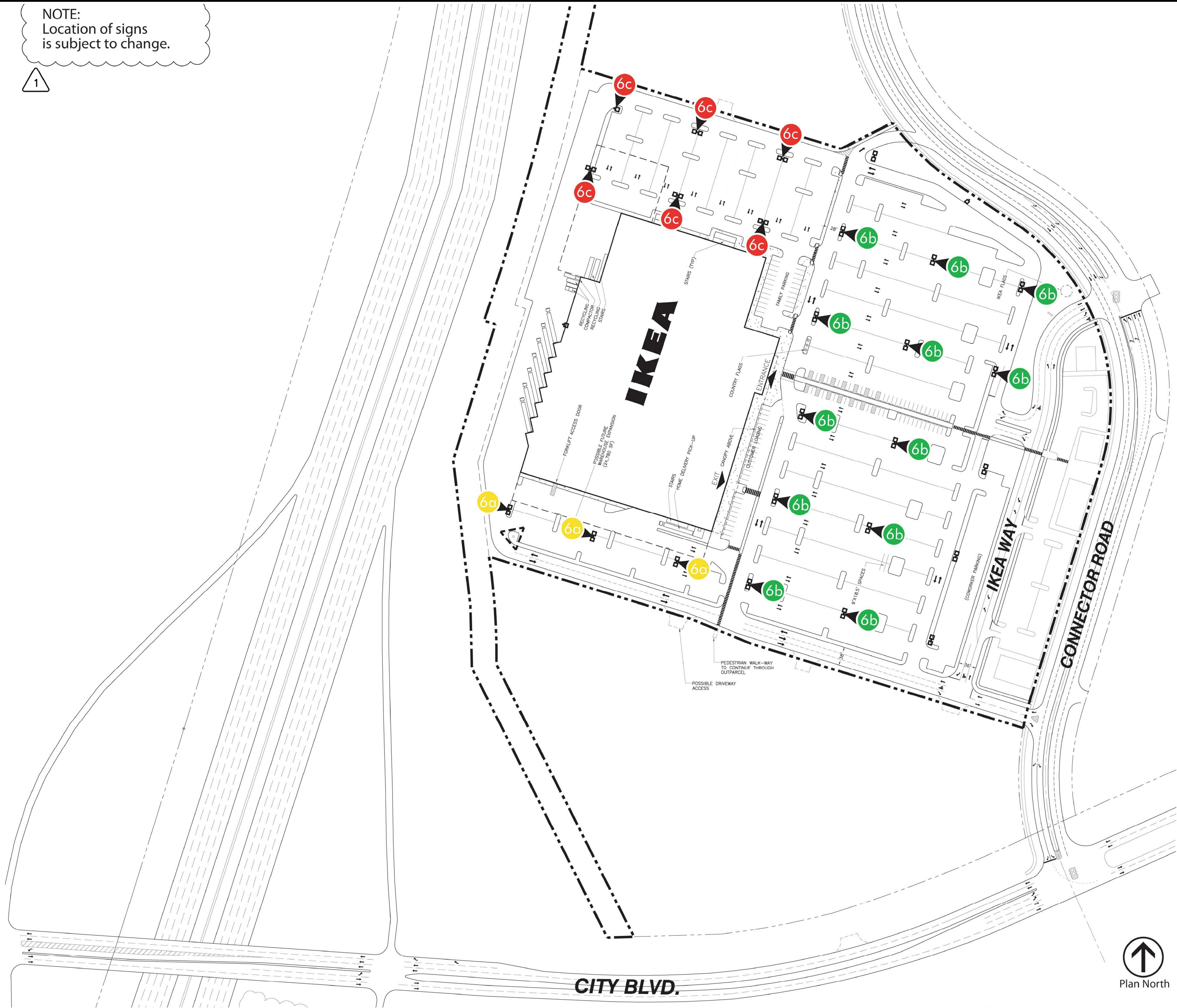

GreenbergFarrow
1755 The Exchange
Atlanta, GA 30339
t: 770 303 1033 f: 770 303 2333

CITY BLVD - NORTH REZONING

PETITIONERS:
IKEA PROPERTY, INC. AND
CRESCENT RESOURCES, LLC

FOR PUBLIC
HEARING
PETITION NO.
2006-155

DESIGNED BY: GF
DRAWN BY: GF
CHECKED BY: GF
DATE: 03-16-07

IKEA
SIGNAGE DETAILS
COMM 101
RZ-10

REVISIONS
1. REVISED PER STAFF COMMENTS
03/16/07

March 16, 2007 - 6:24pm By: brattiperry

P:\018253 IKEA\001 Charlotte VHW CAD\rezoning plans\rezoning SUBMITTAL 03-16-07\rezoning SHEETS (SIGN PACKAGED).dwg

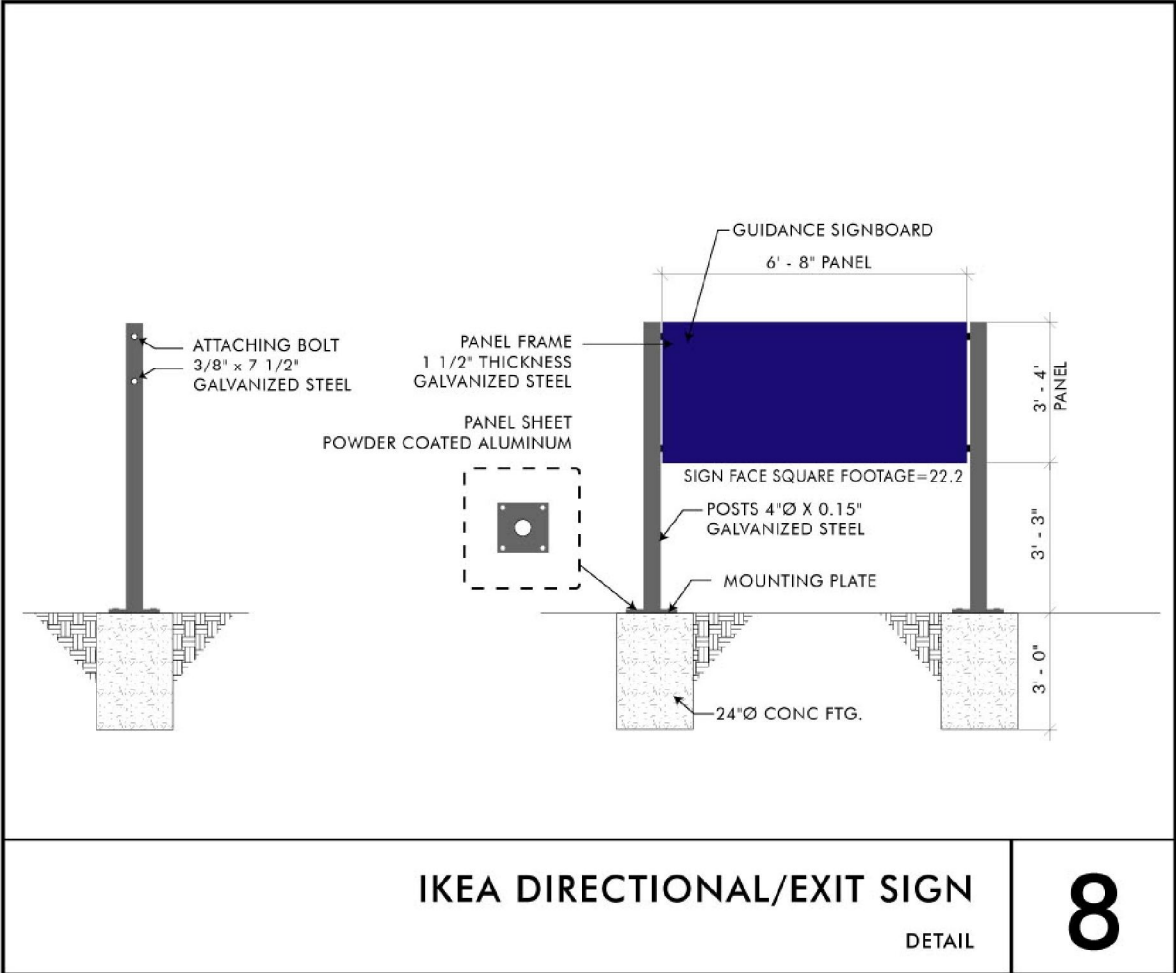
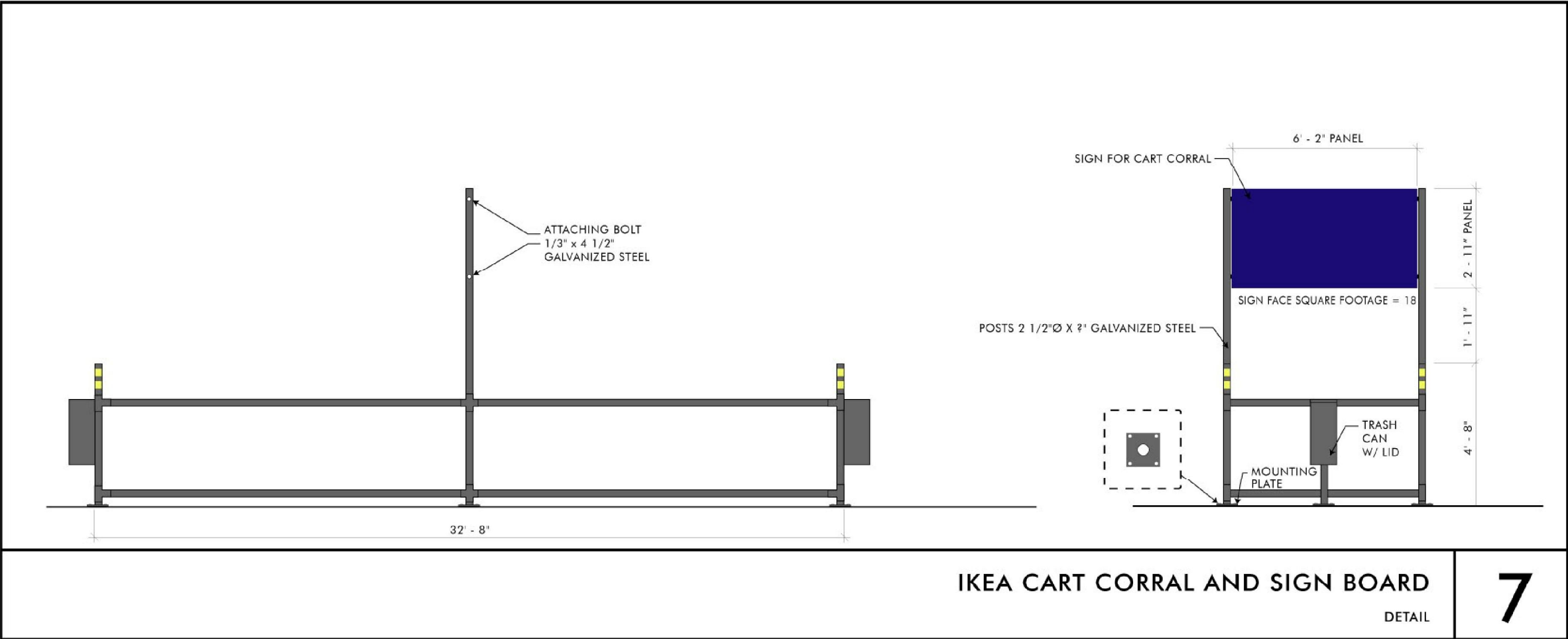
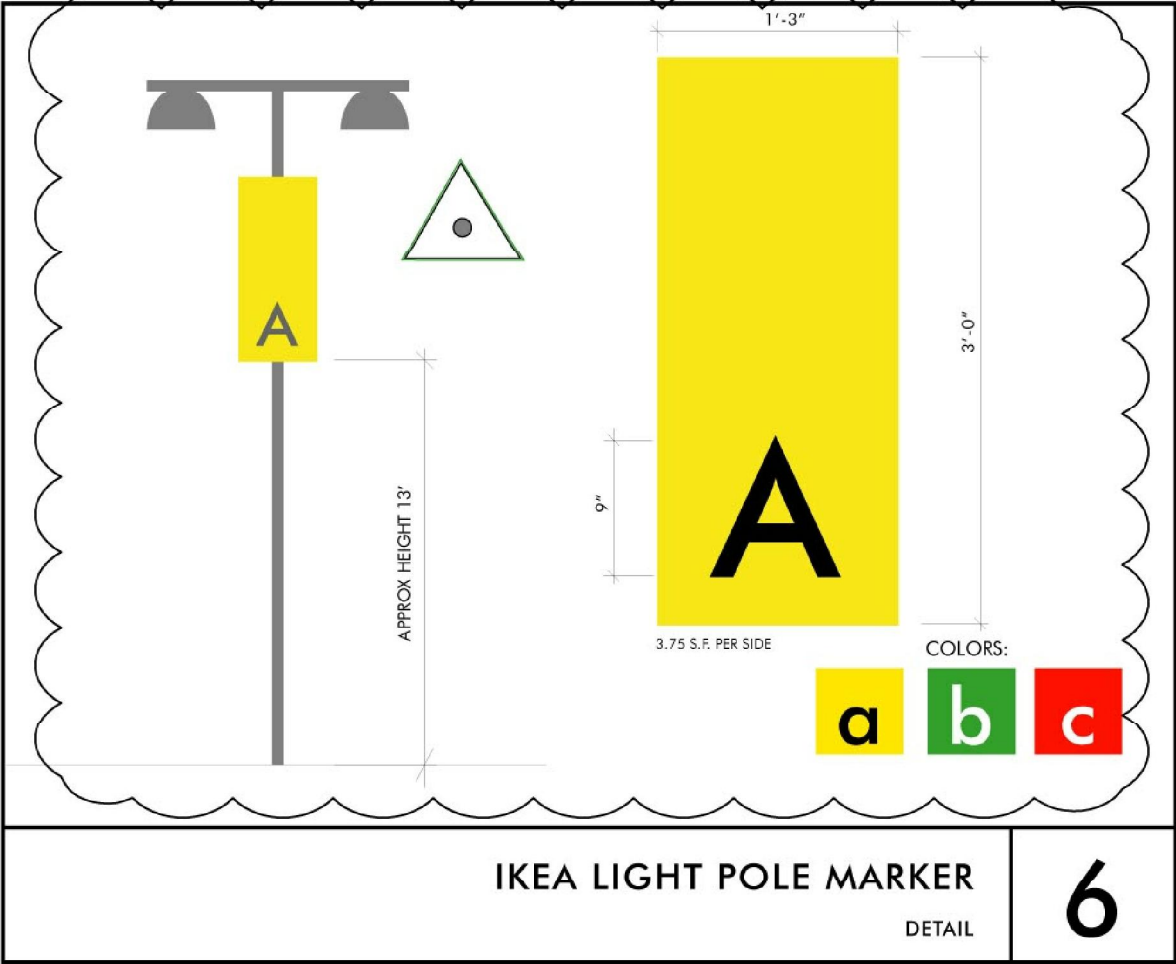
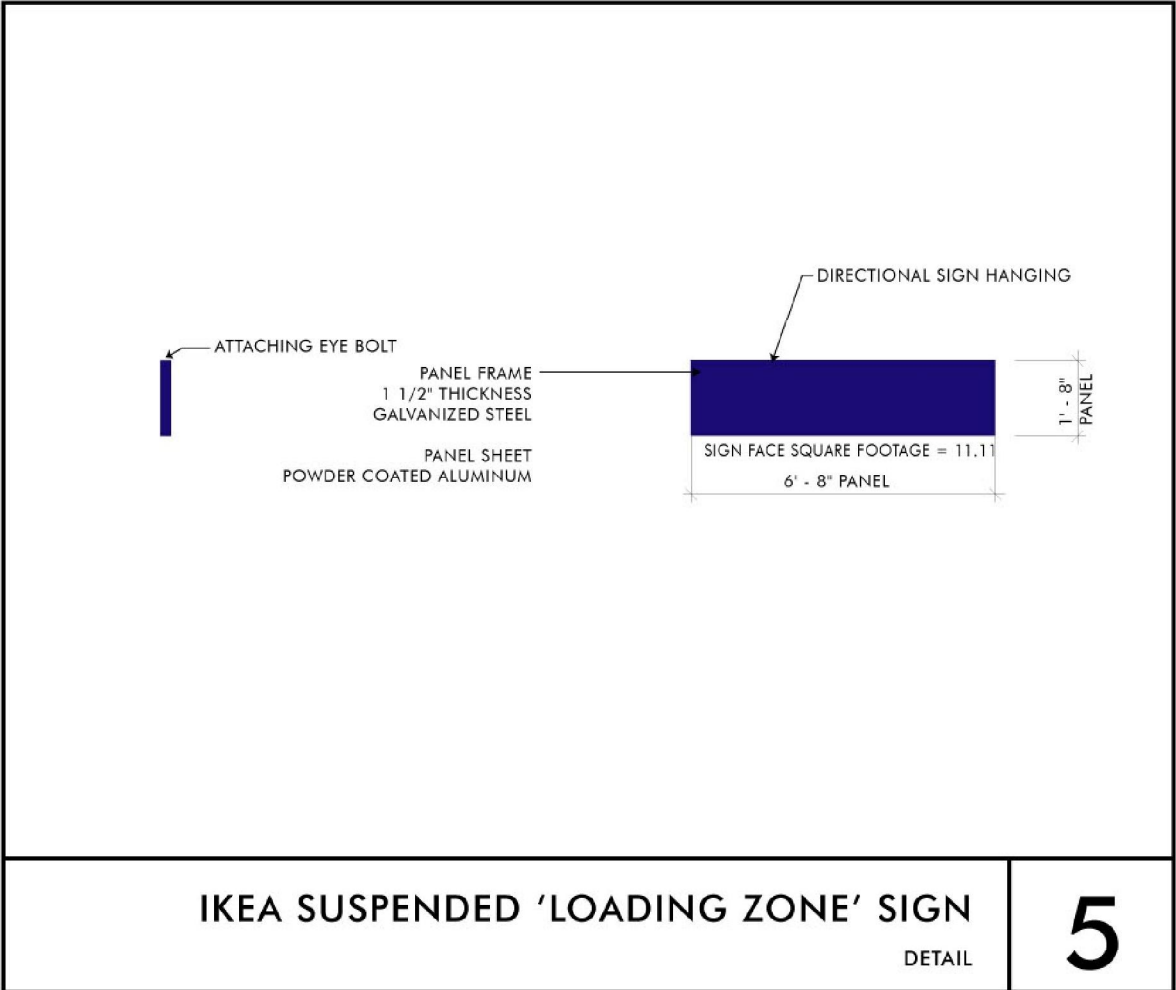
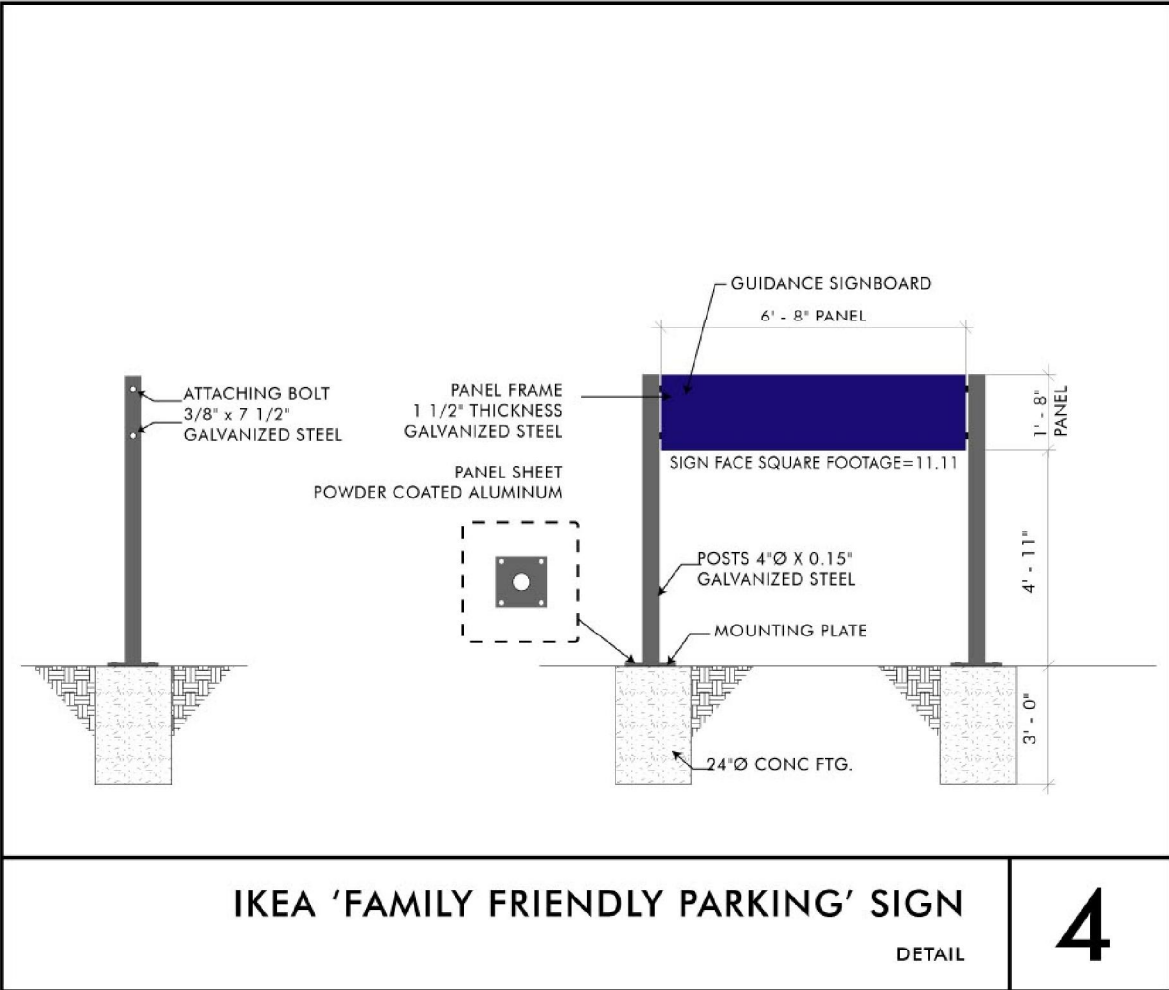
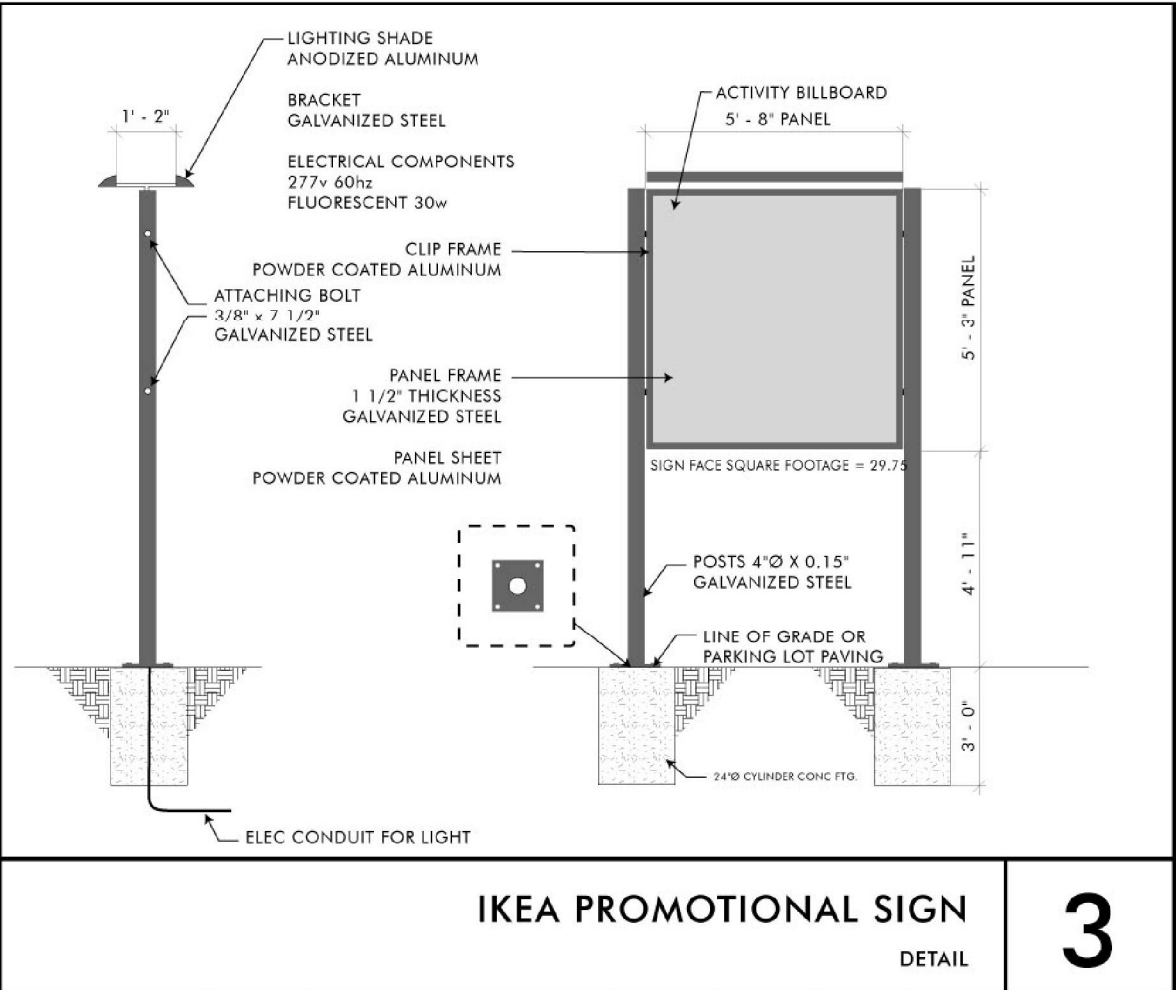
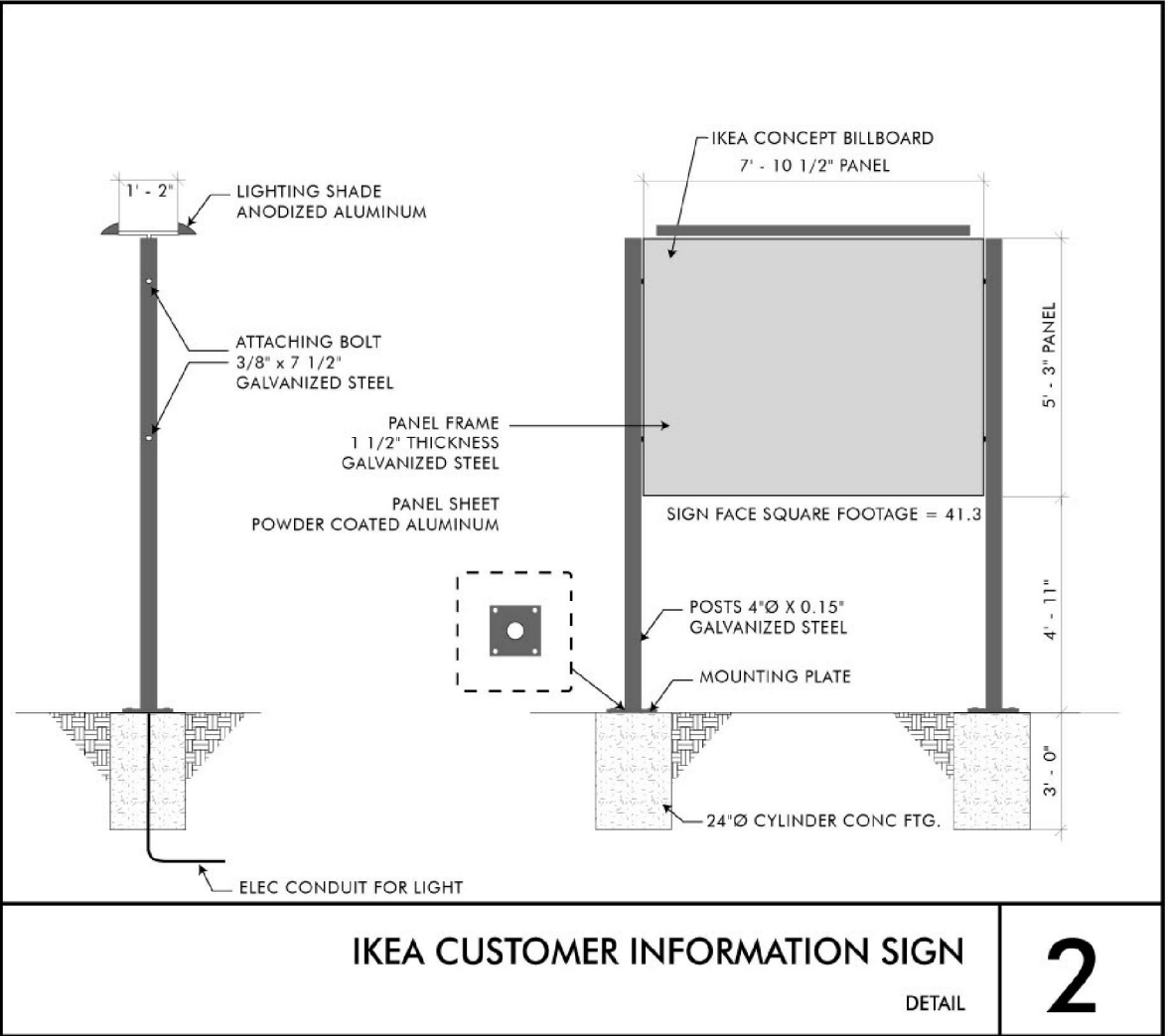
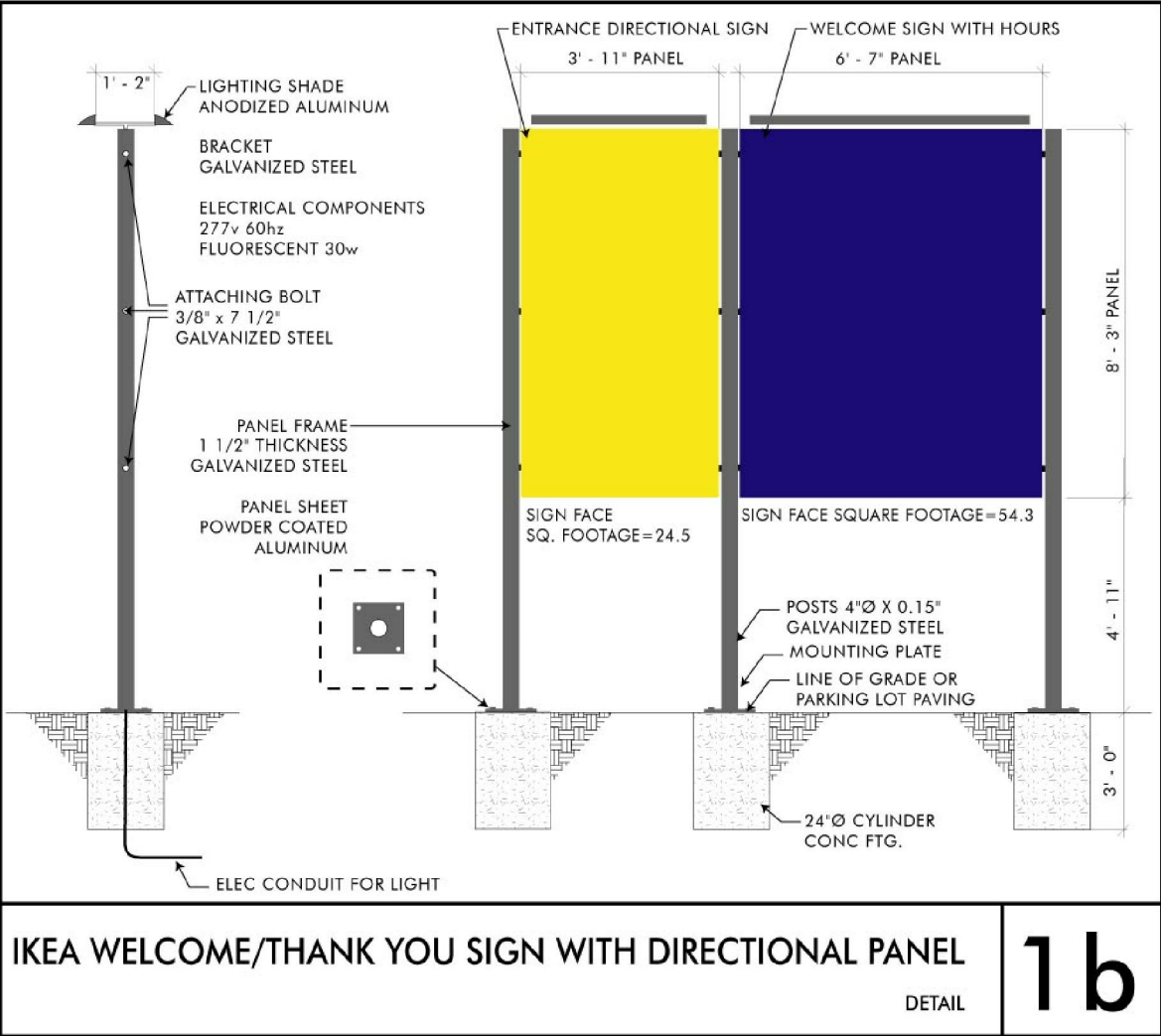
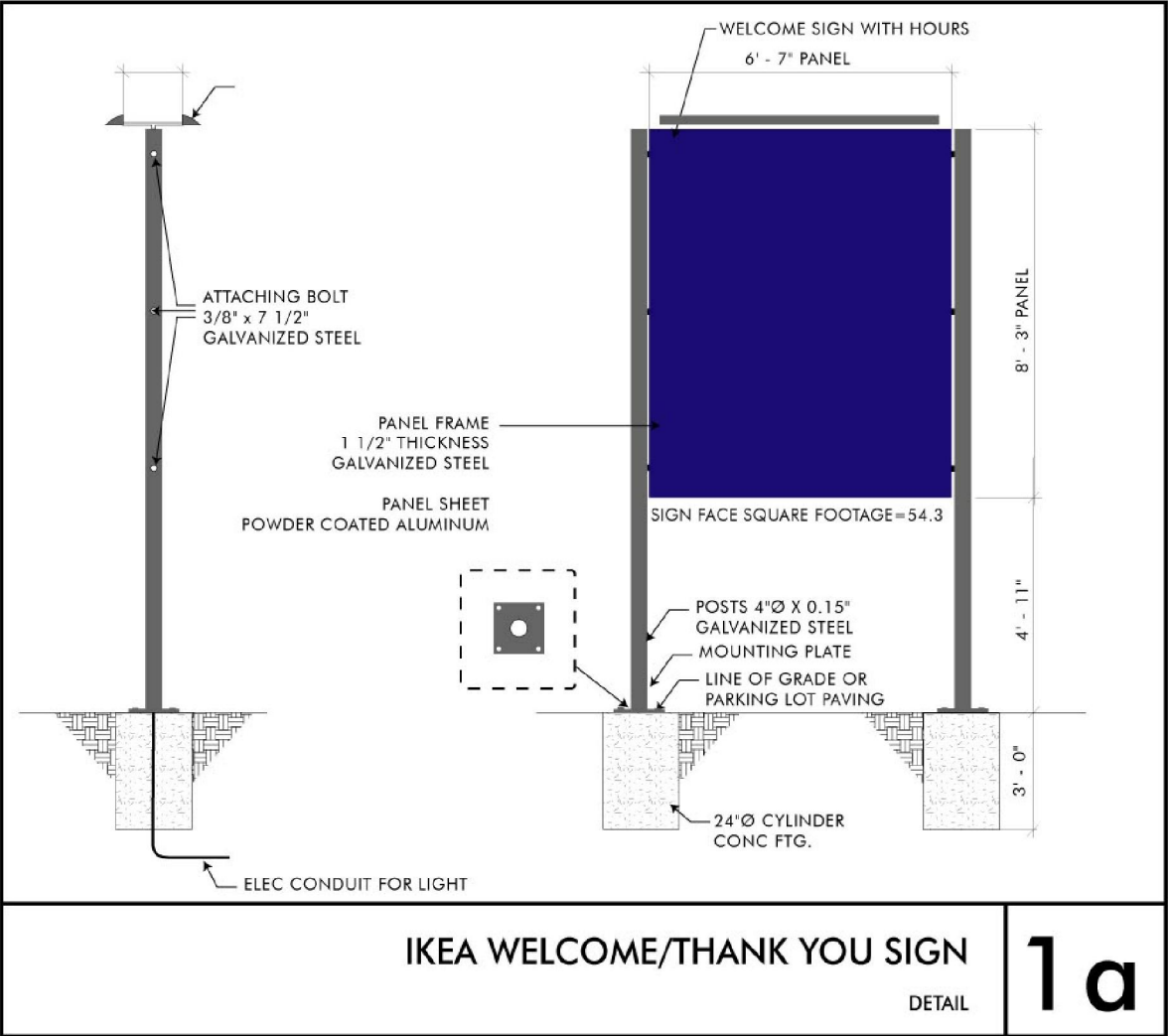

GreenbergFarrow

1755 The Exchange
Atlanta, GA 30339
t: 770 303 1033 f: 770 303 2333

CITY BLVD - NORTH REZONING

PETITIONERS:
IKEA PROPERTY, INC. AND
CRESCENT RESOURCES, LLC

FOR PUBLIC
HEARING
PETITION NO.
2006-155

DESIGNED BY: GF
DRAWN BY: GF
CHECKED BY: GF
DATE: 03-16-07

IKEA
SIGNAGE DETAILS
COMM 200
RZ-11

REVISIONS
1 REVISED PER STAFF COMMENTS
03/16/07

1

CHARLOTTE, NORTH CAROLINA
MECKLENBURG COUNTY, 28201
(NEC) I-85 AND CITY BLVD.

PETITIONERS:
IIKEA PROPERTY, INC. AND
CRESCENT RESOURCES, LLC

DESIGNED BY: GF
DRAWN BY: GF
CHECKED BY: GF
DATE: 03-16-07

IKEA
SIGNAGE DETAILS
COMM 300
RZ-12

REVISIONS

1	REVISED PER STAFF COMMENTS	03/16/07

IKEA WELCOME/THANK YOU SIGN

1 a

IKEA WELCOME/THANK YOU SIGN WITH DIRECTIONAL PANEL

1 k

IKEA CUSTOMER INFORMATION SIGN

2c

IKEA CUSTOMER INFORMATION SIGN

2b

IKEA CUSTOMER INFORMATION SIGN

20

IKEA PROMOTIONAL SIGN
COMMUNICATION LAYOUT

3d

IKEA 'FAMILY FREINDLY PARKING' SIGN

4a

IKEA SUSPENDED 'LOADING ZONE' SIGN

5c

IKEA DOUBLE CART CORRAL AND SIGN BOARD

COMMUNICATION LAYOUT

7c

IKEA DIRECTIONAL/EXIT SIGN PANE

8a

IKEA DIRECTIONAL/EXIT SIGN PANEL

8b

IKEA DIRECTIONAL/EXIT SIGN PANEL

80

P:\018253\ IKEA.001 Charlotte VHM CAD\ rezoning plans\ rezoning submittal 03-16-07\ rezoning sheets\ sign package.dwg March 16, 2007 - 6:06pm By: brattipany



OVERALL ELEVATION

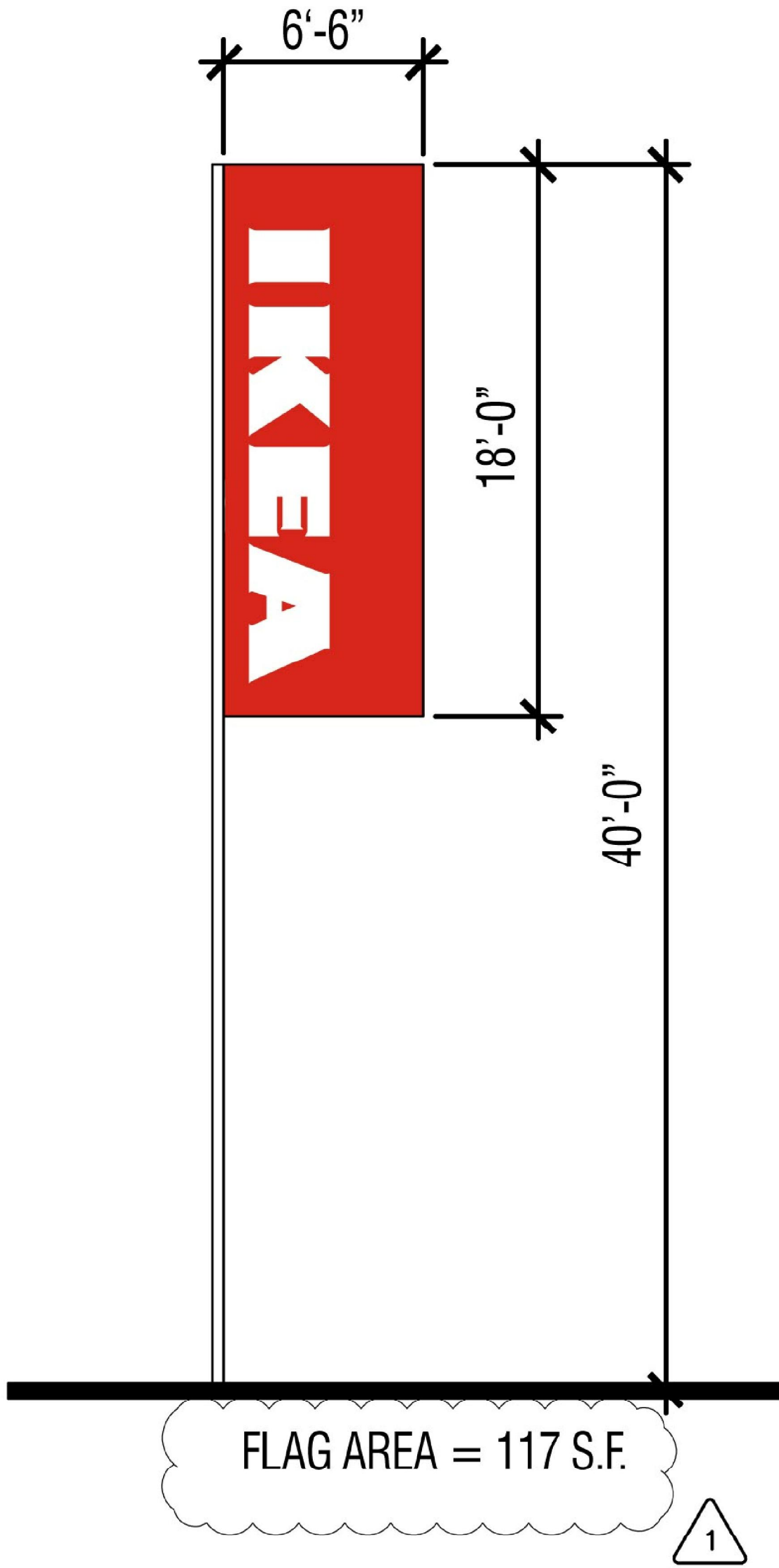

POLE AND FLAG ELEVATION

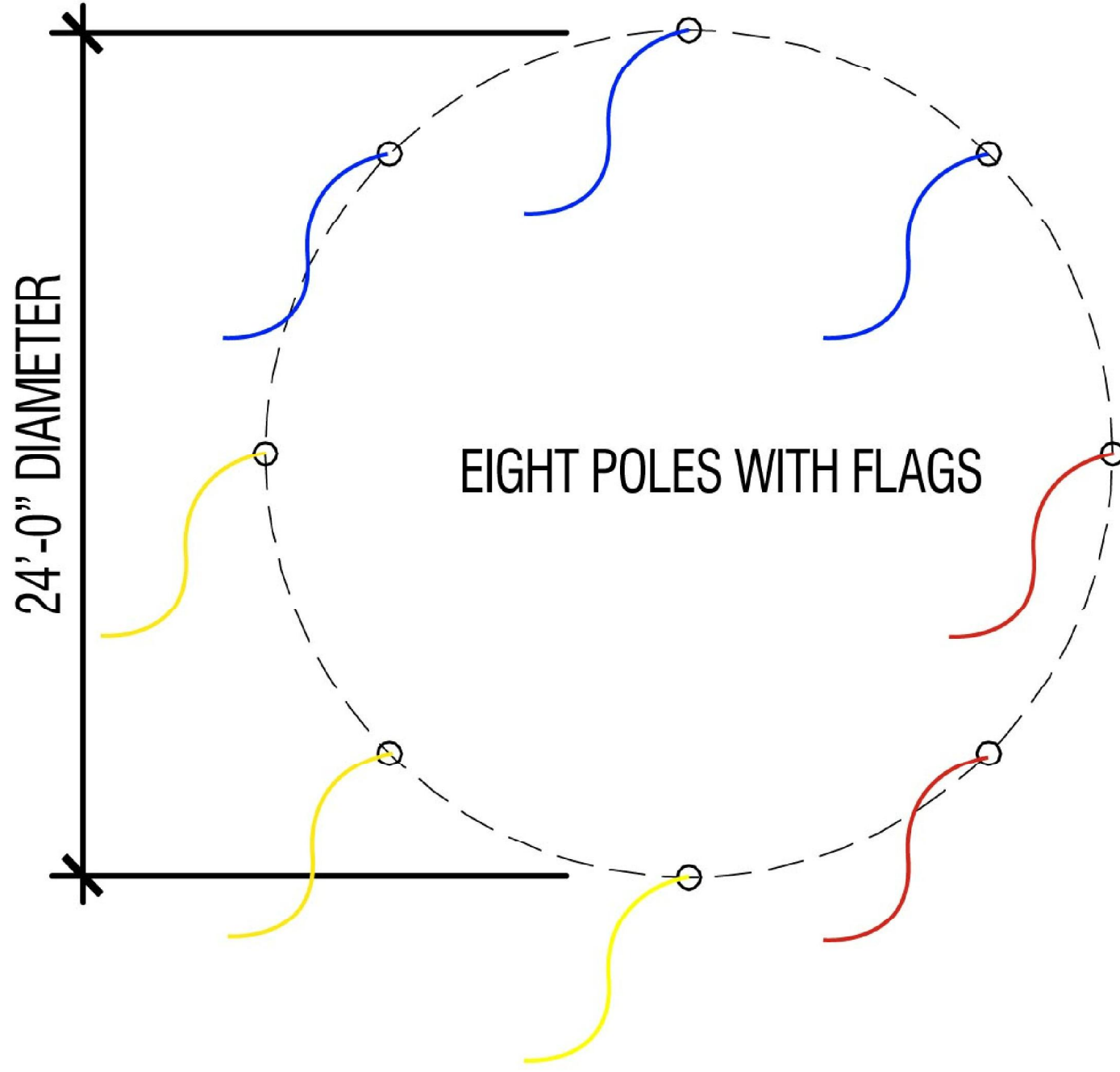

PLAN VIEW

CITY BLVD - NORTH REZONING

PETITIONERS:
IKEA PROPERTY, INC. AND
CRESCENT RESOURCES, LLC

FOR PUBLIC
HEARING
PETITION NO.
2006-155

DESIGNED BY: GF
DRAWN BY: GF
CHECKED BY: GF
DATE: 03-16-07

IKEA
FLAG CIRCLE
RZ-13

REVISIONS	
1	REVISED PER STAFF COMMENTS

03/16/07

CHARLOTTE, NORTH CAROLINA
MECKLENBURG COUNTY, 28201
(NEC) I-85 AND CITY BLVD.

March 16, 2007 - 6:02pm By: brattipatty

P:\018293 IKEA\001 Charlotte VHM CAD\ rezoning plans\ rezoning submittal 03-16-07\ rezoning sheets-cw4g

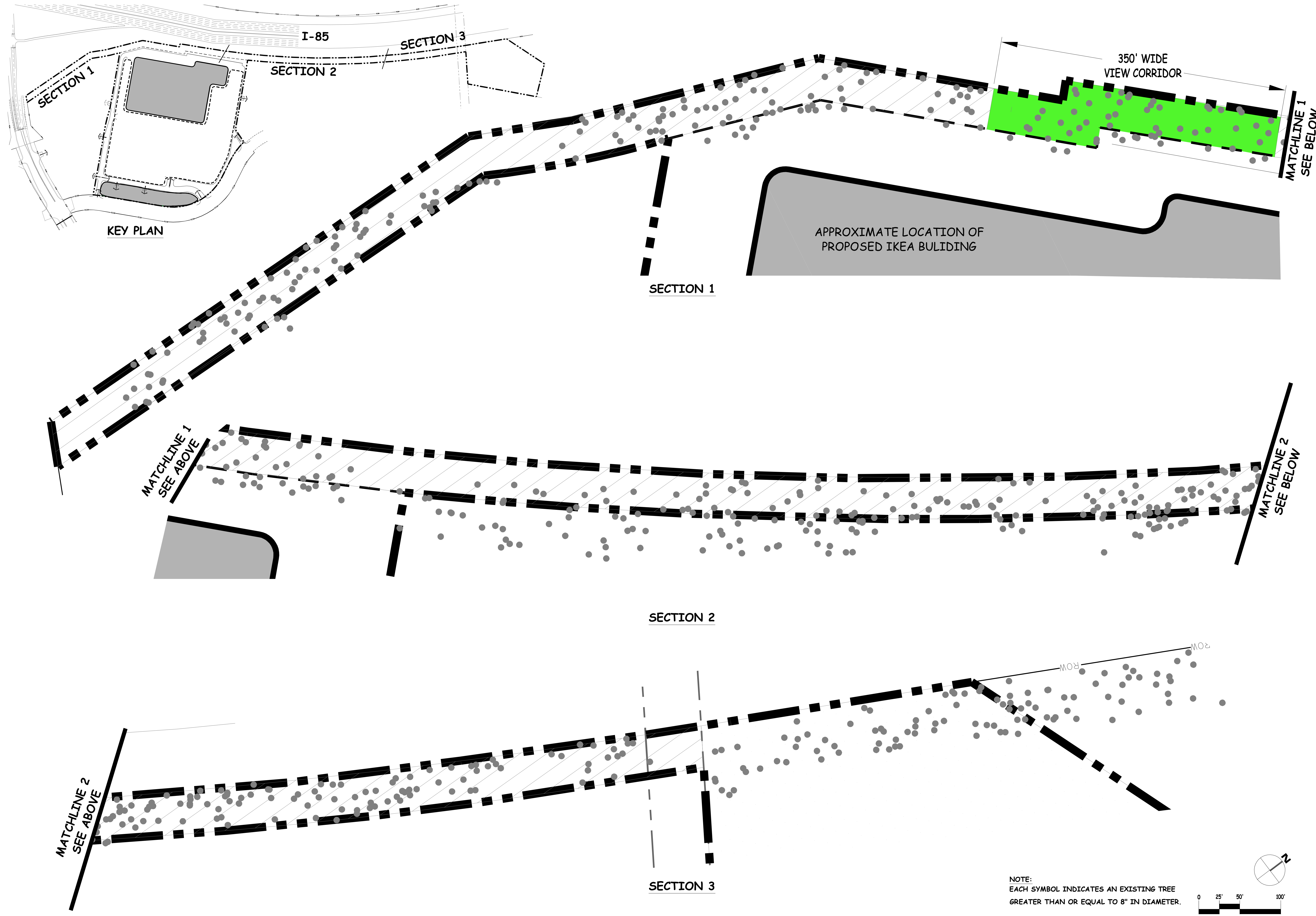

KEY PLAN

APPROXIMATE LOCATION OF
PROPOSED IKEA BUILDING

350' WIDE
VIEW CORRIDOR



**Kimley-Horn
and Associates, Inc**
8401 CHARLOTTE PARK DRIVE
SUITE 300
CHARLOTTE, NORTH CAROLINA 28217
PHONE: (704) 333-5131
FAX: (704) 333-0845 © 2007

REVISIONS	
1	REVISED PER STAFF COMMENTS
03/16/07	

CITY BLVD - NORTH REZONING
CHARLOTTE, NORTH CAROLINA
MECKLENBURG COUNTY, 28201
(NEC) I-85 AND CITY BLVD.

PETITIONERS:
IKEA PROPERTY, INC. AND
CRESCENT RESOURCES, LLC

**FOR PUBLIC
HEARING
PETITION NO.
2006-155**

DESIGNED BY: PB
DRAWN BY: LL
CHECKED BY: BW
DATE: 03-16-07

**TREE SURVEY
RZ-14**

NOTE:
EACH SYMBOL INDICATES AN EXISTING TREE
GREATER THAN OR EQUAL TO 8" IN DIAMETER.

