

Steele Creek Commerce Park

STEELE CREEK ROAD, SHOPTON ROAD, GABLE DRIVE
CHARLOTTE, NORTH CAROLINA

EASTGROUP
P R O P E R T I E S



SWM / DETENTION

APPROVED

By Robert Zink at 2:56 pm, Sep 13, 2013

EROSION CONTROL

FOR A PRE-CONSTRUCTION MEETING
48 HRS. PRIOR TO ANY LAND
DISTURBING ACTIVITY, CONTACT:

Jay Wilson (704) 517-1152

DRAINAGE PLAN

APPROVED

By Robert Zink at 2:56 pm, Sep 13, 2013

TREE ORDINANCE

APPROVED

Kelly Robertson
Ok w/ comments

CDOT DRIVEWAYS

APPROVED

Candice Leonard

NCDOT DRIVEWAYS

NOTE: THIS PLAN APPROVAL DOES NOT INCLUDE
ZONING. ALL BUILDING PERMITS AND ZONING
APPROVALS CAN BE OBTAINED AT MECK. CO.
CODE ENFORCEMENT. PLEASE CALL THE CTAC
AT 704-336-3829 FOR MORE INFORMATION.

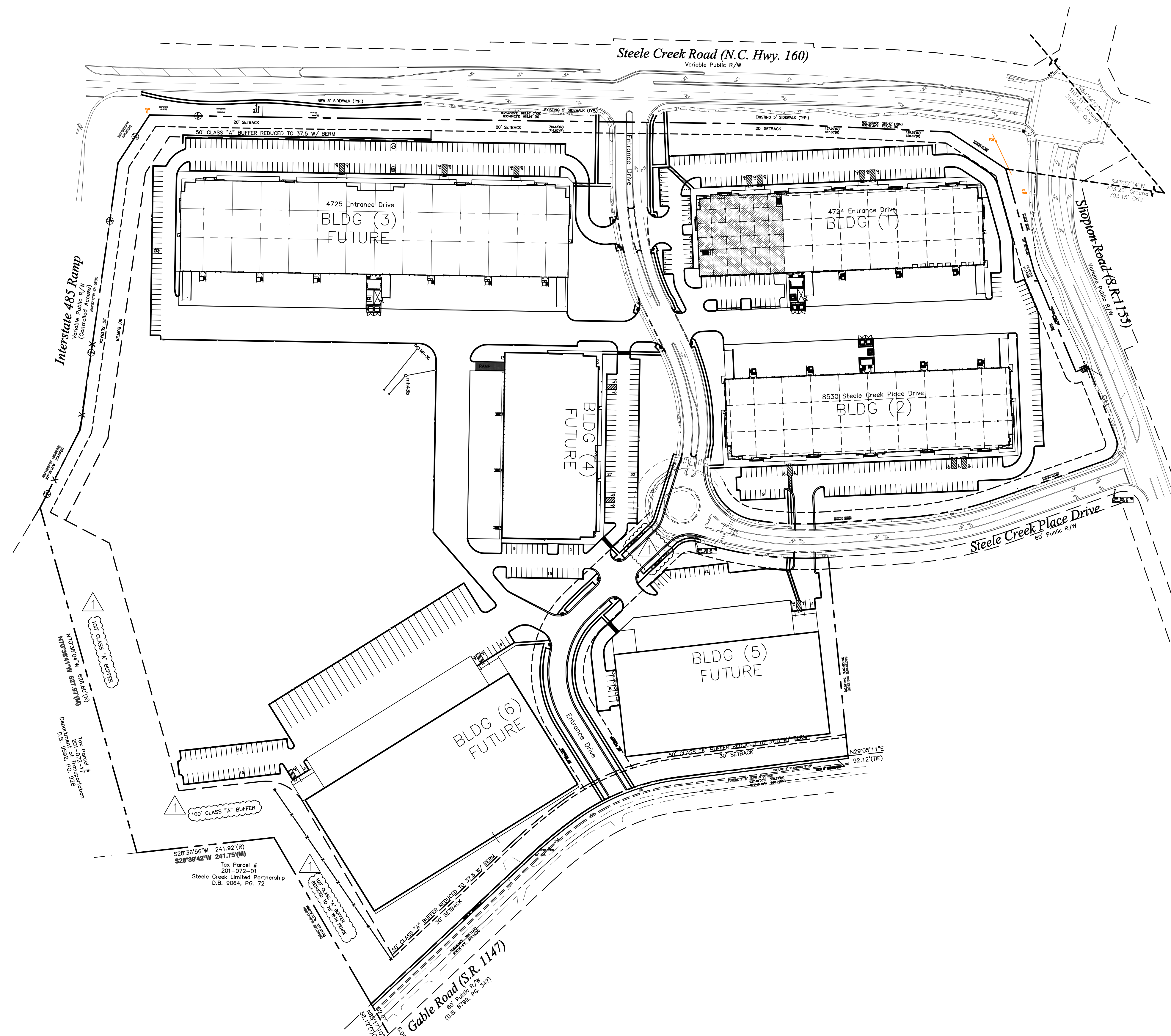
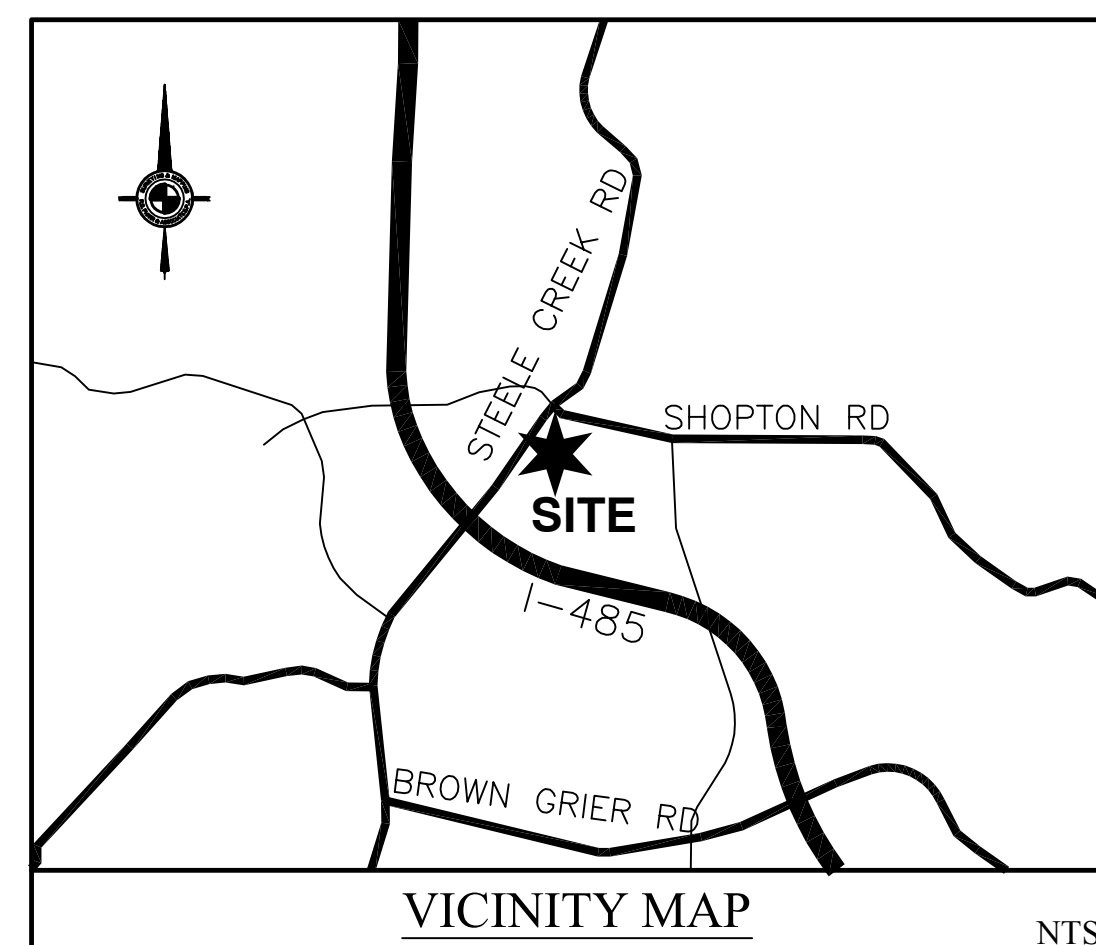

APPROVED FOR
CONSTRUCTION

CHARLOTTE-MECKLENBURG PLANNING DEPARTMENT
By: Joshua Weaver 9-13-2013

COMPLETION SCHEDULE	
BUILDING 1	END OF 2013
BUILDING 2	END OF 2013
BUILDING 3	SPRING 2014
BUILDING 4	UNKNOWN
BUILDING 5	UNKNOWN
BUILDING 6	UNKNOWN

INSPECTOR: John LaMarre (704.517.5601)
URBAN FORESTER: Kelly Robertson (704.607.8987)
EROSION CONTROL: Jay Wilson (704.517.1152)
SENIOR ENGINEER: Brendan Smith (704.336.4556)

SHEET INDEX (CIVIL PLANS) 2013

C	0	COVER SHEET
Csu	1	SURVEY
Cero	2	EROSION CONTROL PLAN
Csp	3	SITE PLAN
Cgdec	4	GRADING, DRAINAGE, AND EROSION CONTROL PLAN
Cut	5	UTILITY PLAN
Cisp	6	Landscape Plan
Cdt	7	Detail Sheet

SHEET INDEX (STORM WATER MANAGEMENT) (CIVIL PLANS) 2013

Cp	1	STORMWATER MANAGEMENT PLAN
Cp	2	WET POND DETAIL
Cp	3	POND 1 PLANTING PLAN
Cp	4	POND 2 IMPROVEMENT

4.17.2013
C 0 of 7

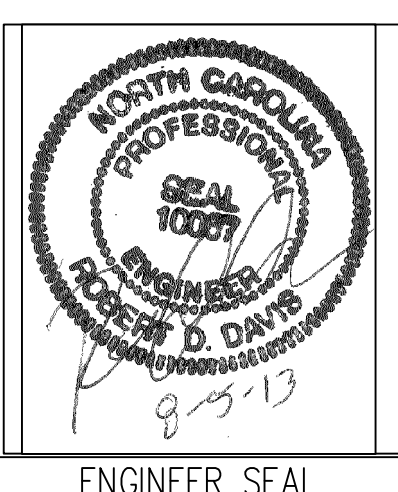

DESIGN COMPANY: JMA, James McGovern Associates
ADDRESS: 202 Main Street, Pineville, NC, 28134
PHONE: (704) 889.8200
FAX: (704) 889.8235

SURVEY COMPANY: R.B. PHARR & ASSOCIATES, P.A.
ADDRESS: 420 HAWTHORNE LANE CHARLOTTE, N.C. 28204
PHONE: (704) 376.2186
FAX:

OWNER: EASTGROUP P R O P E R T I E S
ADDRESS: 11440 CARMEL COMMONS BLVD.
SUITE 209, CHARLOTTE, NC 28226
PHONE: (704) 625.4030
FAX: (704) 542.5560

