

# SITE DATA

TAX PARCEL NUMBERS: 161-062-02 & 161-062-38  
 SITE AREA: 51,714 SF OR 1.187 ACRES  
 EXISTING ZONING: R-4  
 EXISTING USE: VACANT  
 PROPOSED # OF LOTS: 4 SINGLE FAMILY  
 DENSITY: 3.37 DU/AC  
 MIN SETBACK: 30'  
 MIN SIDE YARD: 5'  
 MIN REA YARD: 40'  
 MIN LOT SIZE: 9,000 SF  
 MIN LOT WIDTH: 60'  
 TRACH PICK UP PROVIDED: PUBLIC ROLL OUT  
 RECYCLE PICK UP PROVIDED: PUBLIC PICK UP

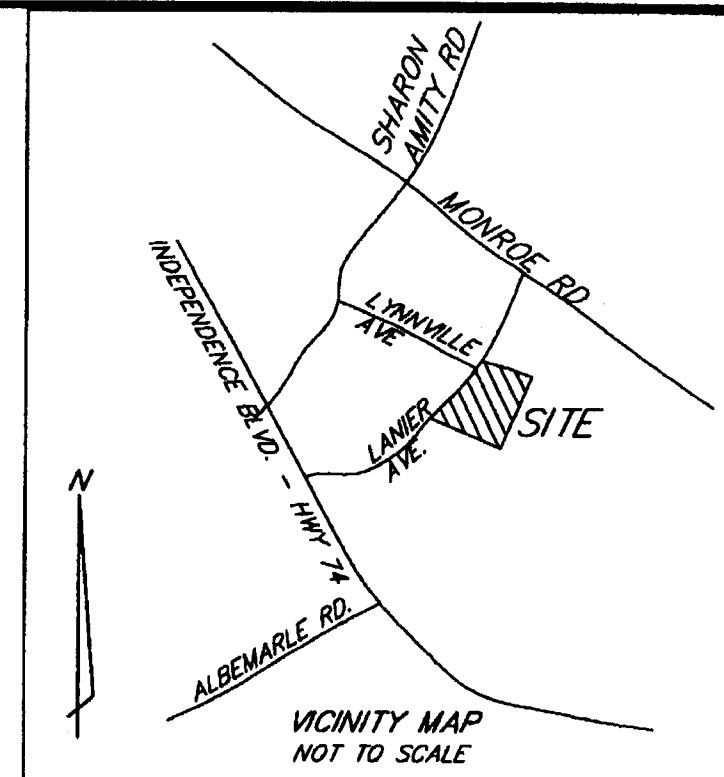

## PLANTING SCHEDULE

KEY	QTY.	SCIENTIFIC NAME/ COMMON NAME	CAL.	HT.	SPD.	COND.	NOTES
9	9	CERCIS CANADENSIS FOREST PANSY EASTERN REDBUD	2" MIN	8'-10'		B+B	SINGLE STEM FULL CROWN WELL MATCHED
4	4	ACER RUBRUM OCTOBER GLORY RED MAPLE	2" MIN	10'-12'		B+B	SINGLE STEM WELL MATCHED

## PERIMETER TREE REQUIREMENTS

LINEAR FEET OF ROAD FRONTAGE ALONG MAINTAINED RIGHT OF WAY INCLUDING DRIVEWAYS  
 STREET: LANIER AVENUE = 249.42 LF  
 PROVIDED: 9 SMALL MATURING TREES  
 NO EXISTING TREES  
 NO EXISTING TREES SHOWN FOR CREDIT  
 PROVIDED: (9) 1 1/2" - 2" CAL., 10' HT., RED BUDS.  
 IF OVERHEAD DISTRIBUTION POWER LINES EXIST, ONLY SMALL MATURING TREES ARE ALLOWED  
 WITHIN 25 FT. OF LINES. OTHERWISE 75% OF NEW TREES MUST BE LARGE MATURING.  
 TREES ARE LOCATED BECAUSE OF POTENTIAL DRIVEWAYS (NOT SHOWN).

## TREE SAVE REQUIREMENTS

TOTAL SITE AREA = 51,714 SF (1.18 AC.)  
 TREE SAVE REQUIRED: 10% = 5,172 SF  
 NO EXISTING TREES TO BE PRESERVED  
 5,172/2,500 = 3 TREES REQUIRED  
 TREE SAVED PROVIDED: 4x2500 = 10,000 SF ~ 19.3%

## TREE PROTECTION NOTE:

THERE ARE NO TREE SAVE AREAS. NO TREES LOCATED ON SITE.  
 FOUR (4) TREES PROPOSED TO MEET TREE PRESERVATION REQUIREMENTS.

## GENERAL NOTES:

- CONTRACTOR IS RESPONSIBLE FOR VERIFYING ALL QUANTITIES. HEIGHT AND WIDTH SIZES SHALL BE MET REGARDLESS OF CONTAINER OR CONDITION SHOWN.
- ALL PLANTS SHALL MEET OR EXCEED THE MINIMUM STANDARDS SET BY THE U.S.D.A. STANDARD FOR NURSERY STOCK SPONSORED BY THE AMERICAN ASSOCIATION OF NURSESMEN, INC., WASHINGTON, D.C.
- CONTRACTOR TO REVIEW PLANT SELECTION WITH LANDSCAPE ARCHITECT PRIOR TO INSTALLATION AND DURING PROPOSAL PREPARATION FOR QUALITY CONTROL AND VALUE ENGINEERING.
- LANDSCAPE CONTRACTOR SHALL VERIFY UTILITY AND STORM DRAINAGE LOCATION IN THE FIELD, PRIOR TO BEGINNING CONSTRUCTION.
- ADJUST TREE PLANTING LOCATIONS TO AVOID UNDERGROUND UTILITIES--PLANT 15'-20' OFF SEWER AND STORM DRAINAGE LINES; 10'-15' OFF GAS, WATER, PHONE AND UNDERGROUND ELECTRICAL LINES.
- ANY CONFLICT BETWEEN TREES AND UTILITIES SHALL BE RESOLVED IN THE FIELD WITH FINAL TREE LOCATIONS APPROVED BY THE LANDSCAPE ARCHITECT AND THE PLANNING DEPARTMENT.
- LARGE MATURING TREES MUST BE A MINIMUM 25 TO 30 FEET FROM THE OVERHEAD DISTRIBUTION OR TRANSMISSION LINES. IF TREES CONFLICT WITH POWER LINES OR SIGNS, CALL URBAN FORESTER TO RESOLVE BEFORE PLANTING.
- PLEASE CALL 336-4255 FOR AN INSPECTION OF TREE PROTECTION AND/OR TREE PLANTING AREAS, 7 TO 10 DAYS BEFORE THE TEMPORARY OR FINAL CERTIFICATE OF OCCUPANCY IS NEEDED.
- ATTENTION CONTRACTOR/LANDSCAPER: IT IS THE RESPONSIBILITY OF THE CONTRACTOR/LANDSCAPER TO NOTIFY THE URBAN FORESTER OF ANY SITE CONFLICTS THAT AFFECT TREE SPECIES OR LOCATIONS PRIOR TO PLANTING TREES. CALL 336-3599 OR THE URBAN FORESTER NAMED ON THE APPROVED PLAN FOR ANY CONFLICTS REGARDING SIGHT, SIGNS, OVERHEAD POWERLINES OR OTHER UTILITIES.
- VIOLATIONS OF TREE PROTECTION REQUIREMENTS ARE SUBJECT TO FINES AND/OR IMMEDIATE CORRECTIVE ACTION/ MITIGATION.
- MINIMUM TREE SIZE AT PLANTING IS 2-INCH CALIPER (FOR SINGLE STEM TREES). ALL MULTI-STEM PLANTS MUST BE TREE FORM, MAXIMUM 3 TO 5 TRUNKS, AND MINIMUM 8 FEET TALL. MITIGATION TREES ARE 3-3 1/2" CAL.
- ALL STRAPPING AND TOP 2/3 OF WIRE BASKET MUST BE CUT AWAY AND REMOVED FROM ROOT BALL PRIOR TO BACKFILLING PLANTING PIT. REMOVE TOP 1/3 OF THE BURLAP FROM ROOT BALL.
- FOR NEW PLANTING AREAS, REMOVE ALL PAVEMENT, GRAVEL SUB-BASE AND CONSTRUCTION DEBRIS. REMOVE COMPACTED SOIL AND ADD 24" NEW TOPSOIL--OR UNCOMPACT AND AMEND THE TOP 24" OF EXISTING SOIL TO MEET TOPSOIL/PLANTING MIX STANDARDS FOR TREES (WITHIN ENTIRE MINIMUM AREA OF 274 SQUARE FEET PER TREE OR PLANTING AREA).
- MULCH ALL PLANTING BEDS WITH 4" OF PINE NEEDLE MULCH.
- APPLY PRE-EMERGENT HERBICIDE TO PLANTING BEDS PRIOR TO MULCHING.
- SEED ALL DISTURBED AREAS EXCEPT PLANTING BEDS AS NOTED.
- ALL PLANT BEDS AND LAWN AREAS SHALL HAVE 2" - 4" TRENCH EDGE.
- NO LIGHT POLES SHALL BE LOCATED IN PLANTER ISLANDS WITH TREES.
- ALL TREES SHALL BE PLANTED PER OLDSM DETAILS 40.01 AND 40.09

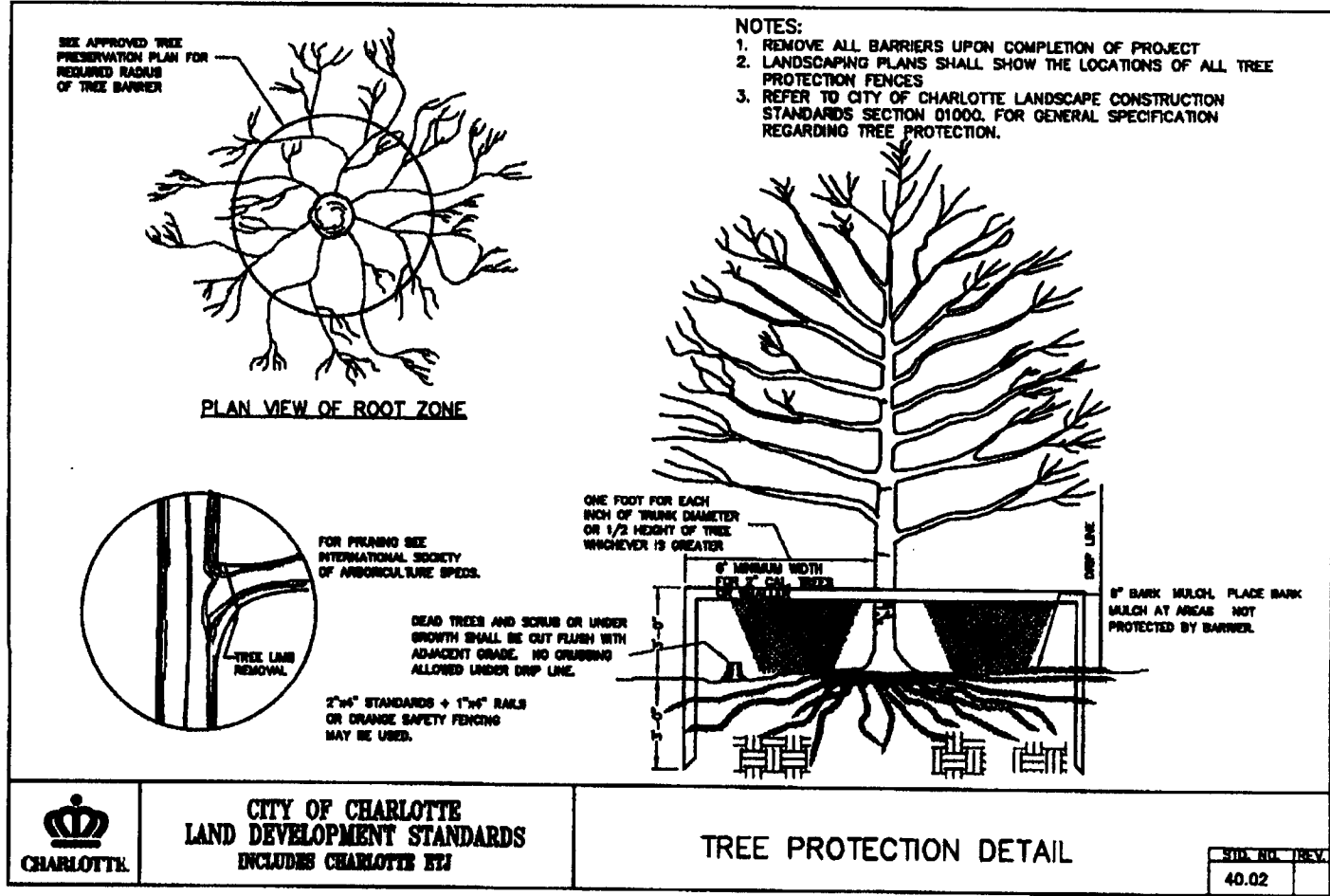
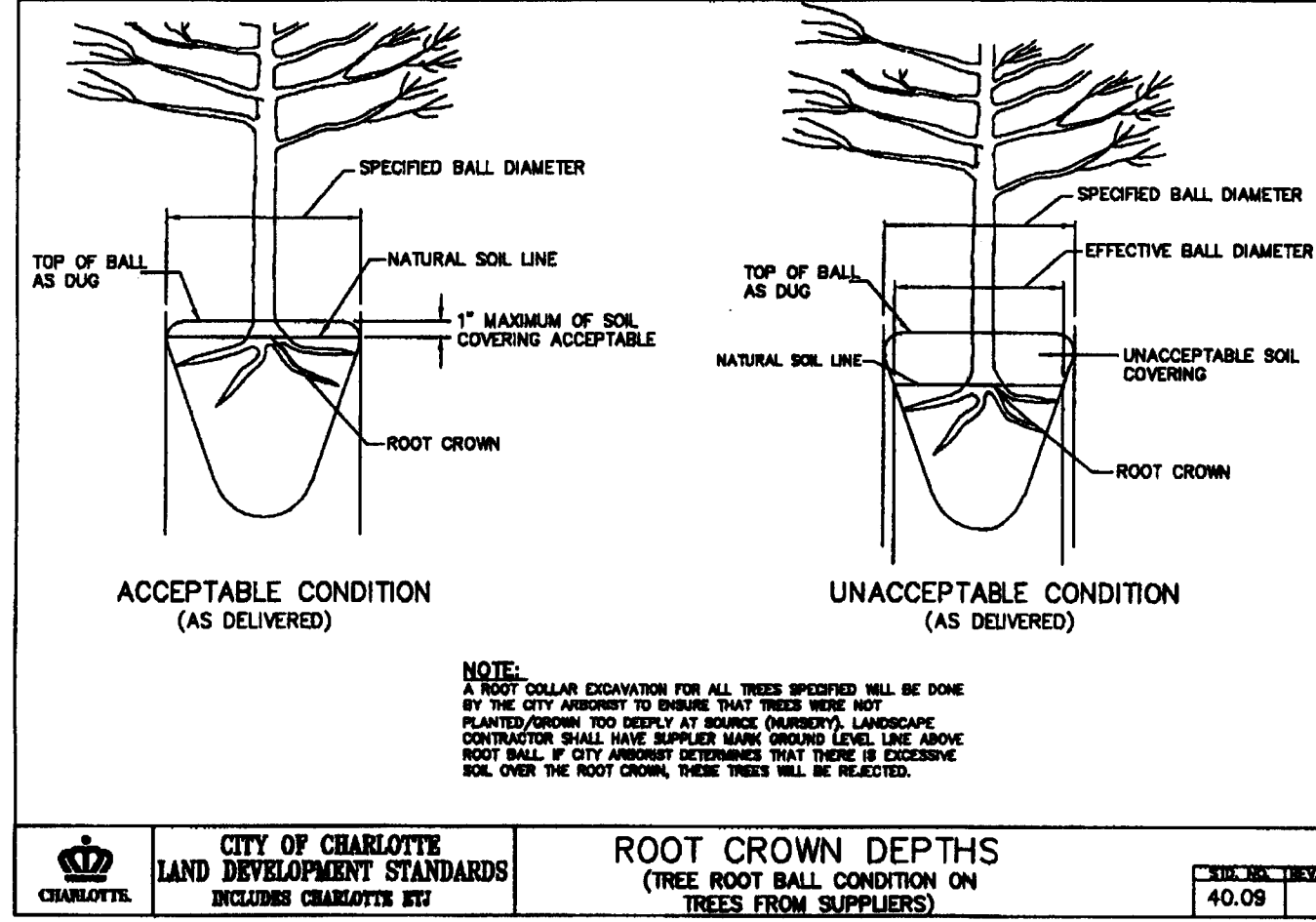
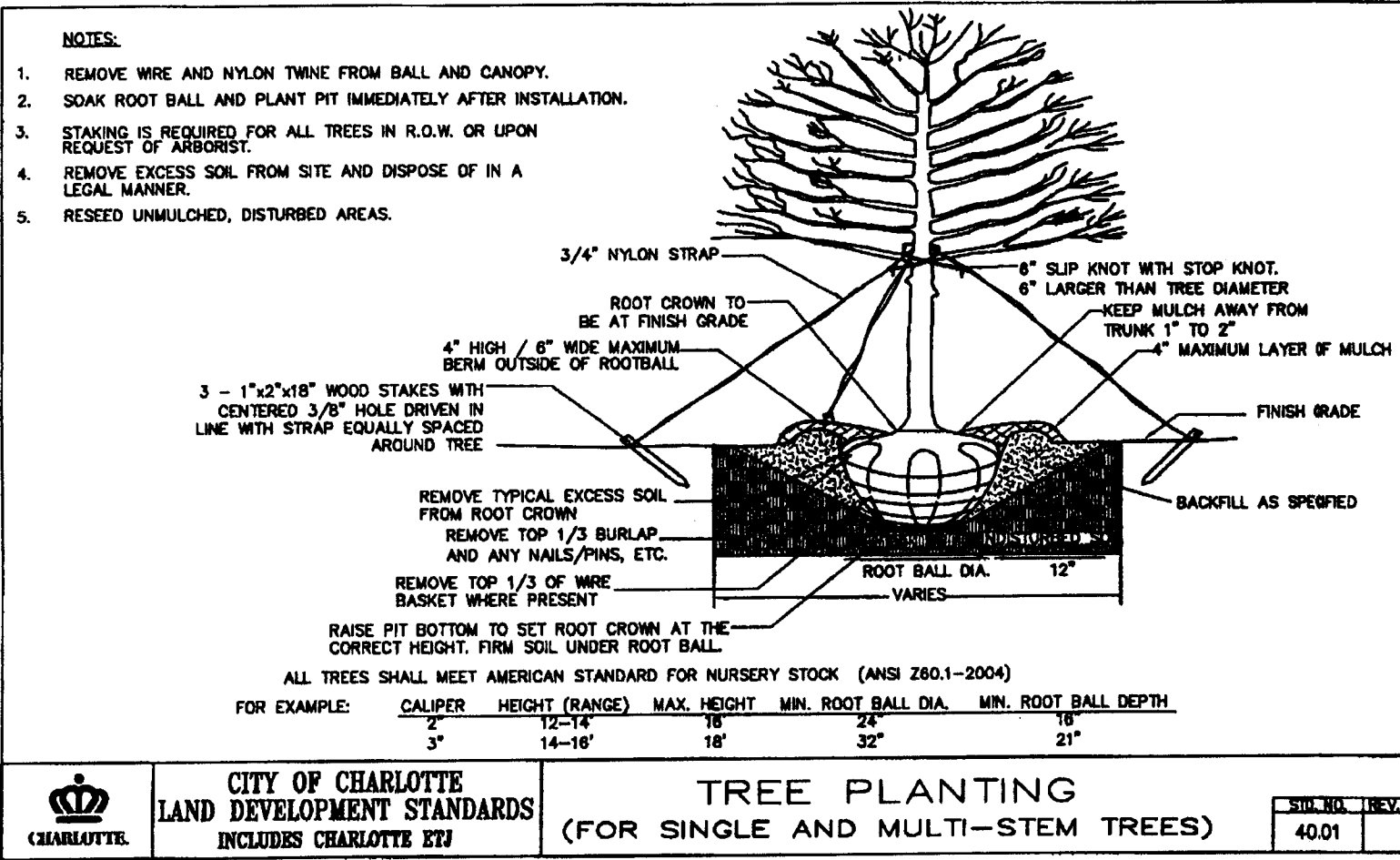

LANIER AVENUE  
 CHARLOTTE, NC  
 ROBERT WEEKS  
 P.O. BOX 1088  
 PINEVILLE, NC

## Design Resource Group

1230 West Morehead Street, Suite 214  
 Charlotte, NC 28208  
 704.343.0808 fax 704.368.3083  
 www.drg.com

- Landscape Architecture
- Urban Design
- Civil Engineering
- Land Planning

## SITE & REQUIRED PLANTING PLAN

Copyright © 2006 Design Resource Group, PA  
 This plan or drawing and any accompanying documents or calculations are the property of Design Resource Group, PA and are intended solely for the use of the recipient noted. No third party use or modification is permitted without written authorization.

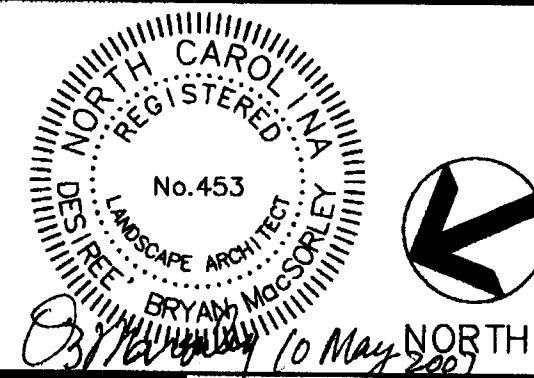

Scale: 1" = 20'  
 Date: OCT 9, 2006  
 Project No.: 248-001  
 Revisions:  
 1. JAN 15, 2007 PER ENGINEERING COMMENTS  
 2. MAR 20, 2007 PER ENGINEERING COMMENTS  
 3. MAY 10, 2007 PER CITY ARBORIST SITE VISIT