

This document, together with the concepts and designs presented herein, as an instrument of service, is intended only for the specific purpose and client for which it was prepared. Reuse of and improper reliance on this document without written authorization and adaptation by Kimley-Horn and Associates, Inc. shall be without liability to Kimley-Horn and Associates, Inc.

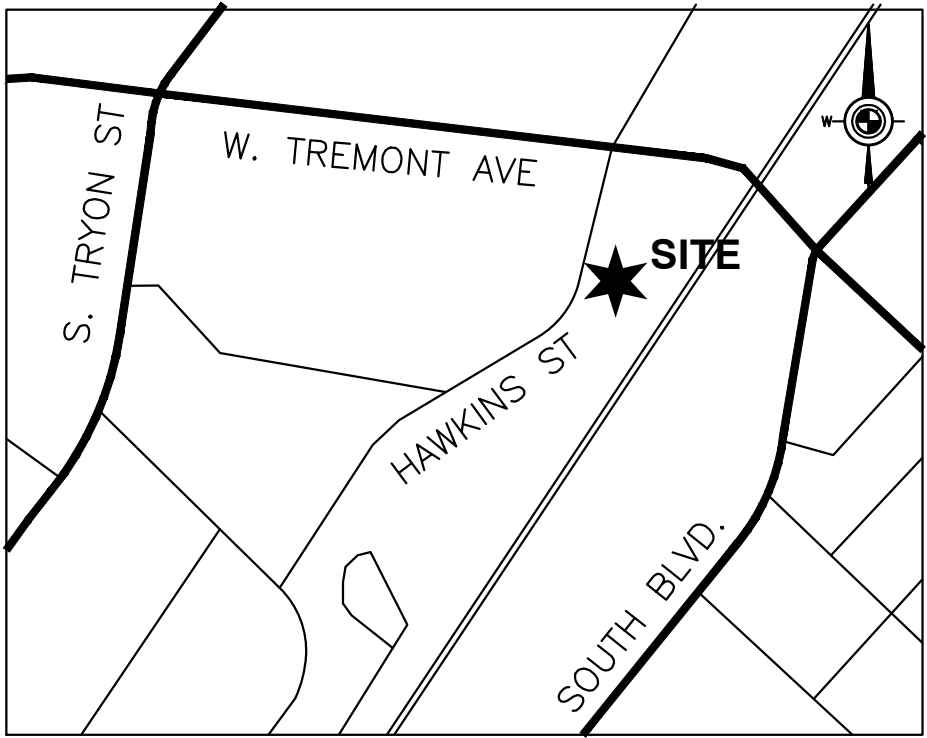

VICINITY MAP  
NOT TO SCALE

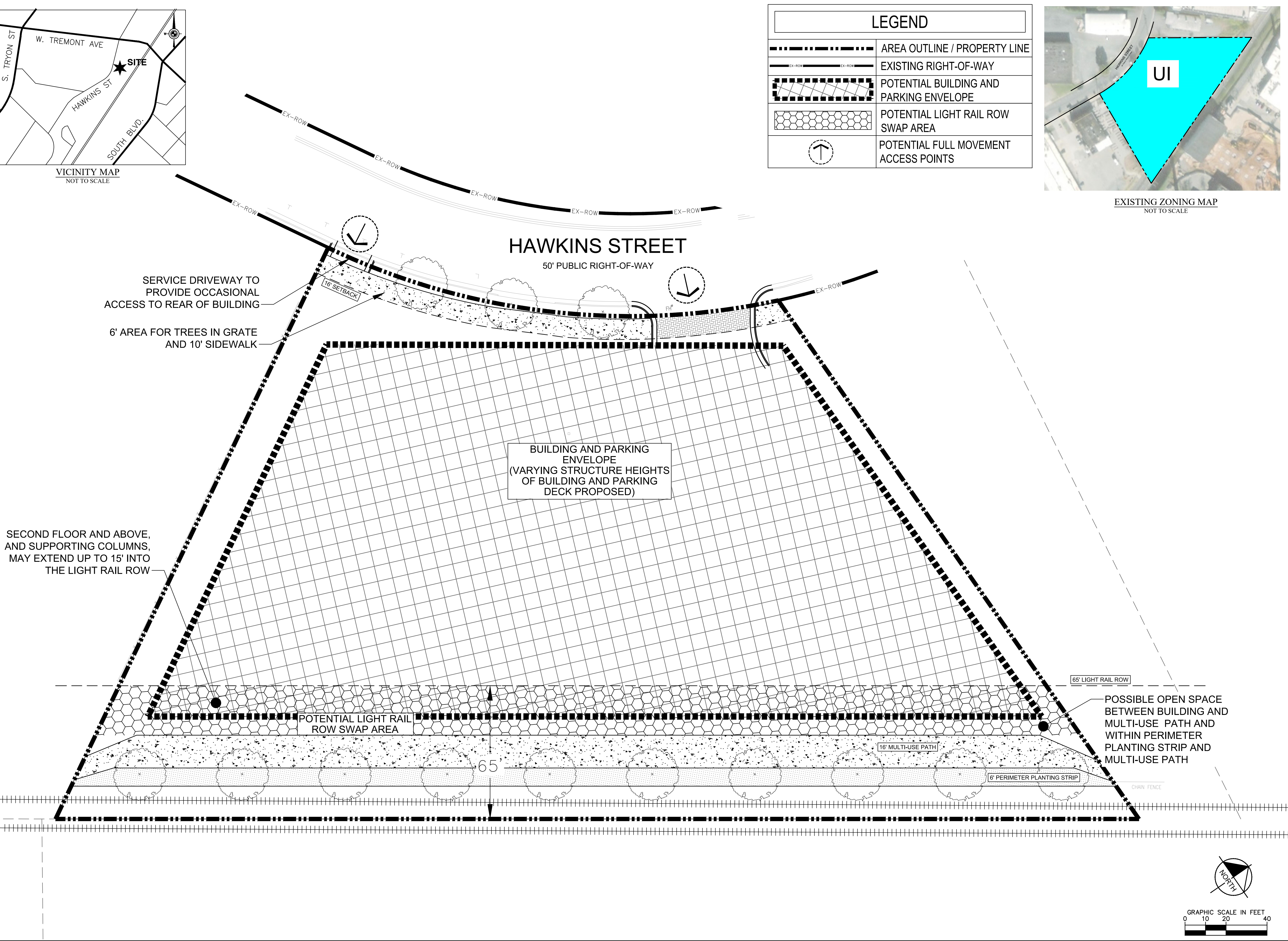

LEGEND	
	AREA OUTLINE / PROPERTY LINE
	EXISTING RIGHT-OF-WAY
	POTENTIAL BUILDING AND PARKING ENVELOPE
	POTENTIAL LIGHT RAIL ROW SWAP AREA
	POTENTIAL FULL MOVEMENT ACCESS POINTS

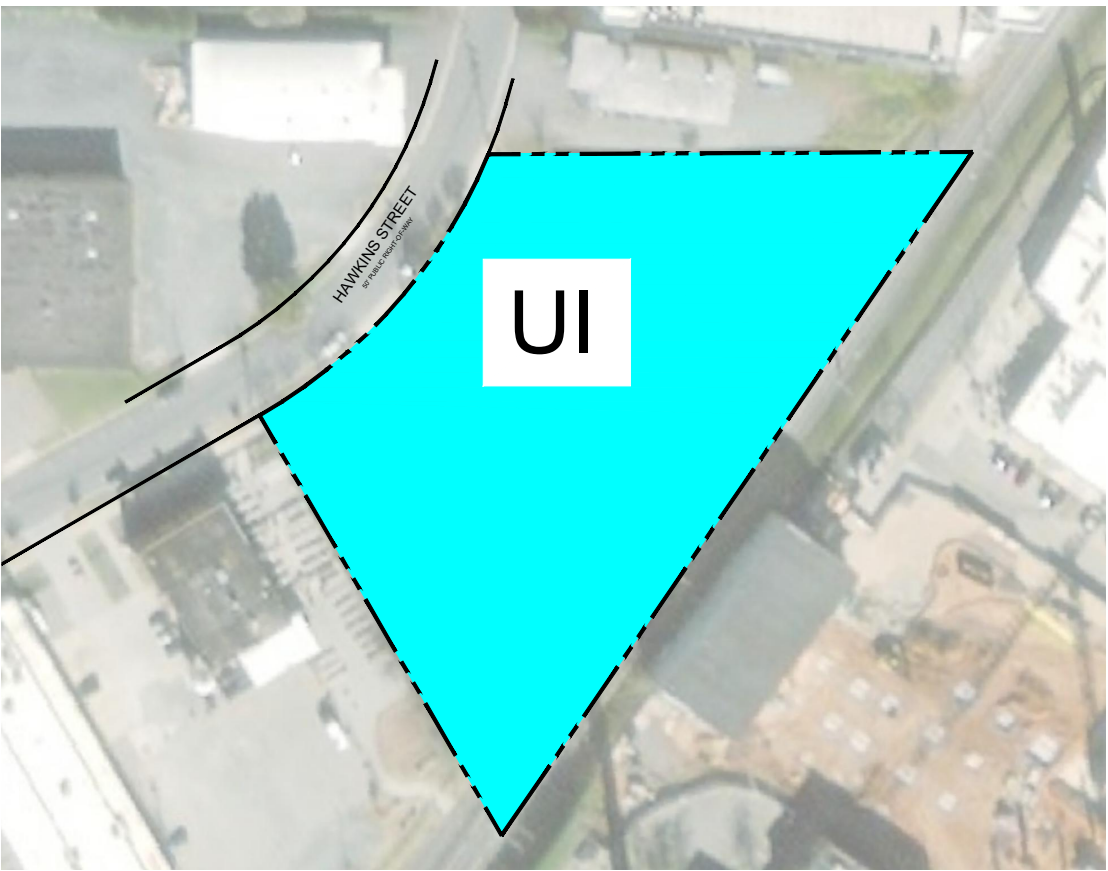

EXISTING ZONING MAP  
NOT TO SCALE

KHA PROJECT 01929011		DATE 2/25/2019	SCALE AS SHOWN	DESIGNED BY JH	DRAWN BY KS	CHECKED BY JH
PORTMAN SOUTHEND PREPARED FOR PORTMAN HOLDINGS		TECHNICAL DATA SHEET		PRELIMINARY DOCUMENT		
CITY OF CHARLOTTE		NORTH CAROLINA		Kimley»Horn		
SHEET NUMBER RZ - 1		REVISIONS		© 2019 KIMLEY-HORN AND ASSOCIATES, INC. 200 SOUTH TRYON STREET SUITE 200, CHARLOTTE, NC 28202 PHONE: 704-333-5131 WWW.KIMLEY-HORN.COM NC LICENSE #F-0102		
				No.		
				DATE		
				BY		

This document, together with the concepts and designs presented herein, as an instrument of service, is intended only for the specific purpose and client for which it was prepared. Reuse of and improper reliance on this document, without written authorization and adaptation by Kinney-Horn and Associates, shall be without liability to Kinney-Horn and Associates, Inc.

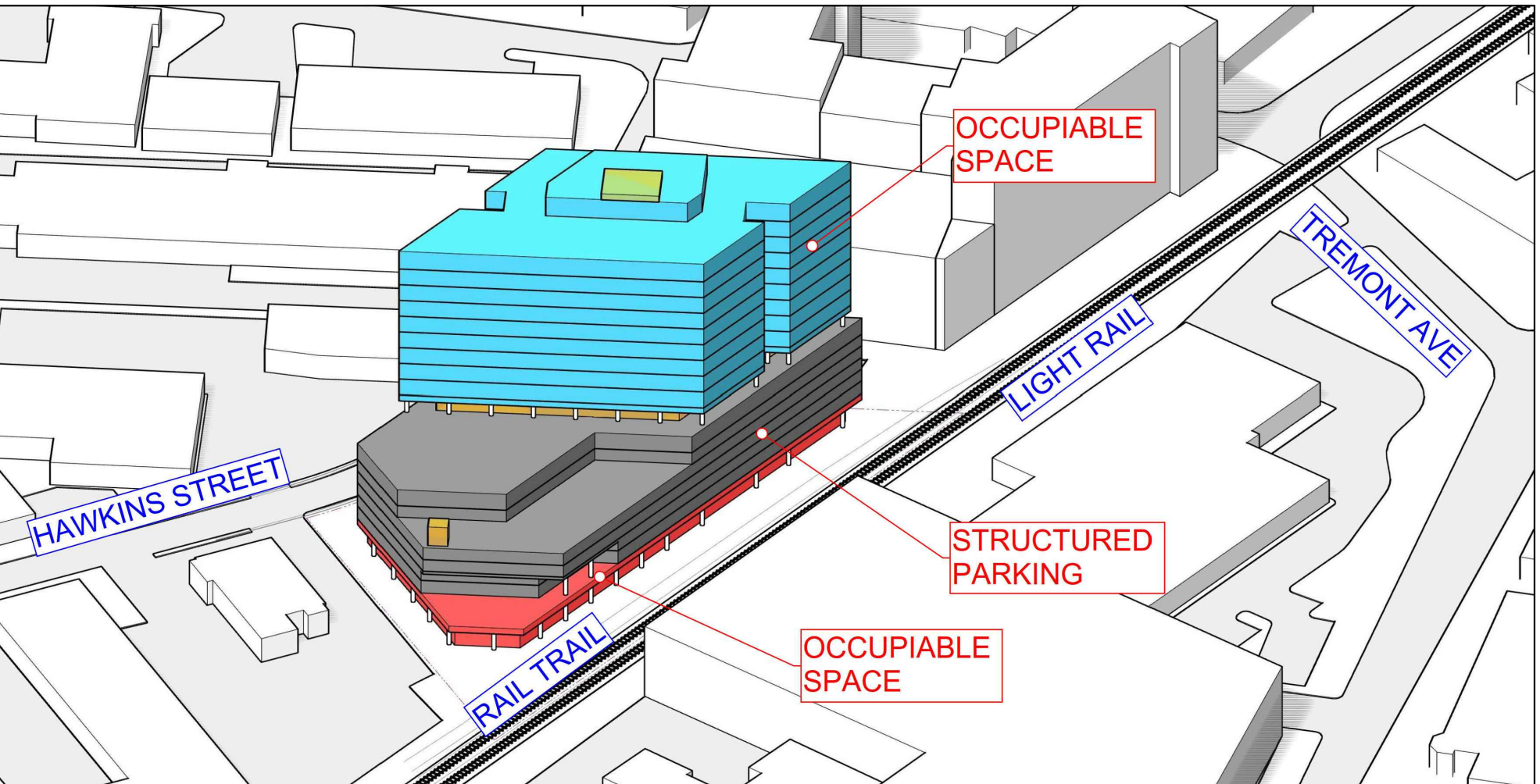
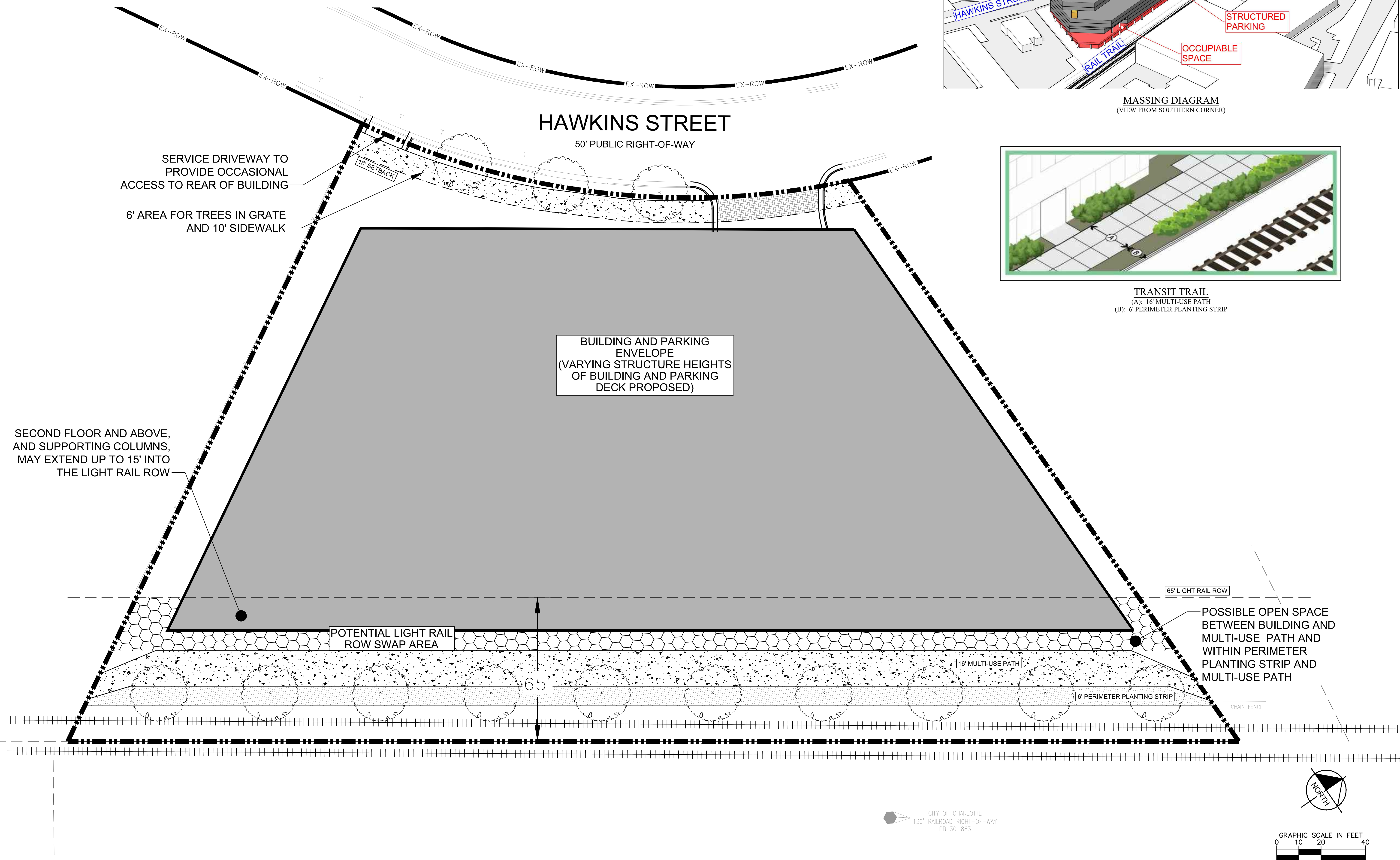

MASSING DIAGRAM  
VIEW FROM SOUTHERN CORNER

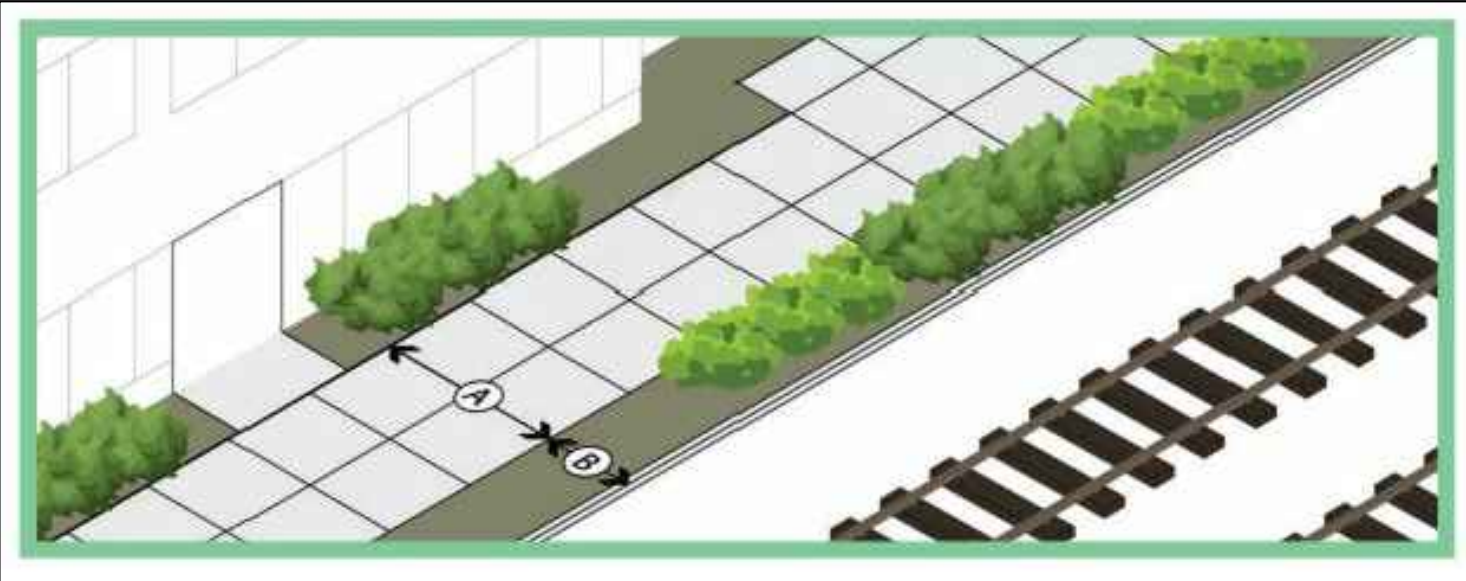

TRANSIT TRAIL  
(A): 16' MULTI-USE PATH  
(B): 6' PERIMETER PLANTING STRIP

[illegible]

**Kimley»»Horn**  
© 2019 KIMLEY-HORN AND ASSOCIATES, INC.  
2020 SOUTH TRYON STREET SUITE 200, CHARLOTTE, NC 28207  
PHONE: 704-333-5131  
WWW.KIMLEY-HORN.COM  
NC LICENSE #F-0102

PRELIMINARY  
DOCUMENT

KHA PROJECT 01929011	DATE 2/25/2019	SCALE AS SHOWN	JH
		DESIGNED BY	JH
		DRAWN BY	KS
		CHECKED BY	JH

# SITE PLAN

PORTMAN SOUTHBEND  
PREPARED FOR  
PORTMAN HOLDINGS  
OF CHARLOTTE NORTH CAROLINA

SHEET NUMBER  
**RZ - 2**

