

Petition #: **2015-101**

Petitioner: **Kolter Acquisitions, LLC**

Zoning Classification (Existing): **R-3, R-12MF, & B-1(CD)**

(Single Family, Residential; Multi-Family, Residential; and General Business, Conditional)

Zoning Classification (Requested): **NS 5-Year Vested Rights & MX-1(INNOV) 5-Year Vested Rights**

(Neighborhood Services, Five Year Vested Rights and Mixed Use, Innovative, Five Year Vested Rights)

Acreage & Location: Approximately 371 acres located on the northwest corner at the intersection of Rocky River Church Road and Albemarle Road.

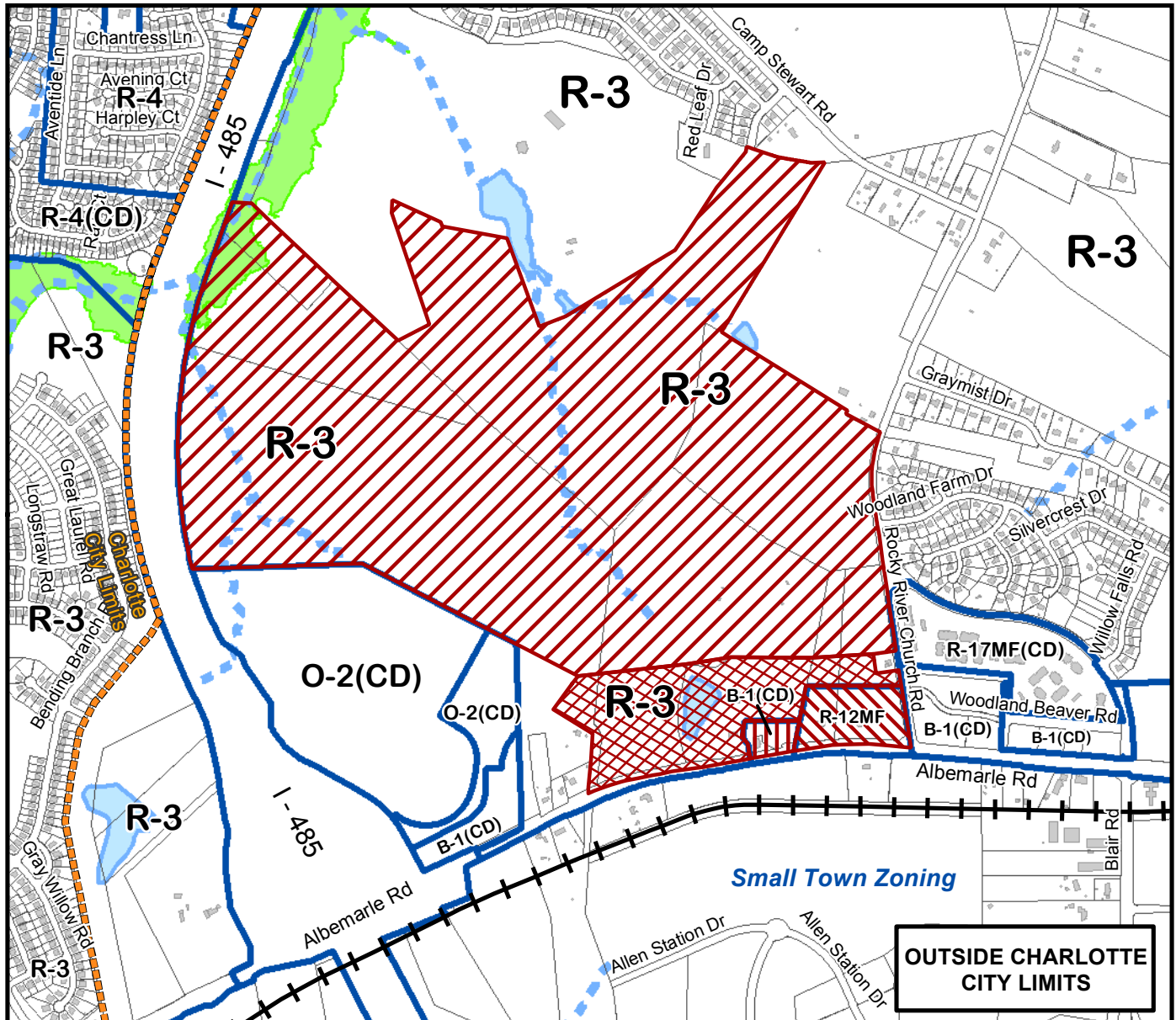

Map Produced by the Charlotte-Mecklenburg Planning Department, 6-29-2015.

0 400 800 1,600 2,400 3,200 Feet



Zoning Map #(s)

97

- Requested NS 5-Year Vested Rights from R-3
- Requested MX-1(INNOV) 5-Year Vested Rights from R-3
- Requested NS 5-Year Vested Rights from R-12MF
- Requested NS 5-Year Vested Rights from B-1(CD)

- Existing Building Footprints
- Existing Zoning Boundaries
- Charlotte City Limits
- Pedestrian Overlay

- FEMA flood plain
- Watershed
- Lakes and Ponds
- Creeks and Streams
- Historic District