

**MANDATORY REFERRAL REPORT NO. 00-14**  
**CHARLOTTE MECKLENBURG PLANNING COMMISSION**  
**ACQUISITION OF FLOODPLAIN PROPERTIES**  
**MARCH 21, 2000**

**PROJECT LOCATION**

The project is located in six Mecklenburg County Acquisition Project Areas: Andriell (11 parcels), Wellingford (17 parcels), Roslyn (13 parcels), Belmont (15 parcels), Whitehurst (10 parcels), and Westfield (50 parcels). (See Attached Map)

**PROJECT PROPOSAL**

This proposed project calls for the purchase of 116 parcels in flood prone areas and the demolition or removal of any improvements from the parcels using federal (Federal Emergency Management Administration Funds), state (a grant), and local funding as part of the Flood Hazard Mitigation Program.

**PROJECT JUSTIFICATION**

The Flood Hazard Mitigation Program will eliminate structures located in the flood plain. The program is voluntary. No person will be forced to sell his/her property. Once the property is purchased, it will then become greenway land and remain undeveloped.

**PROJECT IMPACT**

The purchase of these properties will eliminate the possibility of the subject properties ever being developed. The properties will become greenways or open space in the flood plain. The purpose of the Flood Hazard Mitigation Program is to protect land within the floodway from storm water or flooding related damages.

**RELATIONSHIP TO OTHER PUBLIC AND PRIVATE PROJECTS**

This project will provide open space in the flood plains.

**PROJECT COST**

Project will pay fair market value for the 116 parcels of property.

# Mecklenburg County Acquisition Project Areas

ANDRILL PROJECT AREA

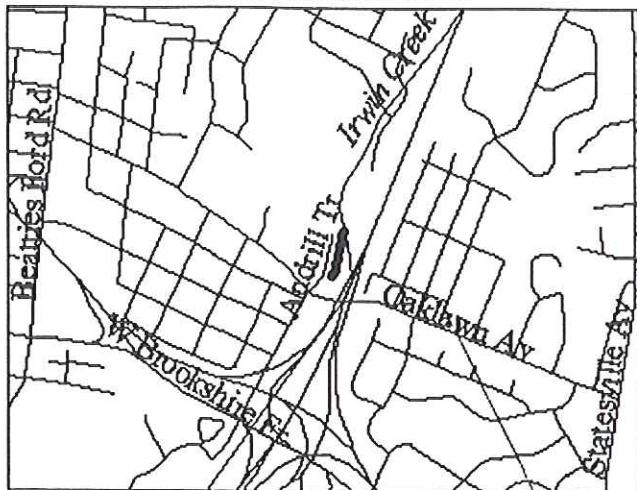

WELLINGFORD PROJECT AREA

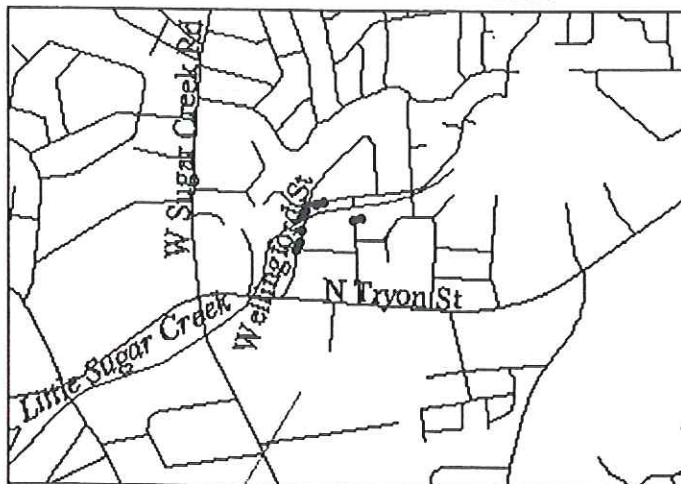

ROSLYN PROJECT AREA



BELMONT PROJECT AREA



WHITEHURST PROJECT AREA

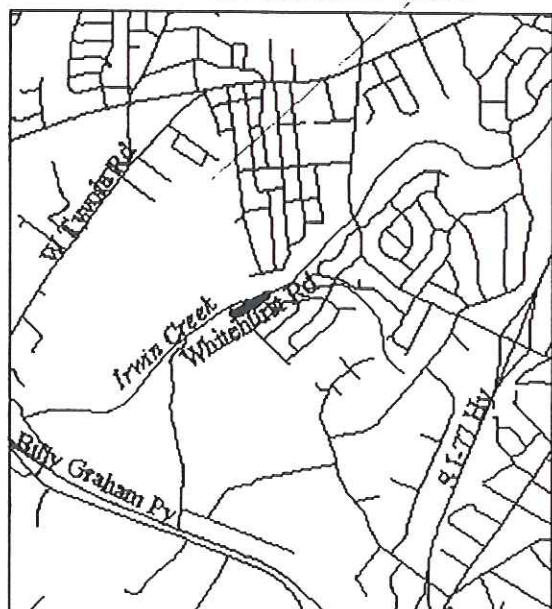

WESTFIELD PROJECT AREA





# MECKLENBURG COUNTY STORM WATER

## ACQUISITION/DEMOLITION ADDRESS LIST

1218 ABELINE RD	1012 ANDRILL TERRACE	3204 WESTFIELD RD
4000 WHITEHURST RD	1014 ANDRILL TERRACE	3208 WESTFIELD RD
4012 WHITEHURST RD	1016 ANDRILL TERRACE	3212 WESTFIELD RD
4018 WHITEHURST RD	1020 ANDRILL TERRACE	3216 WESTFIELD RD
4024 WHITEHURST RD	1024 ANDRILL TERRACE	3220 WESTFIELD RD
4030 WHITEHURST RD	1028 ANDRILL TERRACE	3224 WESTFIELD RD
4036 WHITEHURST RD	1032 ANDRILL TERRACE	3228 WESTFIELD RD
4100 WHITEHURST RD	1036 ANDRILL TERRACE	3232 WESTFIELD RD
4108 WHITEHURST RD	1040 ANDRILL TERRACE	3236 WESTFIELD RD
4114 WHITEHURST RD	1044 ANDRILL TERRACE	3240 WESTFIELD RD
	1048 ANDRILL TERRACE	3244 WESTFIELD RD
		3248 WESTFIELD RD
223 MELLOW DR		3252 WESTFIELD RD
224 MELLOW DR	2429 ROSLYN AV	3300 WESTFIELD RD
4508 SPRING VIEW RD	2525 ROSLYN AV	3304 WESTFIELD RD
141 WELLINGFORD ST	2533 ROSLYN AV	3308 WESTFIELD RD
145 WELLINGFORD ST	2537 ROSLYN AV	3312 WESTFIELD RD
149 WELLINGFORD ST	2601 ROSLYN AV	3316 WESTFIELD RD
201 WELLINGFORD ST	2605 ROSLYN AV	3320 WESTFIELD RD
205 WELLINGFORD ST	2609 ROSLYN AV	3324 WESTFIELD RD
209 WELLINGFORD ST	2613 ROSLYN AV	3328 WESTFIELD RD
213 WELLINGFORD ST	2617 ROSLYN AV	3332 WESTFIELD RD
217 WELLINGFORD ST	2621 ROSLYN AV	3336 WESTFIELD RD
228 WELLINGFORD ST	2625 ROSLYN AV	3340 WESTFIELD RD
229 WELLINGFORD ST	2629 ROSLYN AV	3344 WESTFIELD RD
233 WELLINGFORD ST	2633 ROSLYN AV	3348 WESTFIELD RD
237 WELLINGFORD ST		3352 WESTFIELD RD
240 WELLINGFORD ST		3356 WESTFIELD RD
243 WELLINGFORD ST		3401 CAROWILL CR
	2832 WESTFIELD RD	1456 DEVON DR
728 BELMONT AV	2836 WESTFIELD RD	1630 GENEVA CT
729 BELMONT AV	2900 WESTFIELD RD	2826/2828 IRBY DR
1005 EVENINGSIDE DR	2906 WESTFIELD RD	2832/2834 IRBY DR
1009 EVENINGSIDE DR	2910 WESTFIELD RD	1463 TOWNES RD
1013 EVENINGSIDE DR	2914 WESTFIELD RD	
1017 EVENINGSIDE DR	2920 WESTFIELD RD	
1025 EVENINGSIDE DR	2926 WESTFIELD RD	
631 EAST 15TH ST	2932 WESTFIELD RD	
705 EAST 15TH ST	2936 WESTFIELD RD	
713 EAST 15TH ST	3000 WESTFIELD RD	
717 EAST 15TH ST	3014 WESTFIELD RD	
1313 N. ALEXANDER ST	3020 WESTFIELD RD	
1317 N. ALEXANDER ST	3026 WESTFIELD RD	
1321 N. ALEXANDER ST	3032 WESTFIELD RD	
1105 N. MYERS ST	3038 WESTFIELD RD	



**Mecklenburg County, NC Engineering and Building Standards  
Department of Mapping and GIS Services  
ZONING INTERFACE**

[Tax Parcel and Map Sheet Search](#)   [Road Interchange/Intersection Search](#)   [Market Analysis Search](#)

[Menu](#)

[Return to Full Map Extent](#)   [How to Use the System](#)   [Return to GIS Zoning Interface Homepage](#)

**Click on Map to Perform Operation.**

☐ Refresh Map   ☐ Pan   ☐ Zoom In   ☒ Zoom Out   Zoom Factor:    ☐ Identify

☐ Surveyor's Report

☐ Adjoining Owner's Report within    ☐ Measure    Label Parcels by:

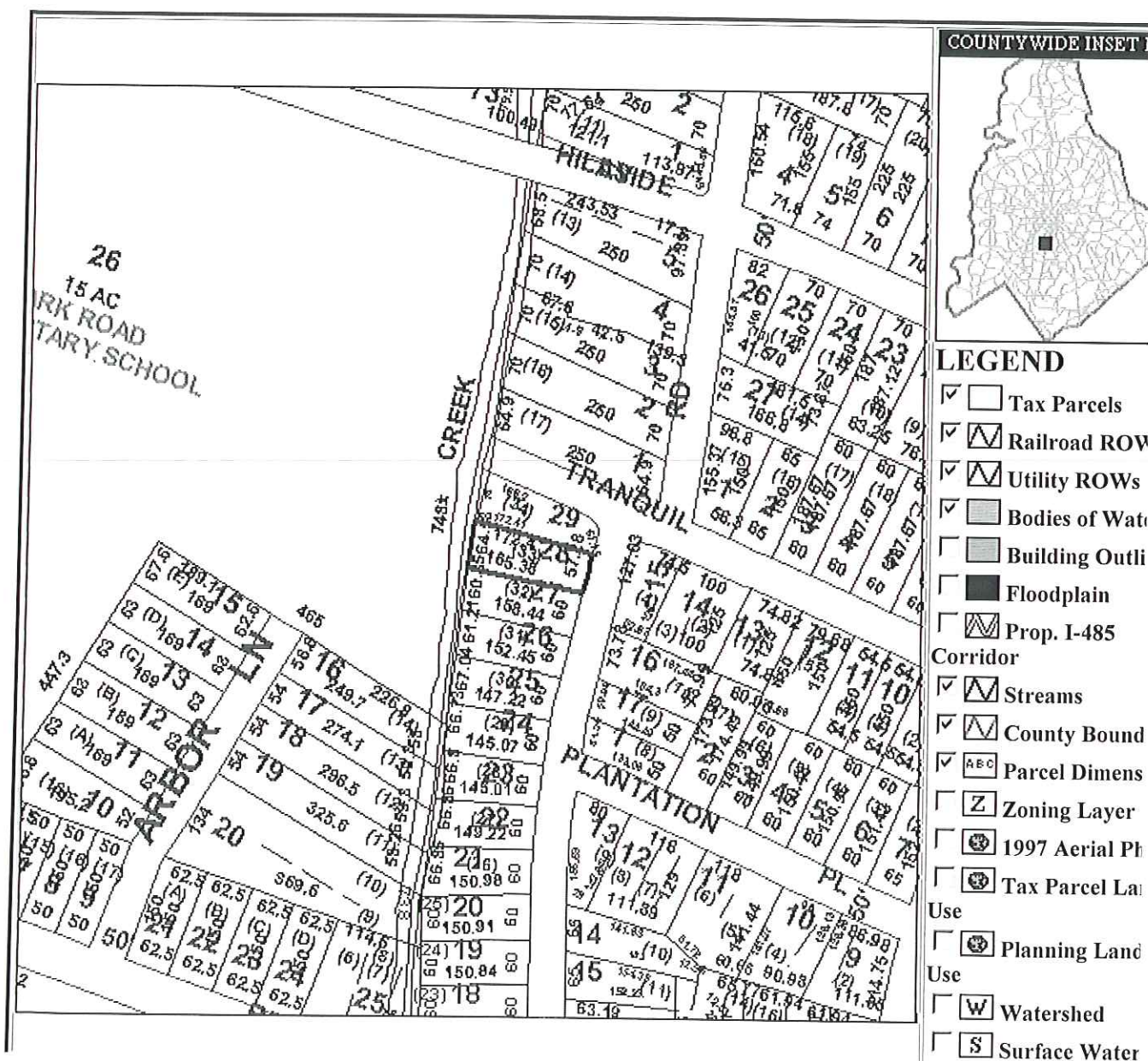

CAPITAL PROJECT PROPOSAL FORM

Instructions:

This form is provided to capital project initiating agencies and departments for reporting proposed projects to the Charlotte-Mecklenburg Planning Commission in accordance with the requirements of North Carolina House Bill 855.

Proposed capital projects are to be submitted to the Planning Commission using this form, at least 30 days prior to presenting the project to the governmental unit having authority to authorize it.

In order to constructively review a project proposal a full description of the project and its objectives is necessary. Please provide all of the information requested and all available graphic information. You will be advised when the project is scheduled for Planning Commission consideration so that your department representative may be present to respond to questions.

I. Initiating Department County Engineering & Building Standards Date 2/25/00

Submitted By Robert F. Binford

Department Representative Robert F. Binford

II. Project Name Floodplain Property Acquisition

Location and Description of Project 116 parcels of property in flood prone areas (see attached maps) to be purchased and building demolished or removed from property using federal, state, local funding as a part of the Flood Hazard Mitigation Program.

III. Project Justification/Need These structures and properties have been flooded and are in the various flood plains. This program will eliminate then from flooding . This is the full project discussed in Mandatory Refarral 99-15.



IV. Project Status (check those that apply).

Nothing done but this report	<u>          </u>	Land Not yet acquired	<u>  X  </u>
Preliminary plans completed	<u>  X  </u>	Land acquisition underway	<u>          </u>
Detailed plans completed	<u>          </u>	Land acquired	<u>          </u>
No land acquisition involved	<u>          </u>	Project under contract	<u>          </u>

V. Proposed Development Schedule

	<u>Begin</u>	<u>Completed</u>
Planning	FY 99-00	FY 99-00
Land	FY 99-00	FY 00-01
Construction	FY 00-01	FY 00-01

(Identify any known external factors which are critical to the timing of this project. For example, the opening of a major shopping center, or construction of a new school).

VI. Relation of this proposal to Other Public Projects. (Is this project part of a series of interrelated capital projects? Is the project affected by or does it affect other public projects in the area? This will provide

open space in flood plains.

VII. Project Cost Estimate - (indicate the estimated total project cost and describe how this estimation has been made). Project will pay fair market  
value for property.

VIII. Assistance Funds - (If State or Federal assistance funds are proposed indicate the specific assistance program, and the status of any application for project funding assistance). Federal Emergency Management Administration funds and a state grant.

### **STAFF RECOMMENDATION**

Staff recommends approval of the purchase of the 116 parcels of land for the purpose of flood mitigation.

### **PLANNING COMMITTEE RECOMMENDATION**

At the March 21, 2000 meeting, the Planning Committee unanimously approved Mandatory Referral No. 00-14 for the purchase of 116 parcels under the Flood Hazard Mitigation Program.

. . .