



## CHARLOTTE HISTORIC DISTRICT COMMISSION

### CERTIFICATE OF APPROPRIATENESS

**CERTIFICATE NUMBER:** HDCADMRM-2019-00493

**DATE:** 23 August 2019

**ADDRESS OF PROPERTY:** 2300 Dilworth Rd W

**HISTORIC DISTRICT:** Dilworth

**TAX PARCEL NUMBER:** 12112413

**OWNER/APPLICANT:** Janet Caffray

**DETAILS OF APPROVED PROJECT:** Tree Replanting. This project is a tree replanting to replace a decaying, hazardous tree per the Certified Arborist report. A new tree will be selected from the approved plant species, large maturing canopy tree list as outlined in the Charlotte Land Development Standards Manual (CLDSM) and included in the attached exhibit. The replacement tree should be approximately 2"-3" caliper in size and planted during the next replanting season. See attached exhibit labeled 'Site Plan- August 2019'.

1. Applicable Policy & Design Guidelines and Approval Authority – Projects Eligible for Administrative Approval, page 2.6: Landscape and Site Features.
2. The applicable Policy & Design Guidelines for Trees (page 8.5) have been met.

**Contact staff prior to making any changes to this approval. Any deviation from the work/materials approved in this COA may result in 1.) a Notice of Violation and Stop Work Order, and 2.) required removal or replacement to bring the work into compliance with this COA and the Charlotte Historic District Design Guidelines.**

- This Certificate of Appropriateness (COA) indicates that this project proposal has been determined to comply with the standards and policies of the Charlotte Historic District Commission.
- Display the blue COA placard in a visible location along with any required permits.
- No other approvals are to be inferred.
- No demolition other than that specifically indicated on any attached plans is authorized under this approval.
- All work must be completed in accordance with all other applicable state and local codes.
- Any changes from or additions or deletions to the plans referenced herein will void this Certificate, and a new application must be filed with the Historic District Commission.

**This Certificate is valid for a period of twelve (12) months from the date of issuance. Failure to obtain a building permit in that time will be considered as a failure to comply with the Certificate and the Certificate will become invalid. If a building permit is not required, then the approved work must be completed within twelve (12) months of the date of issuance of this Certificate. In either situation, the Certificate can be renewed for an additional twelve (12) months by Historic District Commission staff by written request within the first twelve (12) months from the date of issuance.**

  
James Haden, Chairman

  
Staff

# Site Plan - August 2019.



old tree  
location ←  
to the left  
and behind  
new tree  
location

APPROVED  
Charlotte  
Historic District  
Commission  
Certificate of Appropriateness  
#DCADM-2019-00493



## IV. APPROVED PLANT SPECIES

The following list of trees and shrubs represent the approved plant species that may be used to comply with code sections 12.302 and 12.303 of the City of Charlotte Zoning Ordinance and Chapter 21 ("Tree Ordinance") of the City of Charlotte Code.

### Other species may be allowed with staff approval

List subject to change

\* - Not allowed for required city planting.

\*\* - Not recommended for required city planting.

† - Cultivars under 15' tall only.

‡ - Trees <25' mature height can be planted directly under power lines.

Trees 25'- 40' mature height can be planted at least 20' from power lines.



HDCADM-2019-00493

### Trees

Common Name	Scientific Name	City Tree Ordinance Approved	CIP/ROW Approved	City Zoning Approved (Large or Small Maturing)	Duke Transmission Zone(T) or Distribution line(D) Approved	Shade Tolerant	Tolerates Poor Drainage	Native	Blooming	Foliage (Deciduous, Semi-deciduous, or Evergreen)
<b>LARGE MATURING (50'+ H)</b>										
Arborvitae, 'Green Giant'	Thuja 'Green Giant'		X							E
Ash, Green	Fraxinus pennsylvanica			L		X		X		D
Ash, White	Fraxinus americana	X		L				X		D
Baldcypress	Taxodium distichum	X	X	L			X	X		D
Beech, American	Fagus grandiflora	X	X	L				X		D
Birch, River	Betula nigra	X	X	L		X	X	X		D
Black Gum	Nyssa sylvatica	X	X	L				X		D
Cedar, Deodar	Cedrus deodara	X	X	L						E
Cedar, Eastern Red	Juniperus virginiana		X	L				X		E
Cryptomeria, Japanese	Cryptomeria japonica	X	X				X			E

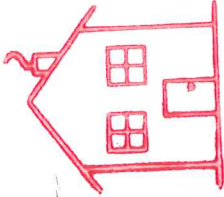

APPROVED

Charlotte  
Historic District  
Commission

Certificate of Appropriateness

HDCADM-2019-00493

## Trees

Common Name	Scientific Name	City Tree Ordinance Approved	CIP/ROW Approved	City Zoning Approved (Large or Small Maturing)	Duke Transmission Zone (T) or Distribution line (D) Approved	Shade Tolerant	Tolerates Poor Drainage	Native	Blooming	Foliage (Deciduous, Semi-deciduous, or Evergreen)
LARGE MATURING (50'+ H) cont...										
Dawn Redwood	Metasequoia glyptostroboides	X	X							S
Elm, Princeton	Ulmus americana 'Princeton'		X							D
Elm, Lacebark	Ulmus parvifolia	X	X	L		X	X			D
Ginkgo ♯	Ginkgo biloba	X	X	L		X	X			D
Hackberry, Common	Celtis occidentalis	X		L		X	X	X		D
Hackberry, Sugar	Celtis laevigata	X				X	X	X		D
Hemlock, Eastern	Tsuga canadensis			L		X		X		E
Hickory, Bitternut	Carya cordiformis			L				X		D
Hickory, Pignut	Carya glabra			L				X		E
Hickory, Shagbark	Carya ovata			L				X		E
Holly, American	Ilex opaca	X	X	S		X		X		E
Honeylocust, Shademaster**	Gleditsia tricanthos inermis 'Shademaster'							X		D
Hornbeam, European	Carpinus betulus	X	X	S		X	X			D
Kentucky Coffeetree	Gymnocladus dioica	X	X			X		X		D
Linden, Little Leaf	Tilia cordata	X				X	X		X	D
Magnolia, Cucumber	Magnolia acuminata		X					X	X	D
Magnolia, Southern	Magnolia grandiflora	X	X	L			X	X	X	E
Maple, Freeman	Acer x fremanii	X	X			X		X		D
Maple, Red *	Acer rubrum		X	L		X	X	X		D
Maple, Sugar	Acer saccharum	X	X	L		X		X		D
Oak, Black	Quercus velutina			L		X		X		D
Oak, Fastigiante English	Quercus robur 'Fastigiata'		X							D



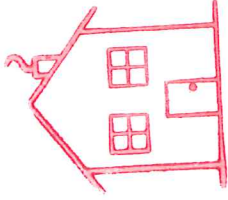

Charlotte  
Historic District  
Commission

Certificate of Appropriateness

# HOC ADM 2019-00493

## Trees

Common Name	Scientific Name	City Tree Ordinance Approved	CIP/ROW Approved	City Zoning Approved (Large or Small Maturing)	Duke Transmission Zone (T) or Distribution line (D) Approved	Shade Tolerant	Tolerates Poor Drainage	Native	Blooming	Foliage (Deciduous, Semi-deciduous, or Evergreen)
LARGE MATURING (50'+ H) cont...										
Oak, Laurel	Quercus laurifolia	X		L		X		X		D
Oak, Live	Quercus virginiana	X	X	L		X	X	X		E
Oak, Northern Red*	Quercus rubra			L		X		X		D
Oak, Nuttall	Quercus nuttallii	X	X			X		X		D
Oak, Overcup	Quercus lyrata	X	X			X	X	X		D
Oak, Scarlet**	Quercus coccinea			L				X		D
Oak, Shumard	Quercus shumardii	X	X	L		X		X		D
Oak, Southern Red	Quercus falcata	X	X	L		X		X		D
Oak, Swamp White	Quercus bicolor		X	L		X	X	X		D
Oak, Water	Quercus nigra		X	L			X	X		D
Oak, White	Quercus alba		X	L		X		X		D
Oak, Willow	Quercus phellos	X	X	L		X	X	X		D
Pecan	Carya illinoensis			L				X		D
Persimmon	Diospyros virginiana			L		X		X		D
Pine, Austrian	Pinus nigra	X		L			X			E
Pine, Japanese Black	Pinus thunbergi			L						E
Pine, Loblolly	Pinus taeda	X	X	L			X	X		E
Pine, Shortleaf	Pinus echinata		X	L				X		E
Pine, Virginia	Pinus virginiana	X	X	L				X		E
Poplar, Tulip	Liriodendron tulipifera	X	X	L		X	X	X	X	D
Sweetgum, Fruitless	Liquidambar styraciflua 'Rotundiloba'	X	X	L		X	X	X		D
Sweetgum, Slender	Liquidambar styraciflua 'Slender Silhouette'		X			X	X	X		D
Zelkova, Japanese *	Zelkova serrata			L		X				D