LOCAL HISTORIC DISTRICT: Dilworth

PROPERTY ADDRESS: 723 East Worthington Avenue

SUMMARY OF REQUEST: Replacement windows

APPLICANT: Edward Vinson

The application was continued for 1) Drawings or a physical mockup with head jamb details with historic trim and a sample of the putty profile sash, 2) Details of the existing construction for comparison

Details of Proposed Request

Existing Conditions

The existing structure is a 1.5 story house constructed in 1925 and listed as a contributing structure in the Dilworth Register of Historic Places. The house is further described as having a cross gable roof with exposed rafters and decorative joists. Engaged porch with side plain frieze on short posts on high piers.

Project

The project is replacement windows around the house. The window type is Renewal by Andersen. The window material is described as "Fibrex, which is made of reclaimed wood fiber and PVC polymer that is fused together." This new window material has not been reviewed by the HDC. The window patterns would be consistent with the original windows. There are 16 windows to be replaced in their original openings. The HDC will determine if the window materials and trim meet the guidelines.

Design Guidelines –Replacement Windows, page 4.14

18. Give depth and profile to windows by using true divided lights, or three-part simulated divided lights with integral spacer bars and interior and exterior fixed muntins. Small variations such as the width and depth of the muntin and sash may be permitted if those variations do not significantly impact the historic characteristics of the window design. Clip-in/false muntins, flat muntins and removable external grilles are not allowed.
19. Replace a wood window with a wood window when possible. Wood-resin composite, aluminum clad wood, or fiberglass windows that meet these guidelines may be considered on a case by-case basis. Requests for vinyl windows must be reviewed by the full Historic District Commission.

Staff Analysis – This application was submitted June 1, 2017. November 8, 2017 is the 6th month. Per HDC procedures a decision must be rendered this month to approve or deny the application. Staff recommends denial of the application.

This application was continued from October for the following:

- **Drawings or a physical mockup with head jamb details with historic trim and a sample of the putty profile sash**
- **Details of the existing construction for comparison**

Charlotte Historic District Commission Case 2017-404
HISTORIC DISTRICT: DILWORTH
WINDOW REPLACEMENT

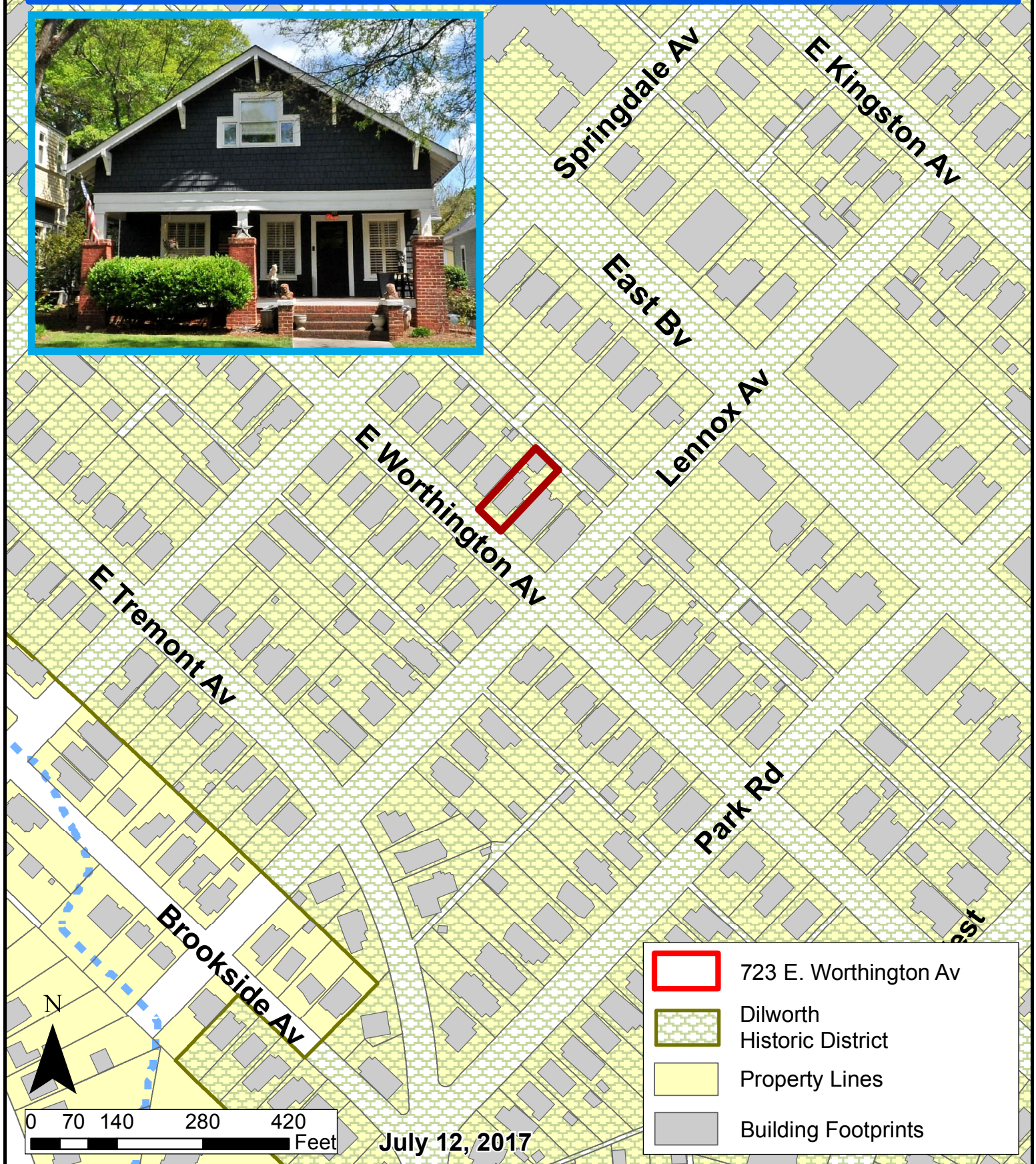



Double-Hung WINDOWS

This classic window style is an excellent choice no matter where you live. Choose gently curved Contemporary or squared **Traditional Check Rails.**

CONVENIENT

Easy cleaning from the inside.



Double-Hung
Equal Window



Double-Hung
Cottage Style
Window



Double-Hung
Reverse Cottage
Style Window
(Oniel)

EXPRESS
YOUR
STYLE

Check Rail Options



Contemporary



Traditional

ELEGANT

Traditional look of mortise-and-tenon styling.



ACCURATE

Appropriate for restoration and renovation projects.

Reverse cottage style windows feature larger upper sash

Choosing Renewal by Andersen Windows is Easy...

The Renewal by Andersen process starts with our consultative sales approach. Our experienced sales representatives will work with you to find solutions to enhance your home's functionality, energy efficiency and beauty.

1

Select Window Styles



Double-Hung
Window
PAGE 8



Casement
Window
PAGE 10

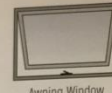

Awning Window
PAGE 10



Gliding Window
PAGE 12



Picture Window
PAGE 14



Specialty Window
PAGE 16

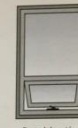

Combination
Window
PAGE 14 & 16

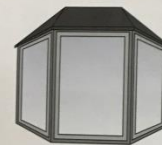

Bay Window
PAGE 18



Bow Window
PAGE 18

2

Select Colors²

INTERIOR



Real Maple



Real Pine



Real Oak

INTERIOR/EXTERIOR



White



Canvas



Sandtone



Terratone

EXTERIOR



Cocoa Bean



Dark Bronze



Black



Forest Green



Red Rock

Real wood interiors can be stained or painted to match your decor

Grille OPTIONS

Customize Your Windows

Renewal by Andersen offers a wide range of creative grille patterns to enhance the look of your home.

All of our grilles are designed to be long-lasting with low-maintenance performance. With such a broad range of high-profile grille options, you can match your home's current architecture, change the look and style of your home, or incorporate them into a renovation project for historical accuracy.

Patterns



Colonial
Specific number of squares per sash.



Farmhouse
Two vertical bars meet a wider horizontal rail or bar at the center of the window.



Prairie
Two vertical and two horizontal bars per sash to form 4 inch corner squares.



Modified Prairie
Two vertical bars and one horizontal bar per sash.



Simulated Double-Hung
Preserve the look of a traditional window.

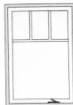

Fractional
Specific number of vertical bars and horizontal bars.



Equal Light
Specified number of horizontal bars, equal distance apart.



Custom
Create a new pattern, revive one from the past.



More
Ask your replacement consultant for more grille options.



Colonial and Double-Hung Windows / White Exterior / Colonial Grilles



Picture Windows / Pine Interior / Colonial Grilles



profiles

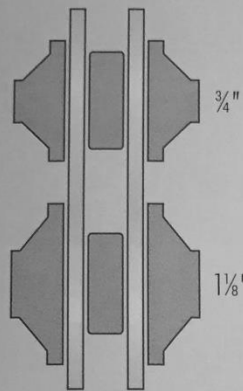
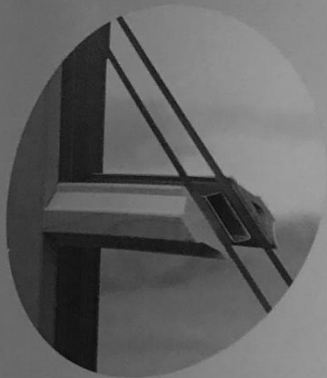

Full Divided Light Grilles

Full divided light grilles provide a visual representation of true divided glass. The option consists of a permanently applied exterior Fibrex® material grille, an aluminum spacer between the glass, and a removable or permanently applied interior grille. Available in two widths and an array of colors.

PERMANENT

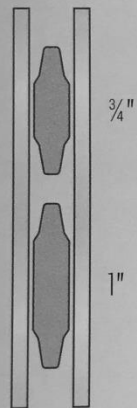

Grilles Between-the-Glass

Aluminum grilles are permanently installed between the panes during manufacturing, providing the beauty of grilles with the quick cleaning of a smooth glass surface. Available in two widths and an array of colors.

REMOVABLE

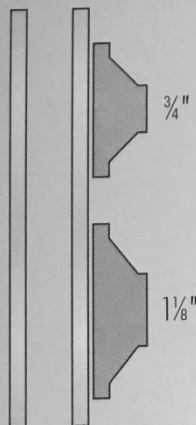

Interior Wood Grilles

Made of hardwood, these grilles snap into clips on the interior of the sash and can be easily removed to make glass cleaning a breeze. Available in two widths.

→ **Renewal**
by Andersen.
WINDOW REPLACEMENT an Andersen Company











Itemized Order Receipt

dba: Mr. Rogers Windows
Legal Name: Ethix Corporation
2705076120

1019 Eden Way N Chesapeake, Va 23320 | 2430 Whitehall Park Drive Charlotte, NC 28273
Phone: VA: 757-436-2200 CH: 704-909-2400 | Fax: 757-548-1323 | contracts@mrrogerswindows.com

Edward Vinson III and Kathy Vinson
723 E Worthington Ave
Charlotte, NC 28203
H: (704) 534-1377

ID#:	ROOM:	DETAILS:
104	Office	Window: Double-Hung, Equal, Slope Sill Insert, Traditional Checkrail, EXTERIOR White, INTERIOR White, Glass: Sash All: High Performance SmartSun Glass, No Pattern, Hardware: White, Screen: Fiberglass, Full Screen, Grille Style: Full Divided Light (FDL with spacer), Grille Pattern: Sash 1: Colonial 3w x 2h, Sash 2: No Grilles, Misc: Non
105	Bath	Window: Double-Hung, Equal, Slope Sill Insert, Traditional Checkrail, EXTERIOR White, INTERIOR White, Glass: Sash All: High Performance SmartSun Glass, No Pattern, Hardware: White, Screen: Fiberglass, Full Screen, Grille Style: Full Divided Light (FDL with spacer), Grille Pattern: Sash 1: Colonial 3w x 2h, Sash 2: No Grilles, Misc: Non
106	Printer	Window: Double-Hung, Equal, Slope Sill Insert, Traditional Checkrail, EXTERIOR White, INTERIOR White, Glass: Sash All: High Performance SmartSun Glass, No Pattern, Hardware: White, Screen: Fiberglass, Full Screen, Grille Style: Full Divided Light (FDL with spacer), Grille Pattern: Sash 1: Colonial 3w x 2h, Sash 2: No Grilles, Misc: Non
107	Living	Window: Double-Hung, Equal, Slope Sill Insert, Traditional Checkrail, EXTERIOR White, INTERIOR White, Glass: Sash All: High Performance SmartSun Glass, No Pattern, Hardware: White, Screen: Fiberglass, Full Screen, Grille Style: Full Divided Light (FDL with spacer), Grille Pattern: Sash 1: Colonial 3w x 2h, Sash 2: No Grilles, Misc: Non



Itemized Order Receipt

dba: Mr. Rogers Windows
Legal Name: Ethix Corporation
2705076120

1019 Eden Way N Chesapeake, Va 23320 | 2430 Whitehall Park Drive Charlotte, NC 28273
Phone: VA: 757-436-2200 CH: 704-909-2400 | Fax: 757-548-1323 | contracts@mrrogerswindows.com

Edward Vinson III and Kathy Vinson
723 E Worthington Ave
Charlotte, NC 28203
H: (704) 534-1377

ID#:	ROOM:	DETAILS:
108	Living	Window: Double-Hung, Equal, Slope Sill Insert, Traditional Checkrail, EXTERIOR White, INTERIOR White, Glass: Sash All: High Performance SmartSun Glass, No Pattern, Hardware: White, Screen: Fiberglass, Full Screen, Grille Style: Full Divided Light (FDL with spacer), Grille Pattern: Sash 1: Colonial 3w x 2h, Sash 2: No Grilles, Misc: Non
109	Living	Window: Double-Hung, Equal, Slope Sill Insert, Traditional Checkrail, EXTERIOR White, INTERIOR White, Glass: Sash All: High Performance SmartSun Glass, No Pattern, Hardware: White, Screen: Fiberglass, Full Screen, Grille Style: Full Divided Light (FDL with spacer), Grille Pattern: Sash 1: Colonial 3w x 2h, Sash 2: No Grilles, Misc: Non
110	Dining	Window: Double-Hung, Equal, Slope Sill Insert, Traditional Checkrail, EXTERIOR White, INTERIOR White, Glass: Sash All: High Performance SmartSun Glass, No Pattern, Hardware: White, Screen: Fiberglass, Full Screen, Grille Style: Full Divided Light (FDL with spacer), Grille Pattern: Sash 1: Colonial 3w x 2h, Sash 2: No Grilles, Misc: Non
111	Dining	Window: Double-Hung, Equal, Slope Sill Insert, Traditional Checkrail, EXTERIOR White, INTERIOR White, Glass: Sash All: High Performance SmartSun Glass, No Pattern, Hardware: White, Screen: Fiberglass, Full Screen, Grille Style: Full Divided Light (FDL with spacer), Grille Pattern: Sash 1: Colonial 3w x 2h, Sash 2: No Grilles, Misc: Non



Itemized Order Receipt

dba: Mr. Rogers Windows
Legal Name: Ethix Corporation
2705076120

1019 Eden Way N Chesapeake, Va 23320 | 2430 Whitehall Park Drive Charlotte, NC 28273
Phone: VA: 757-436-2200 CH 704-909-2400 | Fax: 757-548-1323 | contracts@mrrogerswindows.com

Itemized Order Receipt
dba: Mr. Rogers Windows
Legal Name: Ethix Corporation
2705076120

Edward Vinson III and Kathy Vin
723 E Worthington Ave
Charlotte, NC 28203
H: (704) 534-1377

ID#: ROOM:

DETAILS:

112 Entry

Window: Double-Hung, Equal, Slope Sill Insert, Traditional Checkrail, EXTERIOR White, INTERIOR White, **Glass:** Sash All: High Performance SmartSun Glass, No Pattern, **Hardware:** White, **Screen:** Fiberglass, Full Screen, **Grille Style:** Full Divided Light (FDL with spacer), **Grille Pattern:** Sash 1: Colonial 3w x 2h, Sash 2: No Grilles, **Misc:** Non

113 Entry

Window: Double-Hung, Equal, Slope Sill Insert, Traditional Checkrail, EXTERIOR White, INTERIOR White, **Glass:** Sash All: High Performance SmartSun Glass, No Pattern, **Hardware:** White, **Screen:** Fiberglass, Full Screen, **Grille Style:** Full Divided Light (FDL with spacer), **Grille Pattern:** Sash 1: Colonial 3w x 2h, Sash 2: No Grilles, **Misc:** Non

201 Bed

Window: Fixed Window, Casement, Base Frame, EXTERIOR White, INTERIOR White, **Glass:** Sash All: High Performance SmartSun Glass, No Pattern, **Grille Style:** No Grilles, **Misc:** Non

202 Bed

Window: Double-Hung, Equal, Slope Sill Insert, Traditional Checkrail, EXTERIOR White, INTERIOR White, **Glass:** Sash All: High Performance SmartSun Glass, No Pattern, **Hardware:** White, **Screen:** Fiberglass, Full Screen, **Grille Style:** Full Divided Light (FDL with spacer), **Grille Pattern:** Sash 1: Colonial 3w x 2h, Sash 2: No Grilles, **Misc:** Non

203 Bed

Window: Fixed Window, Casement, Base Frame, EXTERIOR White, INTERIOR White, **Glass:** Sash All: High Performance SmartSun Glass, No Pattern, **Grille Style:** No Grilles, **Misc:** Non