



## CHARLOTTE HISTORIC DISTRICT COMMISSION

### CERTIFICATE OF APPROPRIATENESS

**CERTIFICATE NUMBER:** HDCADMRM 2016-163

**DATE:** August 23, 2018

**ADDRESS OF PROPERTY:** 618 Woodruff Place

**TAX PARCEL NUMBER:** 07103517

**HISTORIC DISTRICT:** Wesley Heights

**OWNER/APPLICANT:** Eugene Reed

**DETAILS OF APPROVED PROJECT:** The project is the repair of porch columns and landscape features including a retaining wall. See attached plans.

1. Applicable Policy & Design Guidelines and Approval Authority – Projects Eligible for Administrative Approval, page 2.6: Repair and maintenance, and landscape features.

- This Certificate of Appropriateness (COA) indicates that this project proposal has been determined to comply with the standards and policies of the Charlotte Historic District Commission.
- Display the blue COA placard in a visible location along with any required permits.
- No other approvals are to be inferred.
- No demolition other than that specifically indicated on any attached plans is authorized under this approval.
- All work must be completed in accordance with all other applicable state and local codes.
- Any changes from or additions or deletions to the plans referenced herein will void this Certificate, and a new application must be filed with the Historic District Commission.

This Certificate is valid for a period of twelve (12) months from the date of issuance. Failure to obtain a building permit in that time will be considered as a failure to comply with the Certificate and the Certificate will become invalid. If a building permit is not required, then the approved work must be completed within twelve (12) months of the date of issuance of this Certificate. In either situation, the Certificate can be renewed for an additional twelve (12) months by Historic District Commission staff by written request within the first twelve (12) months from the date of issuance.

James Haden, Chairman

Staff



APPROVED

Charlotte  
Historic District  
Commission

Certificate of Appropriateness

# 2016-163

618 Woodknuff Place  
Document # 27333

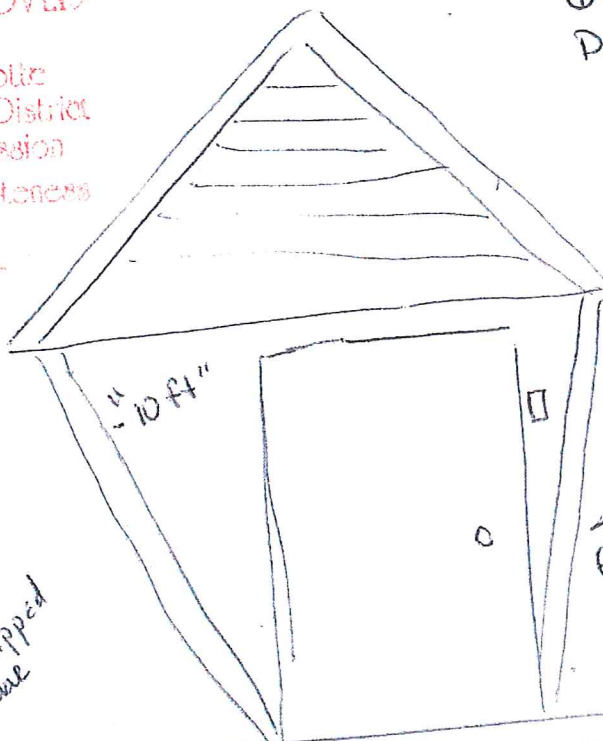

10 ft 4x4x10  
Column made of cedar 4x4x10

column will have a slant  
from front top to back of porch

pole  
pole wrapped  
in cedar

59 in  
Tall

Wall

porch

steps

Wall

Wall