LOCAL HISTORIC DISTRICT: Dilworth

PROPERTY ADDRESS: 2006 Dilworth Road East

SUMMARY OF REQUEST: Landscape features

APPLICANT: Doug Engel

The application was continued from June for accurately dimensioned drawings and lower walls and columns.

Details of Proposed Request

Existing Conditions

The existing site has a two story Colonial Revival home slightly elevated above the sidewalk and set back approximately 50 feet from the sidewalk. The existing walkway does not connect to the sidewalk.

Proposal

The proposal is a new walkway extending from the sidewalk to the house with new steps and columns.

Revised Proposal – July 8, 2015

The revised proposal includes accurately scaled drawings with lower cheek walls and columns along the public sidewalk. The plan also includes a cast iron water fountain and cast aluminum lamps on the brick columns.

Policy & Design Guidelines – Landscape and Site Features, page 60

1. Inspiration for the design of these structures should be drawn from similar historic structures found in the Local Historic District.
2. Not all landscape structures are appropriate for every lot in the Local Historic District; a retaining wall is not suitable for a flat lot.
3. Historic precedents indicate appropriate materials such as stone, brick and concrete.
4. Historic site features are considered integral parts of Local Historic District properties, and cannot be removed without the review of the HDC or its Staff.
5. Walks and walkways in front and side yards or those that are substantially visible from the street should follow the historic design precedents of their environment.
6. Certain modern materials for landscape and site features are not allowed without the approval of the Historic District Commission.
 - Interlocking concrete block
 - Treated landscaping timbers
 - Railroad ties
 - Pre-fabricated lattice

Staff Analysis

The Commission will determine if the proposal is complimentary to the context of the streetscape.

Charlotte Historic District Commission - Case 2015-097

Historic District; Dilworth

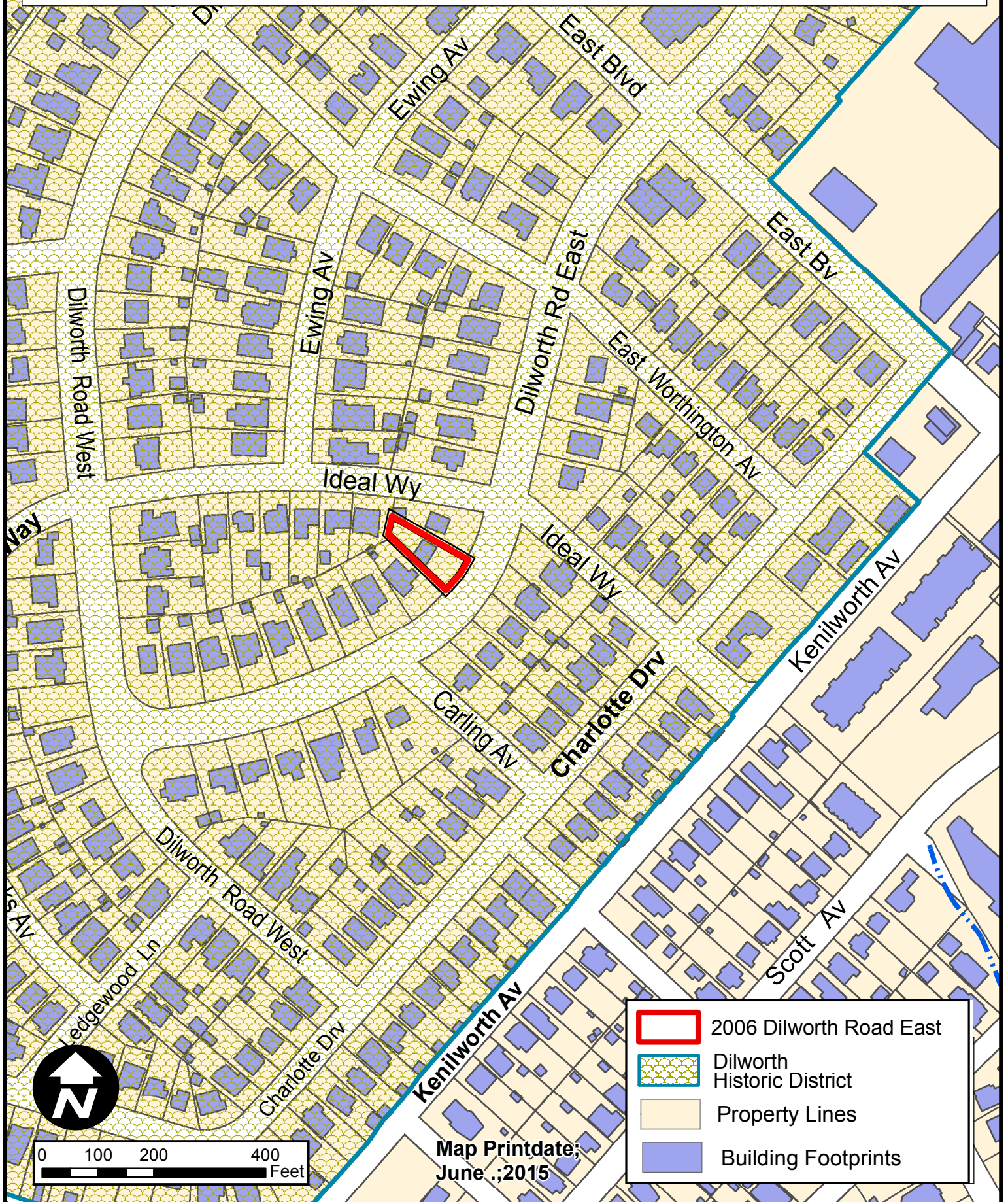



Halsey Taylor®
Satisfying Thirsts Since 1912

MODEL: ☐ 4520-68 (30") ☒ 4521-68 (36")



These fountains are certified to
NSF/ANSI 61.

GENERAL

Pedestal, cast iron closed base with forest green enamel finish for year-round beauty with minimum maintenance. Contour-formed basin with rounded corners and edges reduces splatter, insures proper drainage and prevents standing waste water. **Model 4520-68** is 30" high and **Model 4521-68** is 36" high

BUBBLER

Single-stream, self-closing, pushbutton operated with integral volume control for maintaining proper stream height. Also includes hood guard and anti-squirt feature.

AUTOMATIC STREAM HEIGHT REGULATOR

Self-closing assembly is located inside unit to prevent tampering. Unit resists corrosion and liming. A constant stream height is automatically maintained under line pressures that vary from 20 to 105 psi.

INLET STRAINER

Easily cleaned in-line strainer screen traps particles of 140 microns or larger before they enter the waterway.

WATER INLET

3/8" O.D. Tubing

DRAIN OUTLET

1-1/4" tube outlet for 1-1/4" slip joint connection.

SUGGESTED SPECIFICATIONS

Fountain shall include pushbutton on the front. Shall include contour-formed basin to eliminate splashing and standing water, and shall have rounded corners and edges. Projector shall be single-stream type with integral hood guard and anti-squirt feature. The manufacturer shall certify the unit to meet the requirements of NSF/ANSI 61, and the Safe Drinking Water Act.

Note: Continued product improvement makes specifications subject to change without notice. See Halsey Taylor website for most current spec sheet.

Cast Iron

Pedestal Fountain



Standard Finish is Forest Green enamel.

Each 4520-68 / 4521-68 consists of 1 carton of the following:

Fountain

Trap and service stop not included.

Shipping weight: 63 lbs.

JOB NAME: _____

ENGINEER/CONTRACTOR NAME: _____

APPROVAL: _____

DATE: _____

halseytaylor.com

HALSEY TAYLOR, 2222 CAMDEN COURT, OAK BROOK, ILLINOIS 60523



4520-68 (30"), 4521-68 (36")

Cast Iron Pedestal Fountains

(CONTINUED)

MOUNTING INSTRUCTIONS

- Provide solid, well-drained surface to mount fountain.
- Locate and install plumbing through ground as shown in rough-in.
Note: Fountain is not furnished with service valve.
- Locate three tripod mounting holes as shown on rough-in. Mounting bolts not furnished – $\frac{7}{16}$ " diameter holes provided in tripod.
- Remove set screw in side of tripod cover and raise cover to aid in positioning fountain over mounting holes. Support cover with blocking while making plumbing connections.
- Use unions to connect supply and waste lines.
- Anchor tripod to ground.
- Turn on water supply and check for water leaks.
- Lower tripod cover, align hole for set screw and tighten set screw into leg of tripod.
- Stream height is factory set at 45-50 psi.

Trap and service stop not included.

OPERATING PRESSURES:

Supply water- 20 psi minimum to 105 psi maximum.

4520-68 / 4521-68

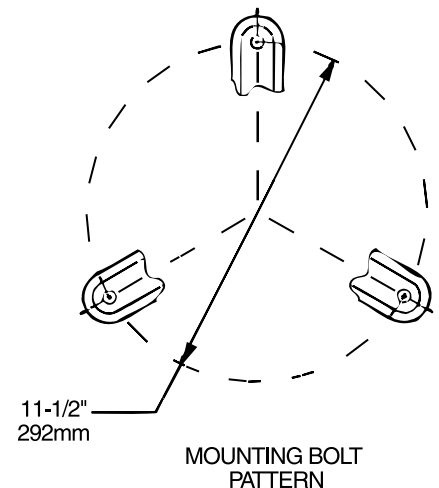
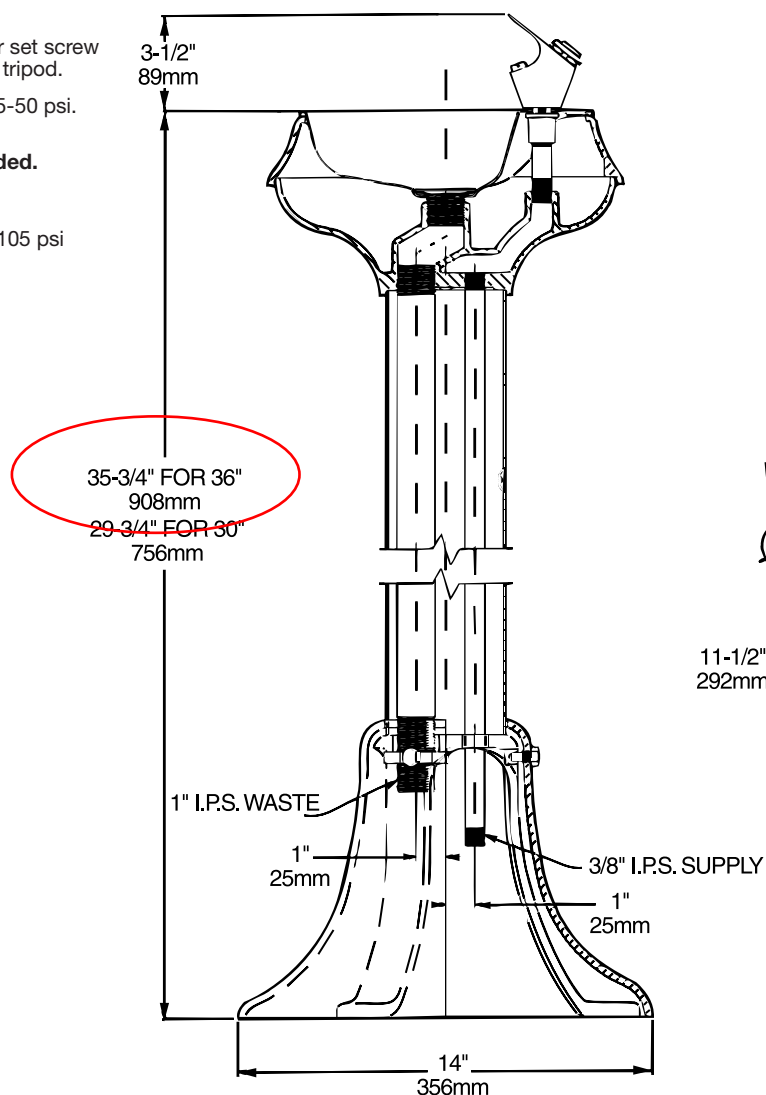

Halsey Taylor®

The Bavarian

Model 1200

Our Bavarian Lamp is a traditional, six-sided lamp that conveys European sophistication and solid functionality. Typical of central Europe's cobblestone villages, the Bavarian is one of our most flexible lamp designs. Its domed top is an ideal focal point for your choice of custom finials; and you may consider beveled panes to add a dash of sparkle.



Post Mount

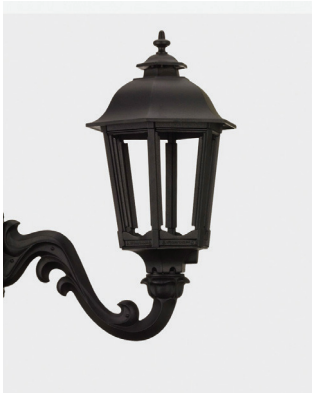

Wall Mount



Pier Mount
As shown with Bishop finial

The Bavarian

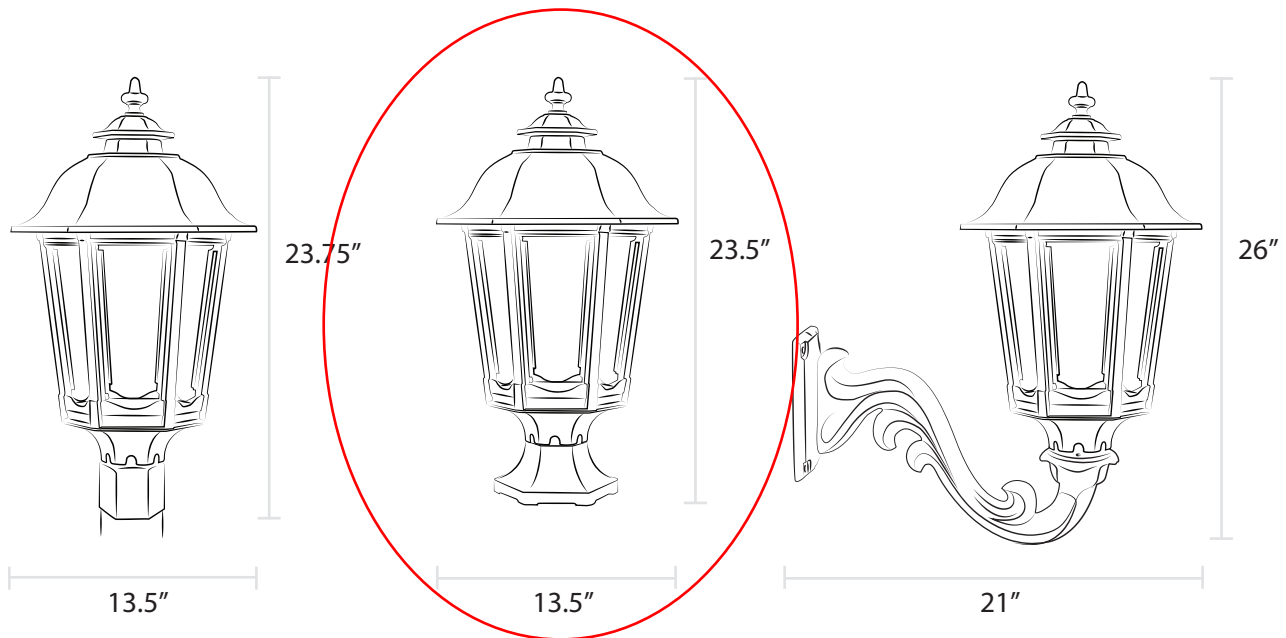

Product Overview:

- Sand cast aluminum
- CSA approved valve
- Flat tempered glass included; additional glass options available*
- Bishop finial included; decorative finials available*

Installation Options:

- Post mount fits standard 3" outside diameter post
- For wall mount, combine with our Six-Sided Decorative Bracket or Universal Bracket
- For pier mount, combine with our Small Six-Sided Pier Mount or Heritage Pier Mount

Illumination Options:



Mantle Gas



Open Flame Gas



GasGlow® LED*



Candelabra Base

Finish Options:

- Available in all finish options

**Additional charges may apply*

