

---

**LOCAL HISTORIC DISTRICT:** Dilworth

**PROPERTY ADDRESS:** 316 East Boulevard

**SUMMARY OF REQUEST:** Material Change

**OWNER:** NPR Properties

**APPLICANT:** Nasrin Robinson/NPR Properties

---

**Details of Proposed Request**

*Existing Conditions*

The existing structure is a 2 story non-contributing commercial structure constructed in 1980. Original siding material is wood. The right side, the left front and the rear elevation have been changed to cementitious siding (HardiePlank). Wood siding remains on the front and left rear side.

*Proposal*

The proposal is to allow a change in siding material to cementitious siding (HardiePlank) for the entire structure.

**Policy and Design Guidelines**

**Non Traditional Building Materials, page 49**

1. The Historic District Commission considers substitute siding to be inappropriate for use in a designated Local Historic District, and does not allow its use on an historic structure within a Local Historic District.
2. The use of the following substitute siding materials is considered incongruous with the overall character of local historic districts, and is prohibited.
  - Vinyl
  - Aluminum or other metal sidings
  - Masonite
3. Cementitious board products are rarely considered appropriate for the main structure on a property. The Historic District Commission will consider these products on a case by case basis.
4. All proposals for the use of other non-traditional building materials for projects in Local Historic Districts will be judged on a case-by-case basis by the full Historic District Commission. The Commission will determine how well the proposed material and its proposed use are contextually appropriate in design, texture and other visual qualities.
5. The use of substitute or replacement building materials will not be considered as an alternative to routine maintenance.

**Staff Analysis**

The Commission will determine if the use of a non-traditional building material is appropriate for siding and other related exterior elements.

# Charlotte Historic District Commission - Case 2014-142

## Historic Distric; Dilworth

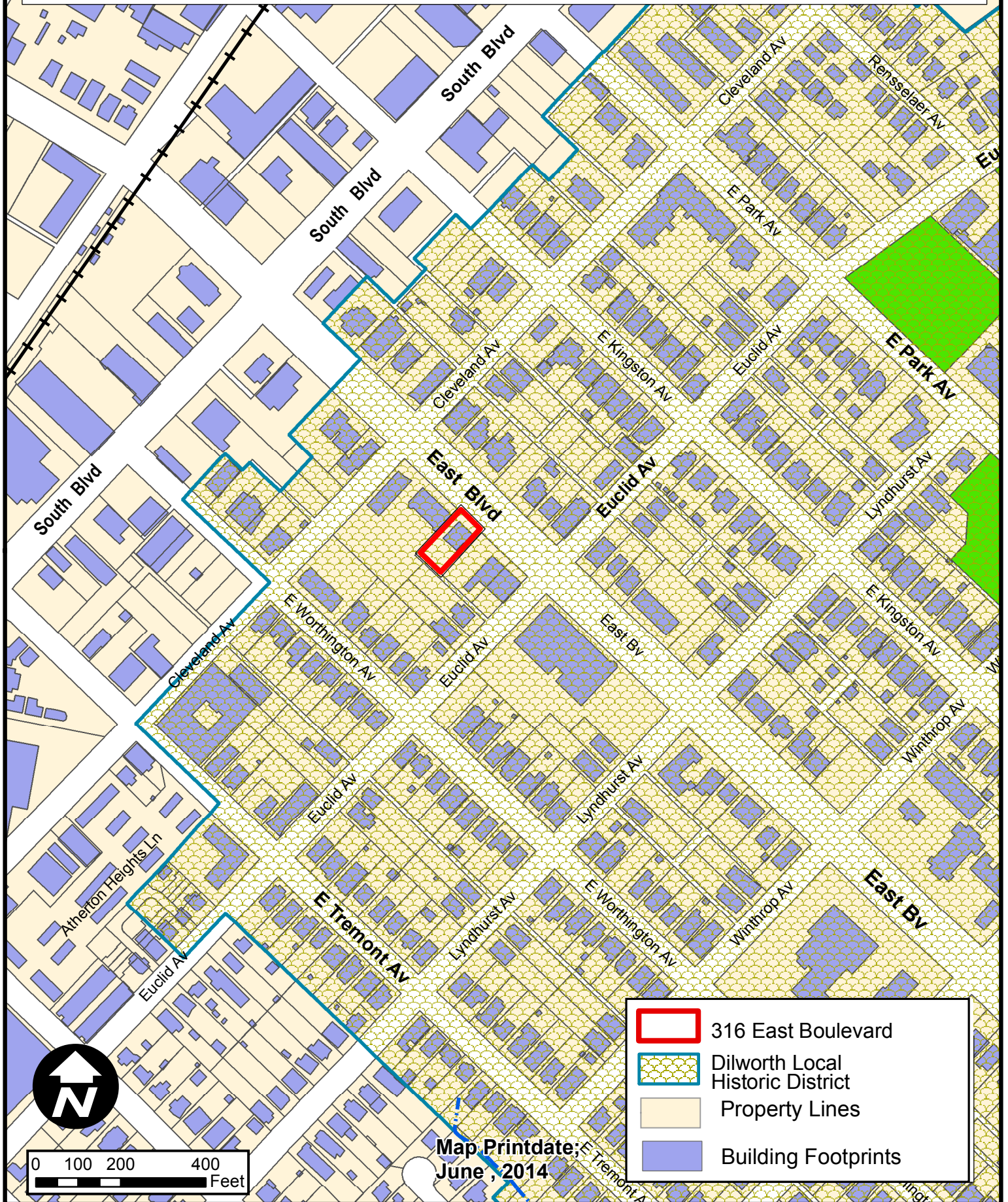





Candella  
704-458-8886

Patio Management  
704-458-8886  
www.patiomanagement.com



THIS PARKING LOT  
FOR  
PAPER SKYSCRAPER,  
AND THAI TASTE  
ONLY

THIS PARKING LOT  
FOR  
PAPER SKYSCRAPER,  
AND THAI TASTE  
ONLY

ALL UNAUTHORIZED VEHICLES  
WILL BE TOWED AWAY AT THE OWNER'S  
EXPENSE. FOR TOWED VEHICLES CALL  
DAN WICKER 323-8318



316  
EAST BLVD.  
SALON 316  
Parrin's Spa  
Chiropractical  
CLAUDETTE'S  
Jade

LOVE CHOCOLATE  
Chocolates  
by  
Lorada

CHARLOTTECHIROPRACTICAL.COM DR. BRAD LONDRE, D.C. 704.334.8018  
chiropractical  
SMART SOLUTIONS FOR PAIN RELIEF





OLEA  
Charlotte Massage

YTL-5696