

---

ADDRESS OF PROPERTY	<i>506 Hermitage Court, Hermitage Court Historic District</i>	<i>HDC 2012-079</i>
SUMMARY OF REQUEST	<i>Side Entry Addition</i>	
OWNERS	<i>Robert &amp; Kay Cordle</i>	
APPLICANT	<i>Robin Taylor of Allison Architecture</i>	

---

**Details of Proposed Request**

This proposal is for the alteration of some side porch elements due to water damage, and the addition of a new side porch as shown on the attached plans.

The plans are plan-view only – Staff has not received elevations to date. Staff has been assured that elevations will be delivered early the week of the August 8, 2012 HDC meeting. The plans will be forwarded to Commission members when they are received.

**Current Status and Context of Property**

This 1921 one and one half story bungalow house sits mid-block between Hermitage and Providence Roads on the west side of Hermitage Court.

**Relevant HDC Design Guidelines**

- ***Additions***

**Relevant Secretary of Interior's Standards for Historic Rehabilitation**

(As cited in the Charlotte Zoning Ordinance Section 10.210)

- (i) New additions, exterior alterations, or related new construction shall not destroy historic materials that characterize the property. The new work shall be differentiated from the old and shall be compatible with the massing, size, scale, and architectural features to protect the historic integrity of the property and its environment.
- (j) New additions and adjacent or new construction shall be undertaken in such a manner that if removed in the future, the essential form and integrity of the historic property and its environment would be unimpaired.





506











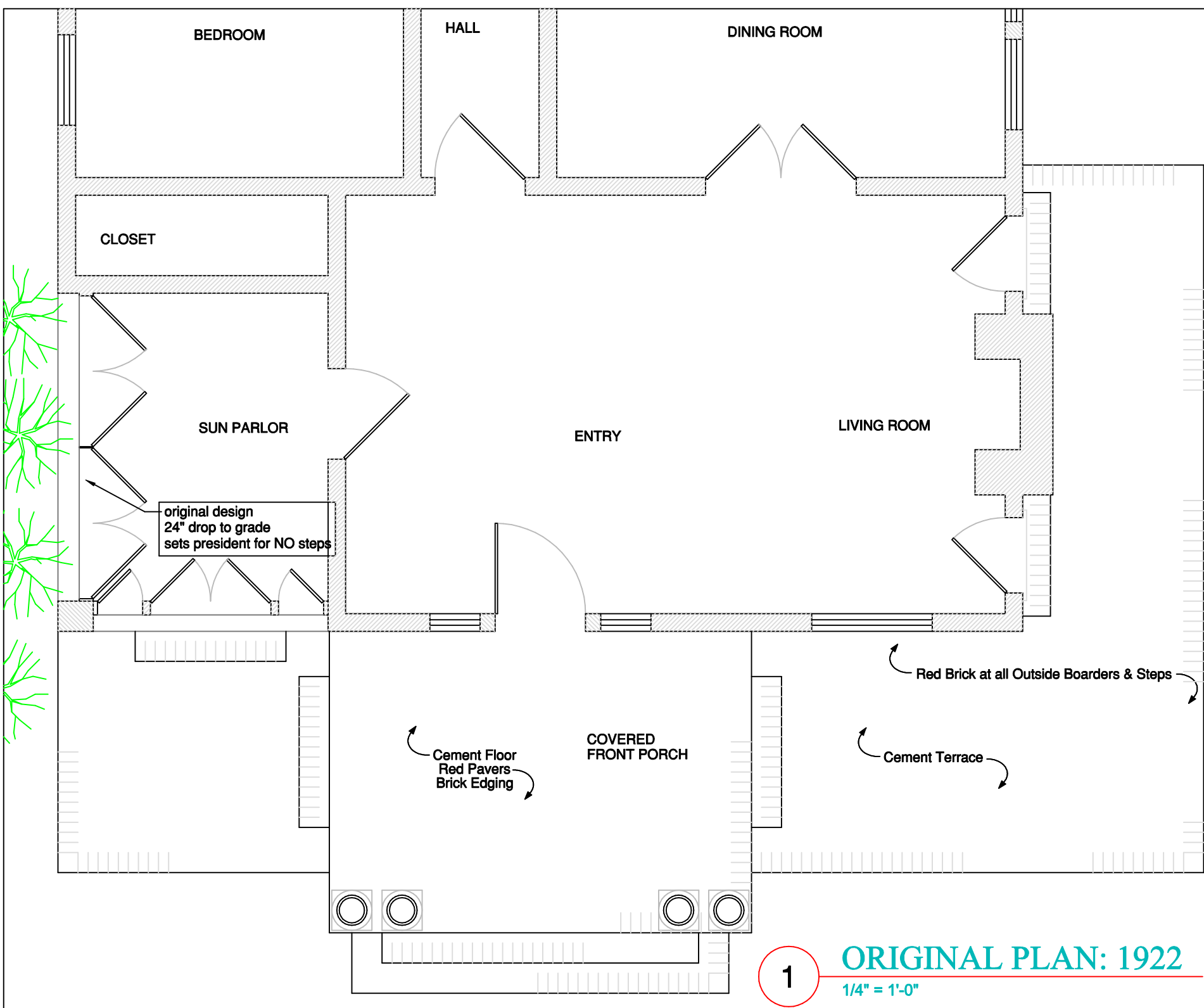

1

**ORIGINAL PLAN: 1922**  
1/4" = 1'-0"



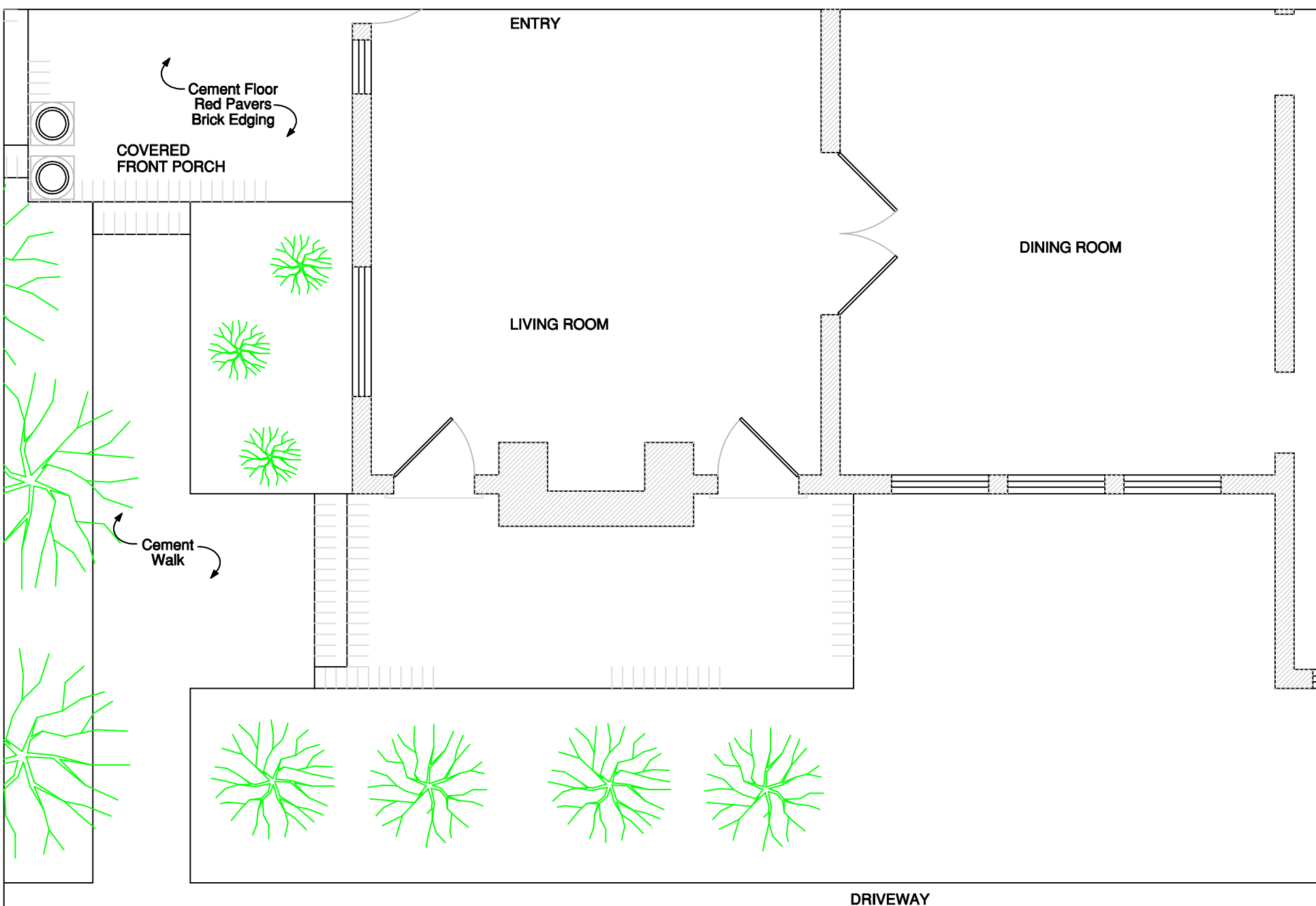

**ALLISON  
ARCHITECTURE**  
850 Linda Lane - Charlotte, NC 28211 - (704) 562-1887

**FOR  
HISTORIC APPROVAL**

A Report For:  
**The Cordle Residence**  
506 Hermitage Court  
Charlotte, North Carolina

Project No.: 2012100	Drawn by: R.A.T.	Date Issued: May 8, 2012
Revisions:		
<b>A-2</b>		Set Total: 1

2

**AS-BUILT PLAN**  
1/4" = 1'-0"



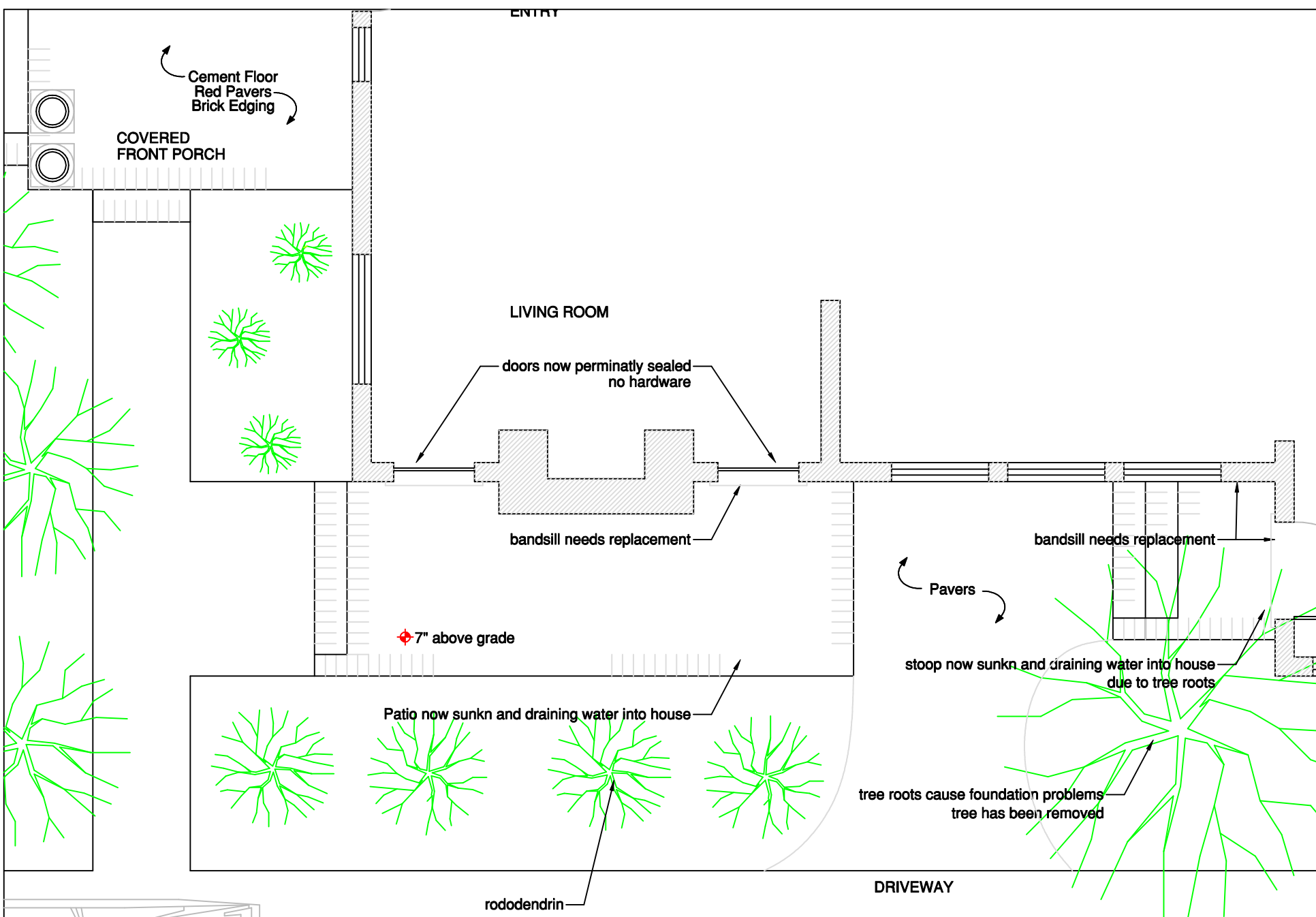

3

## AFTER 2000 RENOVATION

1/4" = 1'-0"

Renovation Approved by  
Historic Landmark Commission

**ALLISON  
ARCHITECTURE**  
850 Linda Lane - Charlotte, NC 28211 - (704) 562-1887

FOR  
HISTORIC APPROVAL

A Repair For:  
**The Cordle Residence**  
506 Hermitage Court  
Charlotte, North Carolina

Project No.: 2012100  
Drawn by: R.A.T.  
Date Issued: May 8, 2012

Revisions:

**A-3**

Set Total: 1



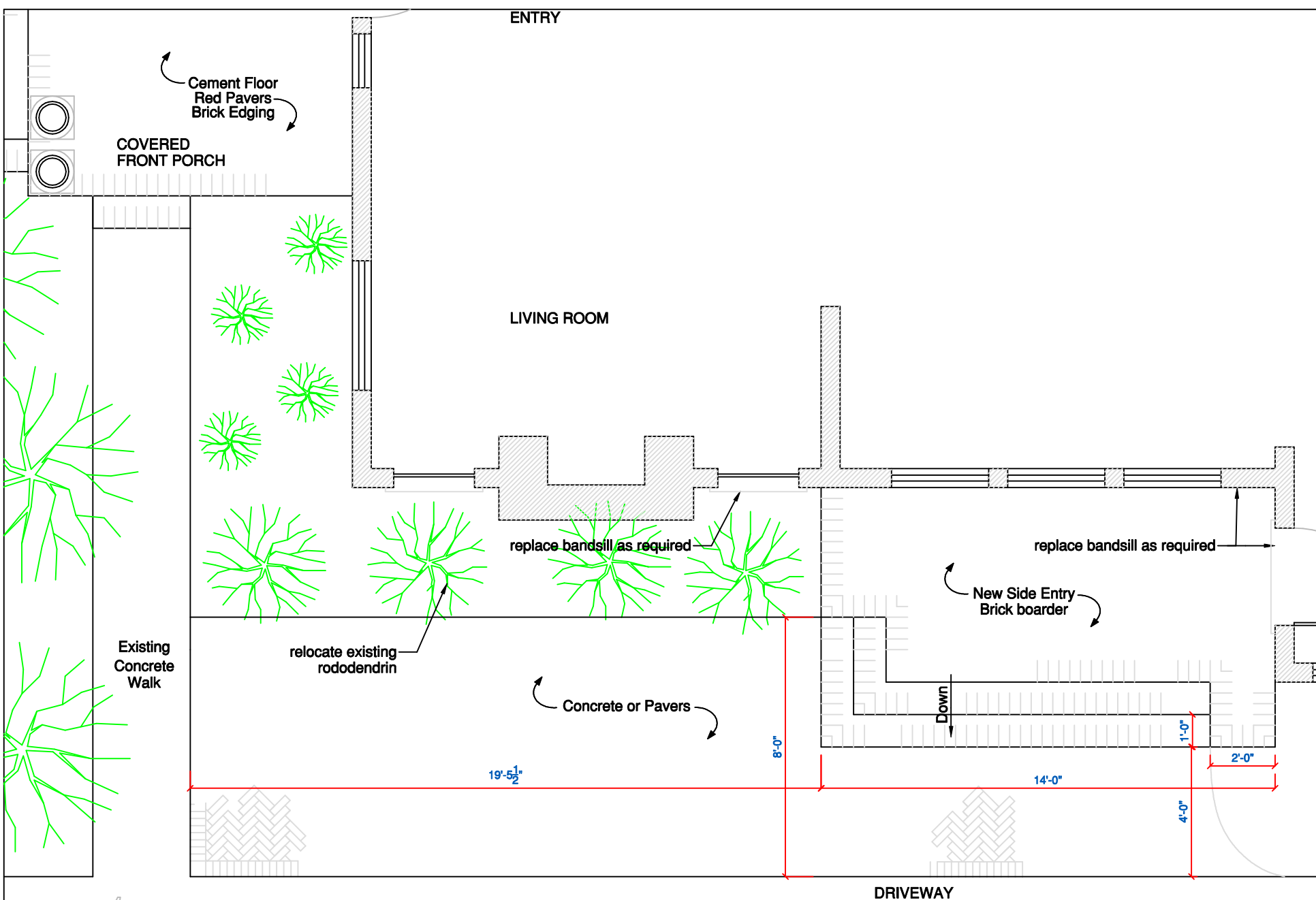

**ALLISON  
ARCHITECTURE**  
850 Linda Lane - Charlotte, NC 28211 - (704) 562-1887

**FOR  
HISTORIC APPROVAL**

**The Cordle Residence**  
506 Hermitage Court  
Charlotte, North Carolina

Project No.: 2012100  
Drawn by: R.A.T.  
Date Issued: May 8, 2012  
Revisions:  
**A-4**  
Set Total: 1

**4**

**PROPOSED RENOVATION**  
1/4" = 1'-0"



# Charlotte Historic District Commission - Case 2012-079

