

ARBOR WAY PHASE II

CONSTRUCTION PLANS FOR:
ARBOR WAY SUBDIVISION PHASE 2
CHARLOTTE, NC
MRH-13110

PRELIMINARY PLAT SMITHFIELD DRIVE CHARLOTTE, NORTH CAROLINA PROJECT NUMBER: MRH-13110

DATE: OCTOBER 5, 2014
REVISED: MARCH 9, 2015
REVISED: APRIL 9, 2015
REVISED: MAY 31, 2016

APPLICANT:
MERITAGE HOMES
11605 NORTH COMMUNITY HOUSE ROAD
SUITE 250
CHARLOTTE, N.C. 28277
(704) 944-8906
Mark.Sergent@meritagehomes.com

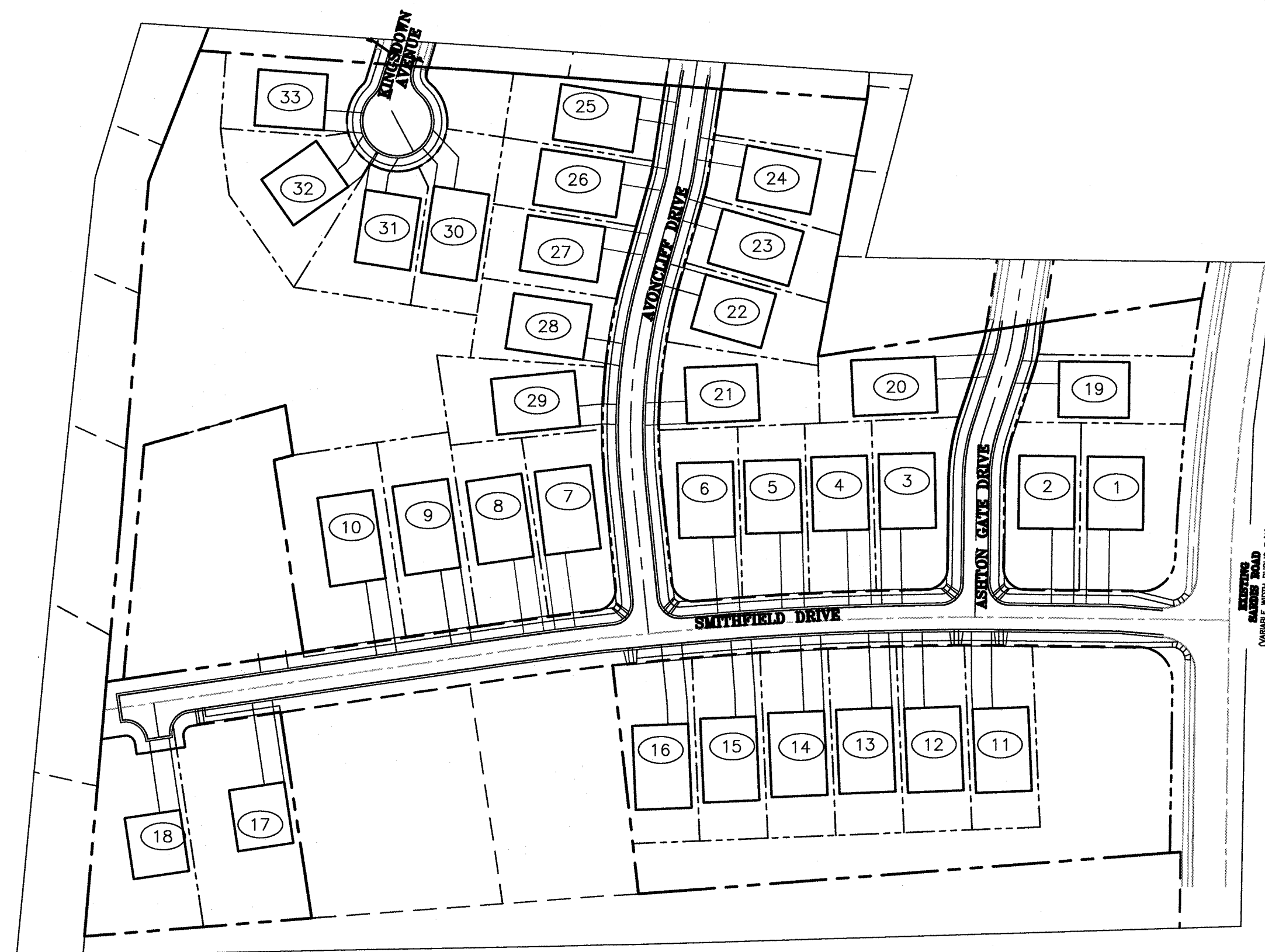

SHEET INDEX

SHEET NUMBER	SHEET TITLE	ORIGINAL DATE	REVISION DATE	REVISION DESCRIPTION
C-1	EXISTING CONDITIONS	10-05-2014		ADDRESSED CITY OF CHARLOTTE COMMENTS
C-2	DEMOLITION PLAN	10-05-2014	04-09-2015	ADDRESSED CITY OF CHARLOTTE COMMENTS
C-3	SITE PLAN	10-05-2014	04-09-2015	ADDRESSED CITY OF CHARLOTTE COMMENTS
C-4	EROSION CONTROL PLAN - PHASE 1	10-05-2014	04-09-2015	ADDRESSED CITY OF CHARLOTTE COMMENTS
C-5	GRADING PLAN	10-05-2014	05-31-2016	PER CLIENT COMMENTS
C-6	GRADING NOTES	10-05-2014	05-31-2016	PER CLIENT COMMENTS
C-7	DRAINAGE AREA PLAN	10-05-2014	05-31-2016	PER CLIENT COMMENTS
C-8	EROSION CONTROL PLAN - STAGE 2	10-05-2014	05-31-2016	PER CLIENT COMMENTS
C-9	UTILITY PLAN	10-05-2014	05-31-2016	PER CLIENT COMMENTS
C-10	LANDSCAPING PLAN	10-05-2014	04-09-2015	ADDRESSED CITY OF CHARLOTTE COMMENTS
C-11	TRAFFIC CONTROL PLAN	10-05-2014	04-09-2015	ADDRESSED CITY OF CHARLOTTE COMMENTS
C-12	NATURAL AREA PLAN	10-05-2014	04-09-2015	ADDRESSED CITY OF CHARLOTTE COMMENTS
P-1	PLAN & PROFILE - SMITHFIELD DRIVE	10-05-2014	04-09-2015	ADDRESSED CITY OF CHARLOTTE COMMENTS
P-2	PLAN & PROFILE - ASHTON GATE, AVONCLIFF & KINGSDOWN	10-05-2014	05-31-2016	PER CLIENT COMMENTS
XS-1	CROSS SECTIONS - SMITHFIELD DRIVE	10-05-2014	04-09-2015	ADDRESSED CITY OF CHARLOTTE COMMENTS
XS-2	CROSS SECTIONS - SMITHFIELD DRIVE	10-05-2014	04-09-2015	ADDRESSED CITY OF CHARLOTTE COMMENTS
XS-3	CROSS SECTIONS - SMITHFIELD DRIVE	10-05-2014	04-09-2015	ADDRESSED CITY OF CHARLOTTE COMMENTS
XS-4	CROSS SECTIONS - SMITHFIELD DRIVE	10-05-2014	04-09-2015	ADDRESSED CITY OF CHARLOTTE COMMENTS
XS-5	CROSS SECTIONS - SMITHFIELD DRIVE	03-09-2015	04-09-2015	ADDRESSED CITY OF CHARLOTTE COMMENTS
SW-A1	STORMWATER MANAGEMENT FACILITY 'A' PLAN VIEW	10-05-2014	04-09-2015	ADDRESSED CITY OF CHARLOTTE COMMENTS
SW-A2	STORMWATER MANAGEMENT FACILITY 'A' DETAILS	10-05-2014	04-09-2015	ADDRESSED CITY OF CHARLOTTE COMMENTS
SW-A3	STORMWATER MANAGEMENT FACILITY 'A' DETAILS	10-05-2014	04-09-2015	ADDRESSED CITY OF CHARLOTTE COMMENTS
SW-A4	STORMWATER MANAGEMENT FACILITY 'A' DETAILS	10-05-2014	04-09-2015	ADDRESSED CITY OF CHARLOTTE COMMENTS
SW-ALS	STORMWATER MANAGEMENT FACILITY 'A' LANDSCAPING PLAN	10-05-2014	04-09-2015	ADDRESSED CITY OF CHARLOTTE COMMENTS
SW-B1	STORMWATER MANAGEMENT FACILITY 'B' PLAN VIEW	10-05-2014	04-09-2015	ADDRESSED CITY OF CHARLOTTE COMMENTS
SW-B2	STORMWATER MANAGEMENT FACILITY 'B' DETAILS	10-05-2014	04-09-2015	ADDRESSED CITY OF CHARLOTTE COMMENTS
SW-B3	STORMWATER MANAGEMENT FACILITY 'B' DETAILS	10-05-2014	04-09-2015	ADDRESSED CITY OF CHARLOTTE COMMENTS
SW-B4	STORMWATER MANAGEMENT FACILITY 'B' DETAILS	10-05-2014	04-09-2015	ADDRESSED CITY OF CHARLOTTE COMMENTS
SW-BLS	STORMWATER MANAGEMENT FACILITY 'B' LANDSCAPING PLAN	10-05-2014	04-09-2015	ADDRESSED CITY OF CHARLOTTE COMMENTS
D-1	DETAILS - SITE	10-05-2014	04-09-2015	ADDRESSED CITY OF CHARLOTTE COMMENTS
D-2	DETAILS - SITE	10-05-2014	04-09-2015	ADDRESSED CITY OF CHARLOTTE COMMENTS
D-3	DETAILS - EROSION CONTROL	10-05-2014	04-09-2015	ADDRESSED CITY OF CHARLOTTE COMMENTS
D-4	DETAILS - EROSION CONTROL	10-05-2014	04-09-2015	ADDRESSED CITY OF CHARLOTTE COMMENTS
D-5	DETAILS - STORM DRAINAGE	10-05-2014	04-09-2015	ADDRESSED CITY OF CHARLOTTE COMMENTS
D-6	DETAILS - UTILITY	10-05-2014	04-09-2015	ADDRESSED CITY OF CHARLOTTE COMMENTS



FINAL
APPROVAL

<http://development.charmeck.org>

SDRSFR-2016-00019

ENGINEERING
PCO / DETENTION / DRAINAGE PLAN

APPROVED
By Brendan Smith at 5:57 pm, Jul 05, 2016

EROSION CONTROL
NOTE: SCHEDULE PRE-CONSTRUCTION MEETING
AT LEAST 48 HRS. PRIOR TO ANY LAND
DISTURBING ACTIVITY USING THE ONLINE
FORM AT <http://development.charmeck.org>

APPROVED

URBAN FORESTRY
TREE ORDINANCE

APPROVED

CDOT

APPROVED

REVISION
**APPROVED FOR
CONSTRUCTION**
CHARLOTTE-MECKLENBURG PLANNING DEPARTMENT
BY: Joshua Weaver 7-6-2016

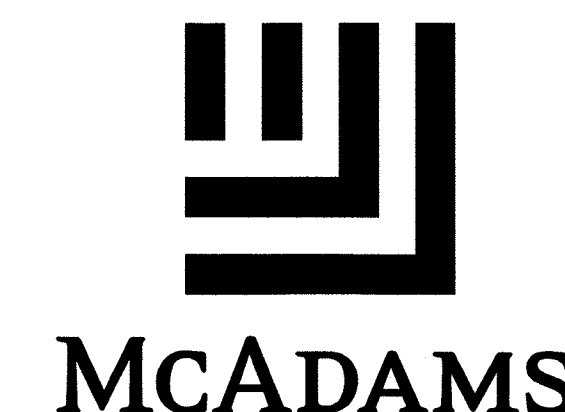
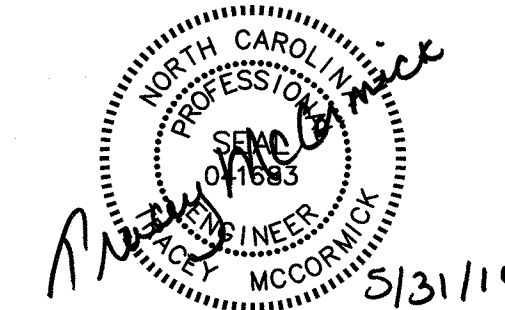

**THE JOHN R. McADAMS
COMPANY, INC.**
11301 Carmel Commons Blvd.
Suite 111
Charlotte, North Carolina 28226
License No.: C-0293
(800) 733-5646 • McAdamsCo.com

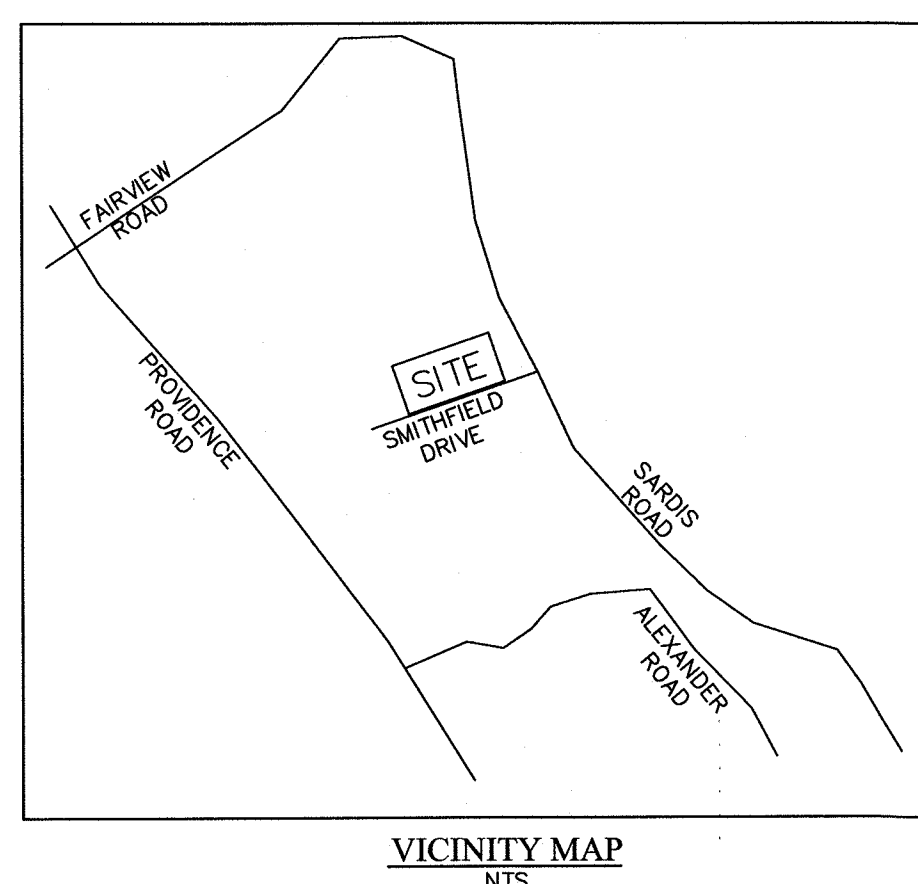

CONTRACTOR SHALL NOTIFY "NORTH CAROLINA ONE CALL" (811) OR
(1-800-632-4949) AT LEAST 48 HOURS PRIOR TO BEGINNING CONSTRUCTION
OR EXCAVATION TO HAVE EXISTING UTILITIES LOCATED.
CONTRACTOR SHALL CONTACT ANY LOCAL UTILITIES THAT PROVIDE THEIR
OWN LOCATOR SERVICES INDEPENDENT OF "NORTH CAROLINA ONE CALL".
REPORT ANY DISCREPANCIES TO THE ENGINEER IMMEDIATELY.

