



**S I T E**  
  
**SOLUTIONS**

2 3 2 0  
W. Morehead Street  
Charlotte, NC 28208  
Landscape Architecture

---

Site Planning

---

Civil Engineering

---

[www.sitesolutionspa.com](http://www.sitesolutionspa.com)  
Telephone: 704-521-9880  
Facsimile: 704-521-8955  
CADD# 2870

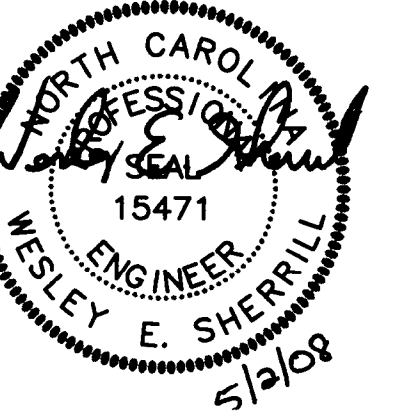

**cms**  
Charlotte-Mecklenburg Schools

# CONSTRUCTION DOCUMENTS

ALTERNATE  
NO. 2

APPROVED FOR  
CONSTRUCTION  
CMPC  
JBS 6/4/2008

C101

ALTERNATE NO.2

1. EARTHWORK QUANTITIES HAVE NOT BEEN ESTIMATED AND SITE AS SHOWN IS NOT ASSUMED TO REPRESENT A BALANCED CUT/FILL CONDITION. CONTRACTOR SHALL PROVIDE EROSION CONTROL MEASURES AND PROVIDE ALL EARTHWORK NECESSARY TO ACHIEVE THE DESIGN GRADE, INCLUDING ANY OFFSHORE BORROW OR SPILLS REQUIRED.
2. CONTRACTOR SHALL PROVIDE POSITIVE DRAINAGE IN ALL GRADED AREAS, INCLUDING DRAINAGE LANE, DRAINAGE DITCHES AND DRAINAGE SWALES.
3. THE CONTRACTOR SHALL IMMEDIATELY REPORT TO OWNER ANY DISCREPANCIES FOUND BETWEEN ACTUAL FIELD CONDITIONS AND CONSTRUCTION DOCUMENTS SHALL BE THE BASIS FOR ANY CORRECTIONS TO PROCEEDING.
4. CONTRACTOR SHALL VERIFY LOCATION OF ALL UNDERGROUND UTILITIES PRIOR TO BEGINNING WORK, BOTH PUBLIC AND PRIVATE. CONTRACTOR SHALL BE RESPONSIBLE FOR LOCATING ALL UTILITIES AND SHALL REPAIR ANY DAMAGE AS A RESULT OF THIS CONTRACT.
5. CONTRACTOR SHALL BLEND NEW EARTHWORK SMOOTHLY TO TRANSITION FROM EXISTING TO NEW GRADE.
6. THE PROPOSED CONTOURS AND SPOT ELEVATIONS SHOWN IN DRIVES, PARKING LOTS, AND SIDEWALKS ARE FINISHED ELEVATIONS INCLUDING CURBS. THE EXISTING PAVED DRIVE AND PARKING AREAS ARE TO BE CORRECTED SUBGRADE OR AGGREGATE BASE COURSE ELEVATIONS TO BE COMPLETED UNDER THIS CONTRACT.
7. ALL DRAWINGS ARE BASED ON THE CHARLOTTE/MECKLENBURG LAND DEVELOPMENT STANDARDS MANUAL.
8. ON-SITE BURIAL PITS REQUIRE AN ON-SITE DEMOLITION PERMIT FROM THE ZONING ADMINISTRATION.
9. ADDITIONAL MEASURES TO CONTROL EROSION AND SEDIMENT MAY BE REQUIRED BY A REPRESENTATIVE OF NC DEP, OF ENVIRONMENTAL AND NATURAL RESOURCES, LAND QUALITY SECTION.
11. ANY EROSION, BEYOND THE LIMITS OF CONSTRUCTION AS SHOWN ON THE GRADING PLAN, IS SUBJECT TO A FINE.
12. GRADING MORE THAN ONE ACRE WITHOUT AN APPROVED EROSION CONTROL PLAN IS SUBJECT TO A FINE.
13. STABILIZATION OF THE BEST FIRM TYPE OF EROSION CONTROL. TEMPORARY SEEDING IS NECESSARY TO ACHIEVE EROSION CONTROL ON LARGE DENuded AREAS AND ESPECIALLY WHEN SPECIFICALLY REQUIRED AS PART OF THE CONSTRUCTION DOCUMENTS. SEEDING SHALL BE COMPLETED WITHIN 15 DAYS OF COMPLETION OF GRADING. ALL REMAINING AREAS SHALL BE SEEDDED AND MULCHED WITHIN 15 DAYS OF COMPLETION OF GRADING.
14. PILE LENGTHS SHOWN ARE THE ENGINEER'S ESTIMATE USED TO COMPUTE PILE SLOPES AND INVERTS. SHALL NOT BE CONSTRUCTED BY THE CONTRACTOR TO REPRESENT THE ACTUAL QUANTITY OF PILE REQUIRED.
15. CROSS SLOPE OF SLOPES SHALL BE 2:1 (MINIMUM) (MAX).
16. SLOPE SHALL BE GRADED NO STEEPER THAN 2:1
17. APPROVAL OF THIS PLAN IS NOT AN AUTHORIZATION TO GRADE ADJACENT PROPERTIES, WHEN FIELD CONDITIONS WARRANT OFF-SITE GRADING. PERMISSION MUST BE OBTAINED FROM THE AFFECTED PROPERTY OWNERS.
18. TREE REMOVAL SHALL BE LIMITED TO ANY DEMOLITION/CLEARING/GRADING/CONSTRUCTION, AND NOT REMOVED UNTIL AFTER FINAL INSPECTION OF THE PROJECT.
19. NO DISTURBANCE OR COMPACTION, CONSTRUCTION MATERIALS, TRAFFIC, BURIAL PITS, TRENCHING OR OTHER LAND DISTURBING ACTIVITY ALLOWED IN TREE PROTECTION BARRICADES OR BARRICADES TO EXISTING TREES. AFTER ANY DEMOLITION, GRADING OR CONSTRUCTION BEGINS, AND NOT REMOVED UNTIL FINAL INSPECTION.
20. TREE REMOVAL SHALL NOT MEET OR EXCEED TREE ORDNANCE GUIDELINES STANDARDS (IN THE CITY OF CHARLOTTE TREE ORDNANCE GUIDELINES APPENDIX 9 OR LAND DEVELOPMENT STANDARDS MANUAL, 40.04).
21. BEFORE REMOVAL OF TREES, CONTRACTOR MUST BEAR AND MAINTAIN FOR INSPECTION OF TREE PROTECTION BARRICADES BY URBAN FORESTER.
22. NO GRUBBING WITHIN TREE PROTECTION ZONE. LEAVE SOIL AND LEAF LITE TOPSOIL SUPPLEMENTED WITH 2" LAYER OF MULCH. OR SHALLOWS ARE GRASS ONLY IN DISTURBED/GRADDED AREAS.
23. BRUSH, VINES AND SMALL TREES (< 8 IN. DIA., OR AS SMALL AS 2 IN. CA. DIA. IN SOME AREAS) SHALL BE CUT AND CHIPPED. BRANCHES AND CHIPS SHALL BE LIMBED UP 6 FEET (AT 2/3 OF THE BRANCHES SHOW) TO LANDFILL OR MULCH.
24. EXPOSED TREE ROOTS MUST BE CLEANLY CUT WITH A SHARP PUNING TOOL BACKFILL SAP TO MINIMIZE EXPOSURE TO THE AIR.
25. ANY TREES IN TREE PROTECTION SETBACK THAT COUNT TOWARD TREE ORD. SHALL BE REMOVED THAT ARE DURING CONSTRUCTION WILL BE MITIGATED AS REQUIRED BY URBAN FORESTER.
26. PILE LENGTHS SHOWN ON CULVERTS INCLUDE FLARED END SECTIONS.
27. SOIL TYPE IS: Csh2,Mud,Vsh
28. NOT USED.
29. DISTURBED URBAN LOT LINES 1.68 ACRES. (THESE PLANS ONLY)
30. COORDINATE ALL CURB AND STREET GRADING IN INTERSECTION WITH INSPECTOR.
31. ALL ROAD IMPROVEMENTS IN HIGHLAND PARK DRIVE ARE TO BE CONSTRUCTED WITH THE CITY OF CHARLOTTE ENGINEERING DEPARTMENT PRIOR TO CONSTRUCTION.
32. THE DEVELOPER SHALL MAINTAIN EACH STREET, CREEK, OR CHANNEL AND CHANNEL BANKS IN EXISTING OR BETTER CONDITION. THE DEVELOPER SHALL MAINTAIN THE CHANNEL AND BANKS THE STREAM ALL DEBRIS, LOGS, TIMBER, JUNK AND OTHER DEBRIS.
33. NON-STANDARD ITEMS (IE: PAVERS, IRRIGATION SYSTEMS, ETC.) IN THE RIGHT-OF-WAY OF THE PROJECT SHALL BE COORDINATED PRIOR TO CONSTRUCTION WITH THE (CHARLOTTE) DEPARTMENT OF TRANSPORTATION/NORTH CHARLOTTE DISTRICT.

1. DIMENSIONS AND COORDINATE POINTS ARE TO FACE OF CURB, EDGE OF PAVEMENT, OR CORNER OF BUILDING UNLESS OTHERWISE NOTED.
2. ALL IMPROVEMENTS AND CONSTRUCTION SHALL BE IN ACCORDANCE WITH STATE AND LOCAL STANDARDS.
3. ANY DISCREPANCIES FOUND IN THE FIELD SHALL BE CALLED TO THE ATTENTION OF THE OWNER OR ENGINEER PRIOR TO PROCEEDING WITH WORK.
4. PRIOR TO BEGINNING CONSTRUCTION, THE GENERAL CONTRACTOR SHALL OBTAIN ALL REQUIRED PERMITS AND APPROVALS FROM ALL REGULATORY AUTHORITIES.
5. THE GENERAL CONTRACTOR SHALL CONTACT ALL OWNERS OF EASEMENTS, UTILITIES, AND RIGHT-OF-WAYS, PUBLIC AND PRIVATE, PRIOR TO WORKING IN THESE AREAS.
6. GENERAL CONTRACTOR SHALL MAINTAIN THE SITE IN A MANNER SO THAT WORKMEN AND THE PUBLIC SHALL BE PROTECTED FROM INJURY.
7. DO NOT SCALE DRAWING FOR ACTUAL DIMENSIONS, AS IT IS A REPRODUCTION AND SUBJECT TO VARIATIONS FROM ORIGINAL.
8. ALL SIGNS, PAVEMENT MARKINGS, AND OTHER TRAFFIC CONTROL DEVICES SHALL CONFORM TO THE MANUAL ON UNIFORM TRAFFIC CONTROL DEVICES(UTMCD), 2003 EDITION AS AMENDED.
9. ALL PAVEMENT MARKINGS SHALL BE FOUR (4) INCHES WIDE UNLESS INDICATED OTHERWISE ON THE DRAWINGS.
10. CONTRACTOR SHALL FURNISH AND INSTALL ALL PAVEMENT MARKINGS AS SHOWN ON THE PLANS.
11. CONTRACTOR SHALL SAW-CUT EXISTING ASPHALT PAVEMENT AREAS TO THE LINE IN SMOOTHLY TO REVEAL PAVEMENT UNDERLAYER DISCREPANCIES.
12. LAND DEVELOPMENT SHALL BE GIVEN 24 HOURS NOTICE PRIOR TO START OF CONSTRUCTION.
13. COORDINATE ALL CURB AND STREET GRADERS IN INTERSECTION WITH INSPECTOR.
14. DEVELOPER WILL PROVIDE STREET SIGNS PER CALIFOS \$50.05 (9" SIGNS ONLY).
15. PE SEALED SHOP DRAWINGS FOR RETAINING WALLS MUST BE SUBMITTED TO CITY ENGINEER PRIOR TO CONSTRUCTION.
16. SIGHT TRIANGLES SHOWN ARE THE MINIMUM REQUIRED.
17. IN ROLLING AND HILLY TERRAINS, SWEEPING OF THE STONE BASE AND/OR APPLICATION OF A TACK COAT MAY BE REQUIRED UNDER HAZY INTERSECTIONS. THESE REQUIREMENTS WILL BE ESTABLISHED BY THE INSPECTOR BASED ON FIELD CONDITIONS.
18. IN ORDER TO ENSURE PROPER DRAINAGE, KEEP A MINIMUM OF 0.5% SLOPE ON THE CURB.
19. SUBSURFACE DRAINAGE FACILITIES MAY BE REQUIRED IN THE STREET RIGHT-OF-WAY IF DEEMED NECESSARY BY THE INSPECTOR.
20. CURB AND GUTTER SHOWN ON PLANS MAY BE ADJUSTED BASED UPON FIELD STAKING BY CITY ENGINEER. ASSOCIATED STORM DRAINAGE MAY ALSO REQUIRE MODIFICATION BASED UPON FIELD CONDITIONS.
21. THE PURPOSE OF THE STORM DRAINAGE EASEMENT IS TO PROVIDE STORM WATER FLOW AND ANY STRUCTURES AND/OR OBSTRUCTION TO STORM WATER FLOW IS PROHIBITED.
22. "AS-BUILT" DRAWINGS AND PLANS OF THE STORM DRAINAGE SYSTEM, INCLUDING DESIGNED DETCHES, MUST BE SUBMITTED PRIOR TO SUBDIVISION FINAL INSPECTION OF CITY/COUNTY ENGINEER TO THE DEPARTMENT IN ACCORDANCE WITH THE CITY/COUNTY SUBDIVISION ORDINANCE.
23. PRIOR TO PLAT RECORDECTION, OFFSITE R/W AND/OR CONSTRUCTION EASEMENTS ARE REQUIRED TO BE OBTAINED ACCORDING TO THE GUIDELINES OF THE "OFFSITE EASEMENT ACQUISITION PROCEDURE". ALL CONSTRUCTION LIMITS ARE CLEARLY SHOWN ON THE ROADWAY IMPROVEMENT PLAN.
24. THE DEVELOPER SHALL CONTACT THE CHARLOTTE DEPARTMENT OF TRANSPORTATION, GUS JORD (704-336-7082) TO IDENTIFY ANY CONFLICTS WITH TRAFFIC SIGNALIZATION EQUIPMENT. 60-90 DAY NOTICE MUST BE PROVIDED TO COORDINATE RELOCATION. DEVELOPER SHALL BE RESPONSIBLE FOR ALL RELATED RELOCATION COST AND/OR ANY REPAIR COST CAUSED BY THE CONTRACTOR/DEVELOPER.
25. ALL SIGNAGE WILL BE APPROVED AND PERMITTED SEPARATELY.
26. HIGH DENSITY POLYETHYLENE (HDPE) STORM DRAINAGE PIPE INSTALLED WITH EXISTING OR PROPOSED PUBLIC STREET RIGHT-OF-WAY MUST BE APPROVED BY THE CITY'S INSPECTOR. EXISTING BACKFILL OR EXISTING DRAINAGE STRUCTURES MUST BE APPROVED BY THE CITY'S INSPECTOR PRIOR TO PLACEMENT OF THE MATERIAL. WITHIN 10' OF THE STREET RIGHT-OF-WAY

**Remaining Shelley Ave to Ridge Road  
Improvements shall be in associated Middle  
School Construction project.**



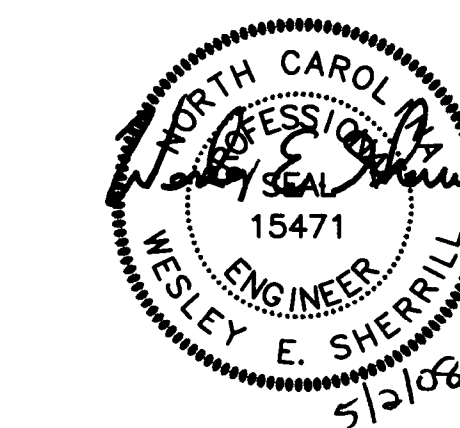
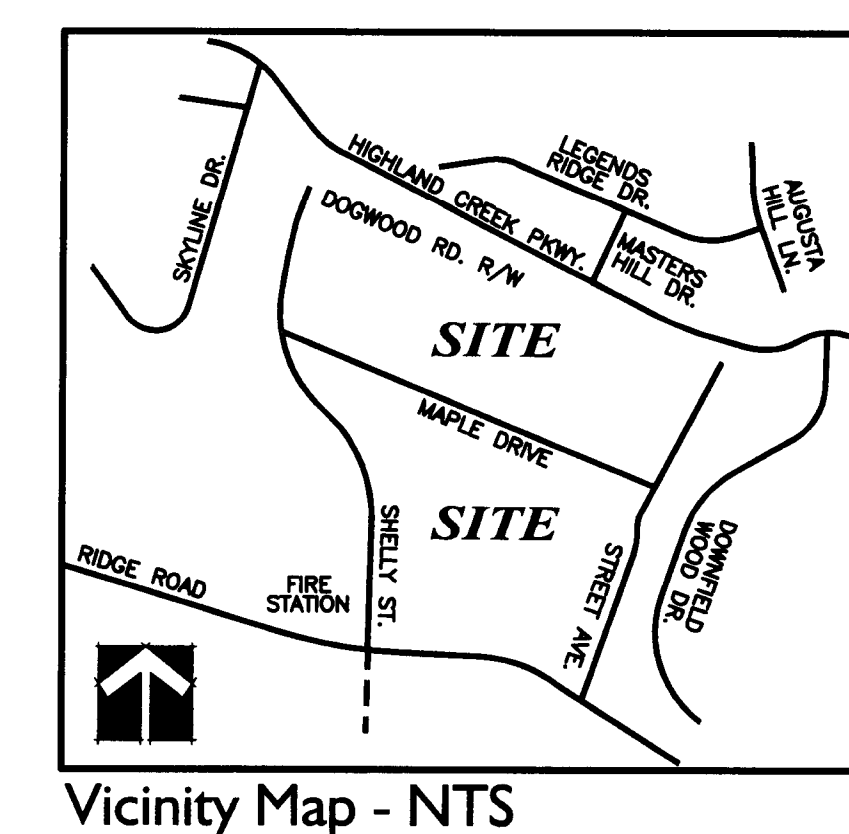
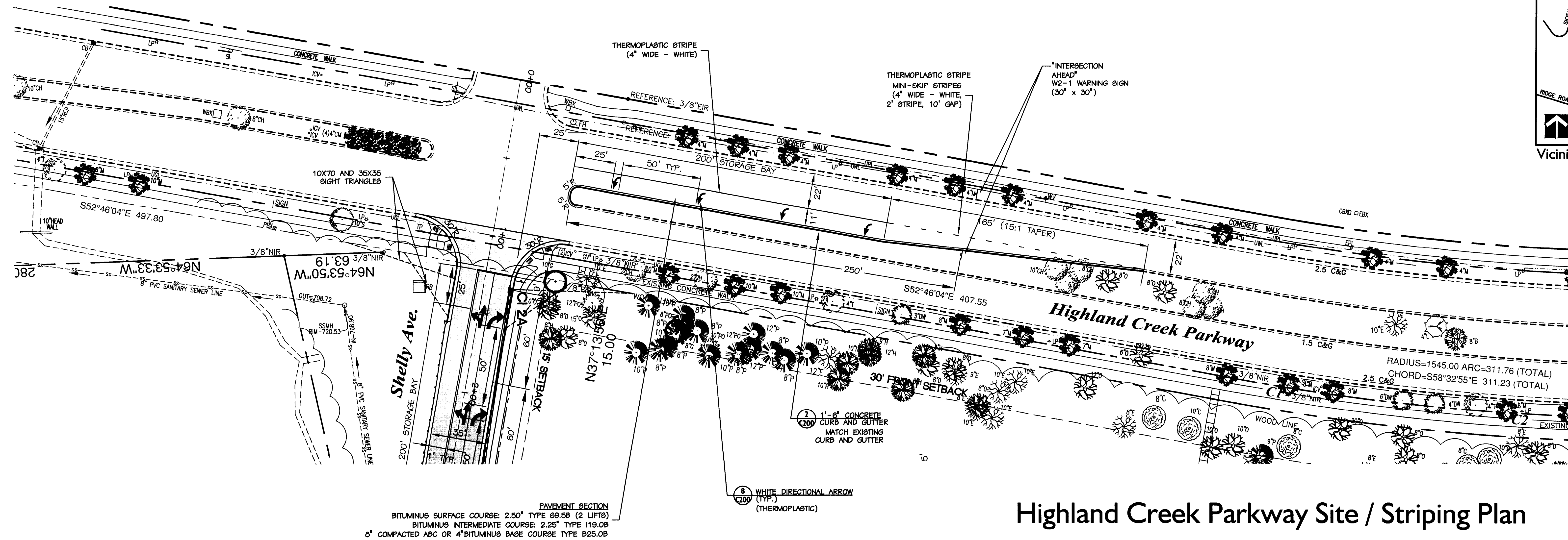

**RIDGE ROAD  
MIDDLE SCHOOL**  
7260 HIGHLAND CREEK PARKWAY  
CHARLOTTE, NORTH CAROLINA



## Shelly Ave / Highland Creek Pky Improvements

CONSTRUCTION  
DOCUMENTS

ALTERNATE  
NO. 2

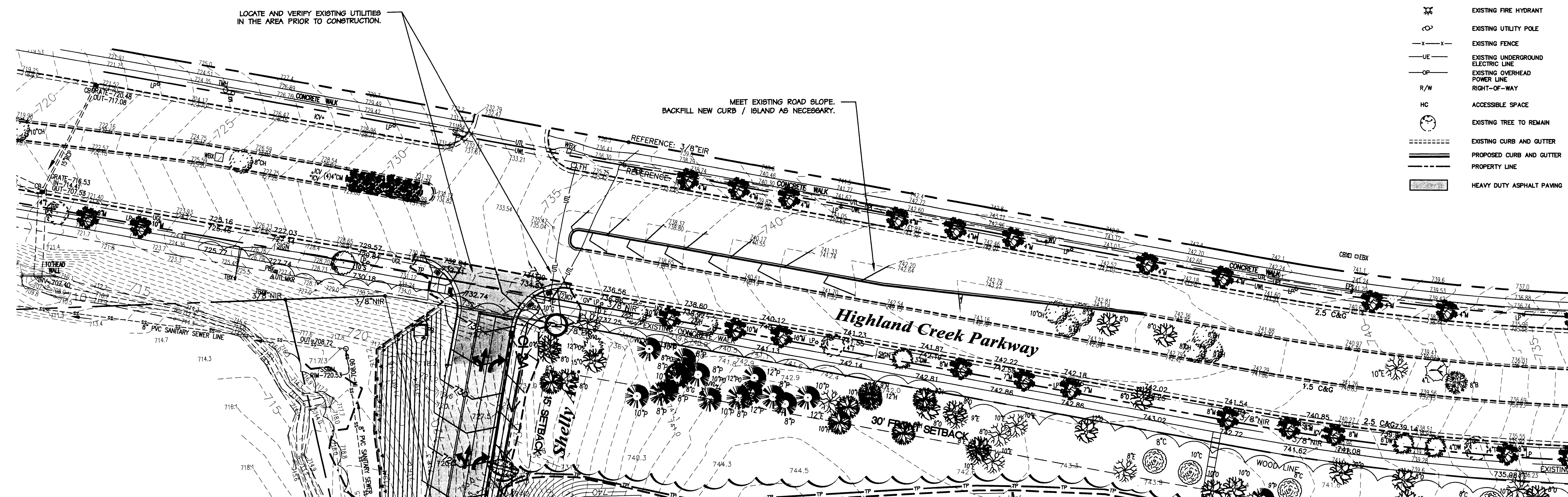

Contractor shall maintain all existing Erosion Control Measures provided during Early package work.

**CAUTION!!!**  
 The locations and elevations of existing underground utilities as shown on this drawing are only APPROXIMATE. No guarantee is either expressed or implied as to the completeness of accuracy thereof. The contractor shall be exclusively responsible for determining the exact locations and elevations of utilities prior to the start of construction

