

VICINITY MAP N.T.S.

SURVEY DISCLAIMER
BACKGROUND INFORMATION PROVIDED BY MECKLENBURG COUNTY
GIS AND PLANIMETRICS.

- LEGEND**
- SYMBOL
- PROPOSED REZONING BOUNDARY
 - PROPOSED PROPERTY LINE
 - PROPOSED SETBACK LINE
 - APPROXIMATE VEHICULAR CONNECTIONS
 - PROPOSED LANDSCAPE BUFFER
 - PROPOSED TREE SAVE AREA

SITE DATA:

TAX PARCELS: 15716201
15716202
15716203
15716204
TOTAL SITE ACREAGE: 4.1777 AC

PROPOSED PARCEL ZONING: O-2(CD)
PROPOSED PARCEL ACREAGE: 0.342 AC

EXISTING ZONING: R-17MF

EXISTING USES: SINGLE FAMILY

*REFER TO DEVELOPMENT STANDARD NOTES ON THIS SHEET FOR FURTHER INFORMATION.

DEVELOPMENT STANDARDS:

- JUNE 21, 2018
- 1. GENERAL PROVISIONS**
- A. THESE DEVELOPMENT STANDARDS FORM A PART OF THE REZONING PLAN ASSOCIATED WITH THE REZONING PETITION FILED BY WHITE OAK MANAGEMENT, INC. (HEREINAFTER REFERRED TO AS THE "PETITIONER") FOR AN APPROXIMATELY .764 ACRE SITE LOCATED ON THE WEST SIDE OF DELANE AVENUE, EAST OF THE INTERSECTION OF CRAIG AVENUE AND DELANE AVENUE, WHICH SITE IS MORE PARTICULARLY DEPICTED ON THE REZONING PLAN (HEREINAFTER REFERRED TO AS THE "SITE"). THE SITE IS COMPRISED OF PORTIONS OF TAX PARCEL NOS. 157-162-01, 157-162-02, 157-162-03 AND 157-162-04.
- B. DEVELOPMENT OF THE SITE WILL BE GOVERNED BY THE REZONING PLAN, THESE DEVELOPMENT STANDARDS AND THE APPLICABLE PROVISIONS OF THE CITY OF CHARLOTTE ZONING ORDINANCE (THE "ORDINANCE").
- C. UNLESS THE REZONING PLAN OR THESE DEVELOPMENT STANDARDS ESTABLISH MORE STRINGENT STANDARDS, THE REGULATIONS ESTABLISHED UNDER THE ORDINANCE FOR THE O-2 ZONING DISTRICT SHALL GOVERN ALL DEVELOPMENT TAKING PLACE ON THE SITE.
- D. FUTURE AMENDMENTS TO THE REZONING PLAN AND/OR THESE DEVELOPMENT STANDARDS MAY BE APPLIED FOR BY THE THEN OWNER OR OWNERS OF THE SITE IN ACCORDANCE WITH THE PROVISIONS OF CHAPTER 6 OF THE ORDINANCE. ALTERATIONS TO THE REZONING PLAN ARE SUBJECT TO SECTION 6.207 OF THE ORDINANCE.
- 2. PERMITTED USES/DEVELOPMENT LIMITATIONS**
- A. THE SITE MAY BE DEVOTED ONLY TO OFF-STREET SURFACE PARKING THAT WILL SERVE THE USES LOCATED ON TAX PARCEL NO. 157-166-15.

- 3. TRANSPORTATION**
- A. VEHICULAR ACCESS SHALL BE AS GENERALLY DEPICTED ON THE REZONING PLAN. THE PLACEMENT AND CONFIGURATION OF THE ACCESS POINTS ARE SUBJECT TO ANY MINOR MODIFICATIONS REQUIRED BY THE CHARLOTTE DEPARTMENT OF TRANSPORTATION ("CDOT").
- B. THE ALIGNMENTS OF THE INTERNAL VEHICULAR CIRCULATION AREAS AND THE DRIVEWAYS MAY BE MODIFIED BY PETITIONER TO ACCOMMODATE CHANGES IN TRAFFIC PATTERNS, PARKING LAYOUTS AND ANY ADJUSTMENTS REQUIRED FOR APPROVAL BY CDOT IN ACCORDANCE WITH APPLICABLE PUBLISHED STANDARDS.
- 4. STREETSCAPE/LANDSCAPING/BUFFERS**
- A. BUFFERS SHALL BE ESTABLISHED ON THE SITE AS REQUIRED BY THE ORDINANCE AND AS DEPICTED ON THE REZONING PLAN, AND SUCH BUFFERS SHALL CONFORM TO THE STANDARDS OF SECTION 12.302 OF THE ORDINANCE. THE WIDTH OF ANY REQUIRED BUFFER MAY BE REDUCED BY 25% IF A WALL, FENCE OR BERM IS PROVIDED THAT MEETS THE REQUIREMENTS OF SECTION 12.302(6) OF THE ORDINANCE.
- B. IN THE EVENT THAT AN ADJACENT PARCEL OF LAND IS EITHER REZONED TO A ZONING DISTRICT OR DEVOTED TO A USE THAT ELIMINATES OR REDUCES THE BUFFER REQUIREMENTS ON THE SITE, PETITIONER MAY REDUCE OR ELIMINATE, AS THE CASE MAY BE, THE RELEVANT BUFFER AREAS ACCORDINGLY.
- C. SIDEWALKS AND PLANTING STRIPS SHALL BE INSTALLED ALONG THE SITE'S PUBLIC STREET FRONTAGE AS GENERALLY DEPICTED ON THE REZONING PLAN.

- 5. ENVIRONMENTAL**
- A. DEVELOPMENT OF THE SITE SHALL COMPLY WITH THE CITY OF CHARLOTTE TREE ORDINANCE.
- 6. LIGHTING**
- A. ANY FREESTANDING LIGHTING FIXTURES INSTALLED ON SITE SHALL HAVE A MAXIMUM HEIGHT OF 21 FEET, AND ALL SUCH FREESTANDING LIGHTING FIXTURES SHALL BE FULLY CAPPED AND SHIELDED AND THE ILLUMINATION DOWNWARDLY DIRECTED SO THAT DIRECT ILLUMINATION DOES NOT EXTEND PAST ANY PROPERTY LINE OF THE SITE.
- 7. BINDING EFFECT OF THE REZONING DOCUMENTS AND DEFINITIONS**
- A. IF THIS REZONING PETITION IS APPROVED, ALL CONDITIONS APPLICABLE TO THE USE AND DEVELOPMENT OF THE SITE IMPOSED UNDER THESE DEVELOPMENT STANDARDS AND THE REZONING PLAN WILL, UNLESS AMENDED IN THE MANNER PROVIDED UNDER THE ORDINANCE, BE BINDING UPON AND INURE TO THE BENEFIT OF PETITIONER AND THE CURRENT AND SUBSEQUENT OWNERS OF THE SITE AND THEIR RESPECTIVE SUCCESSORS IN INTEREST AND ASSIGNS.
- B. THROUGHOUT THESE DEVELOPMENT STANDARDS, THE TERM "PETITIONER" SHALL BE DEEMED TO INCLUDE THE HEIRS, DEVISEES, PERSONAL REPRESENTATIVES, SUCCESSORS IN INTEREST AND ASSIGNS OF PETITIONER OR THE OWNER OR OWNERS OF THE SITE FROM TIME TO TIME WHO MAY BE INVOLVED IN ANY FUTURE DEVELOPMENT THEREOF.
- C. ANY REFERENCE TO THE ORDINANCE HEREIN SHALL BE DEEMED TO REFER TO THE REQUIREMENTS OF THE ORDINANCE IN EFFECT AS OF THE DATE THIS REZONING PETITION IS APPROVED.



1. CONTRACTOR IS RESPONSIBLE FOR PLACEMENT OF ALL BARRICADES, SIGNAGE, FLAGGERS, SHORING, ETC., TO ENSURE THE SAFETY OF WORKERS AND THE PUBLIC.
2. ALL PAVEMENT CUTS SHALL BE REPLACED ACCORDING TO NORTH CAROLINA DEPARTMENT OF TRANSPORTATION AND CHARLOTTE WATER.

REVISIONS		
NO.	DATE	DESCRIPTION
1	6/21/18	AMENDED REZONING PLAN

Disclaimer 6/2017:
Information contained in this document is the property of Bloc Design, PLLC, and the project client listed on this document.
The reproduction, copying, and other use without written consent is prohibited and may be subject to legal action to the fullest extent possible.

stamp / seal:

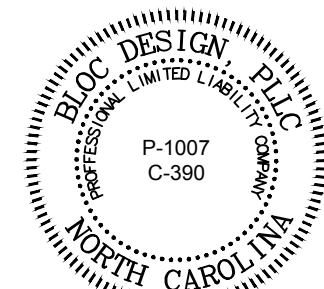

ISSUED FOR CONSTRUCTION	
MANAGING PARTNER (PE):	DATE: _____
MANAGING PARTNER (LA):	DATE: _____
CIVIL ENGINEER/DESIGNER:	DATE: _____
LANDS, ARCHITECT/DESIGNER:	DATE: _____

Craig Ave Rezone
4101-4113 Craig Ave
Charlotte, NC 28211

REZONING PETITION #:
2018-058

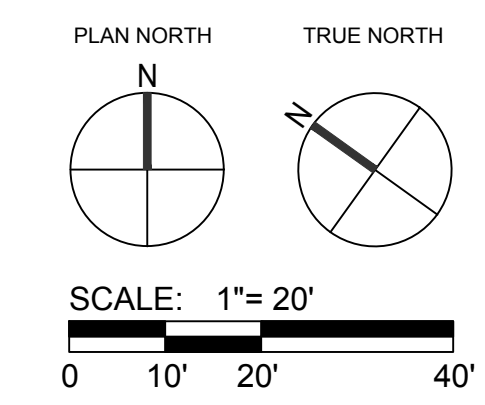

DATE: 04/2018	MPIC: WILL
DRAWN BY: ESB	CHECKED BY: CCBHKG
PROJECT NUMBER: 00433.00	
SCALE: 1"=20'	
TITLE: DEVELOPMENT PLAN & DEVELOPMENT NOTES	
SHEET NO: RZ-1.0	