

**DEVELOPMENT STANDARDS**

**1. GENERAL PROVISIONS**

- A. These Development Standards form a part of the Rezoning Plan associated with the Rezoning Application filed by Forezza Properties ("Applicant") for an approximately 12.5 acre site located on the west side of Steele Creek Road, and just north of Southwest Middle School. This site is depicted on the Rezoning Plan (hereinafter referred to as the "Rezoning Site"). The Rezoning Site is comprised of Tax Parcel No. 19951104 and 19951105.
- B. The development and use of the Rezoning Site will be governed by the Rezoning Plan, these Development Standards and the applicable provisions of the City of Charlotte Zoning Ordinance (the "Ordinance"). Unless the Rezoning Plan establishes more stringent standards the regulations established under the Ordinance for the UR-2 zoning classification shall govern.
- C. The development and uses depicted on the Rezoning Plan are schematic in nature and are intended to depict the general arrangement of the uses and improvements on the Rezoning Site. Accordingly, the ultimate layout, locations and sizes of the development and site elements depicted on the Rezoning Plan are graphic representations of the proposed development and site elements, and subject to the terms of these Development Standards and the Ordinance, are subject to minor alterations or modifications during the design development and construction document phases. Minor modifications to the plan are permitted per Ordinance Section 6.207.

**2. PERMITTED USES/DEVELOPMENT LIMITATIONS**

- A. The Rezoning Site may only be devoted to a residential community containing a maximum of 75 dwelling units and to any incidental or accessory uses relating thereto that are permitted in the UR-2 zoning district. The number of units will vary depending on the final mix of unit types/sizes. However, in no case shall the total number exceed 75 units.
- B. All units will be alley loaded, accessed from the rear of the unit.

- C. Trash pick up will be provided by roll out carts.
- D. Development of the Rezoning Site shall generally comply with the dimensional standards of the UR-2 zoning district set out in the Ordinance and the dimensional standards set out in the Site Data Table.

- E. The residential community to be located on the Rezoning Site shall be subject to a Declaration of Covenants, Conditions and Restrictions that will be recorded in the Mecklenburg County Registry (the "Covenants"). The Covenants shall, among other things, require the establishment of a mandatory homeowner's association for the residential community.

**3. TRANSPORTATION**

- A. Vehicular access shall be as generally depicted on the Rezoning Plan. The placement and configuration of the access points are subject to any minor modifications required to accommodate final site and construction plans and designs and to any adjustments required for approval by the City of Charlotte and/or the North Carolina Department of Transportation ("NCDOT").
- B. Prior to the issuance of the first certificate of occupancy for a new one-family attached dwelling unit to be constructed on the Rezoning Site, Applicant shall dedicate and convey to NCDOT (subject to a reservation for any necessary utility easements) those portions of the Rezoning Site immediately adjacent to Steele Creek Road as required to provide right of way measuring 65.5 feet from the existing centerline of Steele Creek Road, to the extent that such right of way does not already exist.
- C. Road Improvements: Petitioner agrees to extend Settlers Trail Court from the western property line to Steele Creek Road as generally depicted on the Rezoning Plan. The public street will be designed per City of Charlotte Requirements for a Residential Wide cross section.
- D. The petitioner will provide a north bound turn lane on Steele Creek Road with 150' of storage. This turn lane will meet CDOT requirements for storage and stacking.
- E. The petitioner will construct a 6 foot sidewalk on Steele Creek Rd

across the site frontage and extending to the existing sidewalk of the northern entrance of Southwest Middle School. The front of sidewalk is located 60.5 feet from centerline of the road as required by CDOT.

- F. The petitioner will dedicate right of way, fee simple, of 74.5' from the centerline of Steele Creek Road to accommodate the future widening of Steele Creek Road as required by CDOT.
- G. Petitioner will not install curb and gutter along the site frontage of Steele Creek Road. Petitioner will add additional signage as required by CDOT as depicted on the Rezoning Site Plan.

- H. All transportation improvements will be approved and constructed before the site's first building certificate of occupancy is issued. The petitioner may phase transportation improvements if said improvements and phasing are explicitly described in site plan notes.

**4. ARCHITECTURAL STANDARDS**

- A. The maximum height of any one-family attached dwelling unit constructed on the Rezoning Site shall be 33 feet.
- B. Attached to the Rezoning Plan are a series of conceptual, schematic images of the front elevations of the one-family attached dwelling units to be constructed on the Rezoning Site that are intended to depict the general conceptual architectural style, design treatment and character of the front elevations of the one-family attached dwelling units to be constructed on the Rezoning Site. Accordingly, each one-family attached dwelling unit to be constructed on the Rezoning Site shall be designed and constructed so that the front elevation is substantially similar in appearance to one of the attached conceptual, schematic images. Notwithstanding the foregoing, changes and alterations to the front elevation of a one-family attached dwelling unit to be constructed on the Rezoning Site that do not materially change the overall conceptual architectural style, design treatment and character shall be permitted.
- C. The primary exterior building materials for the one-family attached dwelling units to be constructed on the Rezoning Site will be a combination of portions of the following: brick veneer or similar masonry products, stone, manufactured stone, and cementitious siding.

- D. Vinyl, EPS or masonite may not be used as an exterior building material on the one-family detached dwelling units to be constructed on the Rezoning Site. Notwithstanding the foregoing, vinyl may be utilized on windows, doors, garage doors, soffits, trim and railings.
- E. All units will be rear loaded, accessed by private alley. Each garage will be setback from the alley per the CMUDS requirements.

- F. To provide privacy, all residential entrances within 15 feet of the sidewalk must be raised from the average sidewalk grade a minimum of 24 inches.
- G. Pitched roofs, if provided will utilize a main body roof pitch of 6:12 and accents of 12:12 (forward facing gables) and 3:12 (heads).

- H. Usable porches and stoops shall form a predominant feature of the building design and be located on the front and/or side of the building. Usable front porches should be covered and be at least 6 feet deep. Stoops and entry-level porches may be covered but should not be enclosed.

- I. All corner/end units that face a public or private street should have a porch or stoop that wraps a portion of the front and side of the unit or provide blank wall provisions that limit the maximum blank wall exposure to 10 feet on all building levels.

- J. Garage doors visible from public or private streets should minimize the visual impact by providing a setback of 12 to 24 inches from the front wall plane and additional architectural treatments such as translucent windows or projecting elements over the garage door opening.
- K. Walkways should be provided to connect all residential entrances to sidewalks along public and private streets.

- L. Townhouse buildings should be limited to 6 individual units or fewer.

**5. Streetscape and Landscaping**

- A. A 25' setback as measured from the west property line will be provided as generally depicted on the Rezoning Plan.

- B. A 15' setback as measured from the southern property line will be provided as generally depicted on the Rezoning Plan.
- C. A 30' setback from the future Right of Way on Steele Creek Road will be provided as generally depicted on the Rezoning Plan.

- D. No trees can be removed from or planted in the right of way of any State maintained street (Steele Creek Rd.) without permission of NC Department of Transportation and the City Arborist's office. Trees must be planted to meet NCDOT planting guidelines, specifically, small maturing trees are required to be planted 8 feet from edge of travel lane on Steele Creek Rd. If there is a curb and gutter installed, if the shoulder remains, small maturing trees are required to be planted 10 feet from edge of travel lane on Steele Creek Rd. In order to meet this requirement, the width of the planting strip is required to be a minimum of 12 feet wide as measured from back of curb.

- E. Petitioner will dedicate and convey the land within the 50' PCSO and Swim Buffer along the northern property edge to Mecklenburg County for future greenway use.
- F. Open space will be provided as generally depicted on the Rezoning Site Plan. Two linear parks adjacent to Settlers Trail Court will be created that will include benches, hardscape and pedestrian lighting that will act as neighborhood gathering spots.

**6. Environmental Features**

- A. Petitioner shall comply with the Charlotte City Council approved and adopted Post Construction Controls Ordinance.
- B. The location, size and type of storm water management systems depicted on the Rezoning Plan are subject to review and approval as part of the full development plan submittal and are not implicitly approved with this rezoning. Adjustments may be necessary in order to accommodate actual storm water treatment requirements and natural site discharge points.
- C. This site will comply with the Tree Ordinance.

- 7. SIGNS**  
A. All signs installed on the Rezoning Site shall comply with the requirements of the Ordinance.
- 8. LIGHTING**  
A. Outdoor lighting fixtures installed on the Rezoning Site shall comply with the requirements of the Outdoor Illumination provisions of the Ordinance.
- 9. BINDING EFFECT OF THE REZONING APPLICATION**  
A. If this Rezoning Application is approved, all conditions applicable to the development and/or use of the Rezoning Site imposed under the Ordinance, be binding upon and inure to the benefit of Applicant and the current and subsequent owners of the Rezoning Site and their respective successors in interest and assigns. Throughout these Development Standards, the terms "Applicant" and "owner" or "owners" shall be deemed to include the heirs, devisees, personal representatives, successors in interest and assigns of Applicant or the owner or owners of the Rezoning Site from time to time who may be involved in any future development thereof.

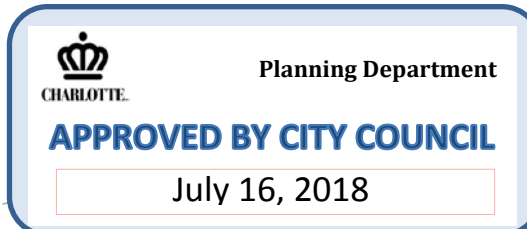

**Development Data**

**Address:** 13608 Steele Creek Road  
Charlotte, NC 28278

**Tax Parcel Number:** 19951104 & 19951105

**Zoning Classification:** R-3

**Proposed Zoning:** UR-2 (CD)

**Project Site Area:** +/- 12.5 acres

**Dedicated R/W:** 0.63 ac.

**Net Site Area:** 11.87 ac.

**Tree Preservation Area Required:** 15% of 11.87ac = 1.78ac.

**Tree Preservation Provided:** 1.90 ac

**Existing Uses:** Vacant

**Proposed Use:** Townhomes

**Proposed Units:** 75 Townhomes

**Proposed Density:** 6.3 DUA

**PCSO Open Space Required:** 17.5% (+/- 2.18 ac.)

**PCSO Open Space Provided:** 20% (+/- 2.5 ac.)

**Proposed Floor Area Ratio:** As allowed in the UR-2 zoning district

**Maximum Building Height:** 35'

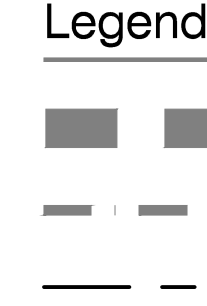

71' R/W centerline  
Alley Centerline  
Proposed RW

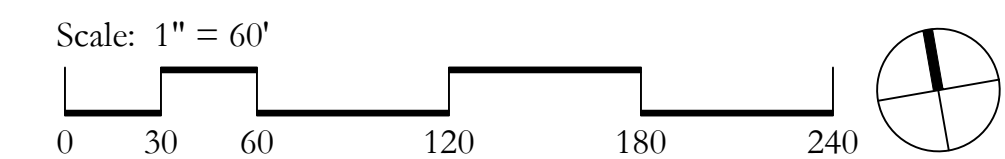
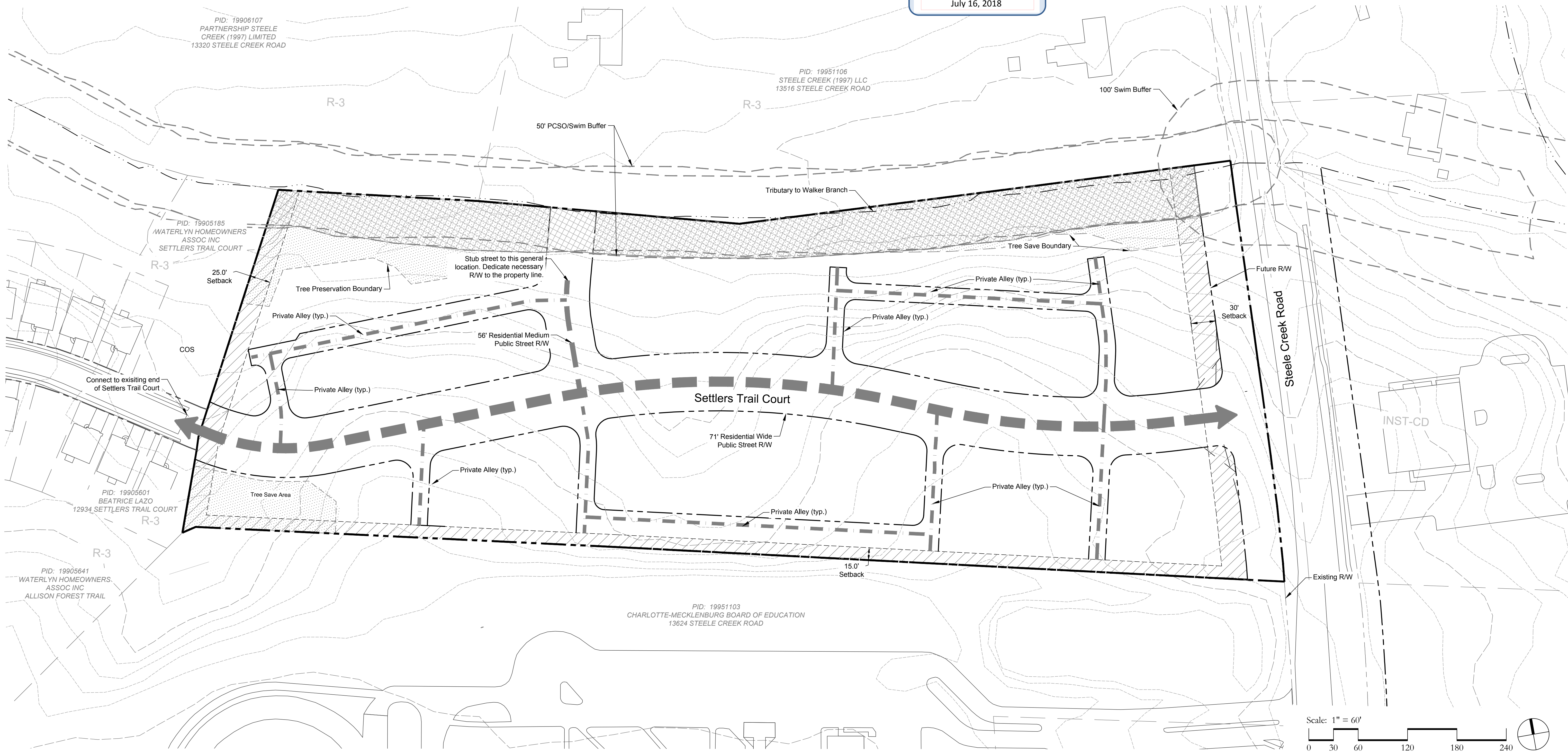

**MERRICK**  
1001 MOREHEAD SQUARE DRIVE, SUITE 150  
CHARLOTTE, NC 28203  
PHONE: 774.520.8500  
FAX: 774.520.8501  
MERRICK PROPERTY GROUP  
THE ABOVE INFORMATION WAS OBTAINED FROM AN INSTRUMENT  
RECORDED IN THE PUBLIC RECORDS OF MECKLENBURG COUNTY, NC.  
IT IS NOT INTENDED OR REPRESENTED TO BE GUARANTEED OR  
WARRANTED IN ANY MANNER. THE USER OF THIS INFORMATION  
SHOULD CONSULT WITH AN ATTORNEY FOR A SHORDED INSTRUMENT.  
DATE OF PREPARATION: 06/25/2018 10:00:54 AM  
DRAWN BY: [Redacted] CHECKED BY: [Redacted] APPROVED BY: [Redacted]

**FIORENZA PROPERTIES, LLC**  
301 Fieldbrook Place  
Charlotte, NC 28209

REVISIONS:	DATE:	DESIGN BY:	CHECKED BY:	APPROVED BY:	DATE:	REVISION DESCRIPTION:	DRAWN BY:	CHECKED BY:	APPROVED BY:
2nd Rezoning Submittal: 06/14/18									
3rd Rezoning Submittal: 06/25/18									

**Cedar Ridge at Steele Creek**  
Charlotte, North Carolina

**Technical Data Sheet**  
Petition #2018-037

JOB NO.: 65119618-00  
DATE: 03/13/2018  
SHEET: RZ-1

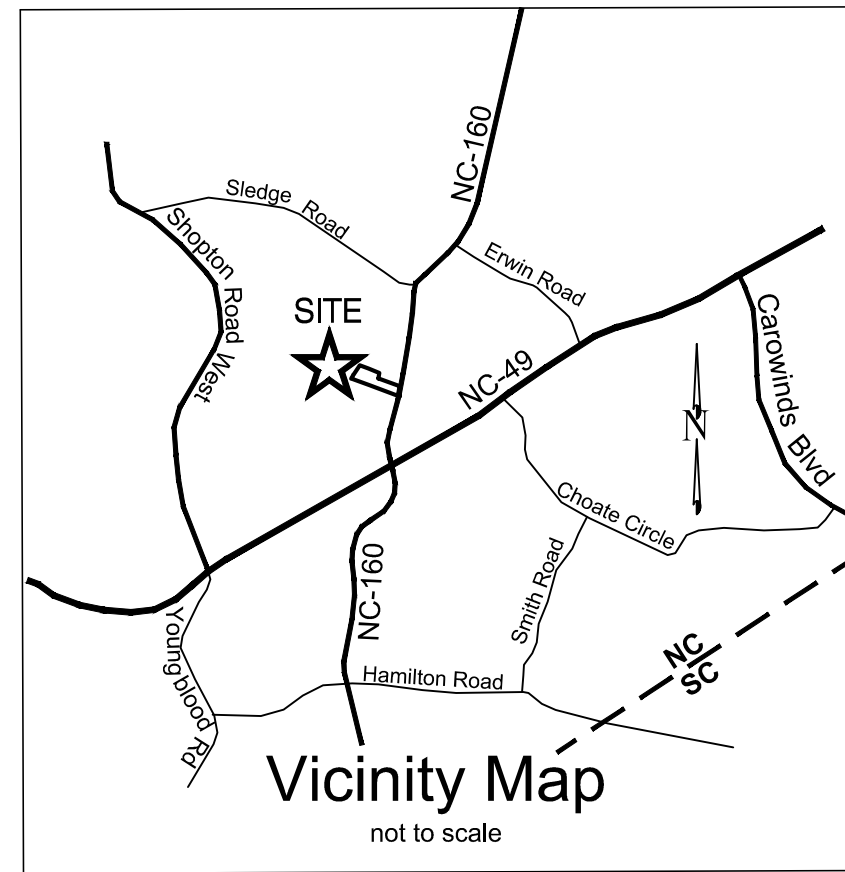

PID: 19906107  
PARTNERSHIP STEELE  
CREEK (1997) LIMITED  
13320 STEELE CREEK ROAD

R-3

PID: 19951106  
STEELE CREEK (1997) LLC  
13516 STEELE CREEK ROAD

R-3

PID: 19905185  
WATERLYN HOMEOWNERS  
ASSOC INC  
SETTLERS TRAIL COURT

R-3

PID: 19905601  
BEATRICE LAZO  
12934 SETTLERS TRAIL COURT

R-3

PID: 19905641  
WATERLYN HOMEOWNERS  
ASSOC INC  
ALLISON FOREST TRAIL

R-3

PID: 19951103  
CHARLOTTE-MECKLENBURG BOARD OF EDUCATION  
13624 STEELE CREEK ROAD

Southwest  
Middle  
School

Scale: 1" = 60'

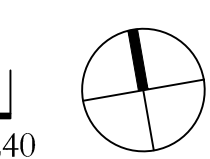
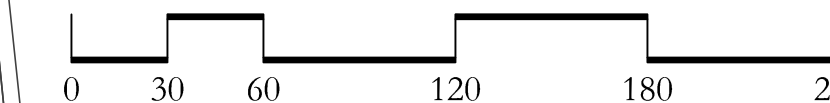

Right of way dedicated to the project boundary

Hatched Area within 50' PCSO /SWIM Buffer to be dedicated and conveyed to Mecklenburg County for future greenway use

Potential BMP

Potential BMP

Potential BMP

COS - Linear Park +/- 12,000 sf

COS - Linear Park +/- 3800 sf

COS +/- 5500 sf

Private Alley

Private Alley

Private Alley

Townhome (typ.)

Townhome (typ.)

Potential Dumpster Pad location

Potential Dumpster Pad location

25' Setback

Potential Dumpster Pad location

Driveway, typ.

Tie to existing Settlers Trail Court

Tree Save Area

Front yard, typ.

15' Class C Buffer

15.0' Setback

Driveway, typ.

5' Sidewalk

Front yard, typ.

Property Boundary

Provide sidewalk connection along Steele Creek Road to this location

100' PCSO /SWIM Buffer

50' PCSO /SWIM Buffer

Existing Right of Way

74.5' From CL

44' 50" Dedicated RW

Proposed RW

35'x35' and 10' x 70' Site Triangle

Steele Creek Road

INST-CD

Full movement access intersection. Petitioner will provide a north bound left turn lane into site per CDOT requirements

Existing EOP

Proposed EOP

Existing RW

**MERRICK**  
1001 MOREHEAD SQUARE DRIVE, SUITE 530  
CHARLOTTE, NC 28203  
PHONE: 704.520.6500  
FAX: 704.520.6501  
WWW.MERRICKINC.COM  
THIS AND ALL OTHER ELECTRONIC MEDIA TRANSMISSIONS ARE SUBJECT TO OUR TERMS AND CONDITIONS OF SERVICE. IF YOU ARE NOT A REGISTERED USER OF OUR WEBSITE, YOU WILL NOT BE ABLE TO ACCESS ANY OF THE CONTENTS OF OUR WEBSITE. BY VISITING OUR WEBSITE, YOU AGREE TO OUR TERMS AND CONDITIONS OF SERVICE. THESE TERMS AND CONDITIONS OF SERVICE WILL APPLY TO ALL CONTENTS OF OUR WEBSITE, INCLUDING ALL CONTENTS OF OUR WEBSITE.

**FIORENZA PROPERTIES, LLC**  
301 Fieldbrook Place  
Charlotte, NC 28209

REVISIONS:	DATE:	DESCRIPTION:	BY:	DATE:	DESCRIPTION:	BY:
2nd Revising Submittal: 05/14/18						
3rd Revising Submittal: 06/25/18						

DESIGN BY:	DATE:
DRAWN BY:	DATE:
CHECKED BY:	DATE:
APPROVED BY:	DATE:

**Cedar Ridge at Steele Creek**  
Charlotte, North Carolina  
**Rezoning Site Plan**  
**Petition #2018-037**

JOB NO: 65119618-00  
DATE: 03/13/2018  
SHEET **RZ-2**

Q:\CHAP\Projects\9618-00-FZP - Miscellaneous Planning Services\Design\Working\Steele Creek Site\Rezoning\2018-05-07-Technical Data Sheet\_2ndsubmittal.dwg 6/25/2018 10:04:56 AM



Building Elevations (typ.)

JOB NO: 65119618-00  
 DATE: 03/13/2018  
 SHEET RZ-3

Cedar Ridge at Steele Creek  
 Charlotte, North Carolina  
 Schematic Elevations  
 Petition #2018-

DESIGN BY:  
 DRAWN BY:  
 CHECKED BY:  
 APPROVED BY:

REV	REVISION DESCRIPTION	DATE	DRAWN	CHECKED	APPROVED

FIORENZA  
 PROPERTIES, LLC  
 301 Fieldbrook Place  
 Charlotte, NC 28209

**MERRICK**  
 1001 MOREHEAD SQUARE DRIVE, SUITE 530  
 CHARLOTTE, NC 28203 PHONE: 704.520.8500  
 FAX: 704.520.8501  
 WWW.MERRICKDESIGN.COM  
 THIS AND ALL OTHER ELECTRONIC MEDIA CONSTITUTE AN INSTRUMENT OF SERVICE. IT IS NOT INTENDED OR REPRESENTED TO BE SUITABLE FOR USE IN ANY COURT OF LAW OR IN ANY OTHER JURISDICTION. THE USER'S SOLE RESPONSIBILITY IS TO VERIFY THE ACCURACY OF ANY INFORMATION AND TO OBTAIN NECESSARY PERMITS AND APPROVALS FROM THE APPROPRIATE AGENCIES. THE USER'S SOLE RESPONSIBILITY IS TO OBTAIN NECESSARY PERMITS AND APPROVALS FROM THE APPROPRIATE AGENCIES.