

APPROVAL STAMP

CHARLOTTE, NC:

Foxmoor & Carmel Rd.
Charlotte, NC 28226

SITE PLAN #

Site Data Summary

Existing Zoning: R-3

Proposed Zoning: R-8 (Conditional)

Parcel ID: Parcel 1: 20930159

Approximate Acreage:

- Parcel 1 = 0.17 ACRES
- Parcel 2 = 0.16 ACRES
- Parcel 3 = 0.16 ACRES
- Parcel 4 = 0.16 ACRES
- Parcel 5 = 0.18 ACRES
- Parcel 6 = 0.12 ACRES
- Parcel 7 = 0.26 ACRES
- Total = 1.19 ACRES

Building Setbacks:

- Front (ROW): 20'
- Rear: 20'
- Side: 20'

Landscape Requirements:

Tree save areas must cover 15% of gross acreage (36 trees per acre) and be at least 20' wide with a spacing of 30-40'. If 15% cannot be saved, planted trees must conform to the same requirements.

Date Prepared: 08/08/2017	Drawn By: MM



CORPORATE OFFICE:

106 FOSTER AVE

CHARLOTTE, NC 28203

PITTSBURGH OFFICE:

5500 BROOKTREE RD; SUITE 303

WEXFORD, PA 15090

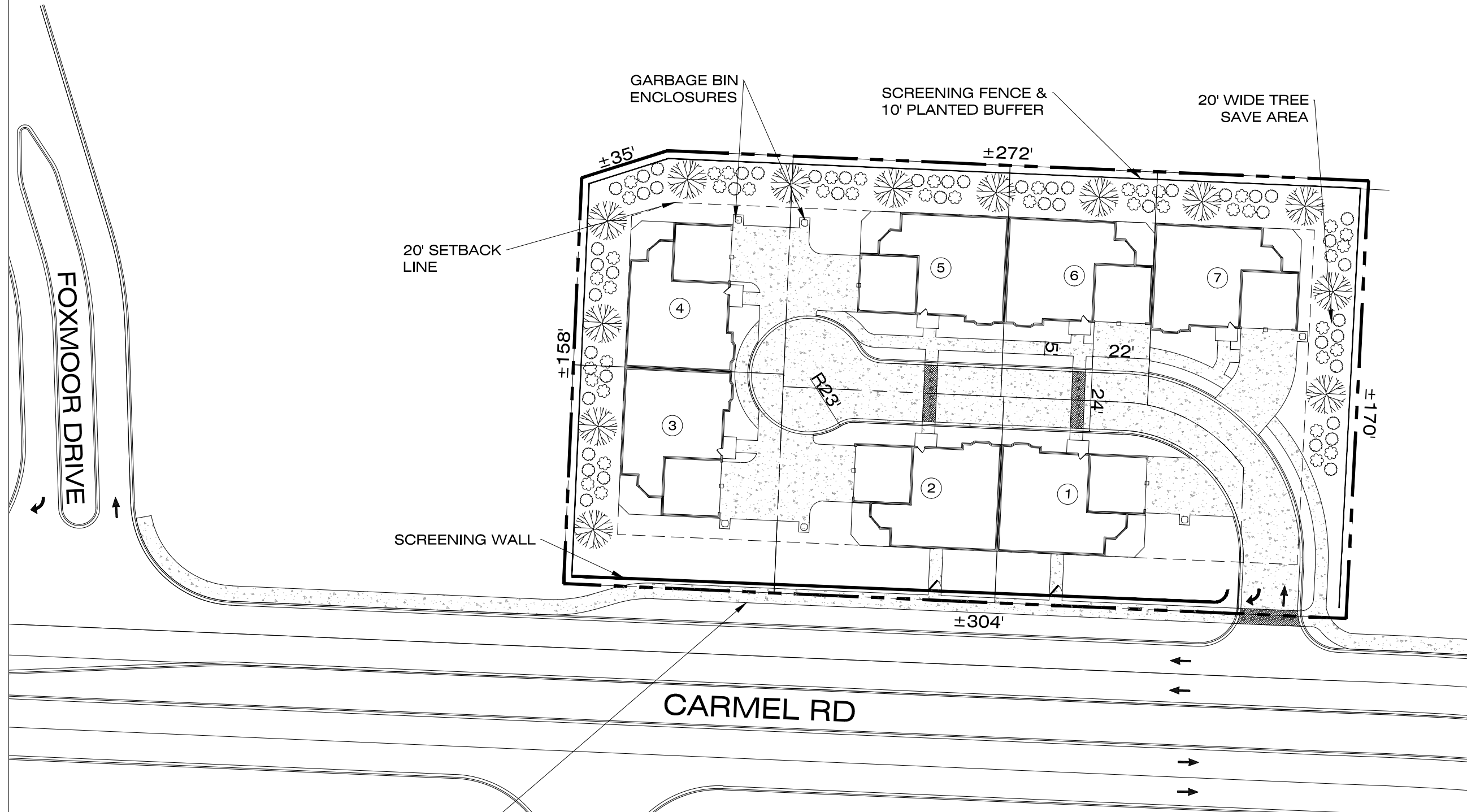

NOTE:

1. PLAN IS BASED ON PRELIMINARY INFORMATION AND TO BE USED FOR SCHEMATIC PURPOSES ONLY NOT FOR CONSTRUCTION.
2. CURB CUTS HAVE NOT BEEN REVIEWED OR APPROVED BY STATE AND LOCAL DOT.
3. ALL ACREAGES, METES, AND BOUNDS SUBJECT TO SURVEY.
4. ANY LANDSCAPING SHOWN IS AN APPROXIMATE LOCATION. FINAL DESIGN WILL BE DONE BY A LICENSED PROFESSIONAL.