

LEGEND	
	FOCAL POINT ON KEY CORNER
	REQUIRED INTERNAL PRIVATE STREET DESIGNED TO PUBLIC STANDARDS
	PRIVATE ACCESS DRIVE
	BUILDING FRONTAGE AREA
	RETAIL BUILDING CORNER
	PERMISSIBLE PARKING AREA
	SETBACK/BUFFER LINE
	EXISTING RIGHT-OF-WAY
	FUTURE RIGHT-OF-WAY
	FULL MOVEMENT ACCESS POINTS
	POTENTIAL FULL MOVEMENT SITE/BUILDING ACCESS POINTS INTO DEVELOPMENT
	OPTIONAL RIGHT IN/RIGHT OUT MOVEMENT ACCESS POINTS
	AMENITIZED PUBLICLY ACCESSIBLE OPEN SPACE
	EXISTING BUILDING (MAY REMAIN)

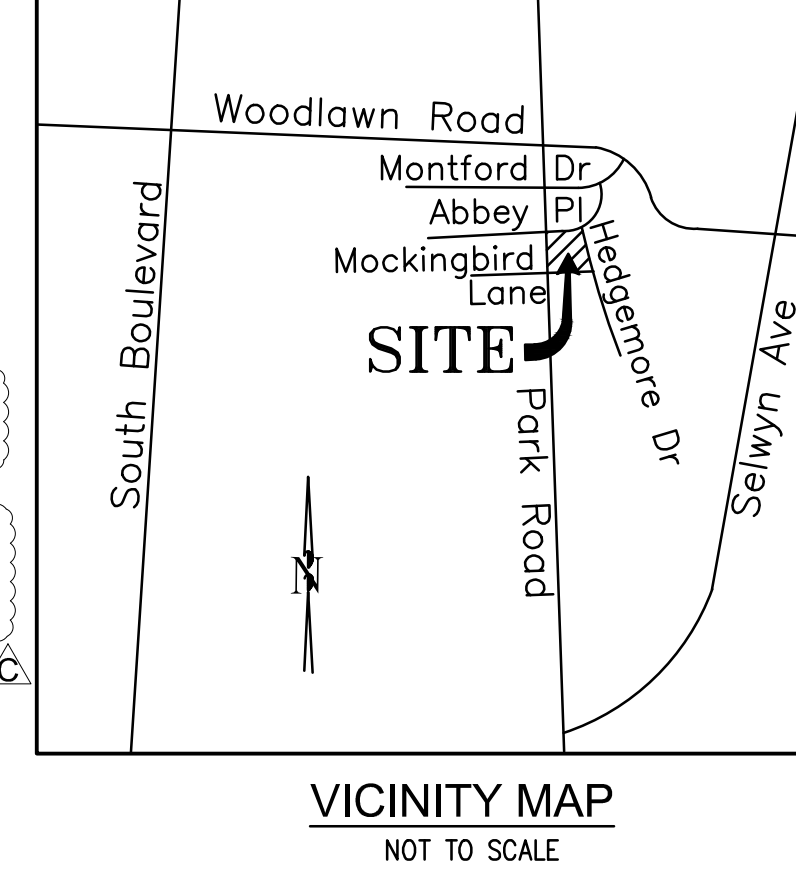

ZONING CODE SUMMARY

PROJECT NAME:	PARK ROAD REDEVELOPMENT
OWNER:	PARK CHARLOTTE, LLC
CLIENT NAME:	GRUBB PROPERTIES, PHONE# (704) 372-5616
PLANS PREPARED BY:	KIMLEY-HORN AND ASSOCIATES PHONE# (704)333-5131
TAX PARCEL ID:	17514401, 17514402
STREET ADDRESS:	PARK ROAD AT ABBEY PLACE
EXISTING ZONING:	O-1
PROPOSED ZONING:	MUDD-O
PROPOSED USE:	MIXED USE: RETAIL/OFFICE/MULTIFAMILY
PROPOSED BUILDING HEIGHT:	AS ALLOWED BY THE APPLICABLE ZONING DISTRICT. SEE TECHNICAL DEVELOPMENT STANDARDS (RZ-2) FOR MORE INFORMATION.
EXISTING LOT SIZE:	±10.66 ACRES
JURISDICTION:	CITY OF CHARLOTTE

Kimley-Horn
 NC License #F-0102
 200 SOUTH TRYON ST.
 SUITE 200
 CHARLOTTE, NC 28202
 PHONE: (704) 333-5131
 © 2016

NO.	DATE	REVISIONS
C	1/21/16	REVISED PER CITY COMMENTS
B	12/18/15	REVISED PER CITY COMMENTS
A	9/28/15	REVISED PER CITY COMMENTS

CLIENT: GRUBB PROPERTIES
 4500 CAMERON VALLEY PARKWAY
 SUITE 350
 CHARLOTTE, NORTH CAROLINA 28211

PROJECT: PARK ROAD REDEVELOPMENT
 PARK RD AT ABBEY PLACE
 CHARLOTTE, NC

TITLE: TECHNICAL DATA SHEET

DESIGNED BY: TEB
DRAWN BY: DMH
CHECKED BY: ECH
DATE: 08/03/15
PROJECT#: 017079000

RZ-1

PETITION NO. 2015-120

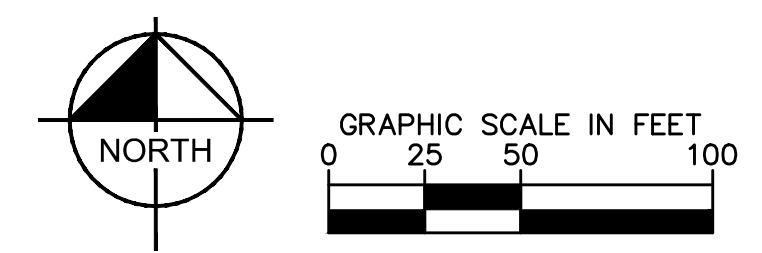

K:\CHL_PRA\017079 GRUBB PROPERTIES\000 PARK ROAD\DWG\EXHIBITS\2015-0702_REZONING\RZ-1_TECHNICAL_DATA.DWG

THIS DOCUMENT, TOGETHER WITH THE CONCEPTS AND DESIGNS PRESENTED HEREIN, AS AN INSTRUMENT OF SERVICE, IS INTENDED ONLY FOR THE SPECIFIC PURPOSE AND CLIENT FOR WHICH IT WAS PREPARED. REUSE OF AND IMPROPER RELIANCE ON THIS DOCUMENT WITHOUT WRITTEN AUTHORIZATION AND ADAPTATION BY KIMLEY-HORN AND ASSOCIATES, INC. SHALL BE WITHOUT LIABILITY TO KIMLEY-HORN AND ASSOCIATES, INC.

