

U:\2014\154\Draw\154\Sheet\Prelim_Engineering\Existing Conditions_Prelim_Land_Saved By: emadmoda, 5/9/2014 8:48 AM Last Printed By: Mgsdmoda, 5/9/2014 8:48 AM



DEVELOPMENT DATA

Site Acreage:
Existing: 3.72± Acres(162,043 SF)
Proposed: 3.72± Acres(162,043 SF)
Tax Parcel No.: 03711204

Zoning:
Existing: R-4
Proposed: UR-2 (CD)
Existing Use: Single Family Residential
Proposed Use: Elderly Multi-Family Residential (*See Note)

Building Data:
Proposed Number of Units: 82
Proposed Density: 82 Dwelling Units/3.72 Ac. = 22.0 D.U.A.
Floor Area Ratio: 1.0
Allowable: 108,900 SF/162,043 SF = 0.67
Provided: 47'
Maximum Building Height: 47'

Setbacks/Yards:
Required:
Front Setback: 14' From back of curb
Side Yard: 5'
Rear Yard: 10'
Provided:
Front Setback: 40'
Side Yard: 5'
Rear Yard: 10'

Parking:
Auto Parking:
Required: 0.25 space per Unit
82 Units x 0.25 = 21 Spaces
Provided: 32 Standard Spaces
10 Handicap Spaces
42 Total Spaces
Short Term Bike Parking:
Required: 1 space per 20 Units
82 Units x 1/20 Space per Unit = 5 Spaces
Provided: 5

Tree Save Area:
Required: 162,043 SF x 15% = 24,306± SF
Provided: 28,890 SF

NOTE: * Magnolia Garden Apartments will be developed as housing intended and operated for occupancy by persons aged 55 and older. In that definition, the units must be occupied by at least one (1) person who is 55 years of age or older and any other occupants must be at least 45 years of age. However, up to 10% of the units may be occupied by persons the ages of 45 and older if they meet the definition of handicap or disabled, provided verification of such is obtained

- FEMA NOTE**
- The proposed Site is located outside of the 100 year floodplain.
 - According to the Federal Emergency Management Agency's Flood Insurance Map, dated March 02, 2009, the subject tract shown herein does not lie within Zone "X" (areas determined to be outside 0.2% annual chance floodplain), Community Panel Nos. 3701594547 J.
 - In areas where the Floodway Regulations are applicable, the Future Conditions Line, FEMA Flood Fringe Line, Community Encroachment Line, and FEMA Floodway Encroachment Line shall be shown on the preliminary plan and the final plat. An application for a Floodlands Development Permit shall be submitted and approved to the County Engineering Department in accordance with the requirements set forth in the City/County Floodway Regulations prior to plan approval.

SHEET INDEX

EXISTING CONDITIONS PLAN	RZ-1.0
SKETCH PLAN	RZ-2.0
REZONING NOTES	RZ-3.0

GRAPHIC SCALE

0 25 50 100
1 inch = 50 feet

PRELIMINARY
NOT TO BE USED FOR
CONSTRUCTION

PLAN SET DATE
March 20, 2014

REZONING PETITION 2014-032

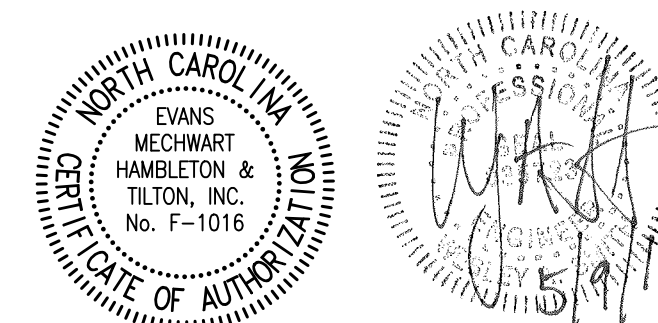

MARK	DATE	DESCRIPTION
1	03/20/14	REVISED PER CITY OF CHARLOTTE COMMENTS
2	04/22/14	REVISED PER CITY OF CHARLOTTE COMMENTS
3	05/29/14	REVISED PER CITY OF CHARLOTTE COMMENTS

REVISIONS

The Affordable Housing Group of NC
4600 Park Road, Suite 390
Charlotte, NC 28209
PH: (704) 342-3316

CITY OF CHARLOTTE, MECKLENBURG COUNTY, NC
FOR
MAGNOLIA GARDENS
EXISTING CONDITIONS PLAN

EMH
EVANS HAMBLETON & TILTON, INC.
ENGINEERS - SURVEYORS - PLANNERS - SCIENTISTS
15400 E. HIGHWAY 100, SUITE 100
CHARLOTTE, NC 28210
PHONE: 704.546.0333 FAX: 704.546.0335
emht.com

DATE
March 20, 2014

SCALE
1" = 50'

JOB NO.
2014-0154

SHEET
RZ-1.0

\\20140154\Draw\04\Sheet\Prelim Engineering\Sketch\Plan\Set Date: 5/9/2014 8:33 AM Last Printed By: Mcdonald, Andrew, 5/9/2014 8:48 AM

PRELIMINARY
NOT TO BE USED FOR
CONSTRUCTION

PLAN SET DATE
March 20, 2014

NOW OR FORMERLY
GLENLEA PARK HOMEOWNERS
ASSOCIATION
PARCEL #03711796
DEED BOOK 13692 PAGE 402
ZONED R-12MF(CD)

NOW OR FORMERLY
GLENLEA PARK HOMEOWNERS
ASSOCIATION
PARCEL #03711791
DEED BOOK 23518 PAGE 127
ZONED R12-MF(CD)

NOW OR FORMERLY
GLENLEA PARK HOMEOWNERS
ASSOCIATION
PARCEL #03711792
DEED BOOK 23518 PAGE 127
ZONED R12-MF(CD)

NOW OR FORMERLY
GLENLEA PARK HOMEOWNERS
ASSOCIATION
PARCEL #03711793
DEED BOOK 23518 PAGE 127
ZONED R-12MF(CD)

NOW OR FORMERLY
KAPPAS OF CHARLOTTE INC
PARCEL #03711206
DEED BOOK 5307 PAGE 928
(APPROX. DEED PLOT)
ZONED R-9MF(CD)

NOW OR FORMERLY
KAPPAS OF CHARLOTTE INC
PARCEL #03711205
DEED BOOK 18696 PAGE 753
ZONED R-4

NOW OR FORMERLY
ADAM BARNES JR.
PARCEL #03737117
DEED BOOK 03020 PAGE 273
ZONED R-3

NOW OR FORMERLY
JHP HOLDING COMPANY LLC
PARCEL #03737206
DEED BOOK 28783 PAGE 99
ZONED R-3

NOW OR FORMERLY
CAROLINA MAGEE LLC
PARCEL #03711203
DEED BOOK 12571 PAGE 518
ZONED B-1(CD)

NOTES:

- 1.) Two (2) additional 3" canopy trees to be provided along the frontage of Beatties Ford Road.
- 2.) Additional 3" canopy trees shall be planted within the proposed 26' type "C" buffer at a rate of 1 tree per 2500 SF, up to a maximum of five (5) trees.

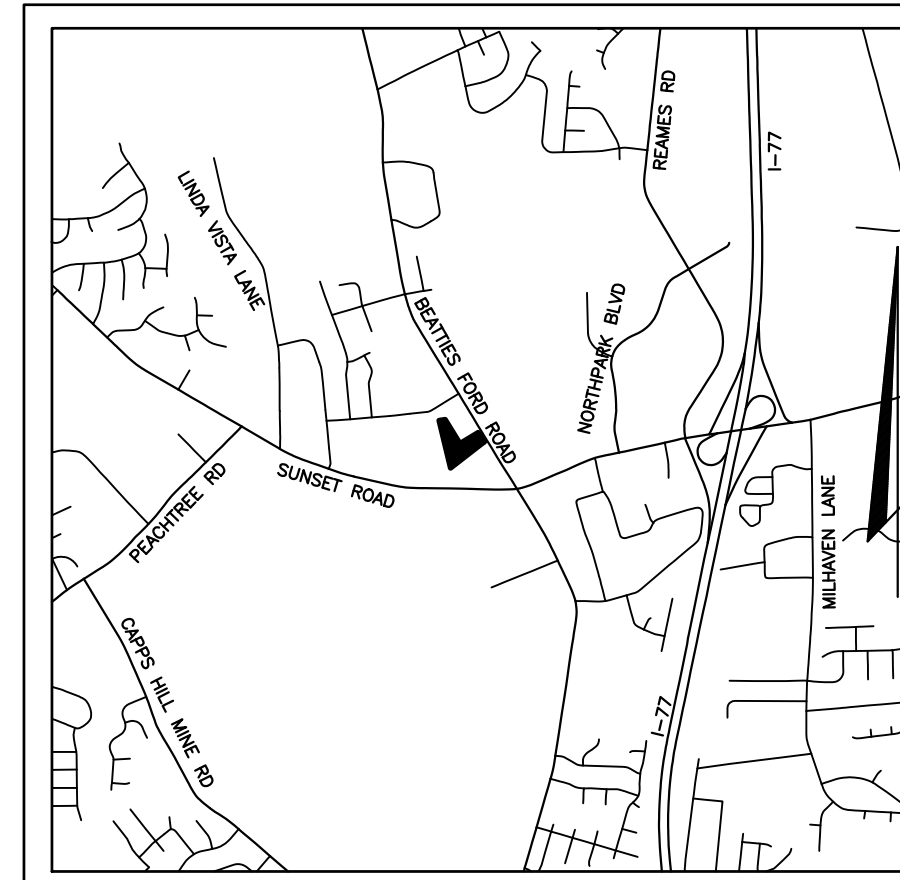

LOCATION MAP
Not to Scale

DEVELOPMENT DATA

Site Acreage

Existing: 3.72± Acres(162,043 SF)
Proposed: 3.72± Acres(162,043 SF)
Tax Parcel No.: 03711204
Zoning:
Existing: R-4
Proposed: UR-2 (CD)
Existing Use: Single Family Residential
Proposed Use: Elderly Multi-Family Residential (*See Note)

Building Data

Proposed Number of Units: 82
Proposed Density: 82 Dwelling Units/3.72 Ac. = 22.0 D.U.A.
Floor Area Ratio:
Allowable: 1.0
Provided: 108,900 SF/162,043 SF = 0.67
Maximum Building Height:
Allowed: 47'

Setbacks Yards:

Required: Front Setback: 14' From back of curb
Side Yard: 5'
Rear Yard: 10'
Provided: Front Setback: 40'
Side Yard: 5'
Rear Yard: 10'

Parking

Auto Parking:
Required: 0.25 space per Unit
82 Units x 0.25 = 21 Spaces
Provided: 32 Standard Spaces
10 Handicap Spaces
42 Total Spaces

Short Term Bike Parking:

Required: 1 space per 20 Units
82 Units x 1/20 Space per Unit = 5 Spaces
Provided: 5

Tree Save Area

Required: 162,043 SF x 15% = 24,306± SF
Provided: 28,890 SF

NOTE: * Magnolia Garden Apartments will be developed as housing intended and operated for occupancy by persons aged 55 and older. In that definition, the units must be occupied by at least one (1) person who is 55 years of age or older and any other occupants must be at least 45 years of age. However, up to 10% of the units may be occupied by persons the ages of 45 and older if they meet the definition of handicap or disabled, provided verification of such is obtained

FEMA NOTE

1. The proposed Site is located outside of the 100 year floodplain.
2. According to the Federal Emergency Management Agency's Flood Insurance Map, dated March 02, 2009, the subject tract shown herein does not lie within Zone "X" (areas determined to be outside 0.2% annual chance floodplain), Community Panel Nos. 3701594547 J.
3. In areas where the Floodway Regulations are applicable, the Future Conditions Line, FEMA Flood Fringe Line, Community Encroachment Line, and FEMA Floodway Encroachment Line shall be shown on the preliminary plan and the final plot. An application for a Floodlands Development Permit shall be submitted and approved to the County Engineering Department in accordance with the requirements set forth in the City/County Floodway Regulations prior to plan approval.

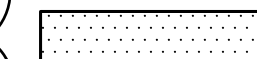

Proposed Sidewalk



Tree Save Area

NOTE: All dimensions are from face of curb unless otherwise noted

GRAPHIC SCALE

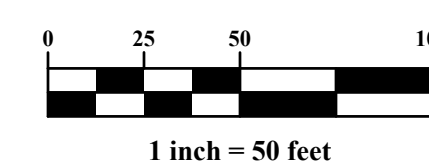

REZONING PETITION 2014-032

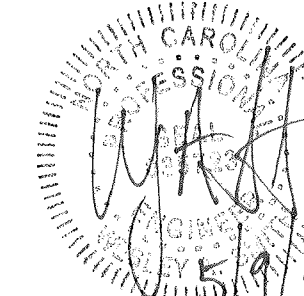
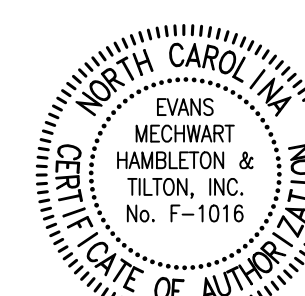

MARK	DATE	DESCRIPTION
1	03/20/14	REVISED PER CITY OF CHARLOTTE COMMENTS
2	04/22/14	REVISED PER CITY OF CHARLOTTE COMMENTS
3	05/07/14	REVISED PER CITY OF CHARLOTTE COMMENTS

The Affordable Housing Group of NC
4600 Park Road, Suite 390
Charlotte, NC 28209
PH: (704) 342-3316

CITY OF CHARLOTTE, MECKLENBURG COUNTY, NC
FOR
REZONING PLAN
MAGNOLIA GARDENS
SKETCH PLAN

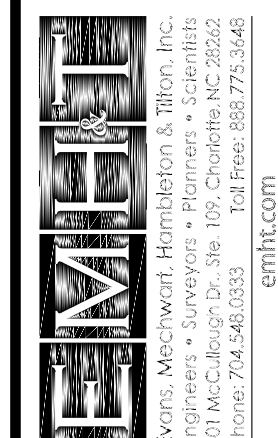

DATE
March 20, 2014

SCALE
1" = 50'

JOB NO.
2014-0154

SHEET
RZ-2.0

a.) Future amendments to the conditional site plan development standards may be applied for by the then Owner of the parcel or parcels involved, in accordance with 6.207 of the Charlotte Zoning Ordinance.

a.) Parcel 03711204 shall be limited to the 'Elderly Multi-Family Residential' use as described in Section 9.404 of the Charlotte Zoning Ordinance.

a.) The total number of ingress/egress points to the site from existing and proposed thoroughfares that abuts the site shall be limited to the number shown on the Plan. The exact locations may vary from those depicted based upon final design and location requirements as regulated by CDOT and NCDOT.

- b.) According to the City of Charlotte's Driveway Regulations, CDOT has the authority to regulate/approve all private street/driveway and public street connections to the right-of-way of a street under the regulatory jurisdiction of the City of Charlotte.
- c.) Adequate sight triangles must be reserved at the existing/proposed street entrance. Two 35'x35' and two 10'x70' sight triangles are required for the entrance to meet requirements. All proposed trees, berms, walls, fences, and/or identification signs must not interfere with sight distance at the entrance.
- d.) The proposed driveway connection to Beatties Ford Road will require a driveway permit to be submitted to CDOT and NCDOT for review and approval. The exact driveway locations and type/width of the driveways will be determined by CDOT during the driveway permit process. The locations of the driveways shown on the site plan are subject to change in order to align with driveway on the opposite side of the street and comply with City Driveway Regulations and the City Tree Ordinance.
- e.) All proposed commercial driveway connections to a future public street will require a driveway permit to be submitted to CDOT for review and approval.
- f.) Any fence or wall constructed along or adjacent to any sidewalk or street right of way requires a certificate issued by CDOT.
- g.) A Right of Way Encroachment Agreement is required for the installation of any non standard item(s) (irrigation systems, decorative concrete pavement, brick pavers, etc.) within a proposed/existing City maintained street right of way by a private individual, group, business or homeowner's/business association. An encroachment agreement must be approved by CDOT prior to the construction/installation of the non-standard item(s). Contact CDOT for additional information concerning costs, submittal and liability insurance coverage requirements.

a.) Parcel 03711204 shall provide a 40' setback measured from the existing Right of Way of Beatties Ford Road. A 5' side and 10' rear yard shall be provided.

- b.) The following is a list of amenities which will be associated with the proposed building.

- Automated exterior door with keypad entry and intercom system for resident security and for visitors to check in with office
- Double load corridors
- Lobby
- Indoor community mail room
- Office manager
- Multisue room (soft seating, kitchenette, cable vision, storage)
- Emergency pull center in each unit
- Sprinklers and smoke detectors
- Community Computer lab
- Common washer and dryer area
- Common area porch or patio on each floor
- Social services coordinator office
- Covered drop off at main entrance
- Community sitting/meeting rooms

- Covered patio adjacent to building
- Seating including tables and chairs
- Outdoor Grill

- c.) The three story structure's architectural shingle rooflines will be articulated with dormers. The site gradually slopes from Beatties Ford Road down toward the west elevation of the building to rest below street level.
- d.) The exterior materials will include brick, architectural windows, and low maintenance siding (board and batten and horizontal)
- e.) The roof will be architectural asphalt shingle.
- f.) The selected materials and colors are designed to accentuate the natural tones of the site and to compliment the surrounding landscape.
- h.) The loading and trash collection areas are to be comprised of brick walls screened from both the view of the public and our residents.

i.) Building materials will be used in such a way to break up the mass and scale of the building.

- j.) No vinyl, EIFS, or masonite will be used for siding materials, but vinyl may be used for soffit and trim, including window and door trim.
- k.) Each building face shall be comprised of a minimum of 30% brick.

a.) Parcel 03711204 shall provide a minimum 26 foot wide type "C" buffer along all property lines that abut properties zoned R-4 zoning in accordance with Section 12.302(9) of the Zoning Ordinance.

- b.) All landscaping and screening requirements shall meet the standards set forth by the City of Charlotte Zoning Ordinance.

- a.) The overall development shall provide 15 percent Tree Save Area, located generally in the vicinity depicted on the site plan.
- b.) Development on the site shall comply with the City of Charlotte Post Construction Controls Ordinance (PCCO).
- c.) The location, size, and type of storm water management systems depicted on the Rezoning Plan are subject to review and approval as part of the full development plan submittal and are not implicitly approved with this rezoning. Adjustments may be necessary in order to accommodate actual storm water treatment requirements and natural site discharge points.

a.) Fire protection shall meet the requirements set forth by the City of Charlotte Fire Department.

a.) All freestanding lighting and all exterior lighting on buildings will be fully shielded and full cut-off type fixtures downwardly directed. Attached decorative lighting fixtures such as sconces may be allowed. The maximum height of any freestanding lighting shall not exceed 20 feet.

a.) Parking will generally conform to the layout shown on the plan. Parking shall meet the requirement set forth by the City of Charlotte Zoning Ordinance.

a.) The Petitioner shall submit to the Mecklenburg County Solid Waste Department a Solid Waste Management Plan prior to initiating demolition and/or construction activities. The Solid Waste Management Plan will include, at a minimum, the procedures that will be used to recycle all clean wood, metal and concrete generated during demolition and construction activities. Additionally, the Solid Waste Management Plan will specify that all land clearing and inert debris shall be taken to a properly permitted facility. The plan shall also include a requirement that a monthly reporting of all tonnage disposed and recycled will be submitted to the Mecklenburg County Solid Waste Department. The report shall include the identification and location of all facilities receiving disposed or recycled materials.

PLAN SET DATE
March 20, 2014

REZONING PETITION 2014-032

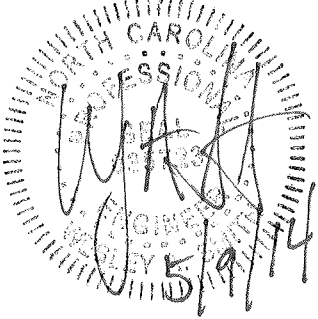
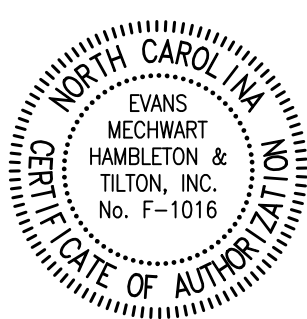

REVISIONS			
MARK	DATE	DESCRIPTION	
1	03/20/14	REVISED PER CITY OF CHARLOTTE COMMENTS	
2	04/22/14	REVISED PER CITY OF CHARLOTTE COMMENTS	
3	06/09/14	REVISED PER CITY OF CHARLOTTE COMMENTS	

The Affordable Housing Group of NC
4600 Park Road, Suite 390
Charlotte, NC 28209
PH: (704) 342-3316

**CITY OF CHARLOTTE, MECKLENBURG COUNTY, NC
REZONING PLAN
FOR
MAGNOLIA GARDENS
REZONING NOTES**

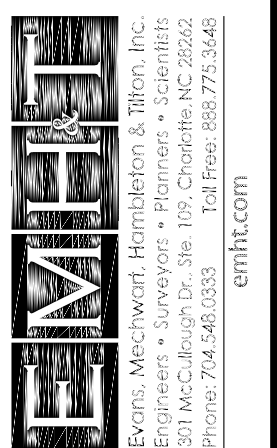

DATE
March 20, 2014
SCALE
None
JOB NO.
2014-0154
SHEET
RZ-3.0



Magnolia Gardens
Senior Living

First Floor Plan

- Legend
- Amenity/Common Space
 - One Bedroom Unit
 - Two Bedroom Unit
 - Service/Utility
 - Circulation

Total Unit Count:
82 Units

1st Floor: 24 Units
2nd/3rd Floor: 29 Units each

- PROJECT BUILDING AMENITIES
- Tenant Storage
 - Automated exterior door with keypad entry and intercom system – for resident security and for visitors to check in with office
 - Double load corridors
 - Lobby
 - Indoor community mail room
 - Office manager
 - Multiuse room (soft seating, kitchenette, cable vision, storage)
 - Emergency pull cord in each unit
 - Sprinklers and smoke detectors
 - Community Computer lab
 - Common washer and dryer area
 - Common area porch or patio on each floor
 - Social services coordinator office
 - Covered drop off at main entrance
 - Community sitting/meeting rooms
 - Laundry Rooms at each Floor with 3 sets of washers and dryers and 1 30" x 48" "folding" Table



RESIDENT COMPUTER CENTER

COVERED DROP-OFF AT ENTRY

COMMUNITY/
MULTI-PURPOSE ROOM

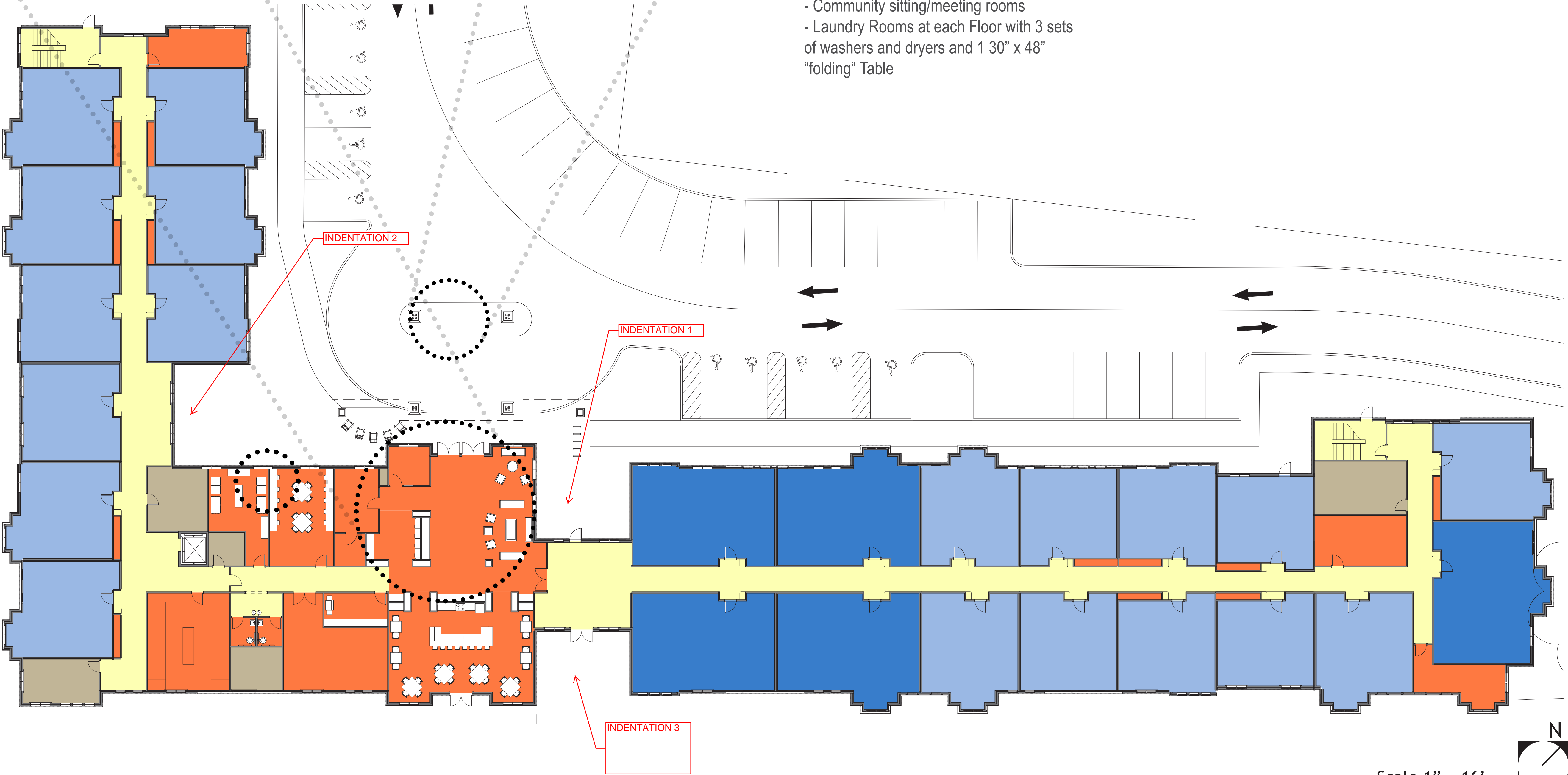

Scale 1" = 16'



Magnolia Gardens
Senior Living

Overall
Elevations



West Elevation

Scale 1" = 16'



East Elevation

Scale 1" = 16'

INDENTATION 2
BEYOND - SEE
PERSPECTIVE
AND PLAN



North Elevation

Scale 1" = 16'

INDENTATION 1



South Elevation

Scale 1" = 16'

INDENTATION 3

