

REZONING PETITION 2012-097

SWITCHING STATION BUILDING

1500 N SHARON AMITY ROAD, CHARLOTTE, NORTH CAROLINA 28211

FOR

TIME WARNER ENTERTAINMENT

(OWNER)

P.O. BOX 7467, CHARLOTTE, N.C. 28241

(919) 573-7119

PROJECT INFORMATION

PARCEL DATA	
PARCEL-ID:	16307101
PLAN JURIS:	CHARLOTTE
SITE ADDRESS:	1500 N Sharon Amity Road
OWNER:	Time Warner Entertainment Advance Newhouse
ADD:	P.O. Box 7467, Charlotte, N.C.28241
PHONE:	(919) 573-7119
EMIAL:	dee.jones@twcable.com
ZONING	
Ex. Zoning:	0-15 (CD)
Pro. Zoning:	Petition 79-15 0-1(CD)
Building data improvement	
Ex. bldg:	2,100 s.f.
Pro. Bldg:	3,500 s.f.
Total Bldg:	5,600 s.f.

VICINITY MAP

NO SCALE



CREDLE ENGINEERING COMPANY, INC

ENGINEERS/PLANNERS/SURVEYORS 204 E. MARKHAM AVE. DURHAM, N.C. 27701 (919) 682-2006 PH (919) 682-2005 FX

INDEX

SHEET #	DESCRIPTION
C0.1	COVER
L-1	EXISTING ZONING SITE

PETITION NUMBER 2012-097



CREDLE ENGINEERING COMPANY, INC

ENGINEERS/PLANNERS/SURVEYORS 204 E. MARKHAM AVE. DURHAM, N.C. 27701 (919) 682-2006 PH (919) 682-2005 FX

COVER

SWITCHING STATION ADDITION
PROPERTY OF
TIME WARNER
1500 N. SHARON AMITY ROAD, CHARLOTTE, N.C. 28211

REVISIONS		
NO.	DATE	DESCRIPTION
△		
△		
△		
△		
△		

DATE	8/27/12
SCALE:	AS SHOWN
DRAWN	WEC
JOB	\\Charlotte\\N Sharon Amity\\Base 120731
SHEET NUMBER	

C0.1

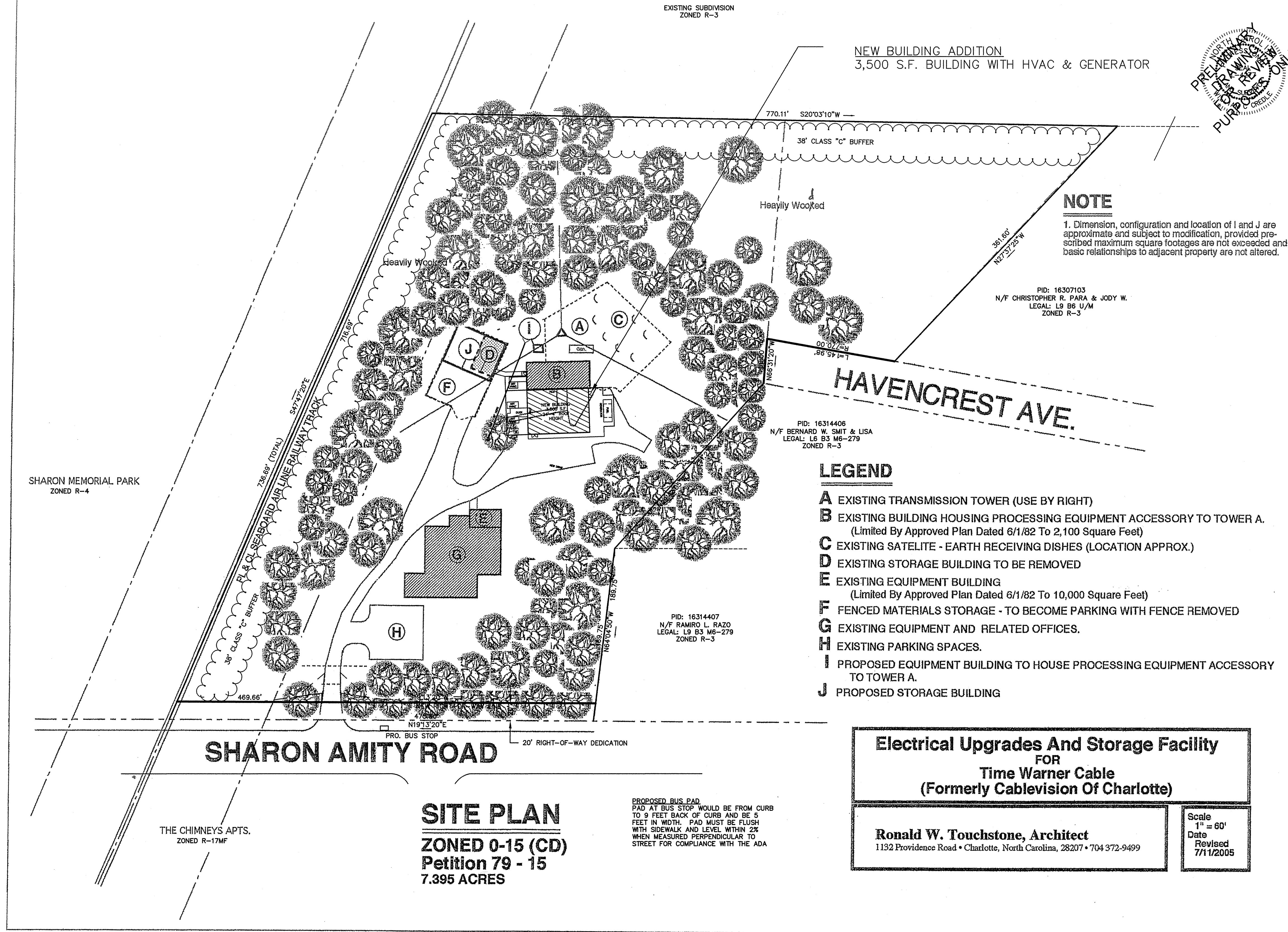

2 Zoning Plan

SITE ACREAGE: 7.02 ac
 TAX PARCEL NUMBER(S): 16307101
 EXISTING ZONING: O-15 (CD)
 PROPOSED ZONING: O-1 (CD)
 EXISTING USE: Utility Switching Station, Office
 PROPOSED USE: Utility Switching Station, Office Expansion
 EXPANSION sq. footage: 3,500 square feet

Note
 B 2,100 Square Feet + 3,500 s.f. = 5,600 Square Feet
 E 700 Square Feet - Equipment
 G 6,663 Square Feet - 2,076± Office, 4,587± Equipment
 I 80 Square Feet - Equipment
 J 2,557 Square Feet - Storage
 E, G, I, J = 10,000 Square Feet

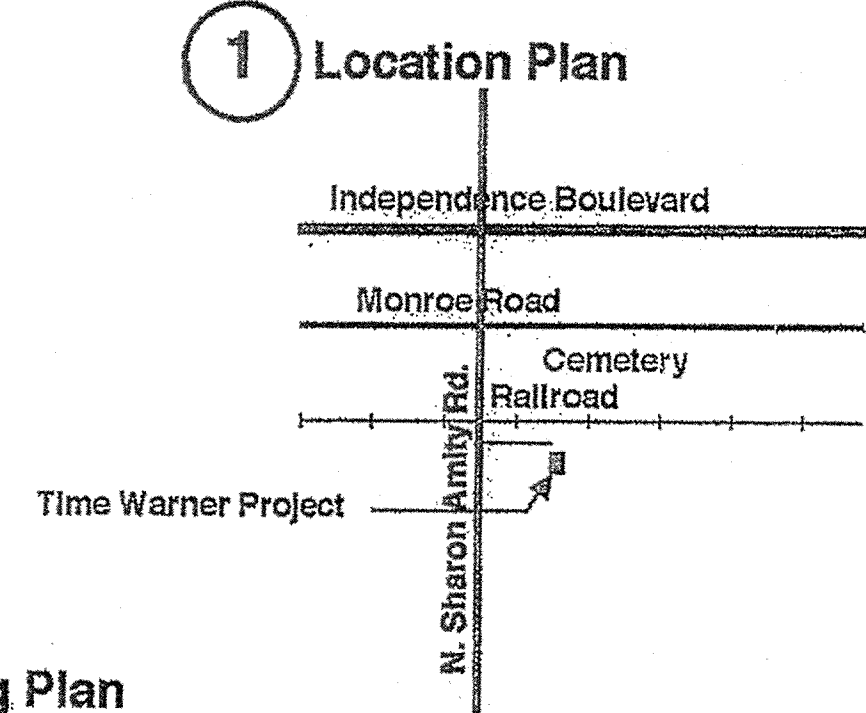

Location Plan, Zoning Plan

