



145 B SCALEYBARK RD
CHARLOTTE, NC 28209

ZONING INFORMATION:

EXISTING: R4 SINGLE FAMILY RESIDENTIAL.
REQUESTED: INST (CD)

TAX PARCEL ID 097-201-32
TOTAL ACREAGE: 9.775 ACRES

**APPROVED BY
CITY COUNCIL**

JUL 18 2011

**INSTITUTIONAL CONDITIONAL USE
STATEMENT:**

1. ALL USES IN R-4 DISTRICT AND COUNSELING SERVICES IN ASSOCIATION WITH SCHOOL.
2. ALL BUFFERS WILL BE MET PER THE ORDINANCE FOR ANY NEW EXPANSION FOR BUILDINGS.
3. PARKING WILL MEET ZONING ORDINANCES FOR ANY NEW EXPANSION.
4. HEIGHT FOR NEW BUILDINGS WILL MEET HEIGHT RESTRICTIONS FOR ZONING DISTRICT.
5. ANY NEW AND EXISTING DEVELOPMENT WILL MEET THE F.A.R FOR INSTITUTION DISTRICTS.

PLAN KEY:

 POSSIBLE BUILDING AND PARKING ENVELOPE

**PETITION
NUMBER:
011-049**

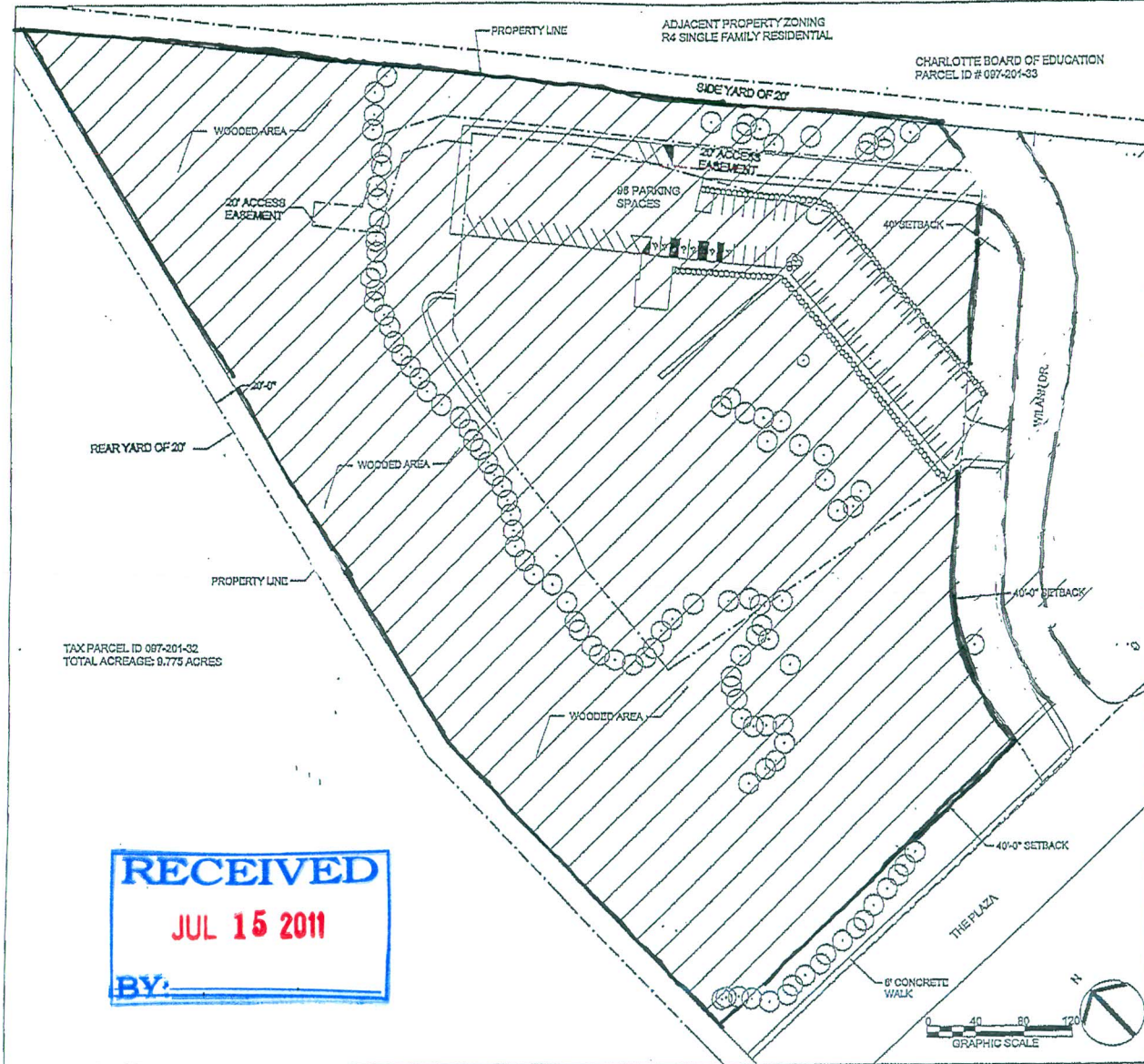

TAX PARCEL ID 097-201-32
TOTAL ACREAGE: 9.775 ACRES

RECEIVED
JUL 15 2011
BY:

ADJACENT PROPERTY ZONING
R4 SINGLE FAMILY RESIDENTIAL

CHARLOTTE BOARD OF EDUCATION
PARCEL ID # 097-201-33