

TORINGDON REZONING PLAN

APPROVED BY
CITY COUNCIL

TORINGDON DEVELOPMENT

2010 REZONING PETITION # 2010 - 035

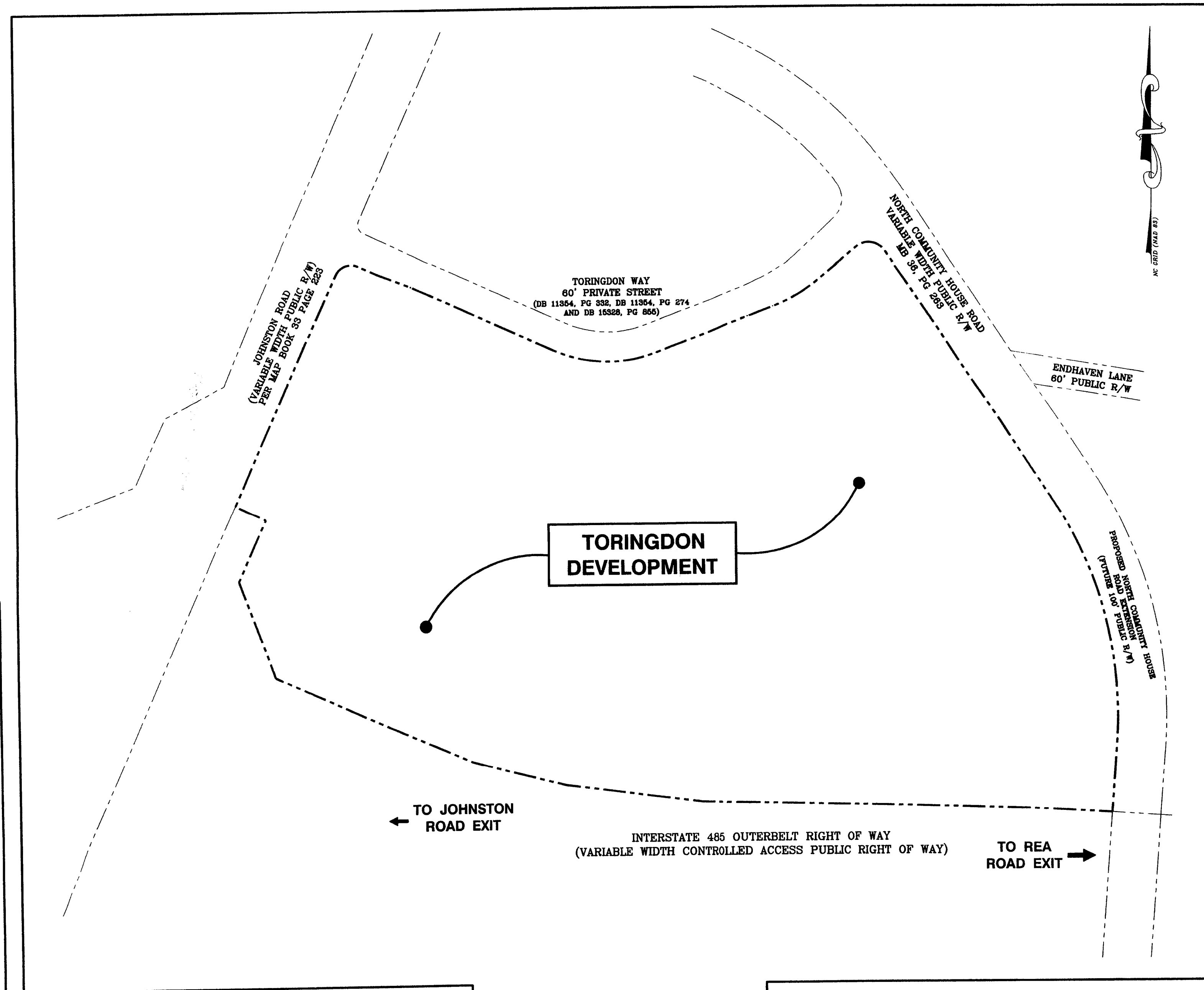
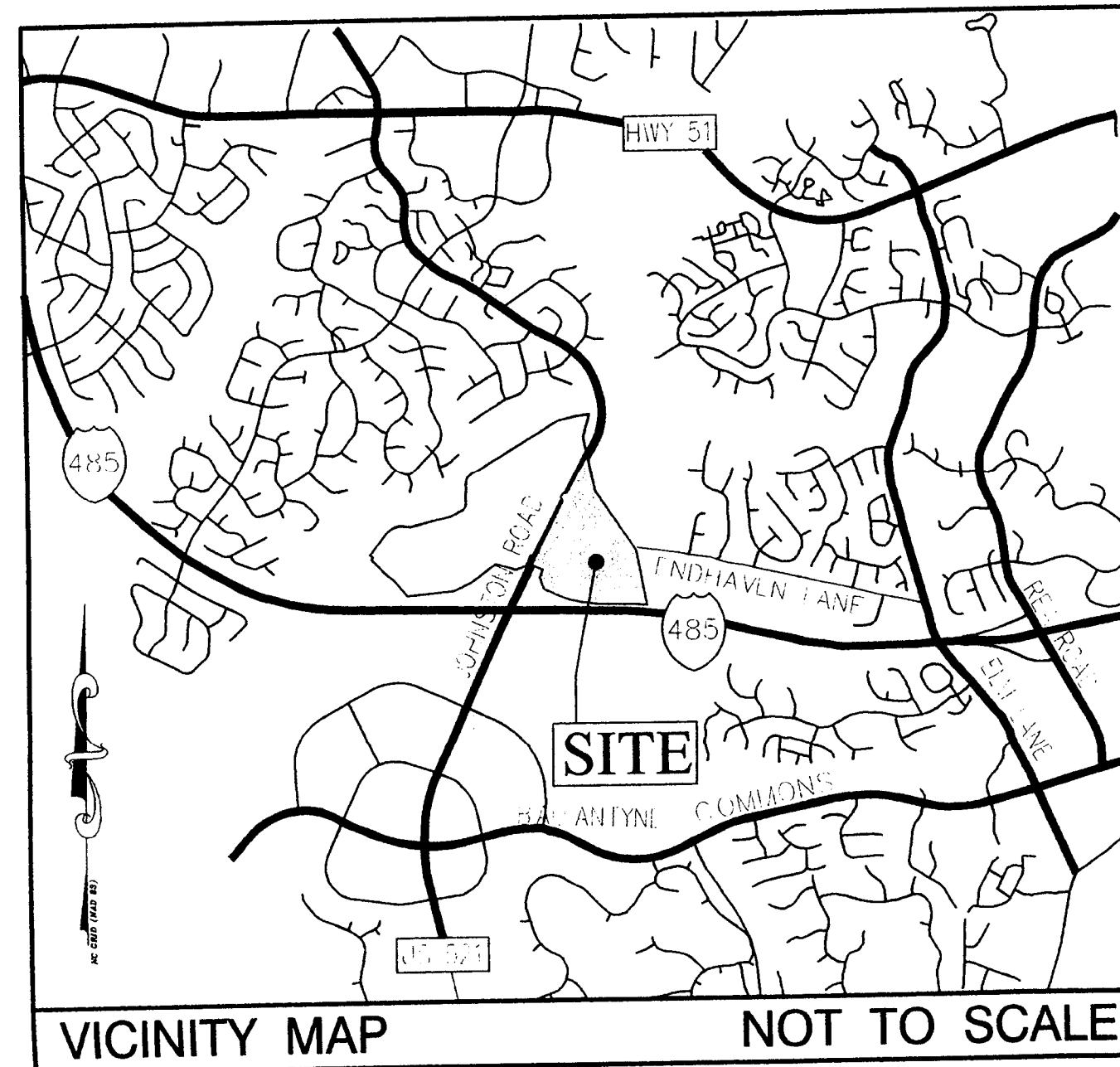

LOCATION MAP
SCALE : 1" = 150'

SITE DATA TABLE:

- P.I.D.'s : 22323108, 22323111, 22323136, 22323137, 22323138, 22323139, 22323153, 22323154, 22323159, 22323160, 22323161, 22323199
- OVERALL DEVELOPMENT AREA : 37.3± ACRES (GROSS)
- EXISTING ZONING : CC (BY REZONING PETITION NOS. 2008 - 040 AND 2005 - 126)
- PROPOSED ZONING : CC - SPA
- USE(S) : GENERAL AND MEDICAL OFFICE / RETAIL / HOTEL / MULTI - FAMILY RESIDENTIAL / RESTAURANT AND PERSONAL SERVICE (SEE DEVELOPMENT STANDARDS)
- MAXIMUM ALLOWED SQUARE FOOTAGES (SEE DEVELOPMENT STANDARDS):
TOTAL OFFICE SPACE : 725,000 SQ. FT. (MAX.)
(534,700 SQ. FT. EXIST.)
TOTAL ACCESSORY RETAIL SPACE : 11,500 SQ. FT.
(5,500 SQ. FT. EXIST.)
TOTAL RESIDENTIAL UNITS : 257 D.U.
HOTEL : 120 ROOMS
- TOTAL PARKING IN DECKS : 1,280 SPACES
- TOTAL SURFACE PARKING : 1,366 SPACES

INDEX OF SHEETS

DESCRIPTION	SHEET NO.
COVER SHEET	C1
REZONING SITE PLAN	C2
DEVELOPMENT CROSS - SECTIONS	C3
DEVELOPMENT STANDARDS	C4

PETITIONER / OWNER : LIGHTIN CORPORATION
3110 EDWARDS MILL ROAD
SUITE 200
RALEIGH, NC 27612
[TELE] 919.783.6000
[FAX] 919.783.7220
CONTACT : JEFF SMITH

CIVIL ENGINEER : DEWBERRY & DAVIS, INC.
6135 LAKEVIEW ROAD
SUITE 400
CHARLOTTE, NC 28269
[TELE] 704.509.9918
[FAX] 704.509.9937
CONTACT : CHRISTOPHER M. FLECK, PE

ARCHITECT : PGAL
1425 ELLSWORTH
INDUSTRIAL DR. STE 15
ATLANTA, GEORGIA 30361
[TELE] 404.602.3800
[FAX] 404.602.1810
CONTACT : FRED D. DOANE, AIA

FOR PUBLIC HEARING
PETITION # 2010 - 035



N.C. REGISTRATION # F - 0679

Dewberry & Davis, Inc.
6135 LAKEVIEW ROAD
SUITE 400
CHARLOTTE, NC 28269-2609
PHONE: (704) 509-9918
FAX: (704) 509-9937

TORINGDON MIXED - USE DEVELOPMENT
(TORINGDON WAY)
OWNER : LIGHTIN CORPORATION
3110 EDWARDS MILL ROAD
SUITE 200
RALEIGH, NORTH CAROLINA 27612
PHONE : (919) 783 - 6000
CHARLOTTE, NORTH CAROLINA
2010 REZONING PETITION PLANS

SEAL

REZONING
DOCUMENT
NOT FOR
CONSTRUCTION

SEAL

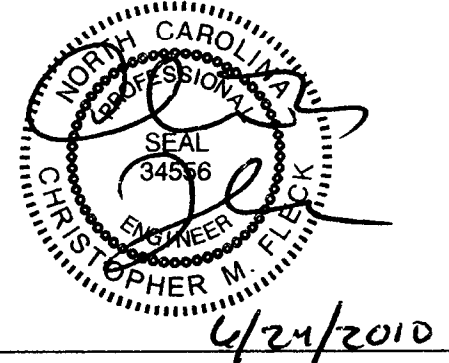

SCALE : NOTED

No.	Date	By	Description
2	06/24/2010	RAM	Revisions per City Review
1	05/14/2010	RAM	Revisions per City Review

REVISIONS

DRAWN BY : CFC
APPROVED BY : ARV
CHECKED BY : CMF
DATE : 03 / 19 / 2010

TITLE

COVER
SHEET
FOR PUBLIC
HEARING

PROJECT NO. 10001471

C1

SHEET NO.

REZONING SITE PLAN

LEGEND

- EXIST. ADJACENT PROPERTY LINE
- EXIST. BOUNDARY
- EXIST. CURB AND GUTTER
- EXIST. SIDEWALK
- EXIST. SETBACK
- PROP. CURB AND GUTTER
- PROP. SIDEWALK
- PROP. BUILDING
- PROP. PARKING
- PROP. STRIPING
- PROP. PAVERS

SYMBOLS

- EXIST. BUILDING / PARKING DECK
- EXIST. BIKE RACK
- PROP. BIKE RACK
- PROP. DIRECTIONAL ARROWS
- PROP. STOP BAR
- PROP. POOL / AMENITY AREA

GRAPHIC SCALE
(IN FEET)
1 inch = 60 ft

**APPROVED BY
CITY COUNCIL**

Dewberry

N.C. REGISTRATION # F - 0679

Dewberry & Davis, Inc.
6135 LAKEVIEW ROAD
SUITE 400
CHARLOTTE, NC 28269-2609
PHONE: (704) 509-9918
FAX: (704) 509-9937

TORINGDON MIXED - USE DEVELOPMENT
(TORINGDON WAY)

OWNER: LIGHTIN CORPORATION
3110 EDWARDS MILL ROAD
SUITE 200
RALEIGH, NORTH CAROLINA 27612
PHONE: (919) 783-6000

CHARLOTTE, NORTH CAROLINA
2010 REZONING PETITION PLANS

REZONING
DOCUMENT
NOT FOR
CONSTRUCTION

SEAL

SEAL

6/24/2010

SCALE : 1 inch = 60 feet

No.	Date	By	Revised per City Review Description
1	05/14/2010	RAM	

REVISIONS

DRAWN BY	CFC
APPROVED BY	ARV
CHECKED BY	CMF
DATE	03 / 19 / 2010

TITLE

**REZONING
SITE PLAN
FOR PUBLIC
HEARING**

PROJECT NO. 10001471

C2

SHEET NO.

BOUNDARY SURVEY PROVIDED BY:
THE SURVEY COMPANY
PROJECT # LIC 26
MAP BOOK 46, PAGE 903

