

**McCLURE  
NICHOLSON  
MONTGOMERY**  
architects

2108 South Boulevard, Suite 110  
Charlotte, N.C. 28203  
Phone: 704 332 6763  
Fax: 704 334 0262

**GARY  
WILLIAMS**  
ARCHITECT

428 East Fourth Street, Suite 410  
Charlotte, NC 28202  
Tel: 704 451 6176

Consulting Architect

THESE DOCUMENTS AND THE DESIGN CONTAINED THEREIN ARE INSTRUMENTS OF SERVICE FOR USE SOLELY WITH RESPECT TO THIS PROJECT. THE DESIGNER SHALL OBTAIN ALL COMMON LAW STATUTORY AND OTHER RESERVED RIGHTS INCLUDING THE COPYRIGHT. THE OWNER SHALL NOT REUSE OR PERMIT THE REUSE OF THE DESIGNER'S DOCUMENTS EXCEPT BY WRITTEN AGREEMENT IN WRITING.

**THE PARK  
CONDOMINIUMS**

HIGH RISE RESIDENTIAL  
222 SOUTH CALDWELL ST.  
CHARLOTTE, NC

PROJECT No. 245.2005.2

ISSUE:

REVISION:

EXISTING ZONING: UMUD-0  
REQUESTED ZONING: UMUD-0, SPA  
The Options Requested Are:

- Section 9.902 • ALLOW ALL USES AS PERMITTED UNDER UMUD.
- Section 9.905(2) • ALLOW ENCROACHMENT INTO 12 FT. SETBACK ALONG CALDWELL STREET AS INDICATED ON THIS SITE PLAN, NO LESS THAN 70 FEET ABOVE THE SIDEWALK.
- ALLOW ENCROACHMENT INTO 12 FT. SETBACK ALONG EAST THIRD STREET AS INDICATED ON THIS SITE PLAN, NO LESS THAN 70 FEET ABOVE THE SIDEWALK.
- Section 9.907(2) • TO ALLOW FOR THE MANEUVERING INTO THE RIGHT-OF-WAY AT THE SERVICE AREA AT CALDWELL STREET BETWEEN THE HOURS OF 10 p.m. TO 6 a.m. ONLY.

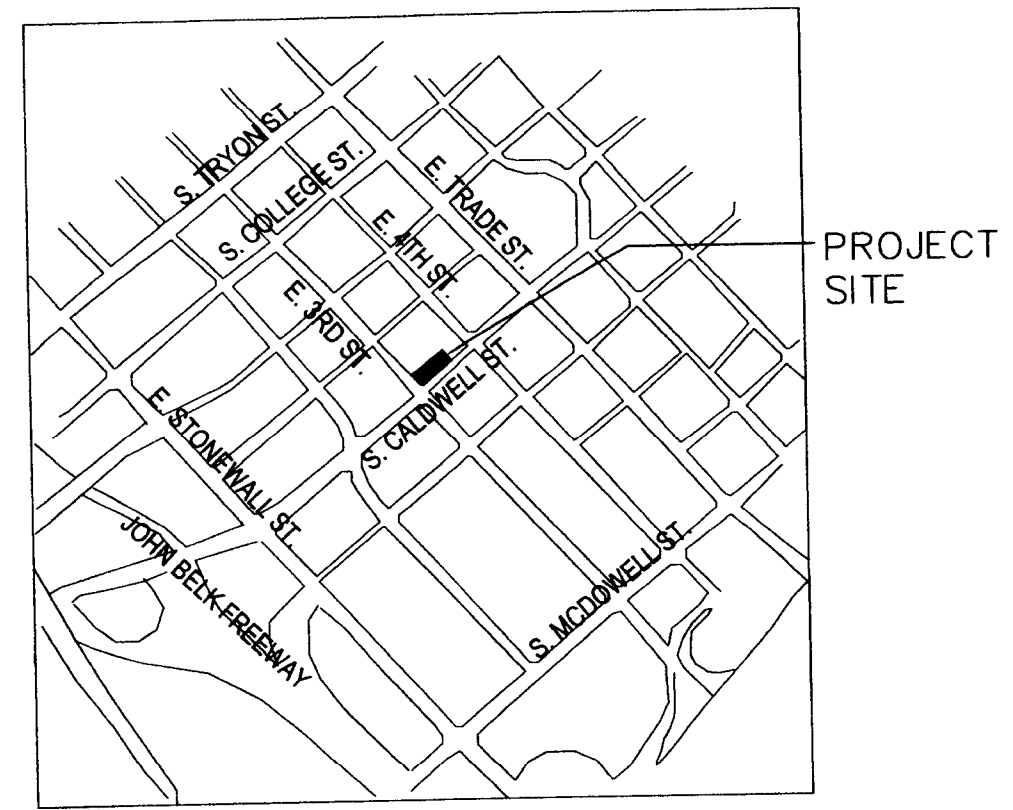

VICINITY MAP

**GENERAL NOTES**

1. EXISTING STREET TREES WERE REMOVED BY THE FORMER DEVELOPER AND WILL BE REPLACED AS PART OF THIS DEVELOPER'S APPROVED CONSTRUCTION PLANS.
2. EXISTING DRIVEWAYS ARE TO REMAIN - EXCEPT TO BE REWORKED WITH MODIFIED TYPE II DRIVEWAY CURBS - STD. NO. 10.25C (UMUD).
3. ALL OTHER REQUIREMENTS OF THE UMUD ORDINANCE (CHAPTER 9, PART 9 OF THE CITY OF CHARLOTTE ZONING ORDINANCE) WILL BE MET.
4. THE BUILDING'S DAYTIME LOADING/UNLOADING SHALL OCCUR IN FRONT OF THE CHARLOTTE NATIONAL BUILDING ON THE CORNER OF 4TH ST. AND CALDWELL ST. WITHIN EXISTING ON-STREET PARKING AREAS. LARGE VEHICLES ASSOCIATED WITH FURNITURE MOVING, ETC. SHALL OCCUR ALONG CALDWELL ST. BETWEEN 8PM AND 5AM AND DURING WEEKEND HOURS, EXCLUDING TIMES DURING UPTOWN SPECIAL EVENTS.
5. THE PETITIONER AND CDOT SHALL WORK TOGETHER DURING THE CONSTRUCTION PLAN APPROVAL PROCESS TO RESOLVE INGRESS/EGRESS DRIVEWAY CIRCULATION ISSUES.
6. ANY USE REQUIRING CHECK-IN SHALL OCCUR ON THE 2ND FLOOR (FIRST PARKING LEVEL) OF THE PARKING DECK. APPROPRIATE SIGNAGE AT THE PARKING DECK ENTRANCE ON 3RD ST. AND ALONG CALDWELL ST. WILL INFORM GUESTS, TAXI-CAB DRIVERS, AND OTHERS THAT CHECK-IN IS LOCATED ON THE 2ND FLOOR.
7. PRIMARY SERVICE VEHICLES FOR THE BUILDING SHALL BE LIMITED TO SU-30 SIZE VEHICLES OR SMALLER AND SHALL PARK/LOAD/UNLOAD IN THE EXISTING TRASH COMPACTOR SPACE ACCESSED FROM THE CALDWELL ST. DRIVEWAY. WB-40 AND LARGER SERVICE VEHICLES SHALL LOAD/UNLOAD ALONG CALDWELL ST. ONLY DURING EVENING HOURS BETWEEN 8PM AND 5AM EXCLUDING TIMES DURING UPTOWN SPECIAL EVENT HOURS.
8. THE PETITIONER AND CDOT SHALL WORK TOGETHER DURING THE CONSTRUCTION PLAN APPROVAL PROCESS TO RESOLVE PEDESTRIAN SITE ISSUES.

BREVARD STREET ASSOCIATES  
DB 4596-329  
EXISTING ZONING: UMUD  
**DEVELOPMENT DATA**

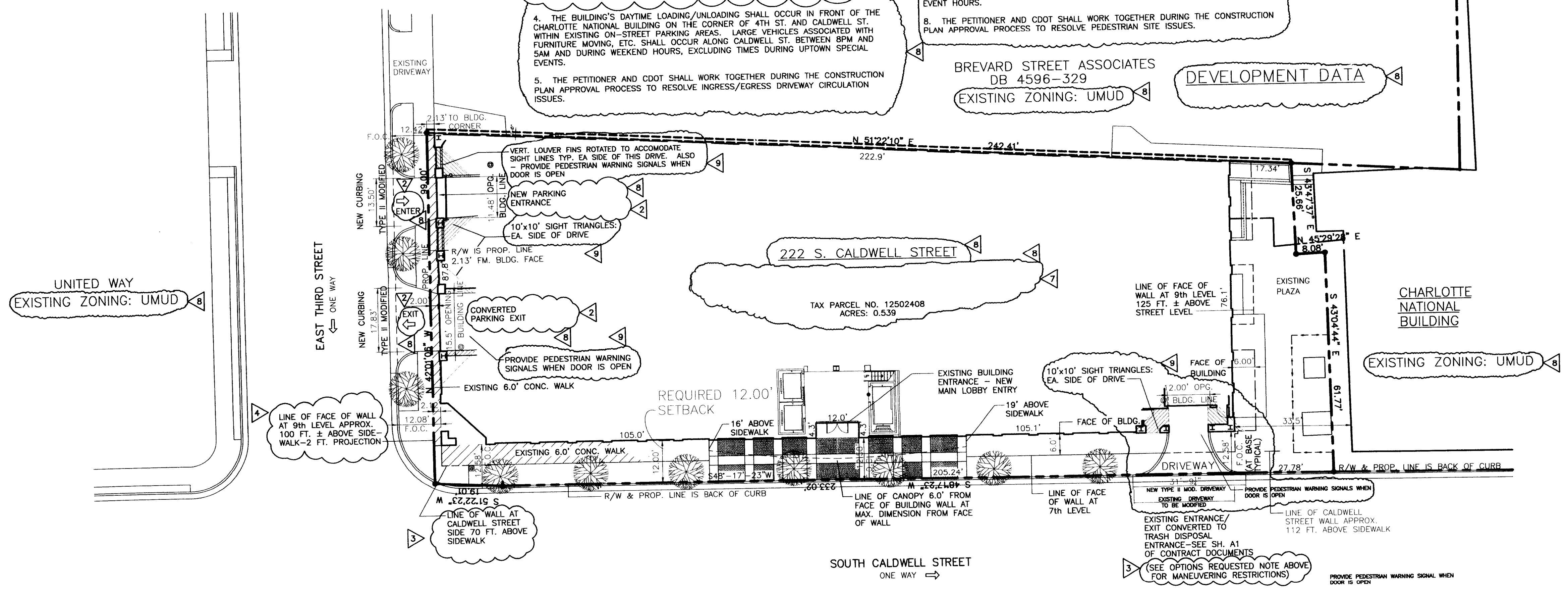

**1 SITE PLAN**  
SCALE: 1/16" = 1'-0"

1st BAPTIST CHURCH  
EXISTING ZONING: UMUD

GOVERNMENT CENTER PARKING DECK  
EXISTING ZONING: UMUD

RECEIVED  
MAR 16 2010

- △ OPTIONS REQUESTED/GEN. NOTES 11/03/01
- △ DRIVES PER CDOT/TED MTC 8/15/01
- △ NOTES PER PC/CDOT MTC 11/8/01
- △ MODIFICATIONS PER CITY COUNCIL MTC/APPROVALS 1/22/02
- △ CHANGE GEN NOTE I RESPONSE TO URBAN FORESTRY 6/18/04
- △ 01.13.06 SHELL-CORE PERMIT
- △ 01.25.10 AMEND PETITION
- △ 02.19.10 AMEND PETITION REVISIONS
- △ 03.16.10 AMEND PETITION PLANNING COMMENTS

2010-029 L1