

*"The cornerstone of the plan is a commitment to preserving the single family character of Belmont's neighborhood core...and to propose improvements that support revitalization and improve neighborhood livability"*

From the Belmont Revitalization Plan, May 12, 2003

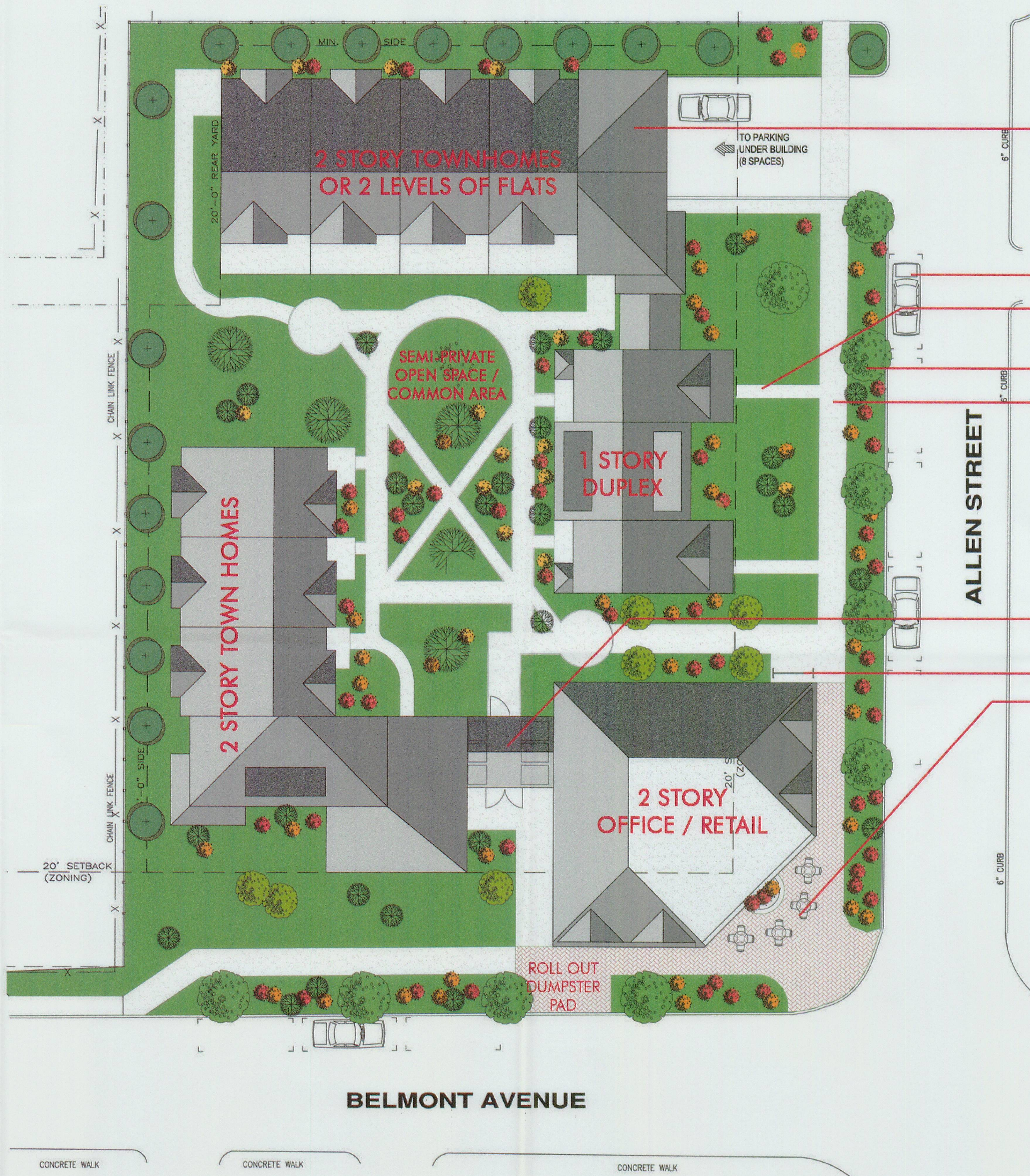

- SECURED PARKING UNDER BUILDING - CONCEALED FROM VIEW
- ON STREET PARALLEL PARKING WHERE POSSIBLE
- WALK OUT STREET ACCESS FROM ALL STREET LEVEL UNITS
- 8' PLANTING STRIP
- 6' SIDEWALK
- DUMPSTERS / RECYCLING HIDDEN FROM VIEW
- BICYCLE RACKS
- CAFE SEATING

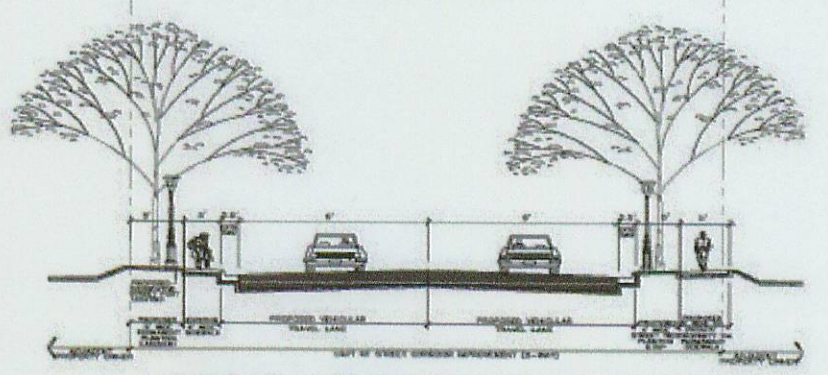

## BELMONT KORNER REDEVELOPMENT

Belmont Avenue and Allen Street

PERKINS EASTMAN



BELMONT AVE. STREETSCAPE - VIEW LOOKING SOUTH



ALLEN ST. STREETSCAPE - VIEW LOOKING WEST

Belmont will be a family oriented community, diverse in age, culture, and income, that promotes **public safety, economic and social development, affordable housing, and community pride** -- A place to live, work, and play.

From the Belmont Area Revitalization Plan, May 12, 2003



BELMONT AVE. AND ALLEN ST. INTERSECTION -VIEW LOOKING NORTH

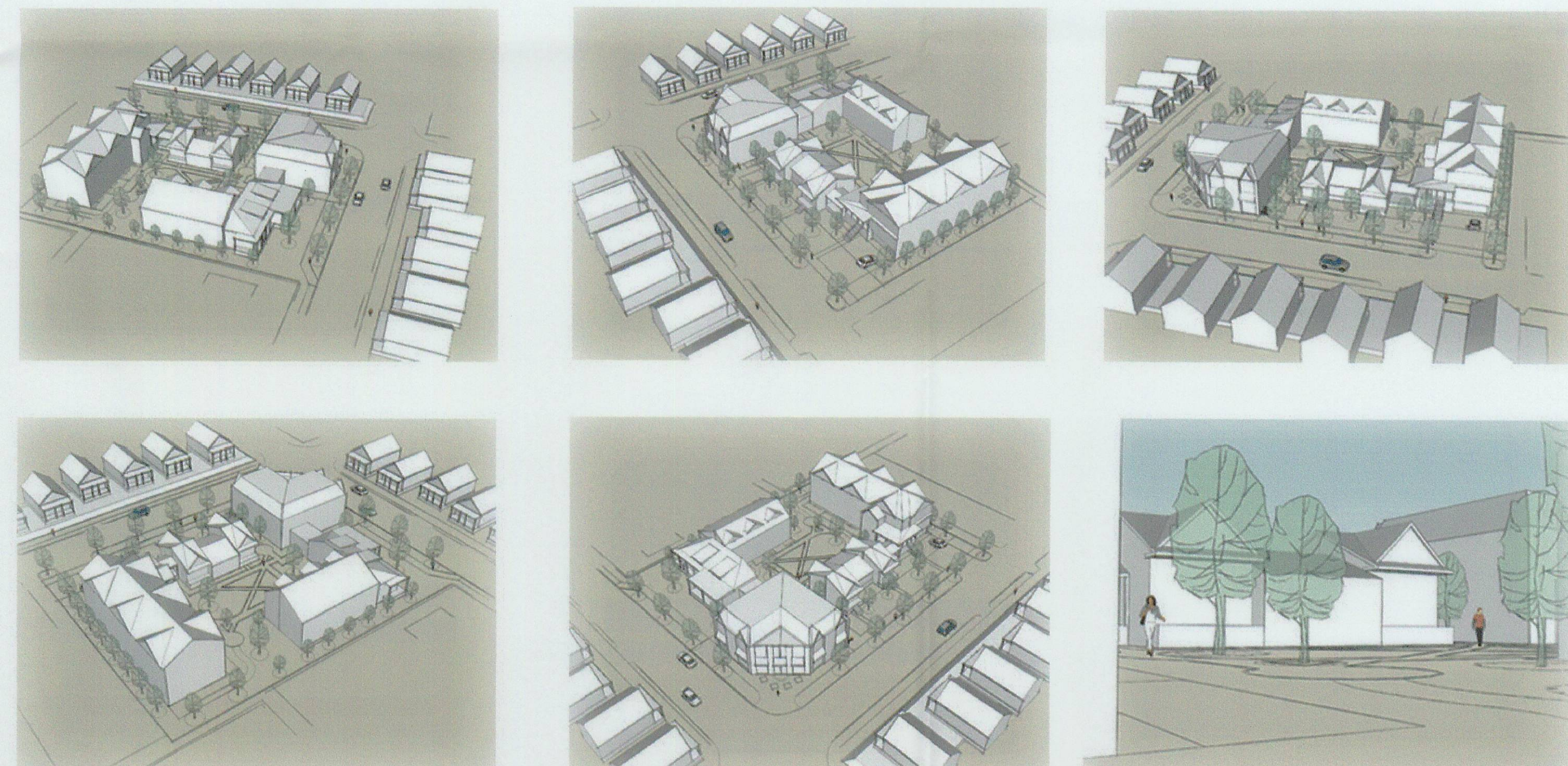

## BELMONT KORNER REDEVELOPMENT

Belmont Avenue and Allen Street

PERKINS EASTMAN