

A blue and white LYNX train, numbered 101, is stopped at a modern transit station platform. Several people, including a man in a white shirt and a young boy in a red shirt, are walking on the platform. The train has the LYNX logo on its front. The station has a curved, arched roof structure.

Welcome to the LYNX Blue Line Extension **Transit Station Area Plans** DRAFT Recommendations

**Presentation will begin
at 6:00 P.M.**

Meeting Agenda



Blue Line Extension Transit Station Area Plans

Community Workshop #4
January 31, 2013
6:00pm



Introduction (5 minutes)

Welcome and Introductions

Kathy Cornett

Charlotte-Mecklenburg Planning Department

Overview Presentation (30 minutes)

Area Plan Basics

Kathy Cornett

Putting the Pieces Together

Overview of Draft Plan Policies

Group Exercise (20 minutes)

*Review and Provide Feedback
On Draft Plan Policies*

All

Wrap-up and Next Steps (10 minutes)

Kathy Cornett

Information about the BLE Station Area Plans will be posted on our website throughout the planning process. Tonight's presentation will be on the website by Friday, February 1, 2013.

www.charlotteplanning.org

Planning

Kathy Cornett

Phone: 704/336-2205

kcornett@charlottenc.gov

CATS

Judy Dellert-O'Keef

704/432-0477

jdellert-okeef@charlottenc.gov

Engineering

Jim Keenan

704/336-4252

jkeen@charlottenc.gov

Transportation

Scott Correll

704/432-5237

bhorton@charlottenc.gov

Why Are We Here?

- Plan Overview and Purpose
- Plan Development Process
- Highlight of Draft Policies and Recommendations
- Plan Implementation
- Next Steps

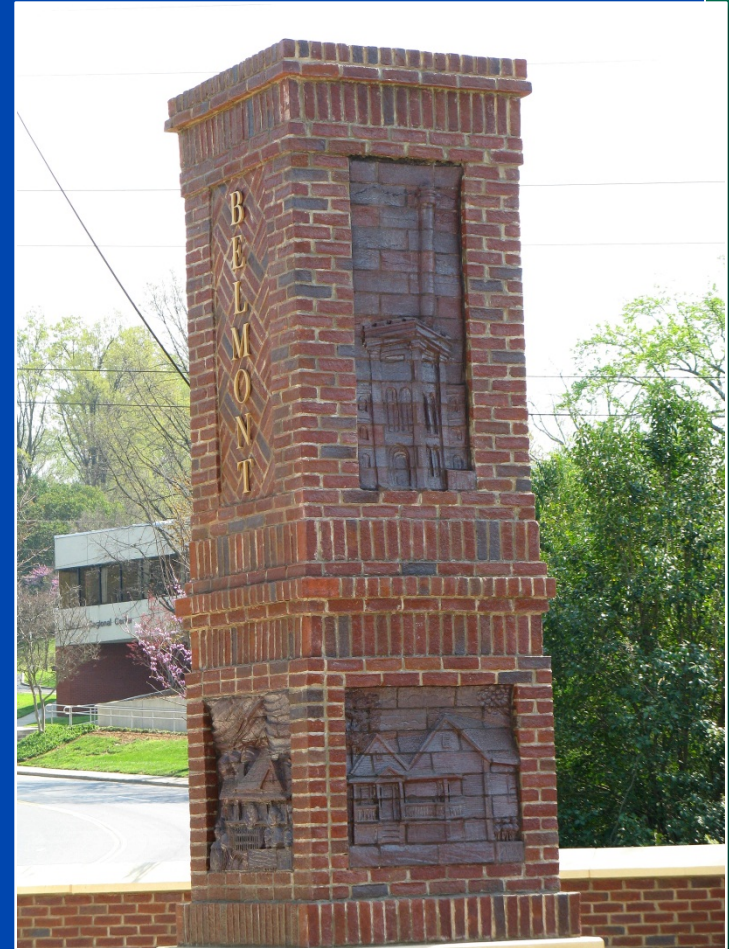



CITY OF CHARLOTTE



Blue Line Extension Update

Blue Line Extension (BLE) Project Update

LYNX Blue Line Extension (BLE)

- 9.3 miles
- Implementation in 2017
- +25,000 daily riders
- Connects UNC Charlotte campuses
- **Major Achievements**
 - FTA issued Record of Decision in December 2011
 - FTA approved entry into Final Design in July 2012
 - **FTA Full Funding Grant Agreement signed on October 16, 2012.**

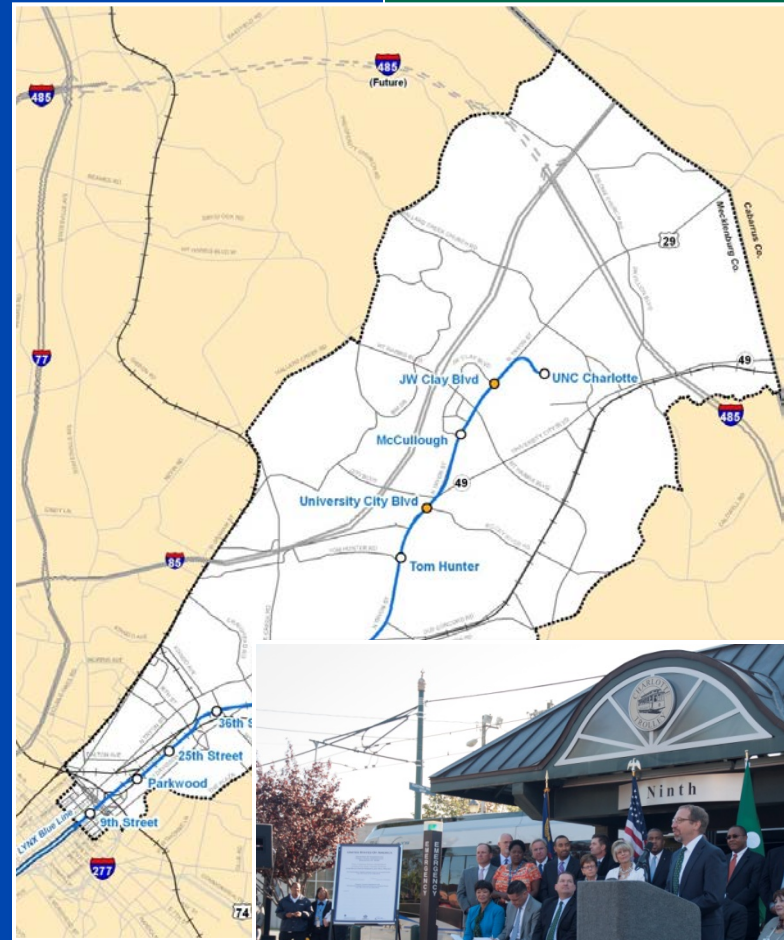

- **11 Stations (7 walk-up / 4 park-and-ride)**
- **Accommodates 3-car trains**
- **Approximately 3,100 parking spaces**
- **Congestion-free commute**
- **Connecting bus services**
- **Convenient and safe station amenities for customers**
 - Security features
 - Bicycle parking
 - Public art
 - Shelters, garbage cans, benches
 - Trees
 - Lighting
 - Ticket vending machines (TVMs)
 - Maps and schedules



Milestone	Date
State FFGA Executed	March 2012
Request to Enter Final Design	March 2012
FTA Approval to Enter Final Design	July 2012
Federal FFGA Signed	October 2012
Advanced Utility Relocation Begins	May 2013
Right-of-Way Acquisition Complete	January 2014
Complete Final Design	May 2014
Start Construction	November 2013
Initiate Revenue Service	March 2017

*Schedule subject to change



CITY OF CHARLOTTE



Station Area Plans



What is a Station Area Plan?



- Policy Guide that Provides a Framework for Future Growth and Development
- Provides Detailed Land Use and Community Design Recommendations for each Station Area
- Identifies Public and Private Investments and Strategies Needed to Realize the Plan Vision
- Updates the Centers, Corridors and Wedges Boundary for the Plan Area
- Provides Building Setback and Streetscape Standards for Properties with Urban Zoning Districts
- Represents a Shared Vision for the Future



What is a Station Area Plan?

- **Elements Typical of Area Plans**
 - **Vision**
 - Land Use/Transportation/Community Design Recommendations
 - **Recommended Infrastructure Improvements**
 - Implementation Section with Recommended Zoning Changes
 - **Street Cross-sections that Identify Future Curb Lines**
 - Identifying Setbacks from Back-of-Curb Lines

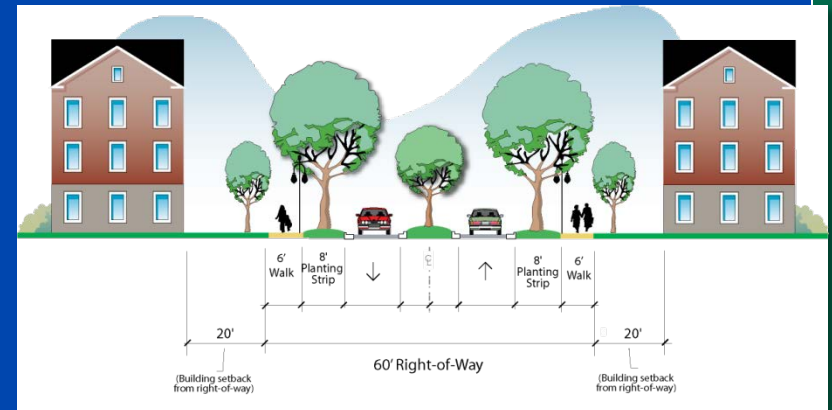



Activity Centers

- Center City
- Mixed Use Center
- Industrial Center

Growth Corridors

- Established Neighborhood Areas
- **Transit Station Areas**
- Interchange Areas
- General Corridor Areas

Wedges

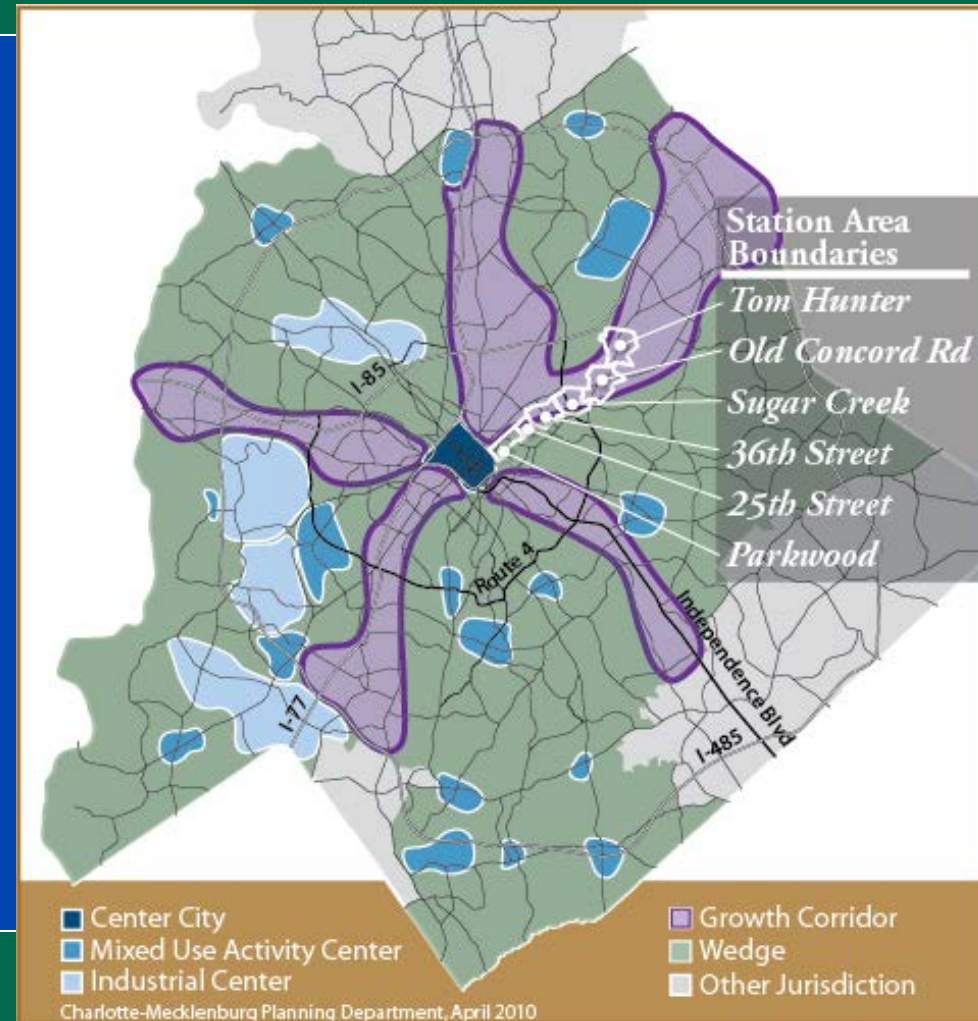

What Can You Expect From a Station Area Plan?

Clarify the Vision for the Area

Identify and provide policies to
address development opportunities
and issues

But not . . .

Create regulations or
laws

Identify public and private
investments needed to achieve
vision

But not . . .

Provide funding and
implementation
means overnight

Possibly recommend zoning
changes in appropriate locations

But not . . .

Rezone property

Guide more appropriate
development

But not . . .

Halt development

What Happens After Plan Adoption?



- Red lines show station area boundaries.
- Criteria Used to Determine Plan Boundaries:

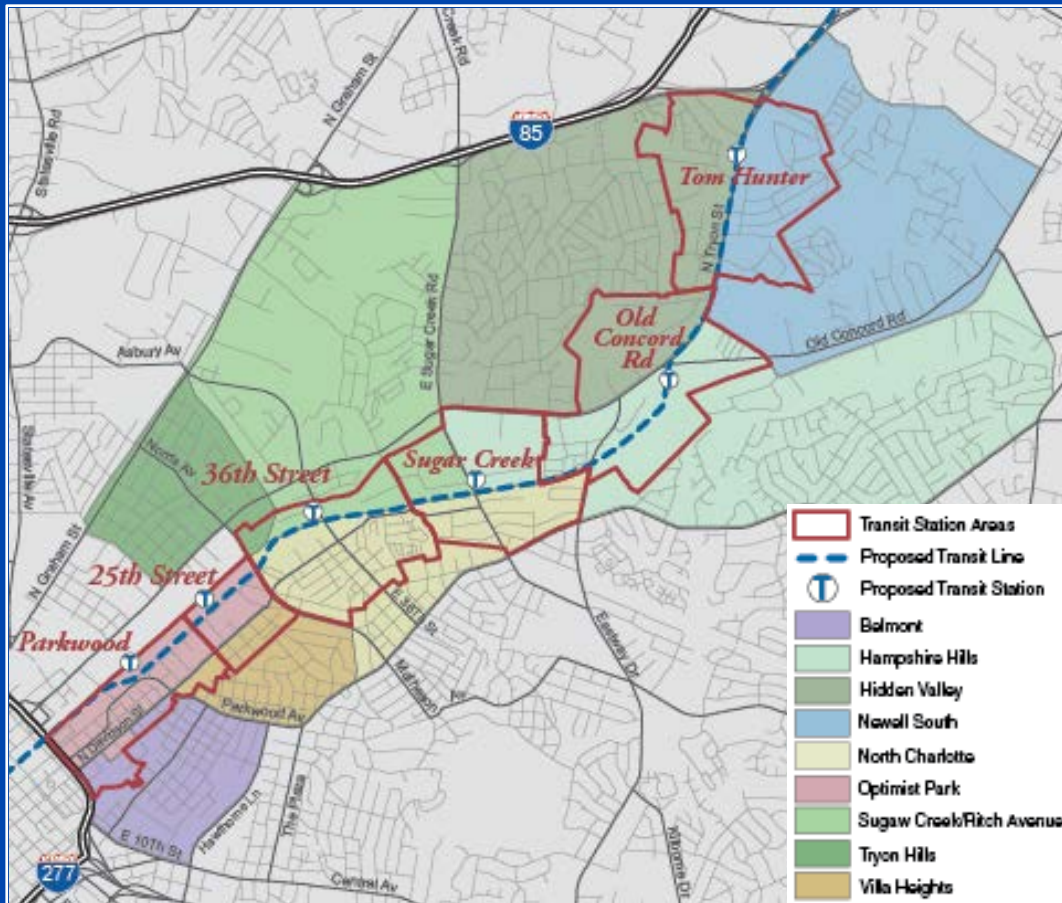

- Properties within ½ mile of the transit station.
- Includes some properties in neighborhoods zoning single family.
- Uses “natural” boundaries where possible (streets, rear property lines, etc.).



BLE Stations

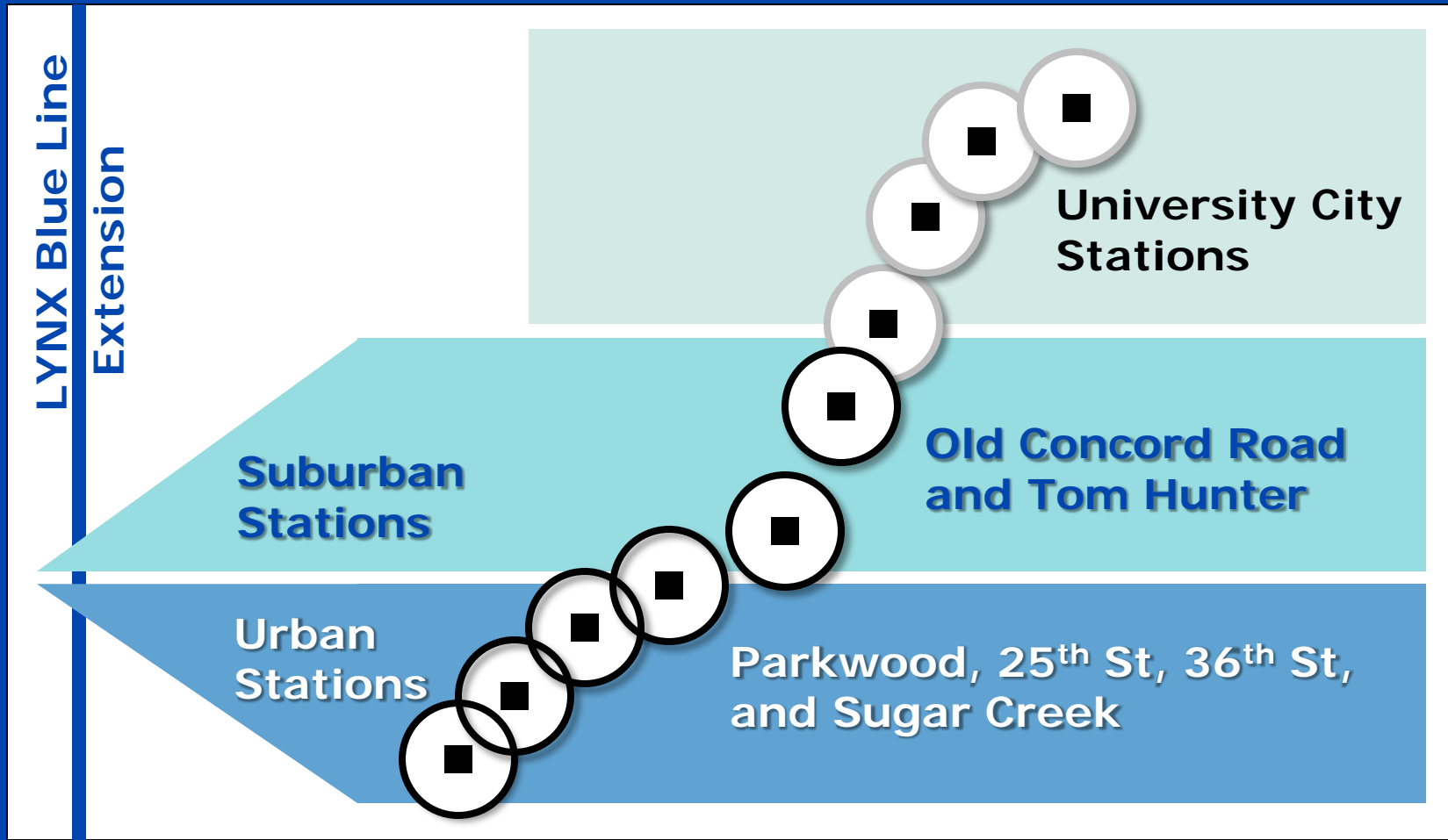

Plan Development Process

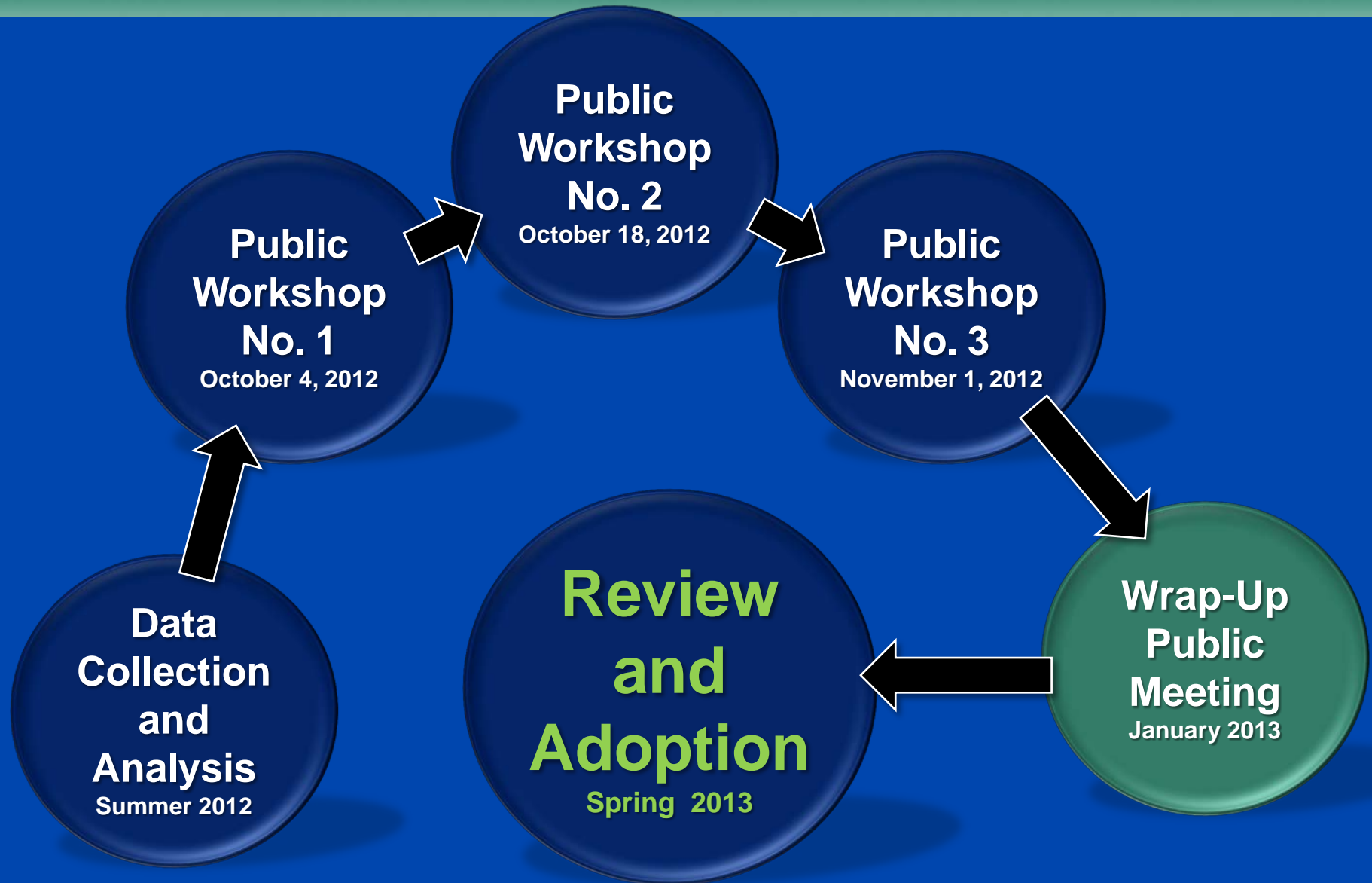



CITY OF CHARLOTTE



Plan Development

- **Presentation**

- Purpose of Station Area Plans
- Introduced the Plan Initiative and Described Process
- BLE Project Update
- Implementation and the NECI Program



- **Open House**

- Provided feed back on the Draft Concept Plans

What We Heard

- Support for greenway/multi-use trail
- **Parking issues**
- Building height near transit stations
- **Expand NoDa Neighborhood Preservation area**
- Station Locations



- **Presentation**
 - BLE Project Update
 - What We Heard at 1st Meeting
 - How the Pieces Fit Together
 - Concept Plan
 - Development Plan
 - Structure Plan
 - Focus on Community Design
- **Open House**
 - Provided feed back on the Draft Development and Structure Plans



What We Heard

- Detailed comments about each station area.

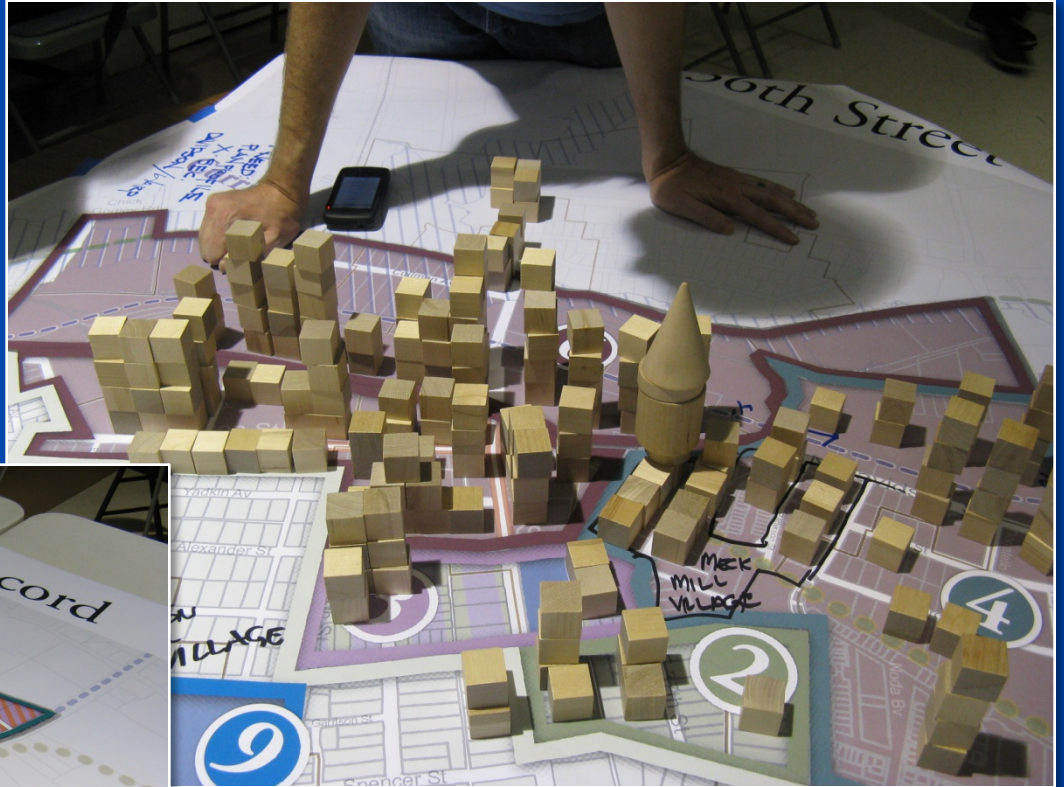

- **Presentation**
 - BLE Project Update
 - What We Heard at 2nd Meeting
 - Mobility
 - Street Types
 - Street Cross-sections
 - Implementation – NECI Program
- **Open House**
 - Provided feed back on the Draft Street Types and Cross-sections



What We Heard

- Onstreet parking for North Davidson Street
- Extension of 25th Street
- Sidewalks
- Roundabout at Jordan Place
- Footbridge over creek at 24th





CITY OF CHARLOTTE



DRAFT Recommendations

How the plan pieces fit together:

- Station Development Concept
- Development Plan
- Structure Plan
- Mobility Plan



Station Development Concept

- Considers the vision and goals
- Illustrates the recommended development pattern
- General in nature and to provide guidance for policies

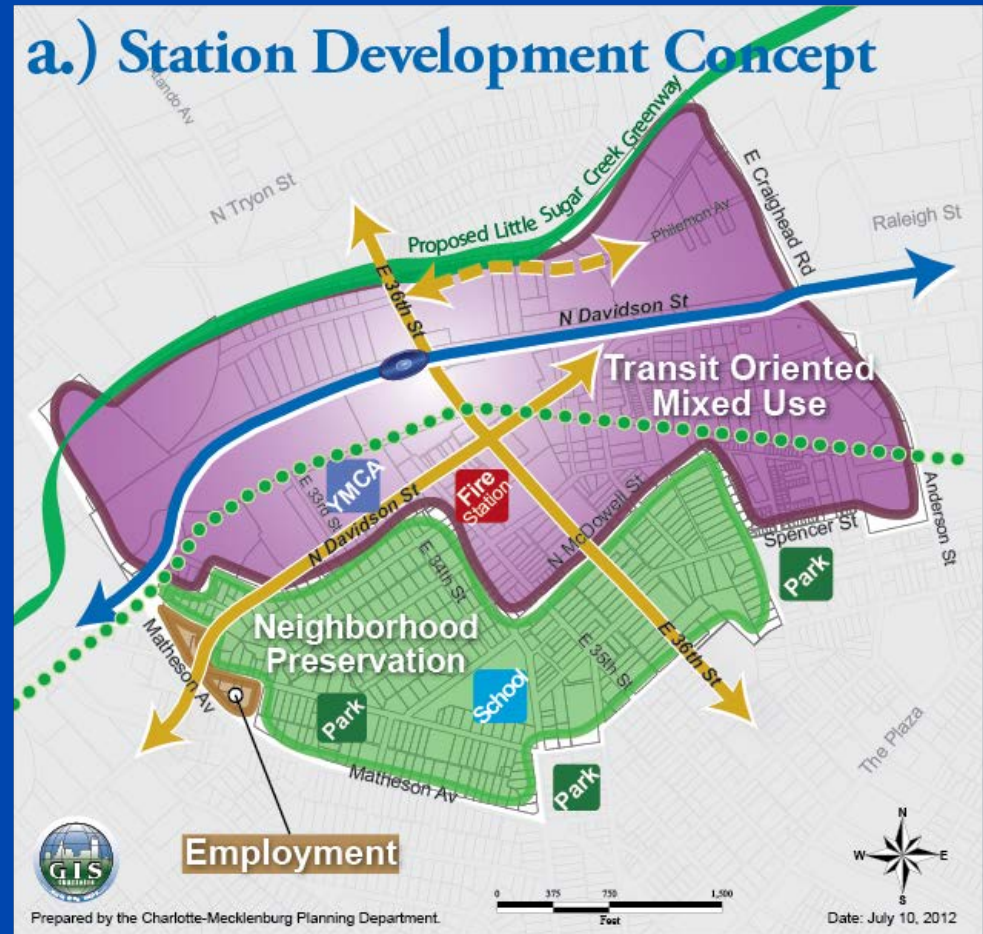



- Provides policy guidance for
 - Land Use
 - Community Design
 - Transportation
 - Infrastructure & Public Facilities
 - Natural Environment
- Keys directly to Implementation Guide

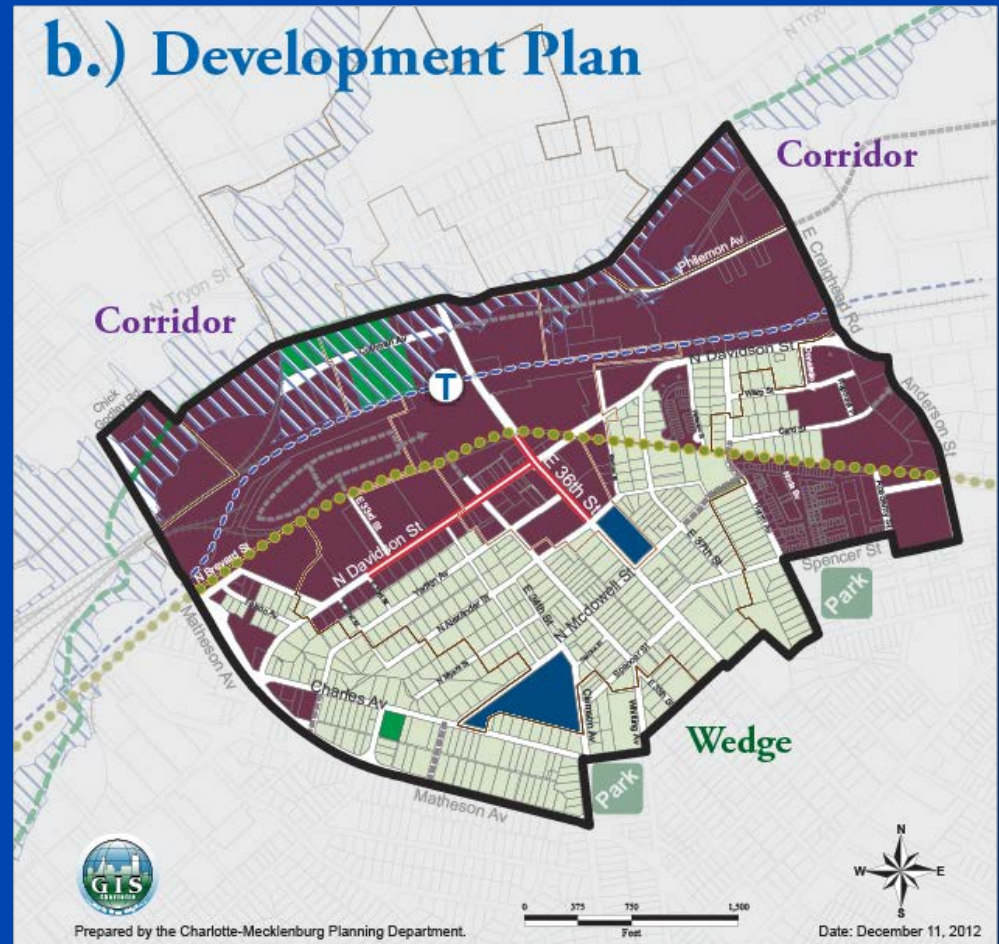

- Provides details
 - Building Types
 - Building Design
- Community's vision for development

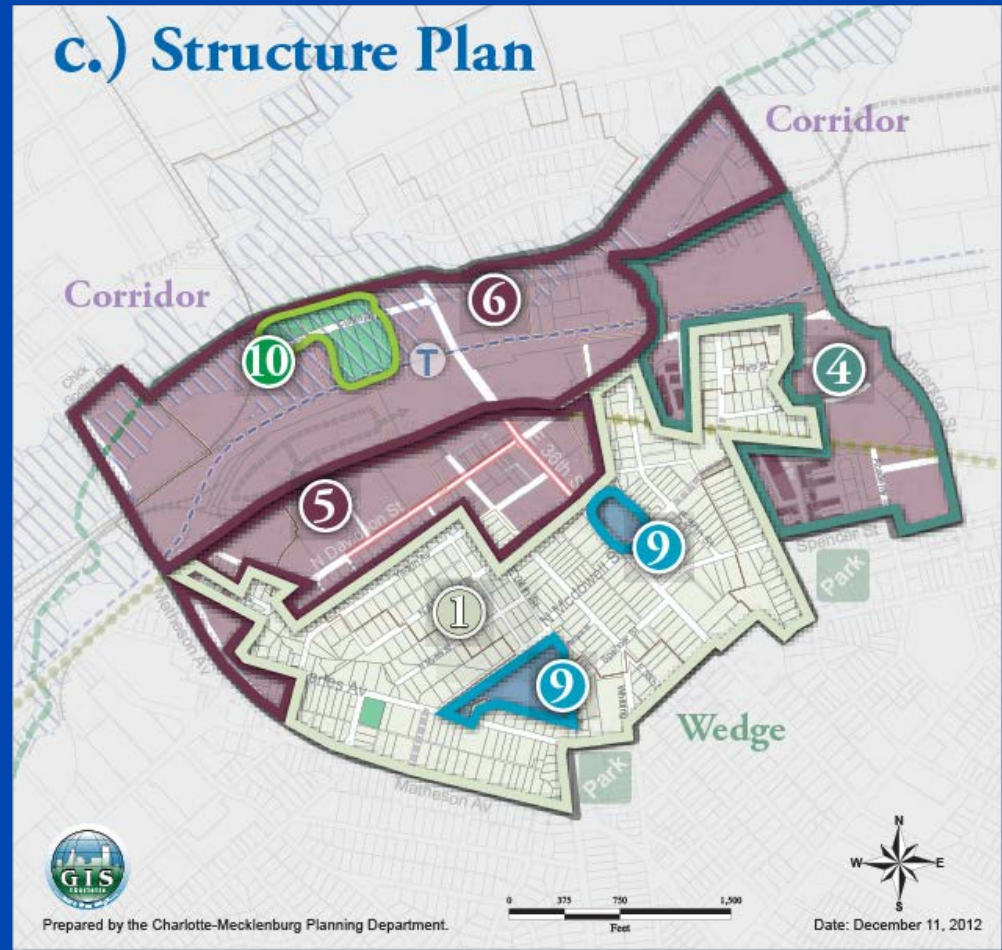

- Provides policy guidance for
 - Future capital projects
 - Land development improvements
- Keys directly to Implementation Guide

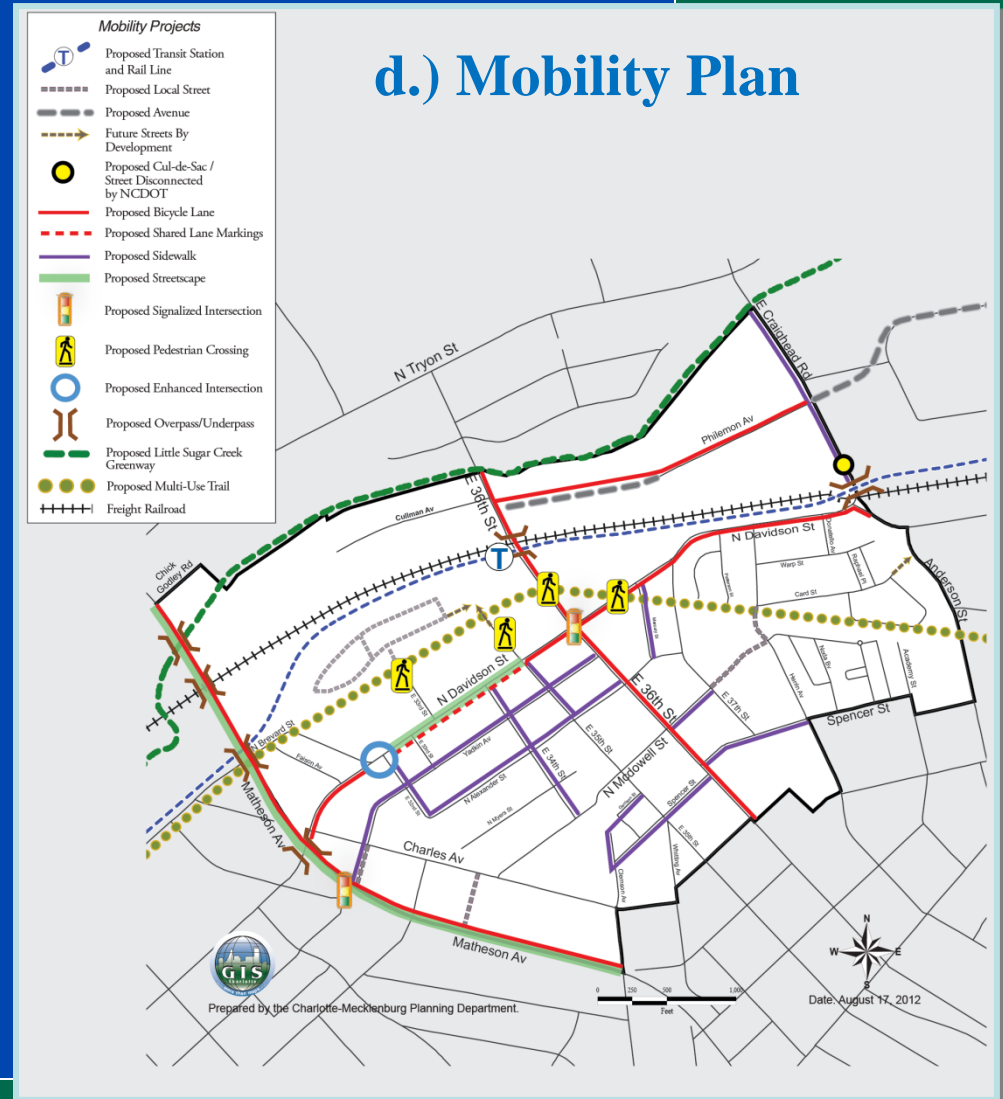



CITY OF CHARLOTTE



Plan Comments

- Document will be available at 1st week in March.
- Sign-up for "Notify Me"
- Hard copy available at University Regional Library and Sugar Creek Library.

www.charlotteplanning.org

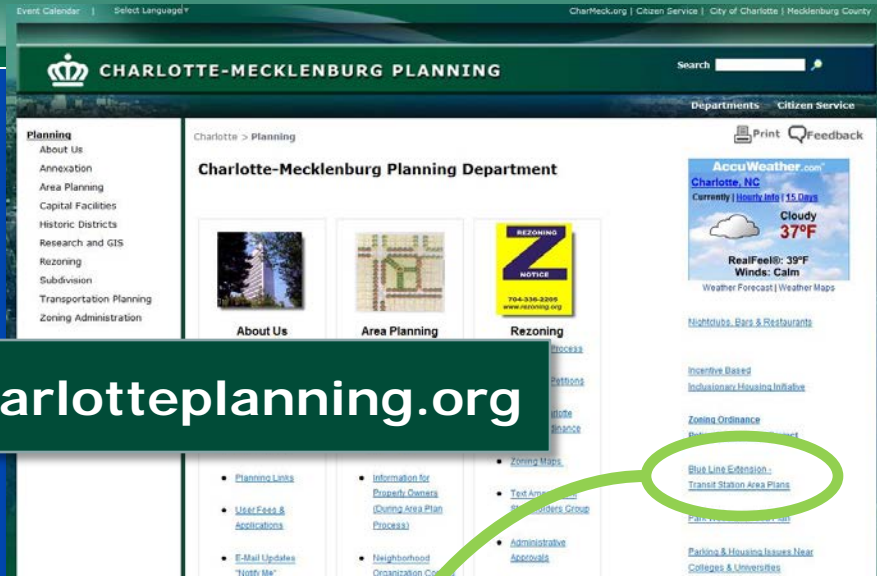

Different Ways to Provide Comments on the Plan

- Submit a comment at any time during this meeting.
- Use the online comment form at:
www.charlotteplanning.org.
- Email your comment to:

BLEstationareaplan@charlottenc.gov



Comment on Plans
Coming Soon!



CITY OF CHARLOTTE



Implementation





CITY OF CHARLOTTE



Art In Transit



CITY OF CHARLOTTE

Art-in-Transit Exhibition

• Exhibitions

- Jan. 14th - Feb. 28th
UNC-Charlotte
Main Campus –
Storrs Gallery
- March 8th – 30th
McColl Center for
Visual Art

• Opening Reception

- March 9th, 4-6pm, McColl
Center for Visual Art

• Neighborhood Meetings

- February and March

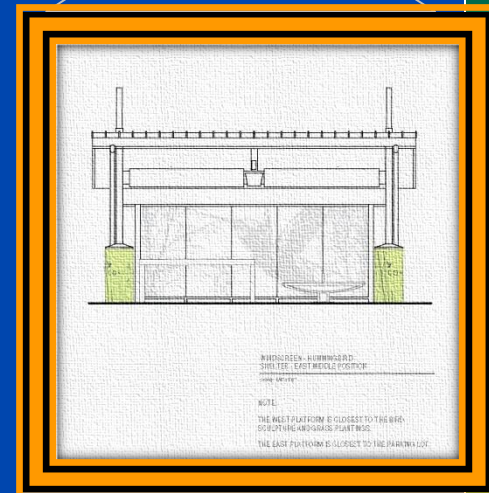
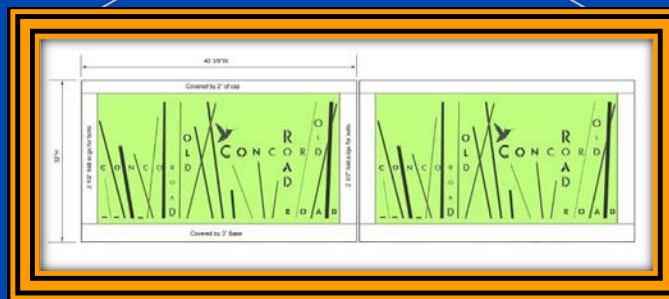



Display 16 Artists' Proposed Artwork for:

- Stations
- Walls and Bridges
- Park and Ride Lots and Elevators
- Signal Houses and Systems
- Bike Shelters

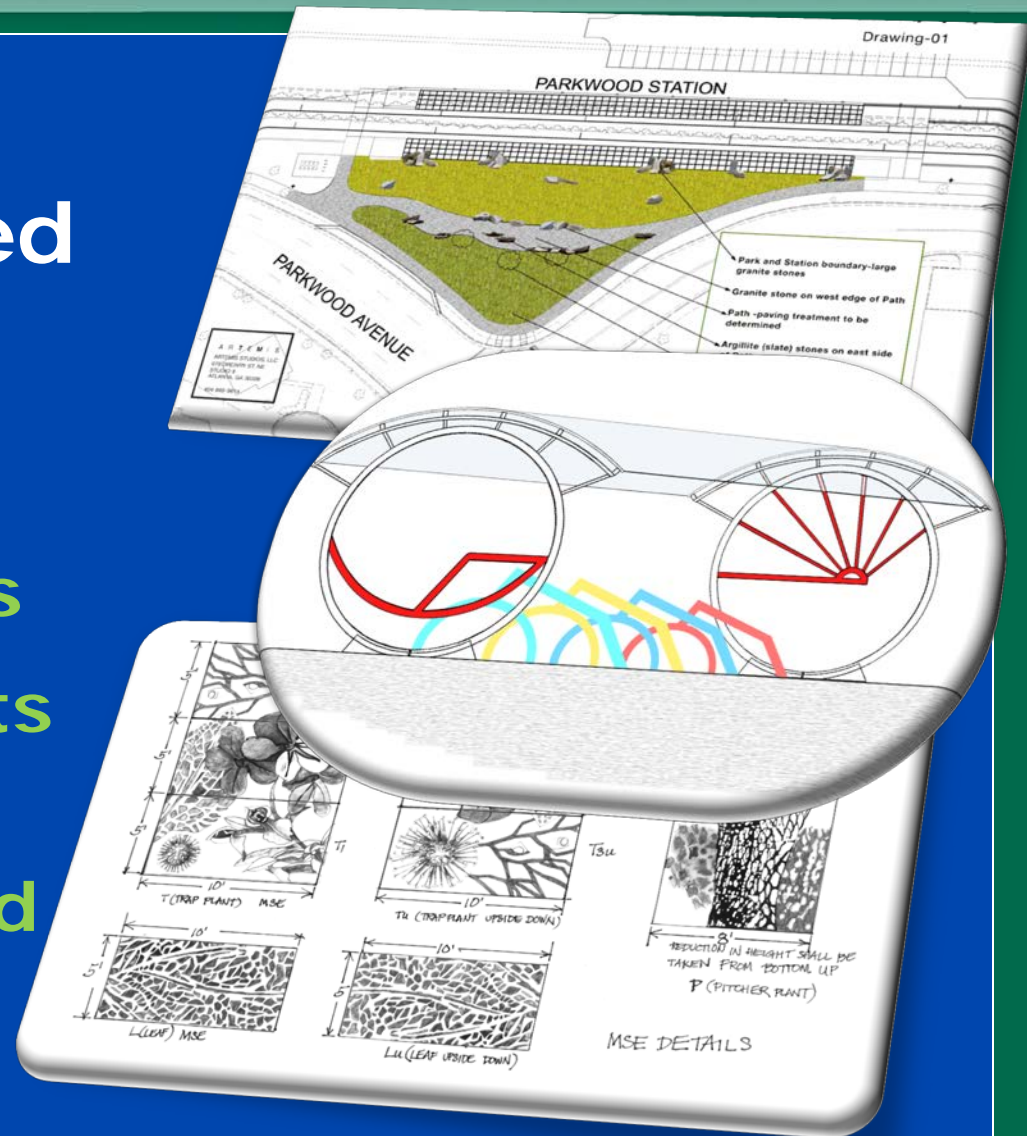



CITY OF CHARLOTTE



Break to Visit Stations



Find Your Station!

Stage/Screen

36th Street

Tom Hunter

Old Concord

Sugar Creek

25th Street

Community
Design

Parkwood

General Seating Area

Public
Facilities &
Natural
Environment

CATS
Real Estate

Art in Transit

Entrance

Sign In
Table

WWW.CHARLOTTE-NC.ORG



CITY OF CHARLOTTE



Next Steps

Plan Development Process

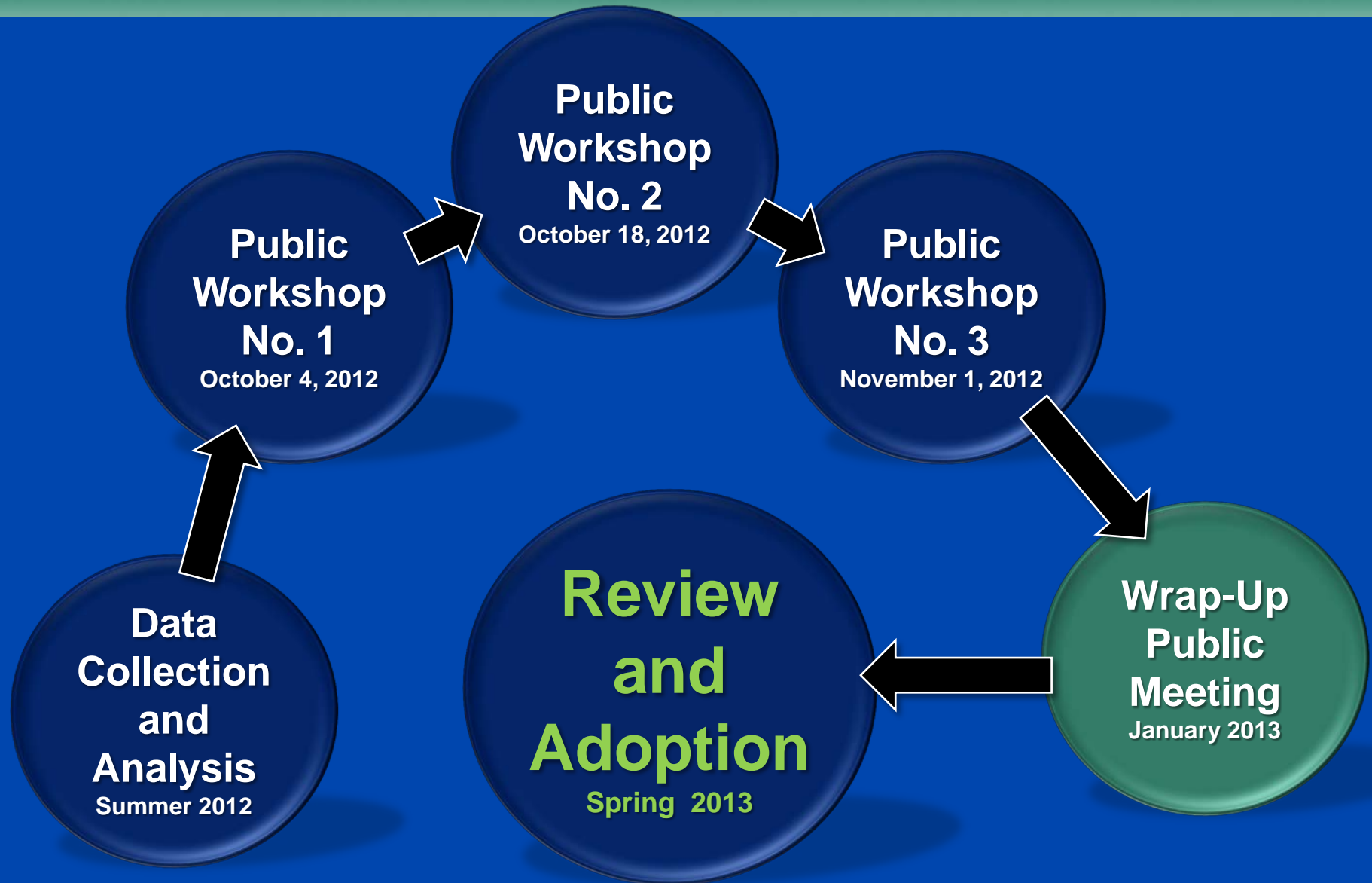

Tentative Plan Review and Adoption Schedule

Spring/
Summer

- Planning Committee - Review and Hear Public Comments
- Council Committee - Review
- Planning Committee - Recommendation
- City Council – Hear Public Comments
- Council Committee – Recommendation
- City Council – Adoption







CITY OF CHARLOTTE

Thank You!

www.charlotteplanning.org



What is the Concept Plan?

- Considers the vision and goals
- Illustrates the recommended development pattern
- General in nature and to provide guidance for policies

