



CHARLOTTE HISTORIC DISTRICT COMMISSION
CERTIFICATE OF APPROPRIATENESS

CERTIFICATE NUMBER: HDCRMI 2018-00052

DATE: August 22, 2018

ADDRESS OF PROPERTY: 1720 Thomas Avenue

TAX PARCEL NUMBER: 08118610

HISTORIC DISTRICT: Plaza Midwood

OWNER/APPLICANT: Zoe Rives

DETAILS OF APPROVED PROJECT: The project is front yard landscaping that includes a new walkway and shrubs. See attached site plan.

1. Applicable Policy & Design Guidelines and Approval Authority – Projects Eligible for Administrative Approval, page 2.6: Properly Sited & Screened Mechanical Units.

- This Certificate of Appropriateness (COA) indicates that this project proposal has been determined to comply with the standards and policies of the Charlotte Historic District Commission.
- Display the blue COA placard in a visible location along with any required permits.
- No other approvals are to be inferred.
- No demolition other than that specifically indicated on any attached plans is authorized under this approval.
- All work must be completed in accordance with all other applicable state and local codes.
- Any changes from or additions or deletions to the plans referenced herein will void this Certificate, and a new application must be filed with the Historic District Commission.

This Certificate is valid for a period of twelve (12) months from the date of issuance. Failure to obtain a building permit in that time will be considered as a failure to comply with the Certificate and the Certificate will become invalid. If a building permit is not required, then the approved work must be completed within twelve (12) months of the date of issuance of this Certificate. In either situation, the Certificate can be renewed for an additional twelve (12) months by Historic District Commission staff by written request within the first twelve (12) months from the date of issuance.

James Haden, Chairman

Staff

1720 THOMAS AVE

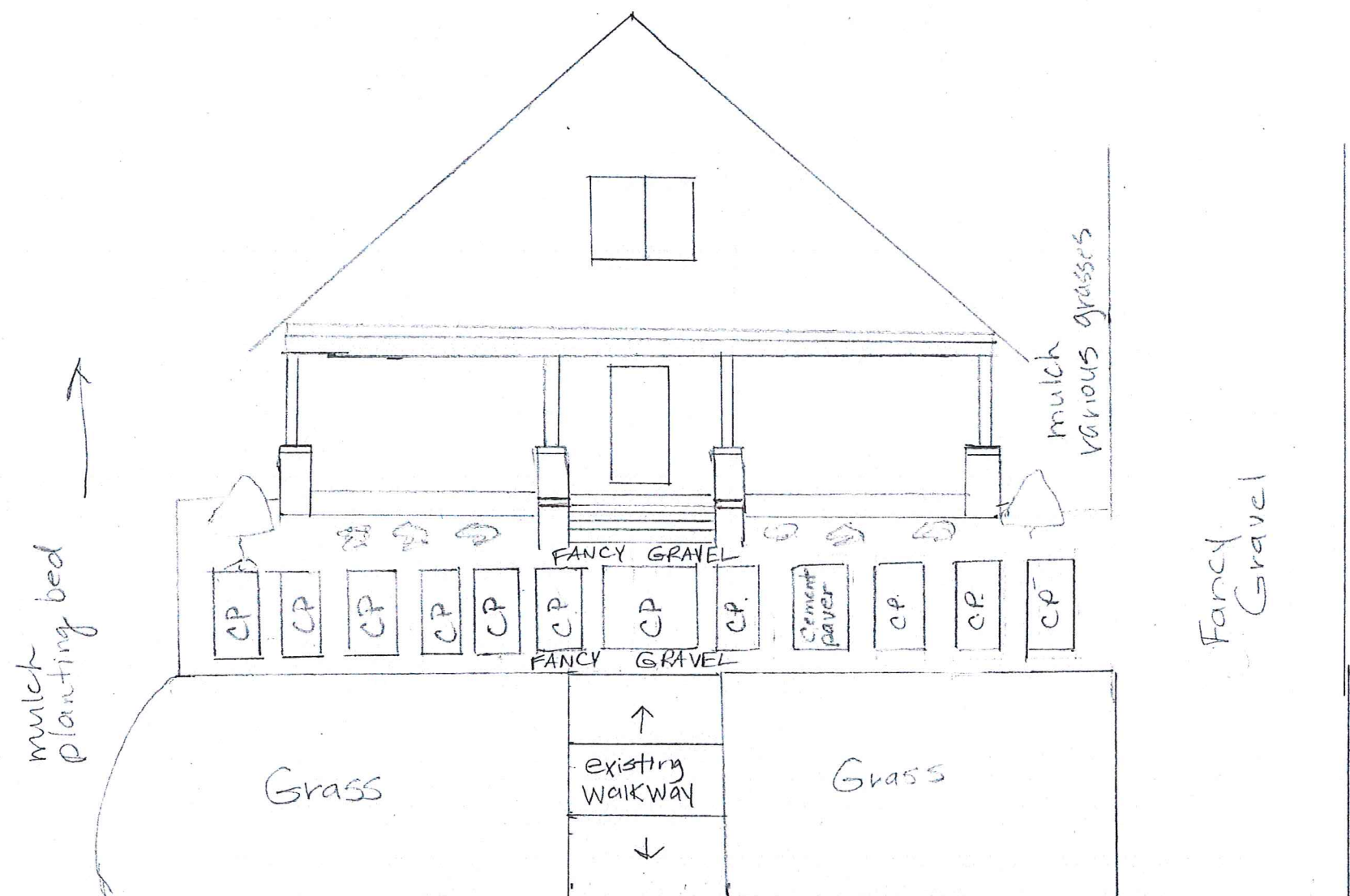

APPROVED

Charlotte
Historic District
Commission

Certificate of Appropriateness

2018-00052

SIDEWALK

Grass

THOMAS AVE