

---

**LOCAL HISTORIC DISTRICT:** Wilmore

**PROPERTY ADDRESS:** 243 West Park Avenue

**SUMMARY OF REQUEST:** Alternate material

**APPLICANT:** Todd Brower

---

**Details of Proposed Request**

*Existing Conditions*

The existing structure is a one story Queen Anne Victorian Cottage constructed in 1926. A COA was issued September 2016 for a rear addition, windows, doors and siding repair/replacement. A stop work order was issued March 2017 for a siding material that cannot be approved administratively.

*Proposal*

The applicant is applying for the use of Smartside siding, an engineered wood product with a wood grain finish.

**Policy & Design Guidelines for Materials, page 34**

1. The Historic District Commission considers substitute siding to be inappropriate for use in a designated Local Historic District, and does not allow its use on an historic structure within a Local Historic District.
2. The use of the following substitute siding materials is considered incongruous with the overall character of local historic districts, and is prohibited.
  - Vinyl
  - Aluminum or other metal sidings
  - Masonite
3. Cementitious board products are rarely considered appropriate for the main structure on a property. The Historic District Commission will consider these products on a case by case basis.
4. All proposals for the use of other non-traditional building materials for projects in Local Historic Districts will be judged on a case-by-case basis by the full Historic District Commission. The Commission will determine how well the proposed material and its proposed use are contextually appropriate in design, texture and other visual qualities.
5. The use of substitute or replacement building materials will not be considered as an alternative to routine maintenance.

**Staff Analysis** - The Commission will determine if the siding material is appropriate for the main structure.

*Charlotte Historic District Commission Case 2017-298*  
**HISTORIC DISTRICT: Wilmore**  
**SUBSTITUTE MATERIAL**











CHARLOTTE HISTORIC DISTRICT COMMISSION

CERTIFICATE OF APPROPRIATENESS

CERTIFICATE NUMBER: 2016-201      DATE: 1 September 2016

ADDRESS OF PROPERTY: 243 West Park Avenue

HISTORIC DISTRICT: Wilmore      TAX PARCEL NUMBER: 11908922

OWNER(S): Cresco Investing, LLC and RNR Investing, LLC

**DETAILS OF APPROVED PROJECT:** The project is a rear addition, new driveway, new fence, replacement windows and doors, and siding repair/replacement. An existing rear addition will be reconfigured with changes the fenestration, roofline, and addition of new flush-mounted, factory-clad skylights, see attached exhibit labeled 'Rear and Front Elevation – September 2016.' The project also includes the construction of a new wood deck measuring approximately 8' x 18" at the rear of the house. The deck rail will be wood with the pickets centered on the top and bottom rails. An additional piece of trim will be added along the top rail. A new gravel driveway will be installed along the left side of the house, terminating in the rear yard, see attached exhibit labeled 'Site Plan – September 2016.'

A new wood fence will be installed around the rear yard and will tie in at the rear corners of the house. The fence will be panels of pickets butt-joined to 6x6 uprights and framed off at the top and bottom. The fence will not exceed six feet in height with the exception of any decorative caps. All framing members will face inward to the property being enclosed or both sides of the fence will be the same. The finished fence will be painted or stained. See exhibit labeled 'Fence Design – September 2016.'

All existing vinyl replacement windows will be removed and new wood windows will be installed. The new windows are double-hung, sash-kit replacements and will be Simulated True Divided Light (STD) with exterior muntins in a 2/2 pattern. On the left elevation a double-hung window will be changed to a transom window, see exhibit labeled 'Right and Left Elevations – September 2016.' The non-original front doors will be replaced with new wood front doors, see exhibit labeled 'Door Design – September 2016.' The front façade will be restored, with new 8" round or square wood columns atop existing brick piers and a new handrail constructed to historic precedent, see exhibit labeled 'Rear and Front Elevations – September 2016.'

*Continued on second page.*



All non-original materials (aluminum siding, trim, details etc.) will be removed. The original wood siding, trim, details etc. will be repaired. If portions of the siding, trim, details, etc. are too deteriorated to repair, then the new replacement elements will match existing in material, design, and dimension. A new brick paver walkway will be installed from the front porch to the sidewalk. The project also includes a new roof, which does not require approval.

1. Applicable Policy & Design Guidelines and Approval Authority – Projects Eligible for Administrative Approval-Additions, page 39: Additions to the rear of existing structures that are neither taller nor wider than the original structure may be eligible for administrative approval. Fences Replacement Windows and Doors
2. This application is in compliance with Policy & Design Guidelines based on location of proposed work.

- This Certificate of Appropriateness (COA) indicates that this project proposal has been determined to comply with the standards and policies of the Charlotte Historic District Commission.
- Display the blue COA placard in a visible location along with any required permits.
- No other approvals are to be inferred.
- No demolition other than that specifically indicated on any attached plans is authorized under this approval.
- All work must be completed in accordance with all other applicable state and local codes.
- Any changes from or additions or deletions to the plans referenced herein will void this Certificate, and a new application must be filed with the Historic District Commission.

This Certificate is valid for a period of twelve (12) months from the date of issuance. Failure to obtain a building permit in that time will be considered as a failure to comply with the Certificate and the Certificate will become invalid. If a building permit is not required, then the approved work must be completed within twelve (12) months of the date of issuance of this Certificate. In either situation, the Certificate can be renewed for an additional twelve (12) months by Historic District Commission staff by written request within the first twelve (12) months from the date of issuance.

  
James Haden, Chairman

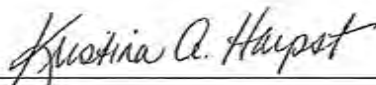
  
Staff



## DEMOLITION

DEMOLITION NOTES:  
LOCATE ALL UNDERGROUND UTILITY SERVICES PRIOR TO BEGINNING.  
RELOCATE SERVICES AS NECESSARY.  
REMOVE AND RELOCATE EXISTING LANDSCAPING AND/OR TREES AS DIRECTED BY OWNER OR NOTED ON PLAN.

PROVIDE FOR PROTECTION OF EXISTING STRUCTURE  
PROVIDE FOR PROTECTION OF EXISTING AREAS NOT AFFECTED  
BY NEW RENOVATION AND/OR ADDITION

PROVIDE FOR TEMPORARY SUPPORTS  
AS NEEDED TO SECURE STRUCTURE  
VERIFY THE CONDITION OF EXISTING BUILDING ELEMENTS  
THAT ARE TO REMAIN. REPORT ANY SUSPICIOUS OR  
DAMAGED ELEMENTS TO OWNER WITH RECOMMENDATIONS  
FOR REPAIR OR REPLACEMENT  
REMOVE ALL DEBRIS FROM SITE

Site Plan - September 2016



APPROVED

Charlotte  
Historic District  
Commission

Certificate of Appropriateness

# 2016-201

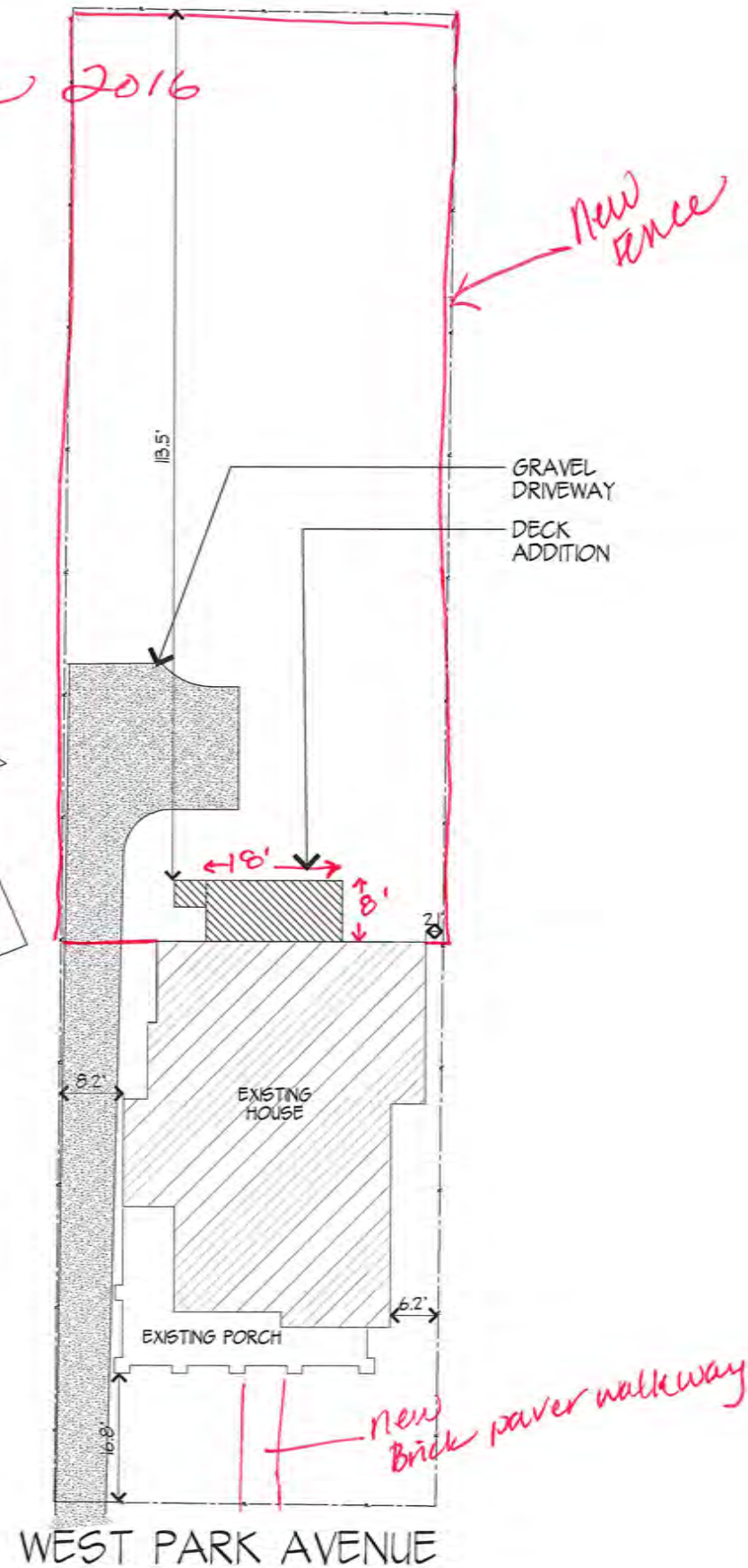
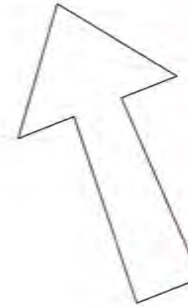

**MND GROUP**

Mike Novick Designs  
www.mndgroup.com

5805 PROSPERITY CHURCH ROAD  
SUITE 202-118  
CHARLOTTE, N.C. 28209  
**704-948-5555**

MIKE NOVICK, DESIGNER

PRIVATE  
RESIDENCE  
RENOVATION

243 WEST PARK AVE  
CHARLOTTE  
NORTH CAROLINA  
28203

## AREA CALCULATIONS

HEATED SQUARE FOOTAGE  
EXISTING  
MAIN LEVEL LIVING 1446.93

NEW PLAN  
MAIN LEVEL LIVING 0  
UPPER LEVEL LIVING 661.56  
TOTAL HSF 2308.49

UNHEATED SQUARE FOOTAGE  
EXISTING ENTRY PORCH 298.91

TOTAL UNHSF 298.91  
TOTAL UNDER ROOF 2607.40

OTHER AREAS  
DECK AREA 412.00

FOR CONSTRUCTION  
6/24/2016

FOR CONSTRUCTION  
6/23/2016

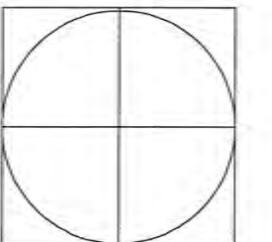

SITE PLAN

1  
AO  
SITE PLAN  
SCALE 1" = 10'-0"

**A0**

IMPORTANT CODE NOTIFICATION:  
NORTH CAROLINA  
IT SHALL BE THE RESPONSIBILITY OF THE GENERAL CONTRACTOR  
AND/OR U.C. TRADES TO INSURE THAT ALL  
LOCAL, STATE AND FEDERAL BUILDING CODES THAT APPLY  
INCLUDING 2015 NC RESIDENTIAL CODE AND  
ANY AMENDMENTS OR UPDATES THAT APPLY  
BE FOLLOWED AND THAT THE MATERIALS, METHODS AND DETAILS  
USED FOR THE EXECUTION OF THIS PLAN MEET OR EXCEED  
ALL LOCAL, STATE AND FEDERAL BUILDING CODES THAT APPLY  
INCLUDING BUT NOT LIMITED TO BUILDING STANDARD,  
FIRE AND EGRESS, AND ENERGY - ENVIRONMENTAL CODES

The Drawing and all Information Contained within are the sole Property of  
The MND Group, Mike Novick Designs and may not be used or distributed by others  
without written consent of Mike Novick and/or the MND Group.  
Representation of the plan in whole or in part is prohibited, without consent of The MND Group.  
The plan may have been provided as a representation of a Residential Building Structure  
offered as part of Residential Design Services.  
Mike Novick does not provide Professional, Architectural, or Engineering services.  
Clients of the MND Group are provided the use of the drawing as part of a service provided.  
The MND Group, Mike Novick Designs, Mike Novick retain Full Ownership of the Drawing.  
copyright 2016 www.mndgroup.com



243 WEST PARK AVE  
CHARLOTTE  
NORTH CAROLINA  
28203

FOR CONSTRUCTION  
8/9/2016

EXTERIOR ELEVATIONS

## A6.0

APPROVED  
Certificate of Appropriateness  
#2016-201

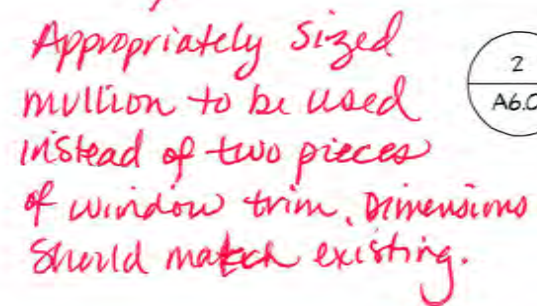

2 REAR ELEVATION  
A6.0 SCALE 1/4" = 1'-0"



See door exhibit

**IMPORTANT CODE NOTIFICATION:**  
NORTH CAROLINA  
IT SHALL BE THE RESPONSIBILITY OF THE GENERAL CONTRACTOR AND/OR LIC. TRADER TO INSURE THAT ALL  
LOCAL, STATE AND FEDERAL BUILDING CODES THAT APPLY  
INCLUDING 2012 NC RESIDENTIAL CODE AND  
ANY AMENDMENTS OR UPDATES THAT APPLY  
BE FOLLOWED AND THAT THE MATERIALS, METHODS AND DETAILS  
FOR THE DESIGN OF THE STRUCTURE ARE IN ACCORD WITH OR EXCEED  
ALL LOCAL, STATE AND FEDERAL BUILDING CODES THAT APPLY  
INCLUDING BUT NOT LIMITED TO BUILDING STANDARD  
FIRE AND EGRESS, AND ENERGY - ENVIRONMENTAL CODES



Right & Left Elevations - September 2016

**MND GROUP**

Mike Novick Designs  
www.mndgroup.com

5806 PROSPERITY CHURCH ROAD  
SUITE #A2-118  
CHARLOTTE, N.C. 28269  
**704-948-5556**

MIKE NOVICK, DESIGNER

PRIVATE  
RESIDENCE  
RENOVATION

243 WEST PARK AVE  
CHARLOTTE  
NORTH CAROLINA  
28203

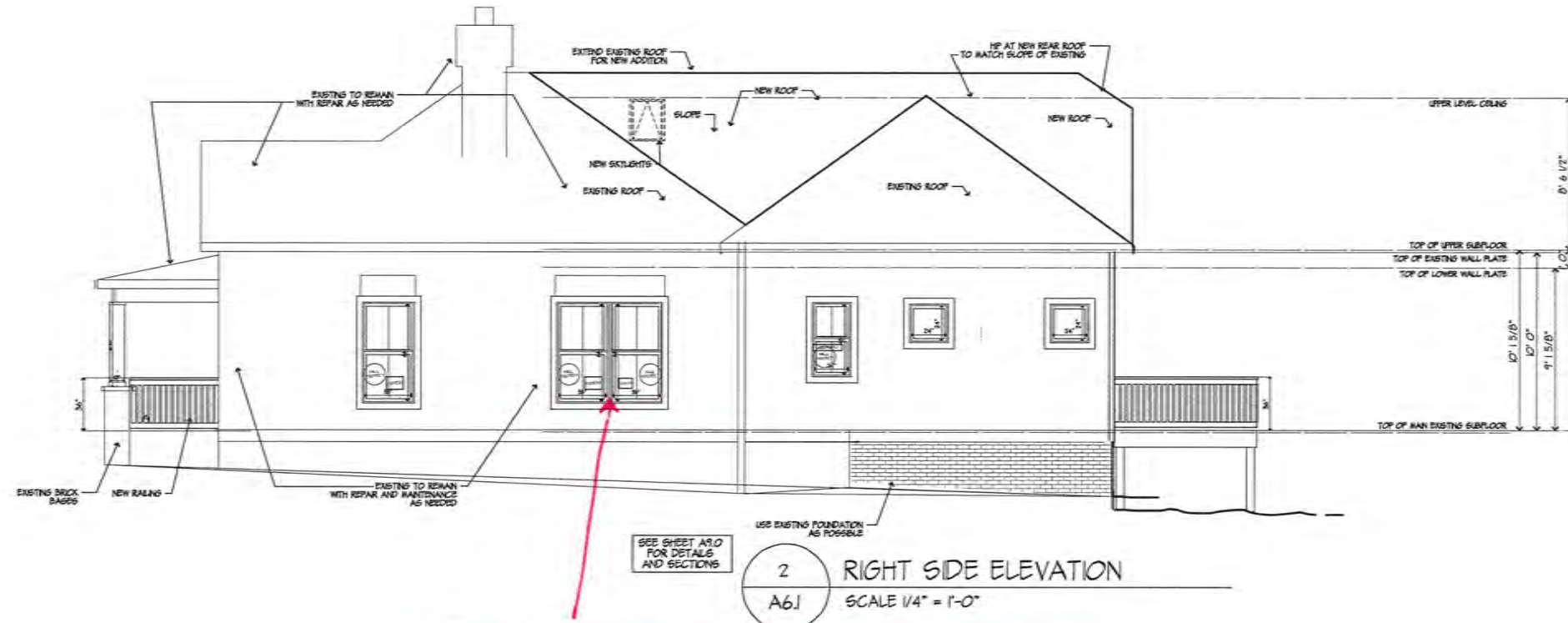

If original trim/mullion needs replaced, then  
appropriately sized mullion to be used  
instead of two pieces of window trim.

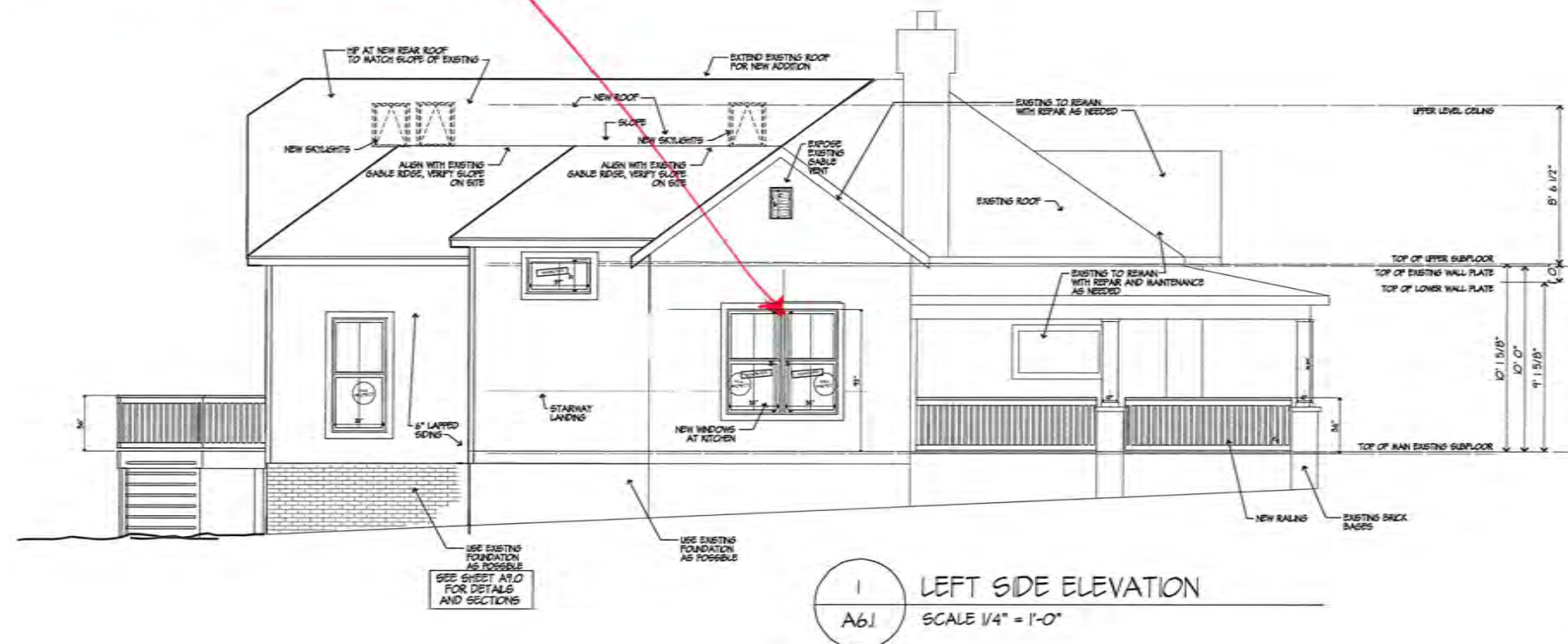

FOR CONSTRUCTION  
8/19/2016

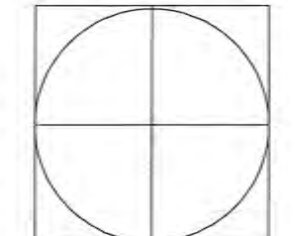

EXTERIOR ELEVATIONS

**IMPORTANT CODE NOTIFICATION:**  
NORTH CAROLINA  
IT SHALL BE THE RESPONSIBILITY OF THE GENERAL CONTRACTOR  
AND/OR LIC. TRACERS TO INSURE THAT ALL  
LOCAL, STATE AND FEDERAL BUILDING CODES THAT APPLY  
INCLUDING 2015 NC RESIDENTIAL CODE AND  
ANY AMENDMENTS OR UPDATES THAT APPLY  
BE FOLLOWED AND THAT THE MATERIALS, METHODS AND DETAILS  
USED FOR THE EXECUTION OF THIS PLAN MEET OR EXCEED  
ALL LOCAL, STATE AND FEDERAL BUILDING CODES THAT APPLY  
INCLUDING BUT NOT LIMITED TO BUILDING STANDARD  
FIRE AND EGRESS, AND ENERGY - ENVIRONMENTAL CODES

The Drawing and all information contained within are the sole property of  
The MND Group, Mike Novick Designs and may not be used or distributed by others  
without written consent of Mike Novick and/or the Agents.  
Reproduction of this plan in whole or in part is prohibited without consent of The MND Group.  
This plan may have been provided as a representation of a Residential Building Structure  
offered as part of Residential Design Services.  
Mike Novick does not provide Professional, Architectural or Engineering services.  
Clients of the MND Group are provided the use of the document as part of a service provided.  
The MND Group, Mike Novick Designs, Mike Novick retain full Ownership of the Design.  
copyright 2015 www.mndgroup.com

**A6.1**



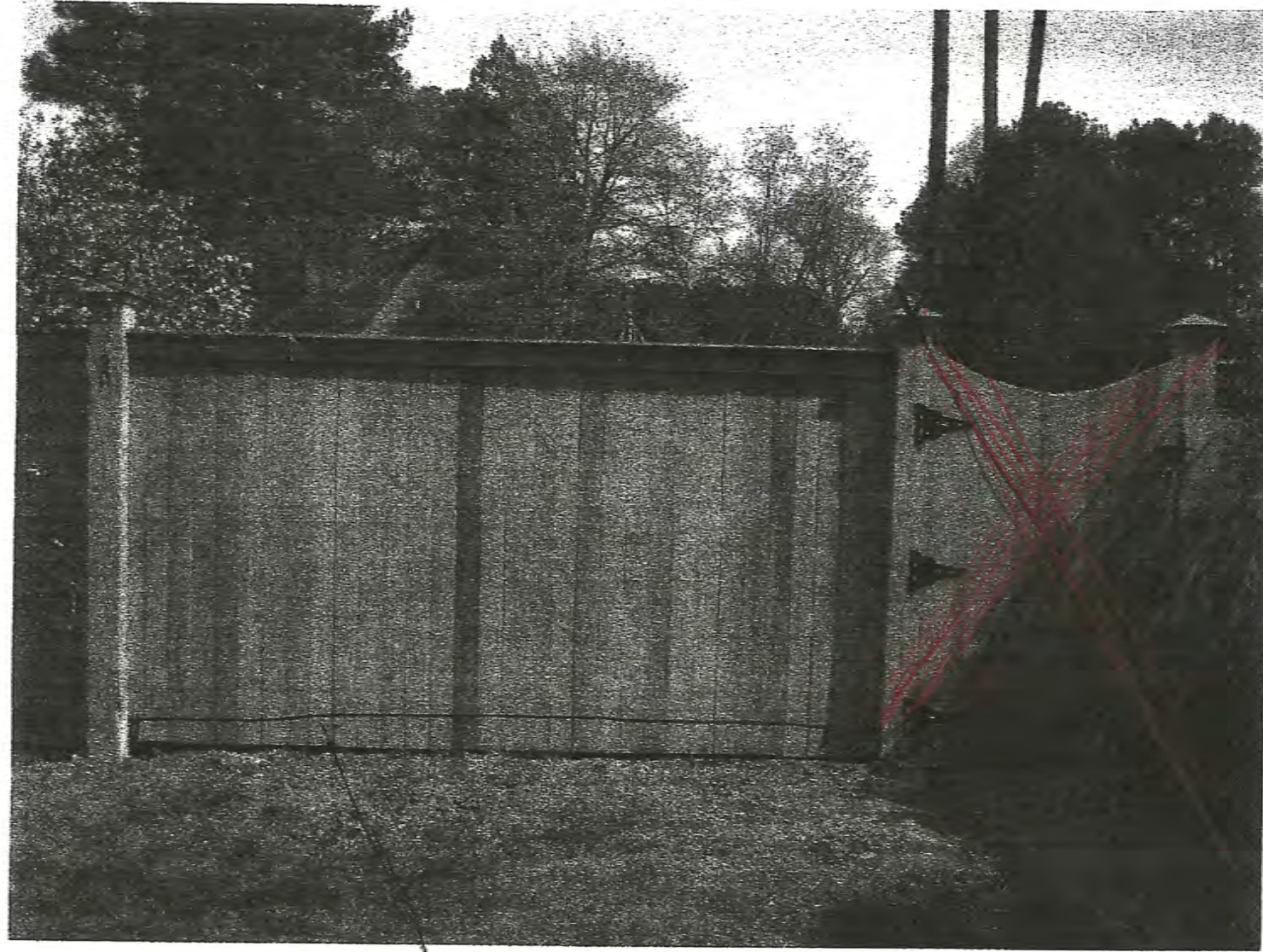

6ft high

wood trim to bottom also  
natural posts.

Fence Design - September 2016



APPROVED

Charlotte  
Historic District  
Commission

Certificate of Appropriateness

# 2016-201





Open until 8PM!  
Central Charlotte

Prices, promotions, styles, and availability may vary. Our local stores do not honor online pricing.

## Masonite 2-Panel Solid Wood Core 9-Lite Hem Fir Unfinished Slab Entry...X

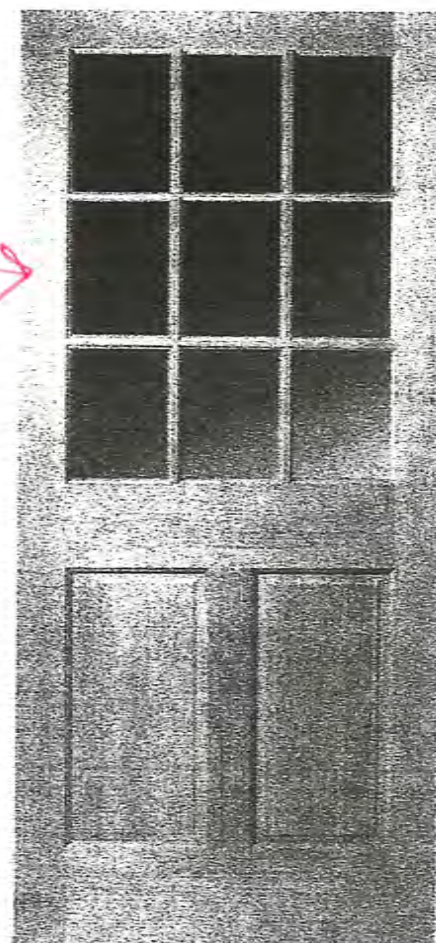

no guide

Today at Central  
Charlotte  
Lowe's!

Door Design - September 2016



APPROVED

Charlotte  
Home Design  
Commission

Certificate of Appropriateness

2016-201

Aisle 18, Bay 6

In-Store Map

CHECK OTHER STORES

Get 5% Off Every Day or



Scan for install instructions.



38 Series Lap

.31 IN x 7.84 IN x 191.87 IN  
8.0mm x 199mm x 4.87m



0 88991 55541 9

Made in USA





**WARNING**  **AVERTISSEMENT**

Risk of burns

Flue hood exhaust surfaces may be hot.



Risk de brûlures

Les surfaces d'échappement du chapeau de tuyau peuvent être chaudes.

**WARNING**



Read and understand all instructions and warnings before using this product. Failure to do so may result in injury or death. For more information, see the user manual.





















PLY GEM

















Top: LP® SmartSide® Lap, Trim and Fascia | Middle: LP SmartSide Lap, Cedar Texture Shakes (straight), Trim and Fascia | Bottom: LP SmartSide Lap, Trim and Fascia



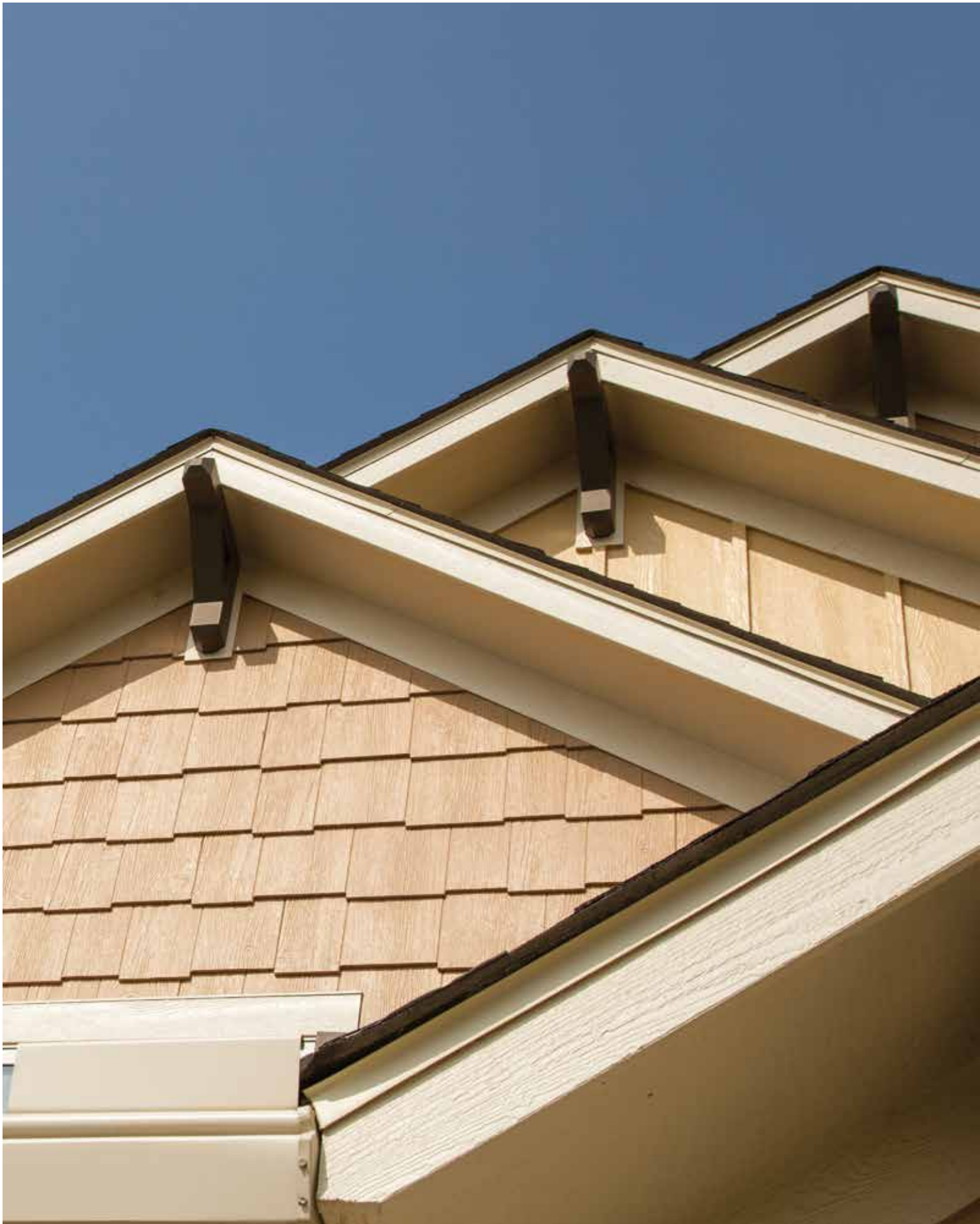

*Featured: LP® SmartSide® Cedar Texture Shakes (staggered), Panel (Board and Batten), Soffit, Trim and Fascia*







# We protect great homes and great reputations.

The LP SmartSide family offers a complete line of exterior trim and siding products – including lap, panel, trim, fascia and soffit – that are engineered using advanced siding technology to give homebuyers the traditional look of real wood, while helping to protect their homes from harsh weather conditions and termites. Every step of the manufacturing process is designed to create a high-performance product that's tough and durable, so it performs beautifully for decades.



For more information on our complete line of LP SmartSide trim and siding products, please call 888-820-0325 or visit us at [LPSmartSide.com](http://LPSmartSide.com)

[LPCorp.com](http://LPCorp.com) | **BUILD WITH US.**

**Cal. Prop 65 Warning:** Use of this product may result in exposure to wood dust, known to the State of California to cause cancer.

2014 Louisiana-Pacific Corporation. All rights reserved. SmartGuard<sup>®</sup> is a trademark of Louisiana-Pacific Corporation and S-T-N Holdings, Inc. All other trademarks are owned by Louisiana-Pacific Corporation. Printed in the USA.

LPZB0526 25m 11/14

**Engineered to Perform Beautifully**

[LPCorp.com](http://LPCorp.com) | **BUILD WITH US.**





# Carefully designed. Brutally tested.

## LP SmartSide: The Next Generation of Siding

LP® SmartSide® products are engineered using advanced siding technology that includes the proprietary SmartGuard® process. Each manufacturing step is designed to create durable siding that will perform beautifully for decades. SmartGuard uses zinc borate to resist termites and fungal decay. This treatment is applied throughout the substrate of all products, which are then factory primed to add yet another level of protection against moisture.



## Warranty

LP SmartSide products come backed with one of the most competitive warranties in the market today:

A 5/50 year limited warranty provides a 5-year, 100% labor and replacement feature and a 50-year prorated warranty on the product.

Please visit [LPCorp.com](http://LPCorp.com) to view the complete LP SmartSide warranty.



## Tested to withstand the worst

Since 1996, LP SmartSide strand substrate siding has undergone brutal testing in Hilo, Hawaii. An average temperature of more than 70 degrees, high levels of humidity and almost 170 inches of annual rainfall make Hilo's climate the perfect breeding ground for wood's worst enemies – termites, moisture and fungal decay.

After 15 years of exposure in the toughest of conditions, SmartSide is still standing strong.

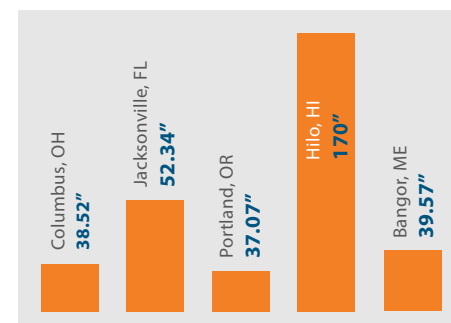

**Average Annual Rainfall in Hilo**  
(in inches)



**Exposure Testing**

## Untreated Wood vs. LP SmartSide Product



Untreated wood devastated by Formosan termites (left) and undamaged LP SmartSide product protected with the SmartGuard® process (right) during same testing period.

## Tackling Termites

To put LP SmartSide strand substrate siding products to the ultimate test, we regularly expose samples to Formosan termites, widely recognized as one of the world's most destructive pests. Each sample is placed on a plastic grid, surrounded by untreated bait samples, then laid directly on top of termite colonies. Even after 3 years, the LP SmartSide siding shows no structural damage, while the bait samples were completely destroyed within three months.

## The Formosan Termite



*Coptotermes formosanus*

## Formosan Termite Distribution in the US

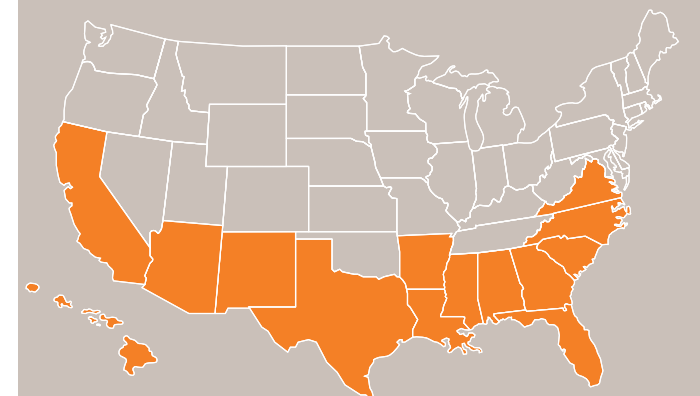



# Cedar Texture Lap

## The Bold Look Of Cedar Without Many Of The Worries

- One of the most durable lap siding options in the market today
- 16' length can result in faster installation
- Fewer seams than traditional 12' siding
- Pre-primed for exceptional paint adhesion
- Self-aligning SmartLock™ option installs faster and more efficiently
- Treated engineered wood strand substrate
- APA-certified lap siding

Also available in fiber substrate.

- CPA-certified lap siding
- Treated engineered wood fiber substrate

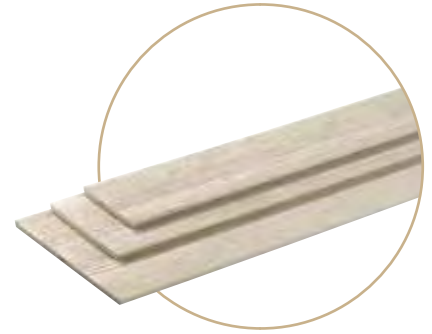

Cedar texture

### 38 Series Cedar Texture Lap (strand)

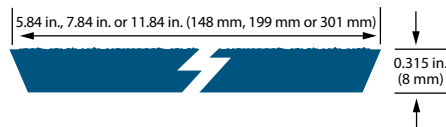

### 76 Series Cedar Texture Lap (strand)

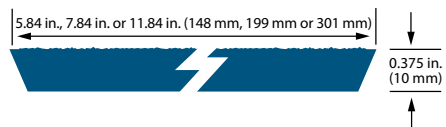

### 76 Series SmartLock Cedar Texture Lap (strand)

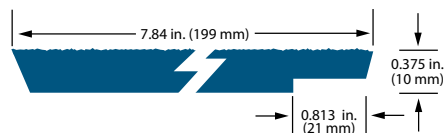

### 76 Series Cedar Texture Lap (fiber)

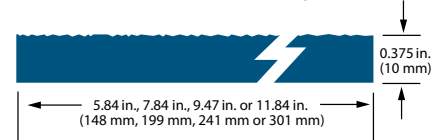

### 120 Series Self-Aligning Cedar Texture Lap (fiber)

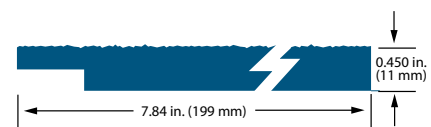

DESCRIPTION	LENGTH	ACTUAL WIDTH	MINIMUM THICKNESS	PID NUMBER
38 Series Cedar Texture Lap (strand)	16 ft. (192 in.)(4877 mm)	5.84 in. (148 mm)	0.315 in. (8 mm)	25796
	16 ft. (192 in.)(4877 mm)	7.84 in. (199 mm)	0.315 in. (8 mm)	25797
	16 ft. (192 in.)(4877 mm)	11.84 in. (301 mm)	0.315 in. (8 mm)	25799
76 Series Cedar Texture Lap (strand)	16 ft. (192 in.)(4877 mm)	5.84 in. (148 mm)	0.375 in. (10 mm)	25785
	16 ft. (192 in.)(4877 mm)	7.84 in. (199 mm)	0.375 in. (10 mm)	25786
	16 ft. (192 in.)(4877 mm)	11.84 in. (301 mm)	0.375 in. (10 mm)	25787
76 Series Cedar Texture Lap (fiber)	16 ft. (192 in.)(4877 mm)	5.84 in. (148 mm)	0.375 in. (10 mm)	25922
	16 ft. (192 in.)(4877 mm)	7.84 in. (199 mm)	0.375 in. (10 mm)	25923
	16 ft. (192 in.)(4877 mm)	9.47 in. (241 mm)	0.375 in. (10 mm)	25924
	16 ft. (192 in.)(4877 mm)	11.84 in. (301 mm)	0.375 in. (10 mm)	25925
76 Series SmartLock Cedar Texture Lap (strand)	16 ft. (192 in.)(4877 mm)	7.84 in. (199 mm)	0.375 in. (10 mm)	30317
120 Series Self-Aligning Cedar Texture Lap (fiber)	16 ft. (192 in.)(4877 mm)	7.84 in. (199 mm)	0.450 in. (11 mm)	25905



# Cedar Texture Shakes

## The Luxurious Appeal Of Cedar

- The look of real cedar with easy installation and maintenance over time
- Staggered edges offer a lively, textured effect
- Can be used on all exterior walls or as a decorative accent with any substrate
- Shiplap ends for seamless appearance
- Treated engineered wood fiber substrate
- Reversible staggered or straight edge offers exceptional design versatility

### Cedar Texture Shakes (fiber)

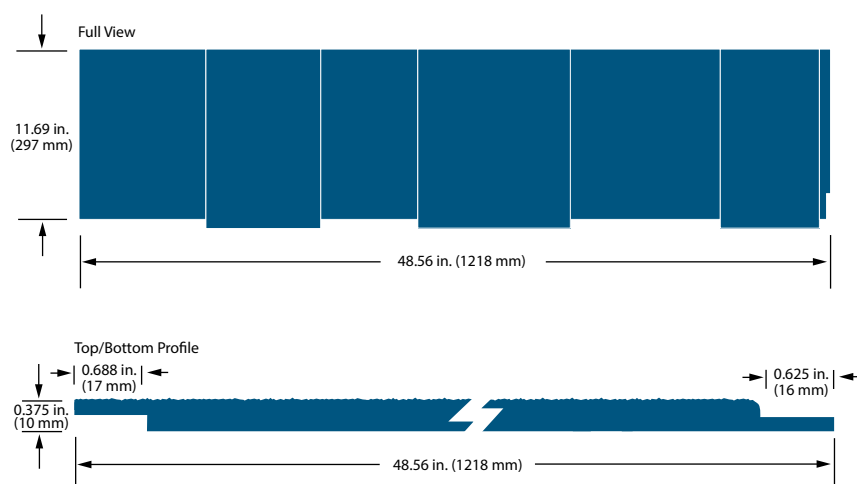

DESCRIPTION	LENGTH	ACTUAL WIDTH	MINIMUM THICKNESS	PID NUMBER
Cedar Texture Shakes (fiber)	48.56 in. (1218 mm)	11.69 in. (297 mm)	0.375 in. (10 mm)	28541



Cedar texture



Staggered



Straight



# 12" Bold Profiles

## Genuine Detail

- Distinctive Triple 4" and Double 5" profiles
- Shiplap edges make it easier to level and apply
- Pre-primed for exceptional paint adhesion
- 16' length can result in faster installation and fewer seams
- Treated engineered wood fiber substrate



Triple 4" Bold Profile Cedar Texture Lap (fiber)

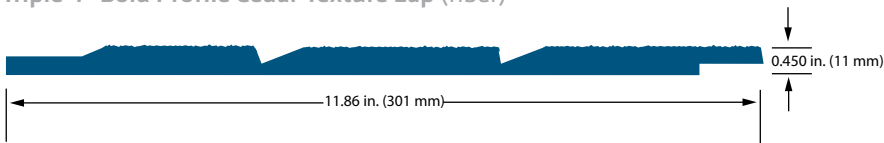

Double 5" Bold Profile Cedar Texture Lap (fiber)

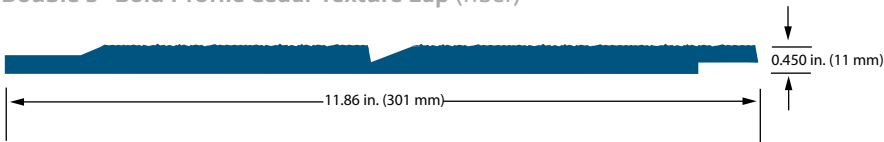

Cedar texture

DESCRIPTION	LENGTH	ACTUAL WIDTH	MINIMUM THICKNESS	PID NUMBER
Triple 4" Bold Profile Cedar Texture Lap (fiber)	16 ft. (192 in.)(4877 mm)	11.86 in. (301 mm)	0.450 in. (11 mm)	25906
Double 5" Bold Profile Cedar Texture Lap (fiber)	16 ft. (192 in.)(4877 mm)	11.86 in. (301 mm)	0.450 in. (11 mm)	25907



# 16" Bold Profiles

## Choices That Make A Statement

- This extra-wide 16" siding comes in three profiles: Quad 4", Triple 5" and Double 8"
- Pre-primed for exceptional paint adhesion
- 16' length can result in faster installation and fewer seams
- Treated engineered wood fiber substrate



### Quad 4" Bold Profile Cedar Texture Lap (fiber)

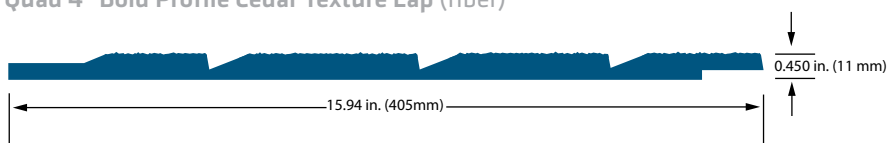

### Triple 5" Bold Profile Cedar Texture Lap (fiber)

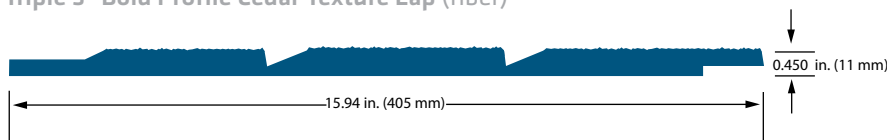

### Double 8" Bold Profile Cedar Texture Lap (fiber)

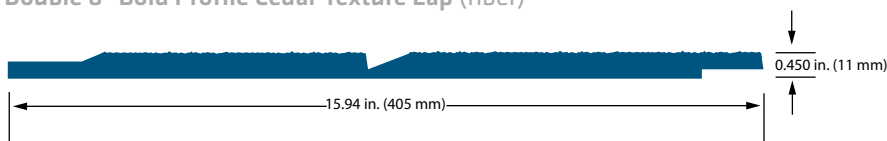

Cedar texture

DESCRIPTION	LENGTH	ACTUAL WIDTH	MINIMUM THICKNESS	PID NUMBER
Quad 4" Bold Profile Cedar Texture Lap (fiber)	16 ft. (192 in.)(4877 mm)	15.94 in. (405 mm)	0.450 in. (11 mm)	25908
Triple 5" Bold Profile Cedar TexturesLap (fiber)	16 ft. (192 in.)(4877 mm)	15.94 in. (405 mm)	0.450 in. (11 mm)	25910
Double 8" Bold Profile Cedar Texture Lap (fiber)	16 ft. (192 in.)(4877 mm)	15.94 in. (405 mm)	0.450 in. (11 mm)	25911



# Colonial Beaded Lap

## Cutting Edge Meets Classical

- Colonial Beaded Lap siding endows homes with authentic American style
- Drip lines cast crisp shadows for maximum curb appeal
- Pre-primed for exceptional paint adhesion
- 16' length can result in faster installation and fewer seams
- Treated engineered wood fiber substrate



### Colonial Beaded Sequoia Texture Lap (fiber)

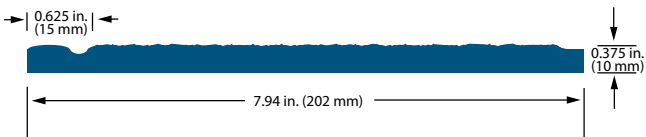

### Colonial Beaded Smooth Finish Lap (fiber)

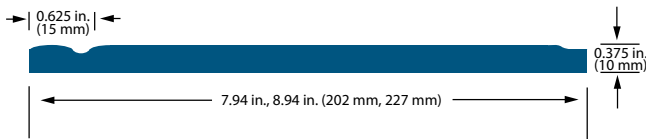

Sequoia texture



Smooth finish

DESCRIPTION	LENGTH	ACTUAL WIDTH	MINIMUM THICKNESS	PID NUMBER
Colonial Beaded Sequoia Texture Lap (fiber)	16 ft. (192 in.)(4877 mm)	7.94 in. (202 mm)	0.375 in. (10 mm)	25904
Colonial Beaded Smooth Finish Lap (fiber)	16 ft. (192 in.)(4877 mm)	7.94 in. (202 mm)	0.375 in. (10 mm)	25903
	16 ft. (192 in.)(4877 mm)	8.94 in. (227 mm)	0.375 in. (10 mm)	25909



# Smooth Finish Lap

## A Traditional, Subtle Look

- Traditional look that accentuates the architectural features of any home
- Smooth finish for a clean appearance
- Pre-primed for exceptional paint adhesion
- 16' length can result in faster installation and fewer seams
- Treated engineered wood fiber substrate

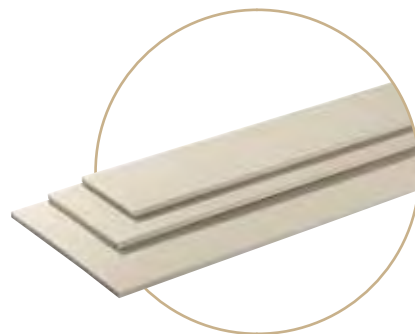

### 76 Series Smooth Finish Lap (fiber)

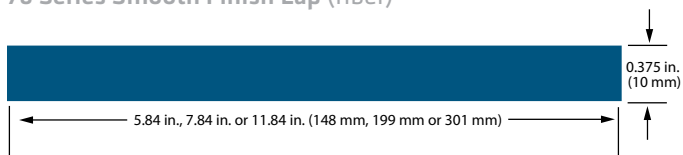

Smooth finish

DESCRIPTION	LENGTH	ACTUAL WIDTH	MINIMUM THICKNESS	PID NUMBER
76 Series Smooth Finish Lap (fiber)	16 ft. (192 in.)(4877 mm)	5.84 in. (148 mm)	0.375 in. (10 mm)	25919
	16 ft. (192 in.)(4877 mm)	7.84 in. (199 mm)	0.375 in. (10 mm)	25920
	16 ft. (192 in.)(4877 mm)	11.84 in. (301 mm)	0.375 in. (10 mm)	25921



# Cedar Texture Panel

## Rated For Structural Use By The Engineered Wood Association

- Shiplap edges with advanced bead system for easier alignment
- Pre-primed for exceptional paint adhesion
- Significantly lighter than comparable fiber cement panel
- Strong enough to be nailed directly to stud, making additional sheathing unnecessary in many applications
- Eliminates need for additional bracing on load-bearing walls
- Ideal exterior for homes in areas of high winds or seismic activity
- Treated engineered wood strand substrate

Also available in fiber substrate.

- Not rated for structural use
- Treated engineered wood fiber substrate



Cedar texture

### 38 Series Cedar Texture Panel 8" o.c. (strand)

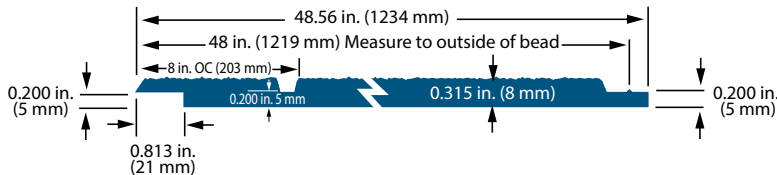

### 38 Series Cedar Texture Panel - No Groove (strand)

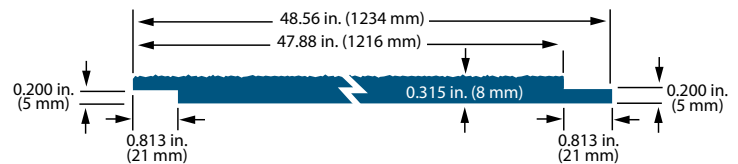

### 76 Series Cedar Texture Panel 4" & 8" o.c. (strand)

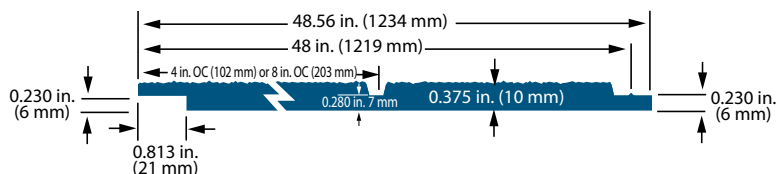

### 76 Series Cedar Texture Panel - No Groove (strand)

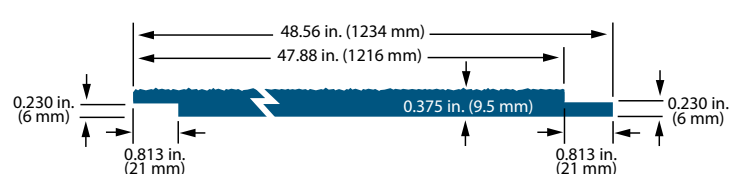

### 190 Series Cedar Texture Panel 8" o.c. (strand)

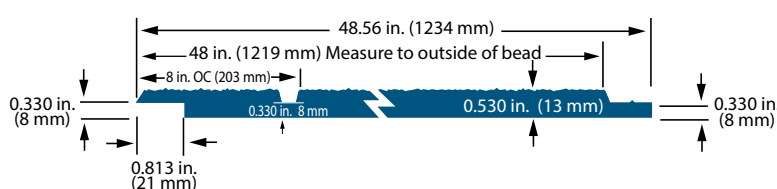

### 190 Series Cedar Texture Panel - No Groove (strand)

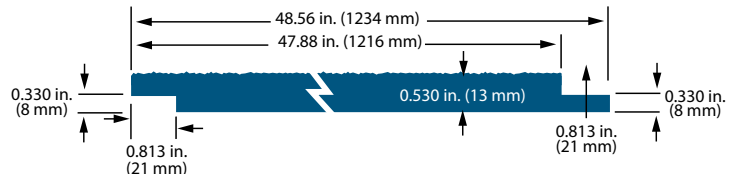

### 76 Series Cedar Texture Panel 8" o.c. (fiber)

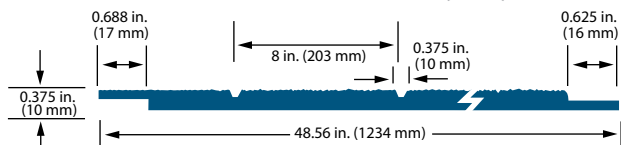

### 76 Series Cedar Texture Panel - Square Edge (fiber)

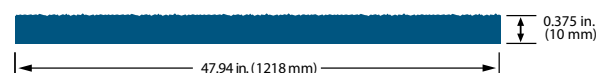



DESCRIPTION	LENGTH	GROOVE	GROOVE WIDTH	ACTUAL WIDTH	MINIMUM THICKNESS	PID NUMBER
38 Series Cedar Texture Panel 8" o.c. (strand)	6 ft. (72 in.)(1829 mm)	8 in. o.c.	3/8 in. (10 mm)	48.56 in. (1234 mm)	0.315 in. (8 mm)	278 05
	7 ft. (84 in.)(2134 mm)	8 in. o.c.	3/8 in. (10 mm)	48.56 in. (1234 mm)	0.315 in. (8 mm)	278 06
	8 ft. (96 in.)(2438 mm)	8 in. o.c.	3/8 in. (10 mm)	48.56 in. (1234 mm)	0.315 in. (8 mm)	258 40
	9 ft. (108 in.)(2743 mm)	8 in. o.c.	3/8 in. (10 mm)	48.56 in. (1234 mm)	0.315 in. (8 mm)	258 43
	10 ft. (120 in.)(3048 mm)	8 in. o.c.	3/8 in. (10 mm)	48.56 in. (1234 mm)	0.315 in. (8 mm)	258 44
38 Series Cedar Texture Panel – No Groove (strand)	8 ft. (96 in.)(2438 mm)	No Groove	N/A	48.56 in. (1234 mm)	0.315 in. (8 mm)	258 55
76 Series Cedar Texture Panel 4" and 8" o.c. (strand)	8 ft. (96 in.)(2438 mm)	4 in. o.c.	3/8 in. (10 mm)	48.56 in. (1234 mm)	0.375 in. (10 mm)	258 31
	9 ft. (108 in.)(2743 mm)	4 in. o.c.	3/8 in. (10 mm)	48.56 in. (1234 mm)	0.375 in. (10 mm)	258 32
	10 ft. (120 in.)(3048 mm)	4 in. o.c.	3/8 in. (10 mm)	48.56 in. (1234 mm)	0.375 in. (10 mm)	258 33
	8 ft. (96 in.)(2438 mm)	8 in. o.c.	3/8 in. (10 mm)	48.56 in. (1234 mm)	0.375 in. (10 mm)	258 48
	9 ft. (108 in.)(2743 mm)	8 in. o.c.	3/8 in. (10 mm)	48.56 in. (1234 mm)	0.375 in. (10 mm)	258 50
	10 ft. (120 in.)(3048 mm)	8 in. o.c.	3/8 in. (10 mm)	48.56 in. (1234 mm)	0.375 in. (10 mm)	258 51
76 Series Cedar Texture Panel – No Groove (strand)	8 ft. (96 in.)(2438 mm)	No Groove	N/A	48.56 in. (1234 mm)	0.375 in. (10 mm)	258 56
	9 ft. (108 in.)(2743 mm)	No Groove	N/A	48.56 in. (1234 mm)	0.375 in. (10 mm)	258 57
	10 ft. (120 in.)(3048 mm)	No Groove	N/A	48.56 in. (1234 mm)	0.375 in. (10 mm)	258 58
190 Series Cedar Texture Panel 8" o.c. (strand)	8 ft. (96 in.)(2438 mm)	8 in. o.c.	3/8 in. (10 mm)	48.56 in. (1234 mm)	0.530 in. (13 mm)	258 52
	9 ft. (108 in.)(2743 mm)	8 in. o.c.	3/8 in. (10 mm)	48.56 in. (1234 mm)	0.530 in. (13 mm)	258 53
	10 ft. (120 in.)(3048 mm)	8 in. o.c.	3/8 in. (10 mm)	48.56 in. (1234 mm)	0.530 in. (13 mm)	258 54
190 Series Cedar Texture Panel – No Groove (strand)	8 ft. (96 in.)(2438 mm)	No Groove	N/A	48.56 in. (1234 mm)	0.530 in. (13 mm)	258 59 *
	9 ft. (108 in.)(2743 mm)	No Groove	N/A	48.56 in. (1234 mm)	0.530 in. (13 mm)	258 60 *
	10 ft. (120 in.)(3048 mm)	No Groove	N/A	48.56 in. (1234 mm)	0.530 in. (13 mm)	258 61 *
76 Series Cedar Siding and Soffit Texture Panel 8" o.c. (fiber)	8 ft. (96 in.)(2438 mm)	8 in. o.c.	3/8 in. (10 mm)	48.56 in. (1234 mm)	0.375 in. (10 mm)	259 34
	9 ft. (108 in.)(2743 mm)	8 in. o.c.	3/8 in. (10 mm)	48.56 in. (1234 mm)	0.375 in. (10 mm)	259 35
76 Series Cedar Texture Siding Panel and Soffit - Square Edge (fiber)	8 ft. (96 in.)(2438 mm)	No Groove	N/A	47.94 in. (1218 mm)	0.375 in. (10 mm)	259 26

### Groove Detail

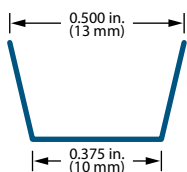

\*Special order item. Requires minimum quantity and extended lead times.  
Metric units are rounded to the nearest millimeter.



# Stucco Texture Panel

## The Rich Look Of Stucco Made Easier

- The remarkably detailed soft, earthy, hand-troweled effect of stucco on a panel
- Deeply textured and varied from board to board
- Comes in easy-to-install shiplap edge panels
- Available pre-primed
- Not rated for structural use
- Treated engineered wood fiber substrate



Stucco Texture

### Stucco Texture Panel (fiber)

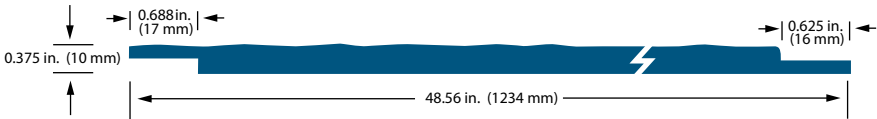

DESCRIPTION	LENGTH	ACTUAL WIDTH	MINIMUM THICKNESS	PID NUMBER
Stucco Texture Panel (fiber)	8 ft. (96 in.)(2438 mm)	48.56 in. (1234 mm)	0.375 in. (10 mm)	25912
	9 ft. (108 in.)(2743 mm)	48.56 in. (1234 mm)	0.375 in. (10 mm)	25913



# Smooth Finish Panel

## Designed For Ease And Performance

- The shiplap edge makes it easier to install
- Pre-primed for exceptional paint adhesion
- Not rated for structural use
- Smooth finish
- Treated engineered wood fiber substrate



### 76 Series Smooth Finish Panel 8" o.c. (fiber)

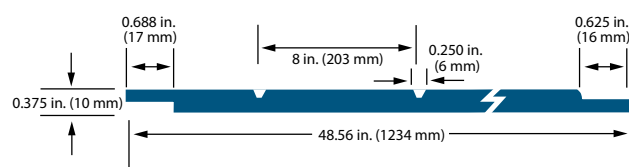

### Groove Detail

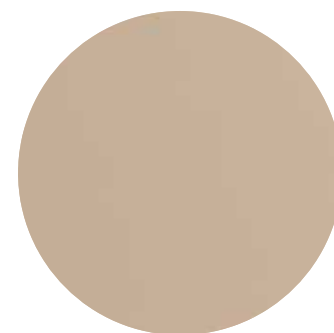
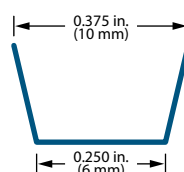

Smooth finish

### 76 Series Smooth Finish Siding Panel and Soffit - Square Edge (fiber)

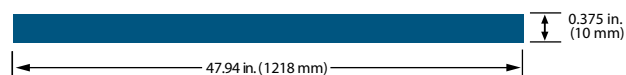

DESCRIPTION	LENGTH	GROOVE	GROOVE WIDTH	ACTUAL WIDTH	MINIMUM THICKNESS	PID NUMBER
76 Series Smooth Finish Panel 8" o.c. (fiber)	8 ft. (96 in.)(2438 mm)	8 in. o.c.	1/4 in. (6 mm)	48.56 in. (1234 mm)	0.375 in. (10 mm)	25932
76 Series Smooth Finish Panel 8" o.c. (fiber) with slip sheets	8 ft. (96 in.)(2438 mm)	8 in. o.c.	1/4 in. (6 mm)	48.56 in. (1234 mm)	0.375 in. (10 mm)	39051
76 Series Smooth Finish Siding Panel and Soffit - Square Edge (fiber)	8 ft. (96 in.)(2438 mm)	No Groove	N/A	47.94 in. (1218 mm)	0.375 in. (10 mm)	25930
	9 ft. (108 in.)(2743 mm)	No Groove	N/A	47.94 in. (1218 mm)	0.375 in. (10 mm)	25931



# Reverse Board & Batten



## The Resilient Spirit Of Historic Architecture

- Rustic and cross-sawn texture, this panel features the weathered grain appearance of cedar
- Available in 8' and 9' lengths
- Shiplap edges make it easier to level and apply
- Pre-primed for exceptional paint adhesion
- Not rated for structural use
- Treated engineered wood fiber substrate



Cedar texture

### Reverse Board and Batten Cedar Texture Panel 12" o.c. (fiber)

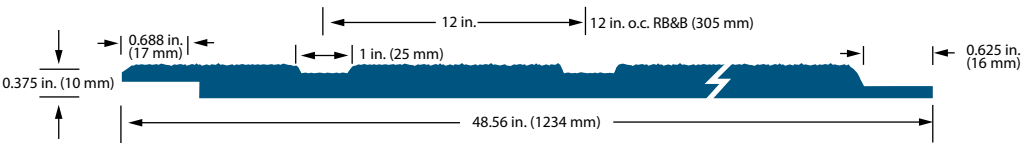

DESCRIPTION	LENGTH	GROOVE	GROOVE WIDTH	ACTUAL WIDTH	MINIMUM THICKNESS	PID NUMBER
Reverse Board and Batten Cedar Texture Panel 12" o.c. (fiber)	8 ft. (96 in.)(2438 mm)	12 in. o.c.	1 in. (25 mm)	48.56 in. (1234 mm)	0.375 in. (10 mm)	25915
	9 ft. (108 in.)(2743 mm)	12 in. o.c.	1 in. (25 mm)	48.56 in. (1234 mm)	0.375 in. (10 mm)	25917



# Cedar Texture Trim

## The Classic Appearance Of Cedar

- Interior or exterior use, including corner boards, windows and doors
- Narrow widths save cutting time with no ripped edges to reprime
- Pre-primed for exceptional paint adhesion
- 16' length can result in faster installation and fewer seams
- Treated engineered wood strand substrate



### 190 Series Cedar Texture Trim (strand)

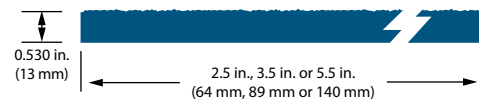

### 440 Series Cedar Texture Trim (strand)

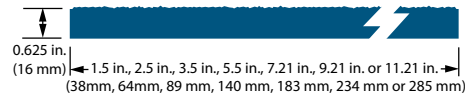

### 540 Series Cedar Texture Trim (strand)

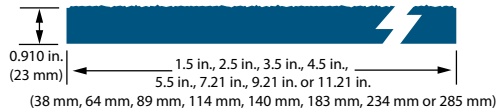

### 440 Series Cedar Texture Ploughed Fascia (strand)

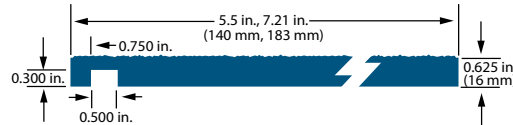

Cedar texture

DESCRIPTION	LENGTH	ACTUAL WIDTH	MINIMUM THICKNESS	PID NUMBER
190 Series Cedar Texture Trim (strand)	16 ft. (192 in.)(4877 mm)	2.50 in. (64 mm)	0.530 in. (13 mm)	28448
	16 ft. (192 in.)(4877 mm)	3.50 in. (89 mm)	0.530 in. (13 mm)	28450
	16 ft. (192 in.)(4877 mm)	5.50 in. (140 mm)	0.530 in. (13 mm)	28452
440 Series Cedar Texture Trim (strand)	16 ft. (192 in.)(4877 mm)	1.50 in. (38 mm)	0.625 in. (16 mm)	25877
	16 ft. (192 in.)(4877 mm)	2.50 in. (64 mm)	0.625 in. (16 mm)	25878
	16 ft. (192 in.)(4877 mm)	3.50 in. (89 mm)	0.625 in. (16 mm)	25880
	16 ft. (192 in.)(4877 mm)	5.50 in. (140 mm)	0.625 in. (16 mm)	25882
	16 ft. (192 in.)(4877 mm)	7.21 in. (183 mm)	0.625 in. (16 mm)	25883
	16 ft. (192 in.)(4877 mm)	9.21 in. (234 mm)	0.625 in. (16 mm)	25884
	16 ft. (192 in.)(4877 mm)	11.21 in. (285 mm)	0.625 in. (16 mm)	25885
540 Series Cedar Texture Trim (strand)	16 ft. (192 in.)(4877 mm)	1.50 in. (38 mm)	0.910 in.(23 mm)	25886
	16 ft. (192 in.)(4877 mm)	2.50 in. (64 mm)	0.910 in.(23 mm)	25887
	16 ft. (192 in.)(4877 mm)	3.50 in. (89 mm)	0.910 in.(23 mm)	25888
	16 ft. (192 in.)(4877 mm)	4.50 in. (114 mm)	0.910 in.(23 mm)	25889 *
	16 ft. (192 in.)(4877 mm)	5.50 in. (140 mm)	0.910 in.(23 mm)	25890
	16 ft. (192 in.)(4877 mm)	7.21 in. (183 mm)	0.910 in.(23 mm)	25891
	16 ft. (192 in.)(4877 mm)	9.21 in. (234 mm)	0.910 in.(23 mm)	25892
440 Series Cedar Texture Ploughed Fascia (strand)	16 ft. (192 in.)(4877 mm)	5.50 in. (140 mm)	0.625 in. (16 mm)	27240
	16 ft. (192 in.)(4877 mm)	7.21 in. (183 mm)	0.625 in. (16 mm)	27819



# Reversible Trim

## Two Great Looks In One

- The natural look of cedar on one side and smooth on the other
- Interior or exterior use, including corner boards, windows and doors
- Pre-primed for exceptional paint adhesion
- 16' length can result in faster installation and fewer seams
- Treated engineered wood fiber substrate
- Reversible trim has a 1/8" bevel cut on its cedar texture side, and is square cut on the smooth finish side.



### 440 Series Reversible Trim (fiber)

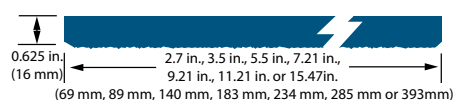

### 540 Series Reversible Trim (fiber)

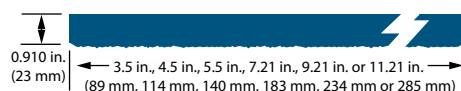

DESCRIPTION	LENGTH	ACTUAL WIDTH	MINIMUM THICKNESS	PID NUMBER
440 Series Reversible Trim (fiber)	16 ft. (192 in.)(4877 mm)	2.70 in. (69 mm)	0.625 in. (16 mm)	25940 *
	16 ft. (192 in.)(4877 mm)	3.50 in. (89 mm)	0.625 in. (16 mm)	25941
	16 ft. (192 in.)(4877 mm)	5.50 in. (140 mm)	0.625 in. (16 mm)	25942
	16 ft. (192 in.)(4877 mm)	7.21 in. (183 mm)	0.625 in. (16 mm)	25943
	16 ft. (192 in.)(4877 mm)	9.21 in. (234 mm)	0.625 in. (16 mm)	25944
	16 ft. (192 in.)(4877 mm)	11.21 in. (285 mm)	0.625 in. (16 mm)	25945
	16 ft. (192 in.)(4877 mm)	15.47 in. (393 mm)	0.625 in. (16 mm)	38445
540 Series Reversible Trim (fiber)	16 ft. (192 in.)(4877 mm)	3.50 in. (89 mm)	0.910 in. (23 mm)	25946
	16 ft. (192 in.)(4877 mm)	4.50 in. (114 mm)	0.910 in. (23 mm)	25947
	16 ft. (192 in.)(4877 mm)	5.50 in. (140 mm)	0.910 in. (23 mm)	25948
	16 ft. (192 in.)(4877 mm)	7.21 in. (183 mm)	0.910 in. (23 mm)	25949
	16 ft. (192 in.)(4877 mm)	9.21 in. (234 mm)	0.910 in. (23 mm)	25950
	16 ft. (192 in.)(4877 mm)	11.21 in. (285 mm)	0.910 in. (23 mm)	25951

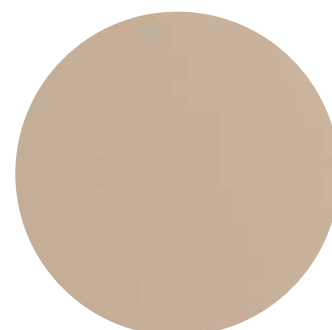

Smooth finish



Cedar texture



# Cedar Texture Soffit

## The Finishing Touch

- The perfect alternative to MDO and plywood soffits
- Cut-to-width eliminates time spent ripping full sheets
- 38 Series engineered for closed soffit applications
- The 76 Series and 190 Series are ideal for use as the starter course for roofs with exposed eaves
- Treated engineered wood strand substrate

Also available in fiber substrate.

- Not rated for exposed eave applications
- Engineered for closed soffit applications
- Treated engineered wood substrate



Cedar texture

### 38 Series 4'x8' Cedar Texture Soffit (strand)

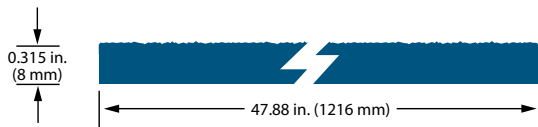

### 38 Series Cedar Texture Soffit – Cut-to-Width (strand)

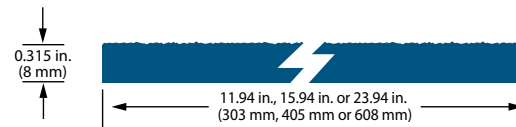

### 76 Series 4'x8' Cedar Texture Soffit (strand)

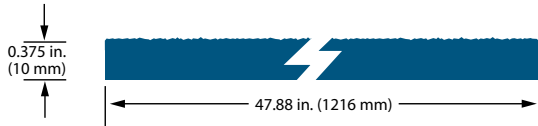

### 76 Series Cedar Texture Soffit – Cut-to-Width (strand)

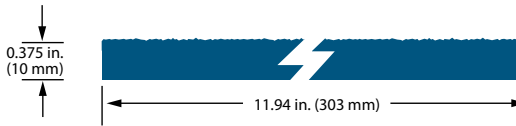

### 190 Series 4'x8' Cedar Texture Soffit (strand)

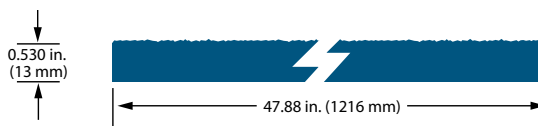

### 76 Series Cedar Texture Soffit (fiber)

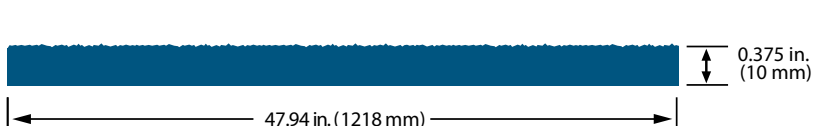

DESCRIPTION	LENGTH	ACTUAL WIDTH	MINIMUM THICKNESS	PID NUMBER
38 Series 4'x8' Cedar Texture Soffit (strand)	8 ft. (96 in.)(2438 mm)	47.88 in. (1216 mm)	0.315 in. (8 mm)	25813
76 Series 4'x8' Cedar Texture Soffit (strand)	8 ft. (96 in.)(2438 mm)	47.88 in. (1216 mm)	0.375 in. (10 mm)	25814
190 Series 4'x8' Cedar Texture Soffit (strand)	8 ft. (96 in.)(2438 mm)	47.88 in. (1216 mm)	0.530 in. (13 mm)	25816
38 Series Cedar Texture Soffit – Cut-to-Width (strand)	16 ft. (192 in.)(4877 mm)	11.94 in. (303 mm)	0.315 in. (8 mm)	25805
	16 ft. (192 in.)(4877 mm)	15.94 in. (405 mm)	0.315 in. (8 mm)	25806
	16 ft. (192 in.)(4877 mm)	23.94 in. (608 mm)	0.315 in. (8 mm)	25807
76 Series Cedar Texture Soffit – Cut-to-Width (strand)	16 ft. (192 in.)(4876 mm)	11.94 in. (303 mm)	0.375 in. (10 mm)	25808
76 Series Cedar Texture Soffit and Siding Panel (fiber)	8 ft. (96 in.)(2438 mm)	47.94 in. (1218 mm)	0.375 in. (10 mm)	25926
	9 ft. (108 in.)(2743 mm)	47.94 in. (1218 mm)	0.375 in. (10 mm)	25927
76 Series Cedar Texture Soffit - Cut-to-Width (fiber)	16 ft. (192 in.)(4877 mm)	15.94 in. (405 mm)	0.375 in. (10 mm)	28756



# Vented Soffit

## Engineered To Cut Out Problems

- The perfect alternative to MDO, plywood or hand-installed metal vents
- Precisely cut vents offer 10 square inches of ventilation per linear foot, making it easier to meet code requirements while adding architectural beauty
- Designed to minimize paint build-up and promote continuous airflow
- Vents are as small as International Building Codes allow (1/8"), to keep hornets and bees out
- Eliminates time spent ripping full sheets
- Treated engineered wood strand substrate



Cedar texture

### 38 Series Vented Cedar Texture Soffit – Cut-to-Width (strand)

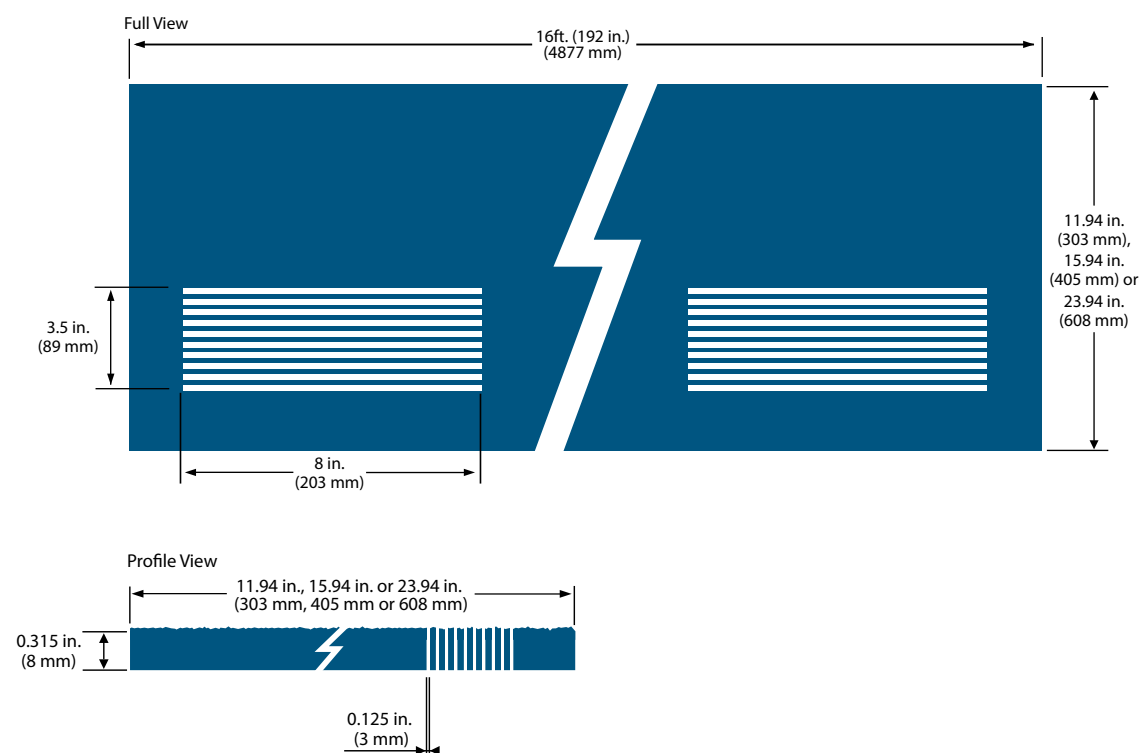

DESCRIPTION	LENGTH	ACTUAL WIDTH	MINIMUM THICKNESS	PID NUMBER
38 Series Vented Cedar Texture Soffit – Cut-to-Width (strand)	16 ft. (192 in.)(4877 mm)	11.94 in. (303 mm)	0.315 in. (8 mm)	25822
	16 ft. (192 in.)(4877 mm)	15.94 in. (405 mm)	0.315 in. (8 mm)	25823
	16 ft. (192 in.)(4877 mm)	23.94 in. (608 mm)	0.315 in. (8 mm)	25824



# Smooth Finish Soffit

## The Perfect Match

- Installs quickly and easily
- Pre-primed for exceptional paint adhesion
- Smooth finish
- Treated engineered wood fiber substrate



Smooth finish

### 76 Series Smooth Finish Soffit (fiber)

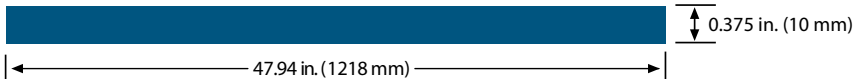

DESCRIPTION	LENGTH	ACTUAL WIDTH	MINIMUM THICKNESS	PID NUMBER
76 Series Smooth Finish Soffit and Siding Panel (fiber)	8 ft. (96 in.)(2438 mm)	47.94 in. (1218 mm)	0.375 in. (10 mm)	25930
	9 ft. (108 in.)(2743 mm)	47.94 in. (1218 mm)	0.375 in. (10 mm)	25931
76 Series Smooth Finish Soffit and Siding Panel (fiber) with slip sheet	8 ft. (96 in.)(2438 mm)	47.94 in. (1218 mm)	0.375 in. (10 mm)	39052
	9 ft. (108 in.)(2743 mm)	47.94 in. (1218 mm)	0.375 in. (10 mm)	39050