



CHARLOTTE HISTORIC DISTRICT COMMISSION

CERTIFICATE OF APPROPRIATENESS

CERTIFICATE NUMBER: 2016-216

DATE: September 19, 2016

ADDRESS OF PROPERTY: 621 Woodruff Place

TAX PARCEL NUMBER: 07102107

HISTORIC DISTRICT: Wesley Heights

OWNER(S): Anthony Perez

DETAILS OF APPROVED PROJECT: The project is a master landscaping plan that includes the replanting of three trees. Two oak trees will be 3" in caliper upon installation or a size that is recommended by the City of Charlotte arborist. Site features include a pergola, shrubs. Fencing, lighting and other landscape features as noted on the site plan.

The project was approved by the HDC September 14, 2016.

- This Certificate of Appropriateness (COA) indicates that this project proposal has been determined to comply with the standards and policies of the Charlotte Historic District Commission.
- Display the blue COA placard in a visible location along with any required permits.
- No other approvals are to be inferred.
- No demolition other than that specifically indicated on any attached plans is authorized under this approval.
- All work must be completed in accordance with all other applicable state and local codes.
- Any changes from or additions or deletions to the plans referenced herein will void this Certificate, and a new application must be filed with the Historic District Commission.

This Certificate is valid for a period of twelve (12) months from the date of issuance. Failure to obtain a building permit in that time will be considered as a failure to comply with the Certificate and the Certificate will become invalid. If a building permit is not required, then the approved work must be completed within twelve (12) months of the date of issuance of this Certificate. In either situation, the Certificate can be renewed for an additional twelve (12) months by Historic District Commission staff by written request within the first twelve (12) months from the date of issuance.

Chairman

Staff

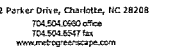

Project Notes

Perez Residence
Address
621 Woodruff Place, Charlotte, NC

scale

$$1'' = 4'$$

Job Number

designer

Janet Bean

Client

Perez
Residence

ate

Completed:4-14-16

Revised: 6-13-16

Revised: 6-22-16

Revised: 7-20-16

Revised: 8-16-16

Jan Type

Master Plan

Page Number

1

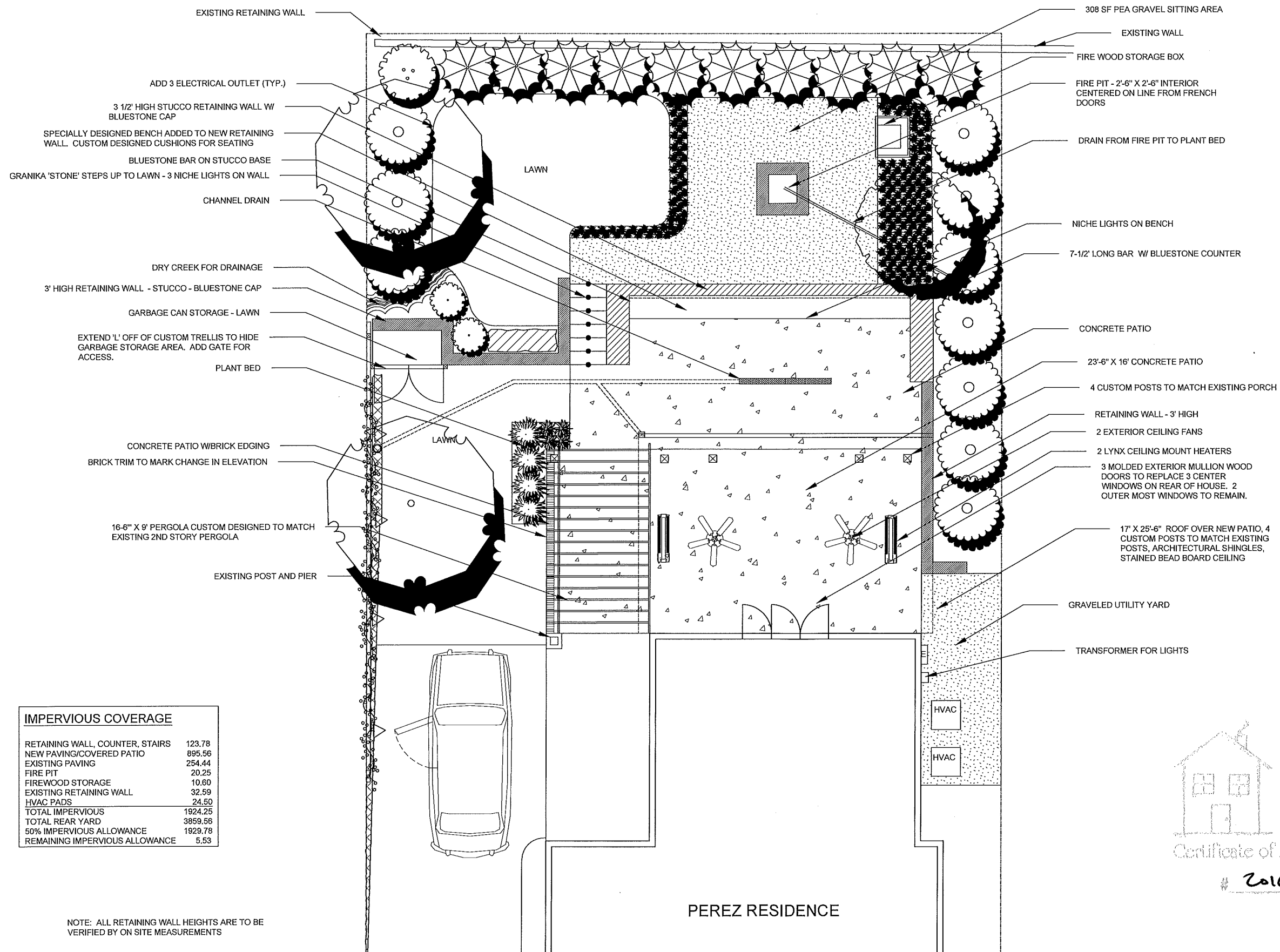

PEREZ RESIDENCE

APPROVED

Charlotte
Historic District
Commission

Certificate of Appropriateness

2016-216



622 Parker Drive, Charlotte, NC 28208
704.504.6980 office
704.504.4547 fax
www.metrogreenscape.com

Project Notes

Perez Residence	Address	621 Woodruff Place, Charlotte, NC

Scale
1" = 4'

Job Number

Designer
Janet Bean

Client

Perez Residence

Date
Completed: 4-14-16
Revised: 6-13-16
Revised: 6-22-16
Revised: 7-20-16
Revised: 8-16-16

Plan Type

Lighting Plan

Page Number

L-6

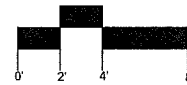

4 SCALE

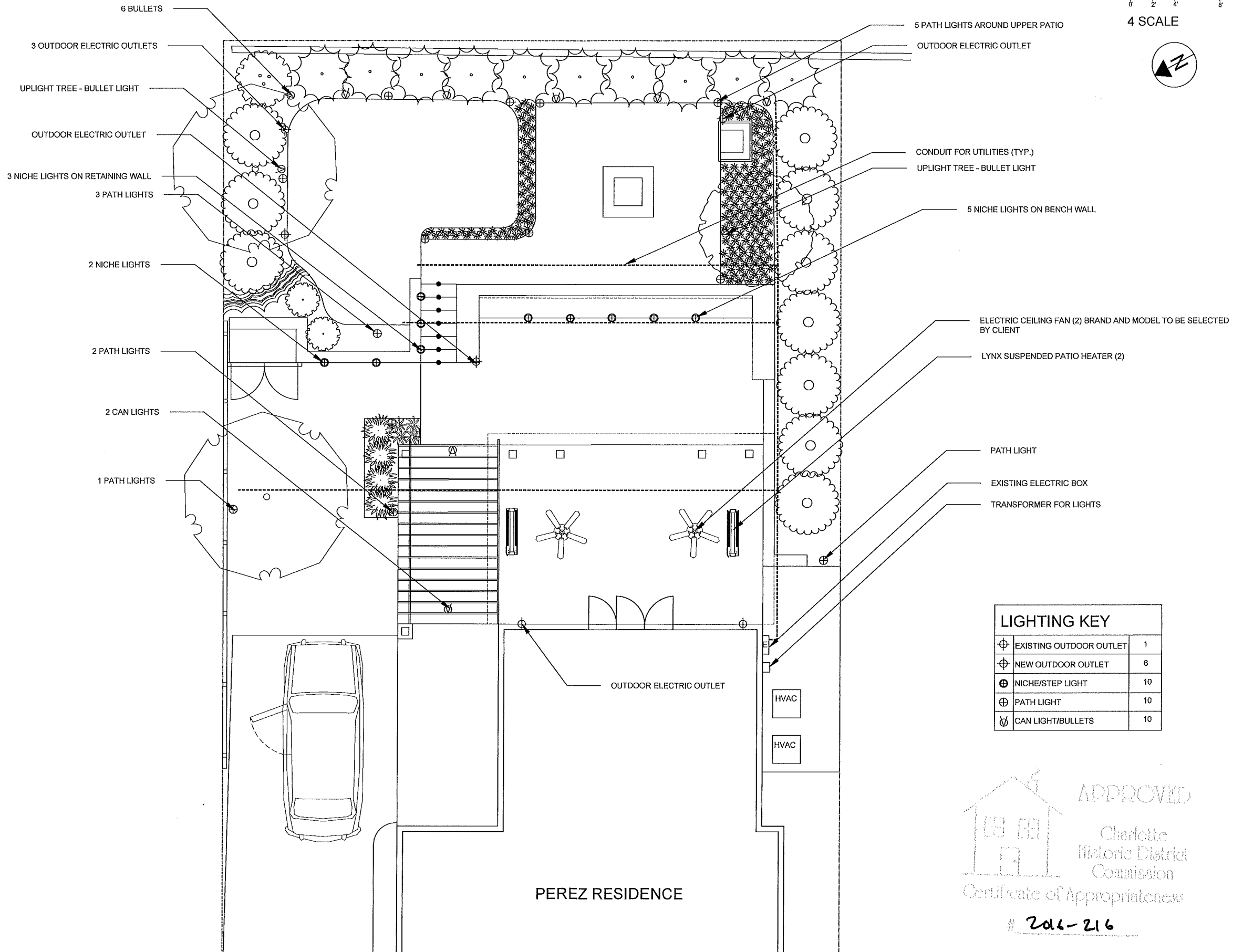

APPROVED
Charlotte
Historic District
Commission
Certificate of Appropriateness
2016-216

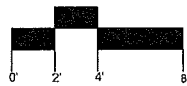

4 SCALE



1 AUTUMN SPIRIT CAMELLIA

1 NUTTALL OAK

3 CHINDO VIBURNUM

2 FROST PROOF GARDENIA

6 GROSSO LAVENDER

4 CORAL REEF DIANTHUS

4 CAROLINA JASMINE

4 DENIM 'N LACE RUSSIAN SAGE

1 WILLOW OAK

1 TRAY VINCA

55 DWARF MONDO GRASS

LAWN

LAWN

LAWN

1 TRAY VINCA MINOR SPREAD THROUGHOUT BEDS

10 DEGROOT'S ARBOVITAE

7 TEA OLIVE

130 DWARF MONDO GRASS

1 KWANZAN CHERRY TREE

HVAC

HVAC

LAWN

PEREZ RESIDENCE

PLANT SCHEDULE

Key	Qty	Latin Name	Common Name
Shade Trees:			
1	1	Quercus nuttallii	Nuttall Oak
1	1	Quercus phellos	Willow Oak
Ornamental Trees:			
1	1	Prunus serotina 'Kwanzan'	Kwanzan Cherry
Shrubs:			
1	1	Camellia x 'Autumn Spirit'	Autumn Spirit Camellia
2	2	Gardenia jasminoides 'Frostproof'	Frostproof Gardenia
7	7	Osmorhiza fragrans	Fragrant Tea Olive
10	10	Thuja occidentalis 'Degroot's Spire'	Degroot's Spire Arborvitae
3	3	Viburnum awabaki 'Chindo'	Chindo Viburnum
Perennials and Bulbs:			
6	6	Lavandula x intermedia 'Grosso'	Grosso Lavender
11	11	Ophiopogon japonicus 'Nana' (18 per flat)	Dwarf Mondo Grass
2	2	Vinca minor 'Bowles' (18 per flat)	Bowles Periwinkle
Vines:			
4	4	Gelsemium sempervirens	Carolina Jasmine

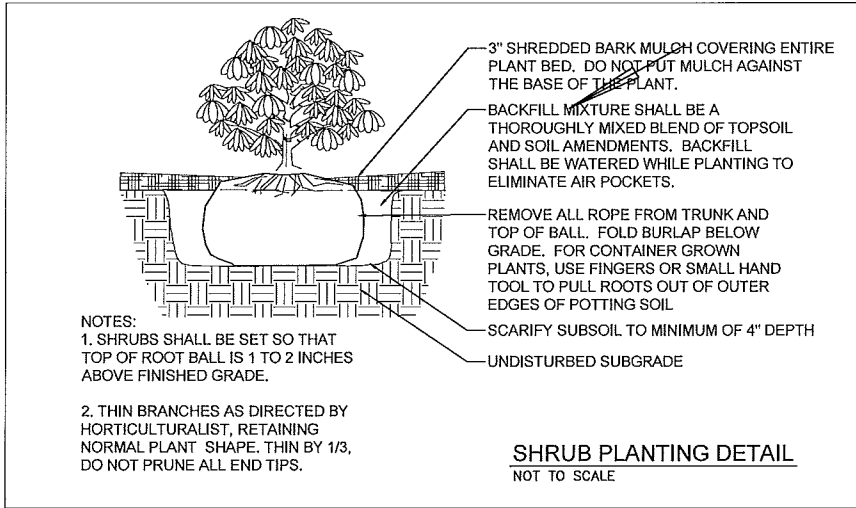
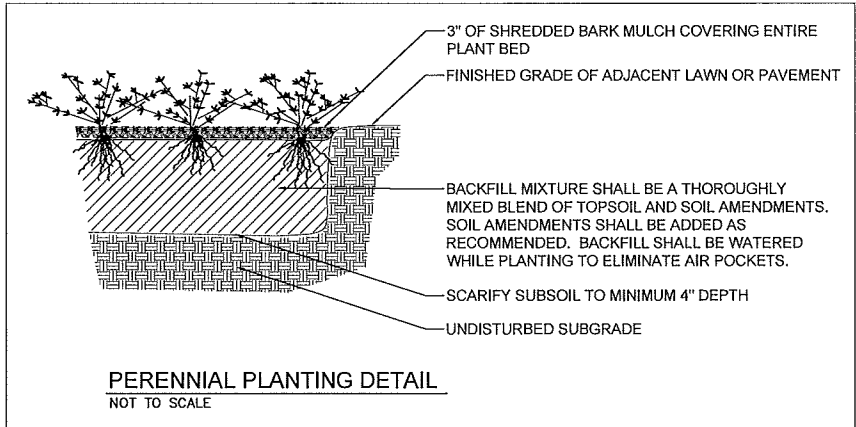

- PLANTING NOTES:
- ALL PLANT MATERIAL SHALL COMPLY WITH THE RECOMMENDATIONS AND REQUIREMENTS OF ANSI Z60.1 "AMERICAN STANDARDS FOR NURSERY STOCK" LATEST REVISION.
 - ALL PLANTS AND ENTIRE SHRUB BEDS TO RECEIVE 3" LAYER OF DOUBLE SHREDDED HARDWOOD BARK MULCH. MULCH SHOULD NOT TOUCH STEMS OR TRUNKS OF PLANTS. MULCH ALL EVERGREEN TREES TO WITHIN 6" OF BRANCH ENDS.
 - TOPSOIL AND SEED ALL DISTURBED AREAS AS A RESULT OF ANY AND ALL CONSTRUCTION OR STORAGE OF EQUIPMENT, WHETHER AREAS ARE SHOWN AS LAWN OR NOT. AREAS NOT DIRECTLY RELATED TO DEVELOPMENT WILL BE RETAINED IN THEIR NATURAL STATE.
 - TOPSOIL FOR PLANT BEDS SHALL BE IMPROVED BY MIXING AS FOLLOWS: (3:2:1 MIXTURE)
50% APPROVED SCREENED SANDY LOAM TOPSOIL
33% COARSE CONCRETE SAND
17% SCREENED COMPOST
 - PROVIDE THIS IMPROVED TOPSOIL MIXTURE TO DEPTHS AS FOLLOWS:
6" IN GROUND COVER AREAS
12" IN SHRUB AND PERENNIAL BED AREAS
2'-6" DEPTH TO WIDTH OF TREE PIT AS SHOWN ON DETAIL
 - PROVIDE AND SPREAD APPROVED SANDY LOAM TOPSOIL TO 6" DEPTH IN LAWN AREAS. ROTOTILL IMPROVED TOPSOIL MIXTURE INTO TOP 6" FOR LAWN AREAS AND INTO TOP 18" FOR SHRUB AND PERENNIALS BED AREAS. ROOTBALLS OF PLANTS SHALL BE SET 1" TO 2" ABOVE FINISHED GRADE.
 - CUT AND REMOVE BURLAP FROM TOP AND SIDES OF BALL. REMOVE ALL NYLON AND PLASTIC. REMOVE ALL NON-ROT BURLAP AND CUT OF SIDES OF WIRE BASKETS FROM BALL IF PRESENT.
 - DO NOT STAKE PLANTS UNLESS DIRECTED TO DO SO BY FOREMAN.



622 Parker Drive, Charlotte, NC 28208

704.501.0660 office
704.501.8547 fax
www.metrogreenscape.com

Project Notes

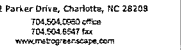

621 Woodruff Place, Charlotte, NC

L-8

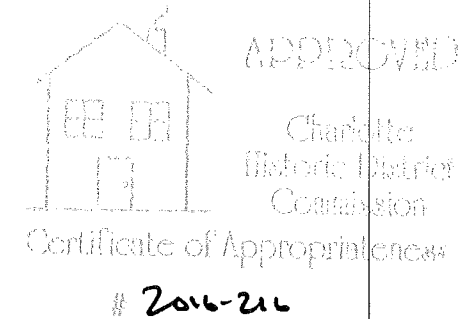

1 CUSTOM TRELLIS
L-8 SCALE: 1" = 1'

- 10 GRAVEL SIDE YARD
L-8 SCALE: 1" = 1'



Address
621 Woodruff Place, Charlotte, NC

-9

APPROVED

Charlotte
Historic District
Commission

Certificate of Appropriateness

2016-216

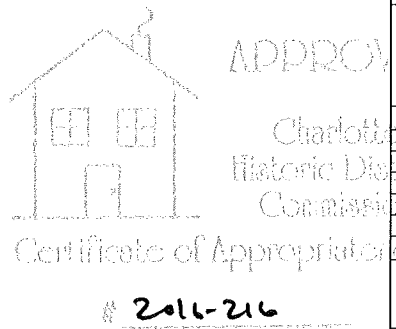
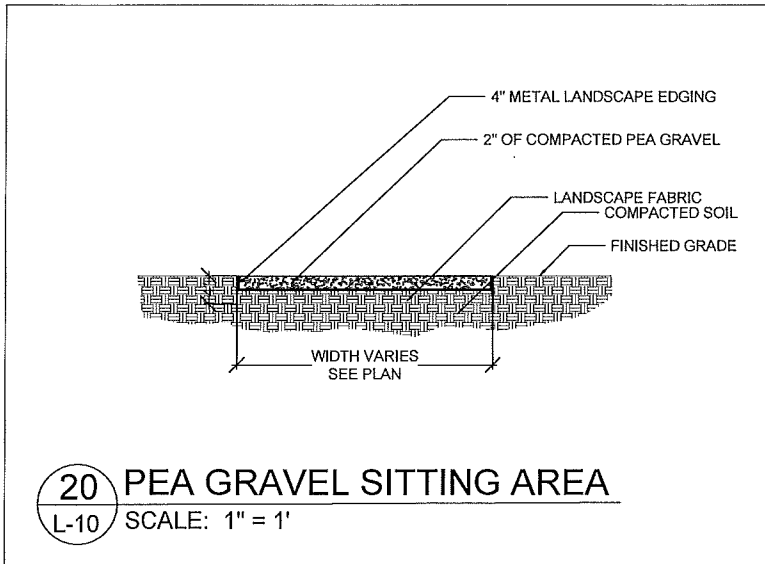
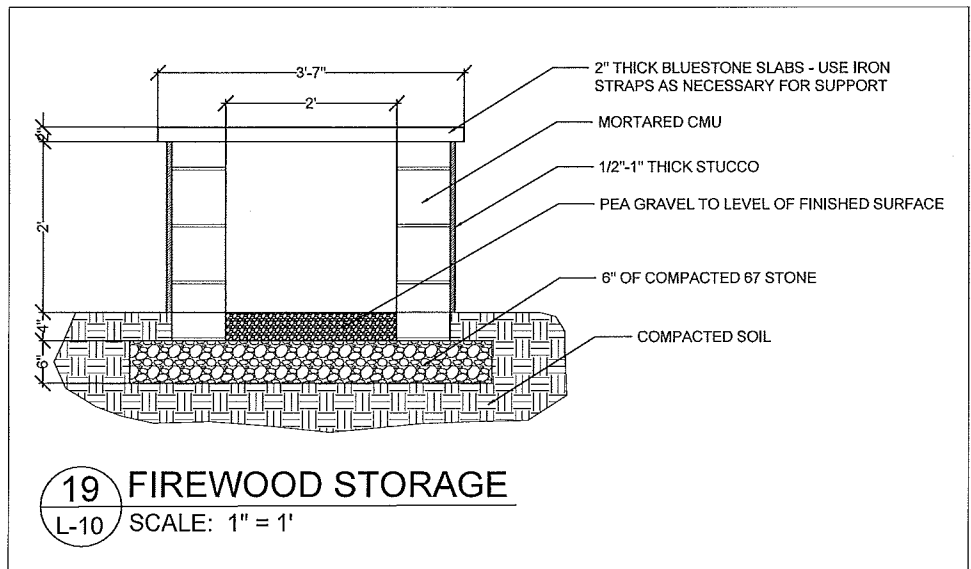
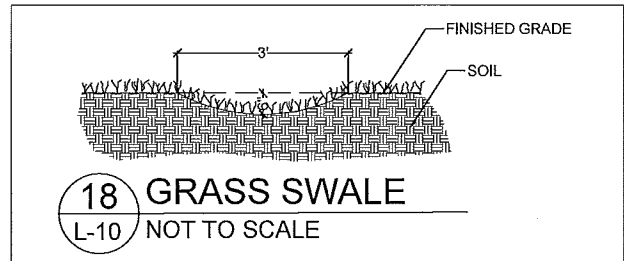
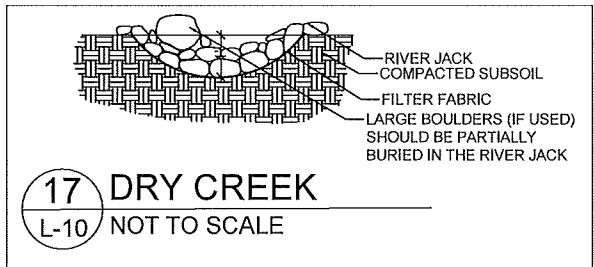
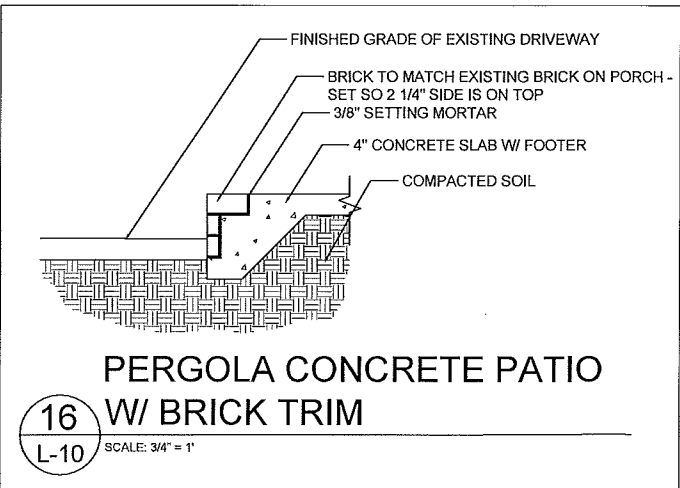
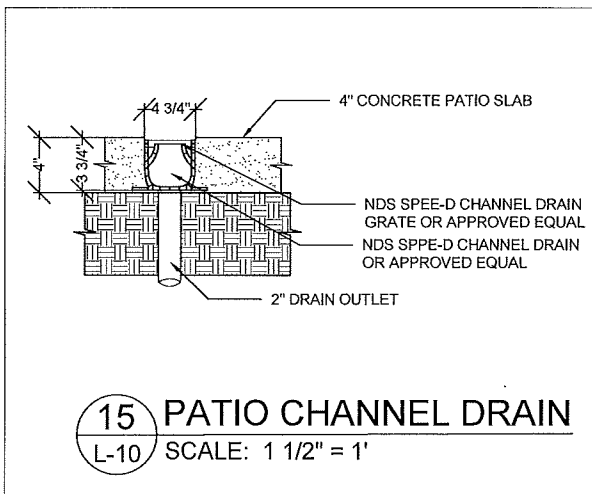
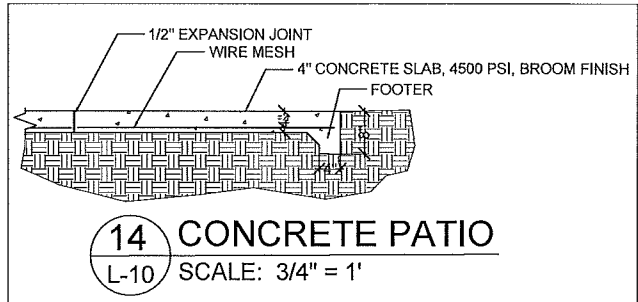
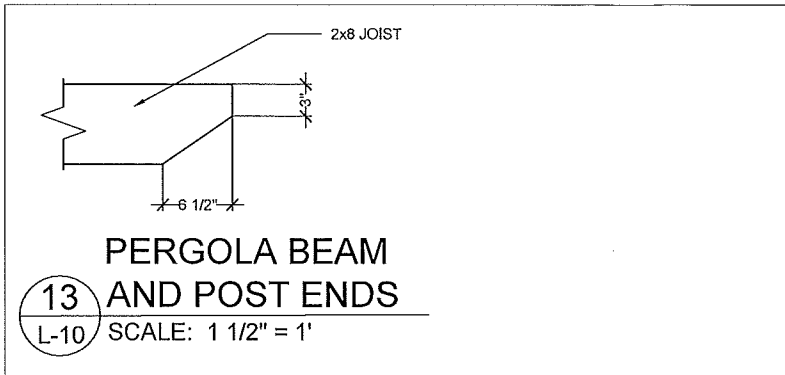
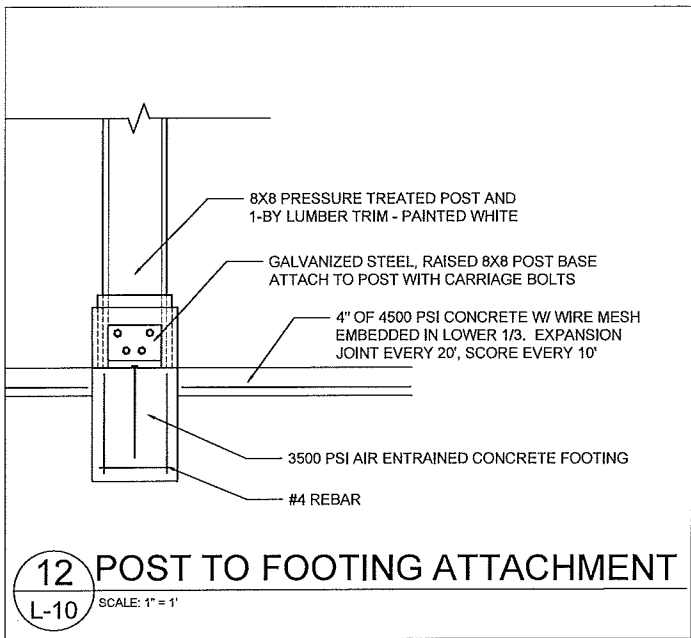
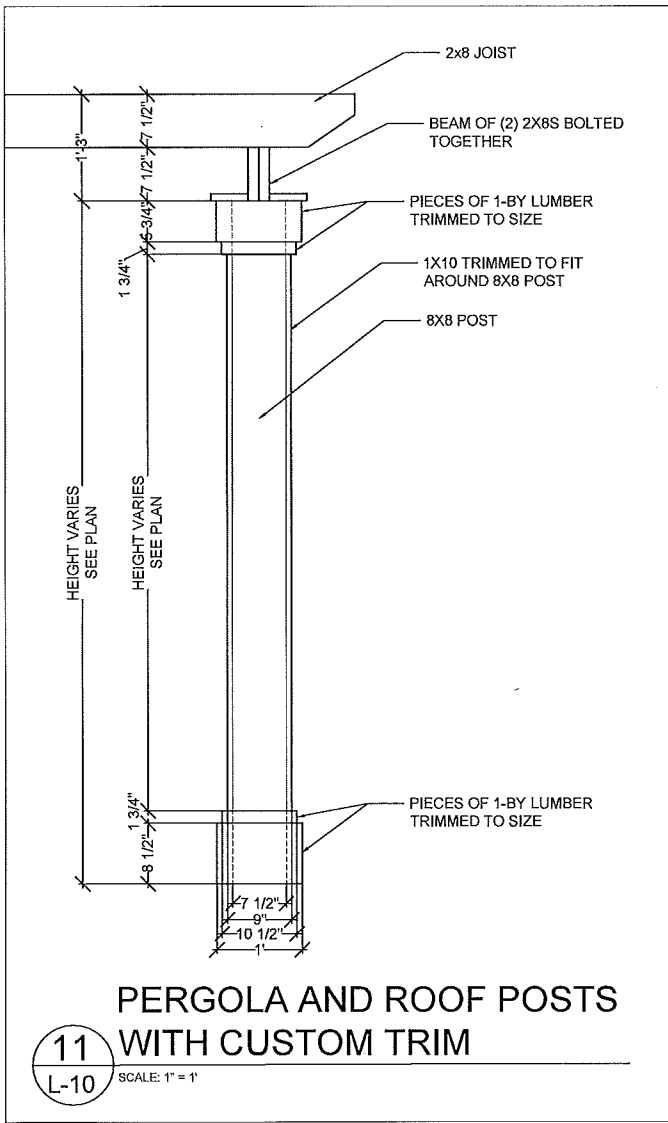

 METROGREENSCAPE everything outdoors	
1622 Parker Drive, Charlotte, NC 28208 704.504.0260 office 704.504.8547 fax www.metrogreenscape.com	
Project Notes	
Perez Residence	621 Woodruff Place, Charlotte, NC
Address	
Scale	
1" = 4'	
Job Number	
Designer	
Janet Bean	
Client	
Perez Residence	
Date	
Completed: 4-14-16	
Revised: 6-13-16	
Revised: 6-22-16	
Revised:	
Revised:	
Plan Type	
Detail Sheet 3	
Page Number	
L-10	



<div><div><div><div><div></div><div>METROGREENSCAPE, INC.</div></div><div><div>1622 Parker Dr., Charlotte, NC 28208</div><div>704.504.0980 office 704.504.8547 fax www.metrogreenscape.com</div></div></div><div>Drawing Disclaimer</div><div><div>Copyright Metrogreenscape, Inc. All Rights Reserved. The Duplication, Reproduction, Copying, Sale, Rental, Lending, or any other distribution or use of these drawings, any portion thereof, or the plans depicted hereon is Strictly Prohibited unless expressly authorized in writing by Metrogreenscape, Inc.</div></div></div></div>	
Client:	Perez Residence
Address:	621 Woodruff Place, Charlotte, NC
Project Notes	
Designed By	
Chris Parris	
Scale	
Job Number	
Client	
Perez Residence	
Date	
Completed:	
Revision:	
Revision:	
Revision:	
Plan Type	
3D Model	
Page Number	
4	

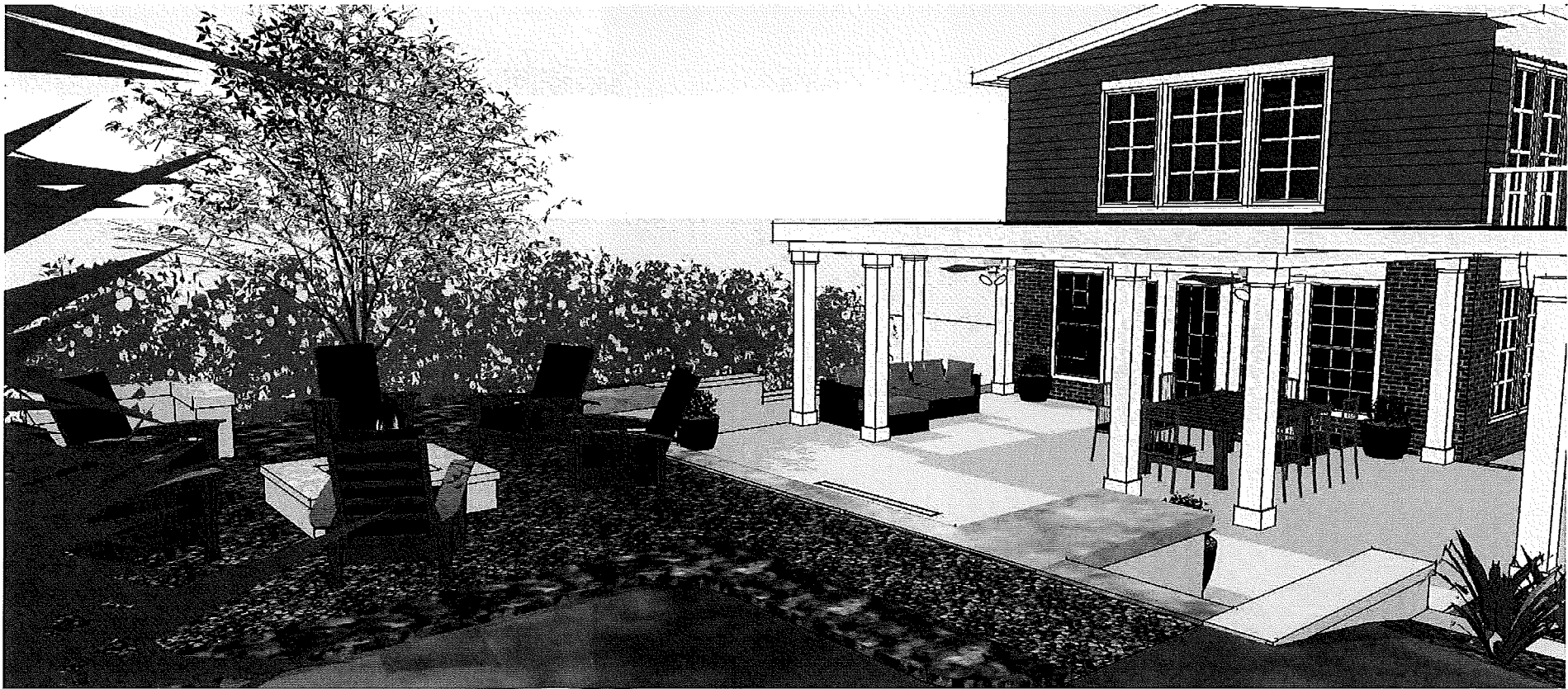
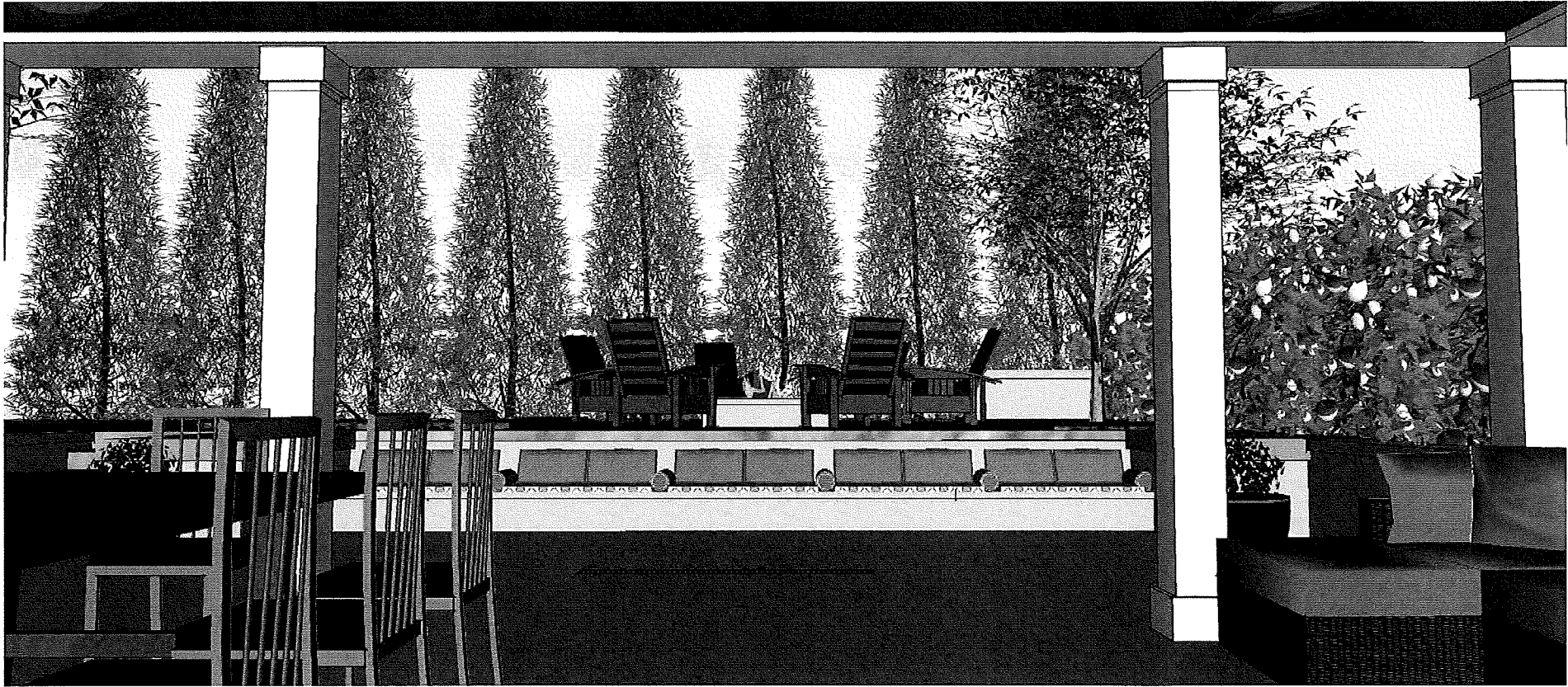

<div><div><div><div><div></div><div></div></div><div><div></div><div></div></div></div><div><div>1622 Parker Dr., Charlotte, NC 28208</div><div>704.504.0880 office 704.504.8547 fax www.metrogreenscape.com</div></div></div></div>	
Drawing Disclaimer	
Copyright Metrogreenscape, Inc. All Rights Reserved. The Duplication, Reproduction, Copying, Sale, Rental, Licensing, or any other distribution or use of these drawings, any portion thereof, or the plans depicted hereon is Strictly Prohibited unless expressly authorized in writing by Metrogreenscape, Inc.	
Client:	Perez Residence
Address:	621 Woodruff Place, Charlotte, NC
Project Notes	
Designed By	
Chris Parris	
Scale	
Job Number	
Client	
Perez Residence	
Date	
Completed:	
Revision:	
Revision:	
Revision:	
Plan Type	
3D Model	
Page Number	
5	

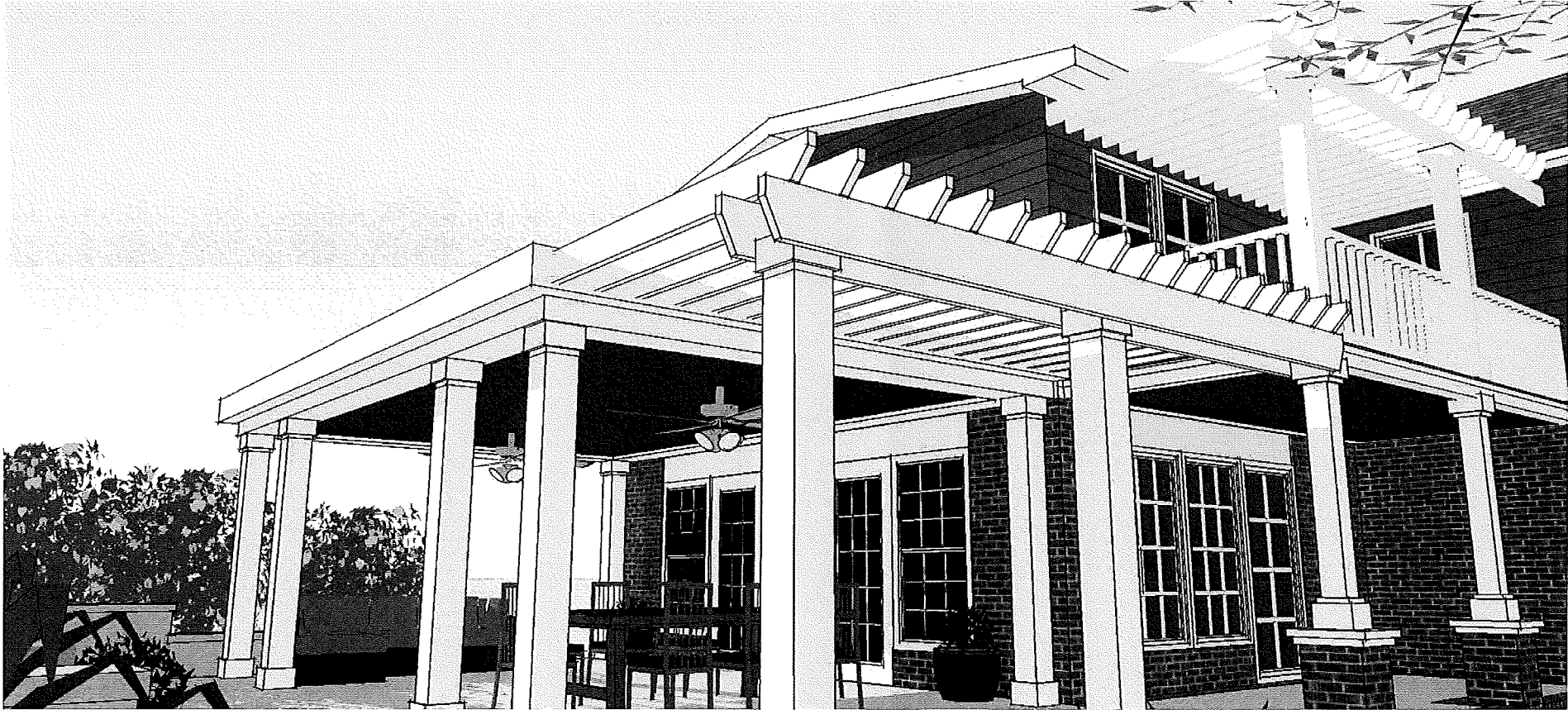

Certificate of Appropriateness

206-216

METROGREENSCAPE, INC.
1622 Parker Dr.,
Charlotte, NC 28208
704.504.0980 office
704.504.8547 fax
www.metrogreenscape.com

Drawing Disclaimer

Copyright Metrogreenscape, Inc. All Rights Reserved. The Duplication, Reproduction, Copying, Sale, Rental, Licensing, or any other distribution or use of these drawings, any portion thereof, or the plans depicted hereon is Strictly Prohibited unless expressly authorized in writing by Metrogreenscape, Inc.

Client: **Perez Residence**
Address: **621 Woodruff Place, Charlotte, NC**

Project Notes

Designed By

Chris Parris

Scale

Job Number

Client

Perez Residence

Date

Completed:

Revision:

Revision:

Revision:

Plan Type

Sample Page

Page Number



- 16'-6" LONG X 9' WIDE PERGOLA OF SPRUCE, PAINTED WHITE.
STYLE TO MATCH EXISTING PERGOLA MATERIALS ON 2ND
STORY PORCH.
- JOISTS OF 2" X 8" SPRUCE LUMBER, PAINTED WHITE
- BEAMS OF (2) 2" X 8" SPRUCE LUMBER BOLTED TOGETHER
AND PAINTED WHITE
- COLUMNS OF PRESSURED TREATED 8" X 8" LUMBER, CLAD IN
1" X 10" SPRUCE LUMBER, PAINTED WHITE. CAPS AND BASES
OF ADDITIONAL 1" X 10" SPRUCE BOARDS, PAINTED WHITE - TO
MATCH EXISTING MATERIALS ON PORCH COLUMNS - SEE
DETAIL 11 ON PAGE L-10
- BRICK EDGING ALONG SOLID POUR CONCRETE SLAB
PROVIDES VISUAL MARKER FOR CHANGE IN ELEVATION (6"
STEP DOWN



Address: 3321 Woodruff Place, Charlotte, NC

Project Notes

Designed By

Chris Parris

Scale

$$1'' = 3'$$

Job Number

Client

Perez
Residence

Date _____

Completed

Revision:

Revision:

Revision:

Plan Type	Plan Description	Plan Number	Plan Date	Plan Status
1	1	1	1	1
2	2	2	2	2
3	3	3	3	3
4	4	4	4	4
5	5	5	5	5
6	6	6	6	6
7	7	7	7	7
8	8	8	8	8
9	9	9	9	9
10	10	10	10	10
11	11	11	11	11
12	12	12	12	12
13	13	13	13	13
14	14	14	14	14
15	15	15	15	15
16	16	16	16	16
17	17	17	17	17
18	18	18	18	18
19	19	19	19	19
20	20	20	20	20
21	21	21	21	21
22	22	22	22	22
23	23	23	23	23
24	24	24	24	24
25	25	25	25	25
26	26	26	26	26
27	27	27	27	27
28	28	28	28	28
29	29	29	29	29
30	30	30	30	30
31	31	31	31	31
32	32	32	32	32
33	33	33	33	33
34	34	34	34	34
35	35	35	35	35
36	36	36	36	36
37	37	37	37	37
38	38	38	38	38
39	39	39	39	39
40	40	40	40	40
41	41	41	41	41
42	42	42	42	42
43	43	43	43	43
44	44	44	44	44
45	45	45	45	45
46	46	46	46	46
47	47	47	47	47
48	48	48	48	48
49	49	49	49	49
50	50	50	50	50
51	51	51	51	51
52	52	52	52	52
53	53	53	53	53
54	54	54	54	54
55	55	55	55	55
56	56	56	56	56
57	57	57	57	57
58	58	58	58	58
59	59	59	59	59
60	60	60	60	60
61	61	61	61	61
62	62	62	62	62
63	63	63	63	63
64	64	64	64	64
65	65	65	65	65
66	66	66	66	66
67	67	67	67	67
68	68	68	68	68
69	69	69	69	69
70	70	70	70	70
71	71	71	71	71
72	72	72	72	72
73	73	73	73	73
74	74	74	74	74
75	75	75	75	75
76	76	76	76	76
77	77	77	77	77
78	78	78	78	78
79	79	79	79	79
80	80	80	80	80
81	81	81	81	81
82	82	82	82	82
83	83	83	83	83
84	84	84	84	84
85	85	85	85	85
86	86	86	86	86
87	87	87	87	

Elevations

Page Number

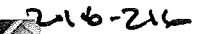
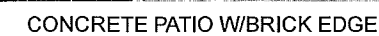
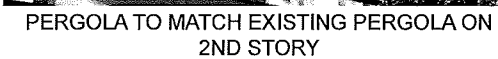
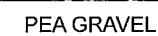
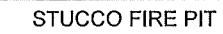
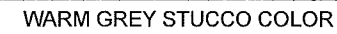
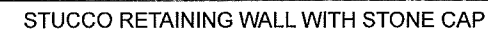
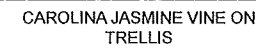
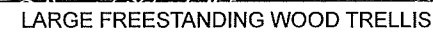

8