



CHARLOTTE HISTORIC DISTRICT COMMISSION
CERTIFICATE OF APPROPRIATENESS

CERTIFICATE NUMBER: HDC 2015.177

DATE: 23 September 2015

ADDRESS OF PROPERTY: 601 Mt. Vernon Avenue

HISTORIC DISTRICT: Dilworth

TAX PARCEL NUMBER: 123.056.01

OWNER(S): Keith and Amanda Anderson APPLICANT: Steve Sebrell of DPS Construction

DETAILS OF APPROVED PROJECT: Fence. Wooden fence will enclose rear yard. Where a retaining wall exists along the City sidewalk, the new fence will step in, allowing a planting strip between the top of the wall and the fence. Panels of pickets will be butt joined to uprights (creating a visible pattern) and framed off along the top. Inset 10' iron gate creates access from side street. See exhibit labeled 'Fence Design September 2015' and Fence Location September 2015. Height will not exceed six feet but the finials may extend higher than the fence itself. Fence will be stained or painted.

Applicable *Policy & Design Guidelines* Fences page 56.

5. Wooden fences must be painted or stained.

6. No fencing may be over six feet in height, as measured from the outside at grade.

10. On corner lots on residential streets, privacy fences in rear yards must be screened with appropriate landscaping materials.

- This Certificate of Appropriateness (COA) indicates that this project proposal has been determined to comply with the standards and policies of the Charlotte Historic District Commission.
- Display the blue COA placard in a visible location along with any required permits.
- No other approvals are to be inferred.
- No demolition other than that specifically indicated on any attached plans is authorized under this approval.
- All work must be completed in accordance with all other applicable state and local codes.
- Any changes from or additions or deletions to the plans referenced herein will void this Certificate, and a new application must be filed with the Historic District Commission.

This Certificate is valid for a period of six months from the date of issuance. Failure to obtain a building permit in that time will be considered as a failure to comply with the Certificate and the Certificate will become invalid. If a building permit is not required, then the approved work must be completed within six months of the date of issuance of this Certificate. The Certificate can be renewed within twelve months of its issuance by Historic District Commission staff by written request and submission of a valid reason for failure to comply within the six-month

Chairman, Tom Egan

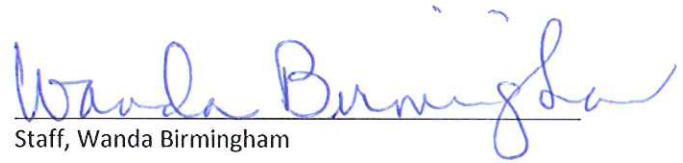
Staff, Wanda Birmingham

TOWN & COUNTRY FENCE

108 Manley Street, Charlotte, NC 28216 • 704-394-2925 • FAX 704-394-5736

CONTRACT

Date 6-28-15

Work by AMANDA ANDERSON

Name DPS Construction

P.O. No. _____
Attn: Steve Sebrell

Address 1230 Bellins Ave.

Home Phone _____

City Charl State NC Zip 28205

Work Phone _____

Job Site 601 Mt. Vernon Ave Charl, NC 28203

Cell Phone 704 644 9817

Fax Phone _____

WOOD SPECIFICATIONS

Steve@dpscharlotte.com

HEIGHT <input type="checkbox"/> 3 <input type="checkbox"/> 4 <input type="checkbox"/> 5 <input checked="" type="checkbox"/> 6 <input type="checkbox"/> _____	TYPE <input checked="" type="checkbox"/> PTP <input type="checkbox"/> _____ <input type="checkbox"/> _____ <input type="checkbox"/> _____	STYLE <input checked="" type="checkbox"/> Privacy <input type="checkbox"/> Semi-Privacy <input type="checkbox"/> Shadowbox <input type="checkbox"/> Picket <input type="checkbox"/> _____	BOARD SIZE <input type="checkbox"/> 5/8 x 4 <input type="checkbox"/> 5/8 x 6 <input checked="" type="checkbox"/> 3/4 x 6 <input type="checkbox"/> _____ <input type="checkbox"/> _____	RAIL SIZE <input checked="" type="checkbox"/> 2 x 4 <input type="checkbox"/> 2 x 6 <input type="checkbox"/> _____ <input type="checkbox"/> _____	PICKET TOP <input type="checkbox"/> Dogear <input type="checkbox"/> French Gothic <input type="checkbox"/> Gothic <input checked="" type="checkbox"/> FIAT	SPACING <input type="checkbox"/> Standard <input type="checkbox"/> Custom <input type="checkbox"/> <u>N/A</u>
POST DESIGN <input type="checkbox"/> Dogear <input type="checkbox"/> Flat <input type="checkbox"/> Gothic <input type="checkbox"/> _____	INSTALL <input type="checkbox"/> Good Side In <input checked="" type="checkbox"/> Good Side Out	GATE SWING <input type="checkbox"/> In <input checked="" type="checkbox"/> Out	SPECIAL INSTRUCTIONS Option: FOR AN In-Line Install with # New England Caps Add 1600 TO Price Below.		CROSS STREET _____	TAKE DOWN & HAUL AWAY FOOTAGE <input type="checkbox"/> Yes <input checked="" type="checkbox"/> No

DESCRIPTION

Install 268' of custom
6' tall wood privacy
fences with 6" cap
and 4" facial bds

+
Install 1-10' Aluminum
Estate gate w/ operator

Install Lift Master LA 400
Single Gate operator
1-Photo Beam
2 Remotes
No Electric Included

TERMS: DUE DAY OF COMPLETION
 Cash or Check
 Credit Card: V-Code _____ Exp. _____
 # _____

Lump Sum Total \$ 9552

Less Deposit _____

Balance Due _____

Day of Completion _____

SKETCH

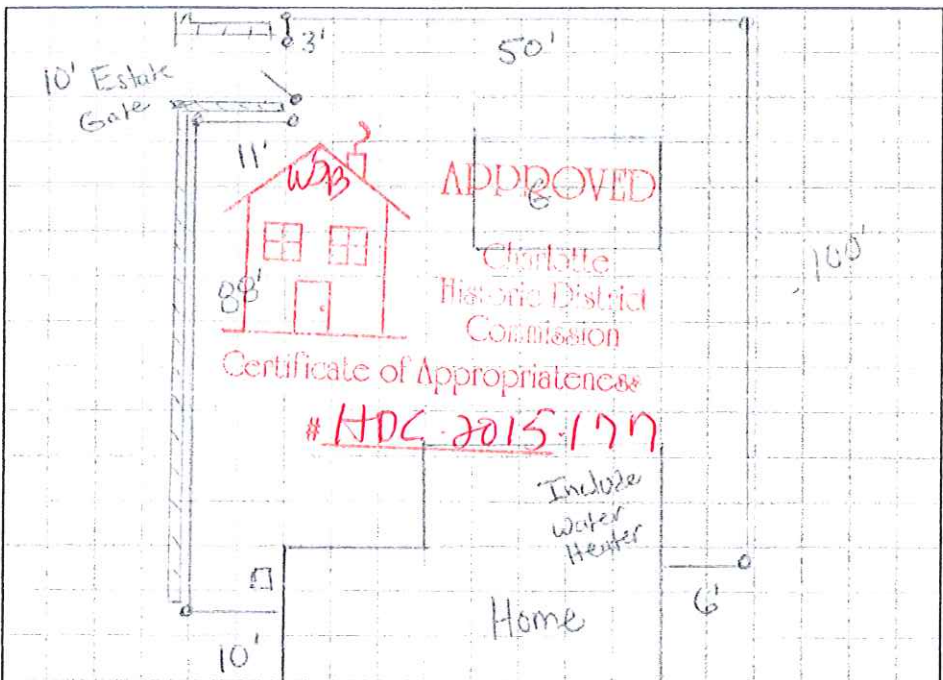

WARRANTY
 ALL PRODUCTS WARRANTED AS PER MANUFACTURER. The Buyer(s) understand and acknowledge that wood fence materials are rough mill cut pieces. Wood fence material(s) has a tendency to shrink and warp in hot, humid weather. Cracks and warpage in wood are a normal and accepted occurrence. THE COMPANY WILL ONLY GUARANTEE THE WORKMANSHIP OF WOOD FENCES AND ALL OTHER INSTALLATIONS FOR ONE YEAR FROM DATE OF SIGNED CONTRACT.

BUYER(S) SIGNATURE(S) ARE REQUIRED **WE ARE NOT LIABLE FOR SPRINKLER HEADS & LINES**

BUYER(S): _____ DATE: _____

BUYER(S): _____ DATE: _____ SALESPERSON Brian Sanford

The provisions on the reverse side of this contract are made part of this contract.

Fence Location September 2015

Birmingham, Wanda

From: Steve Sebrell <steve@dpscharlotte.com>
Sent: Thursday, July 23, 2015 1:38 PM
To: Brian Sanford
Cc: Birmingham, Wanda
Subject: Fwd:
Attachments: Anderson.pdf; ATT00001.htm; Cover Sheet.pdf; ATT00002.htm; ATT00003.htm

Brian,

Can you confirm that the posts in the photo are 4x4 and not 6x6?

Wanda,

See below for the site plan and the fence layout.



Fence Design
September 2015