ADDRESS OF PROPERTY:	<i>400 East Boulevard, Dilworth Local Historic District</i>	<i>HDC 2013-002</i>
SUMMARY OF REQUEST:	<i>Signage</i>	
OWNER:	<i>City of Charlotte – Charlotte Housing Authority</i>	
APPLICANT:	<i>RiteLite Signs, Inc.</i>	

Details of Proposed Request

This application seeks approval of a sign to be installed on an office building at 400 East Boulevard. The proposed sign, as shown on the attached plan, is to be wall mounted over the entrance to this building, and fabricated of illuminated channel letters and logo.

Relevant HDC Design Guidelines

- Signage

Staff Analysis

The proposed sign for this property is an attached wall sign that works out to roughly 27.5 square feet in size.

The sign specifications include letters and a logo design that are channel lit, causing these elements to glow in darker conditions.

This property is zoned O-2.

Current HDC Policy on *Signage* says in part:

1. *Signs should not exceed six feet in height or ten square feet in area.*

The Policy also states:

10. *Signs may be lit with unobtrusive ground-mounted spotlights, or other unobtrusive lighting as the HDC may approve. Signs may not flash, blink, or glow from within.*

The HDC has in the past in certain circumstances allowed exceptions to the signage policy. One of the justifications of such exceptions in the past is the use of an engineered sign space on the building for a sign, and that the proposed sign is also proportional to the building. This appears to staff to be the case in this proposal.

The lighting issue on this proposal would require an exception to policy being granted, but such exceptions have been granted in the past in similar circumstances.



CHA
Tutoring Center

11/26/2012

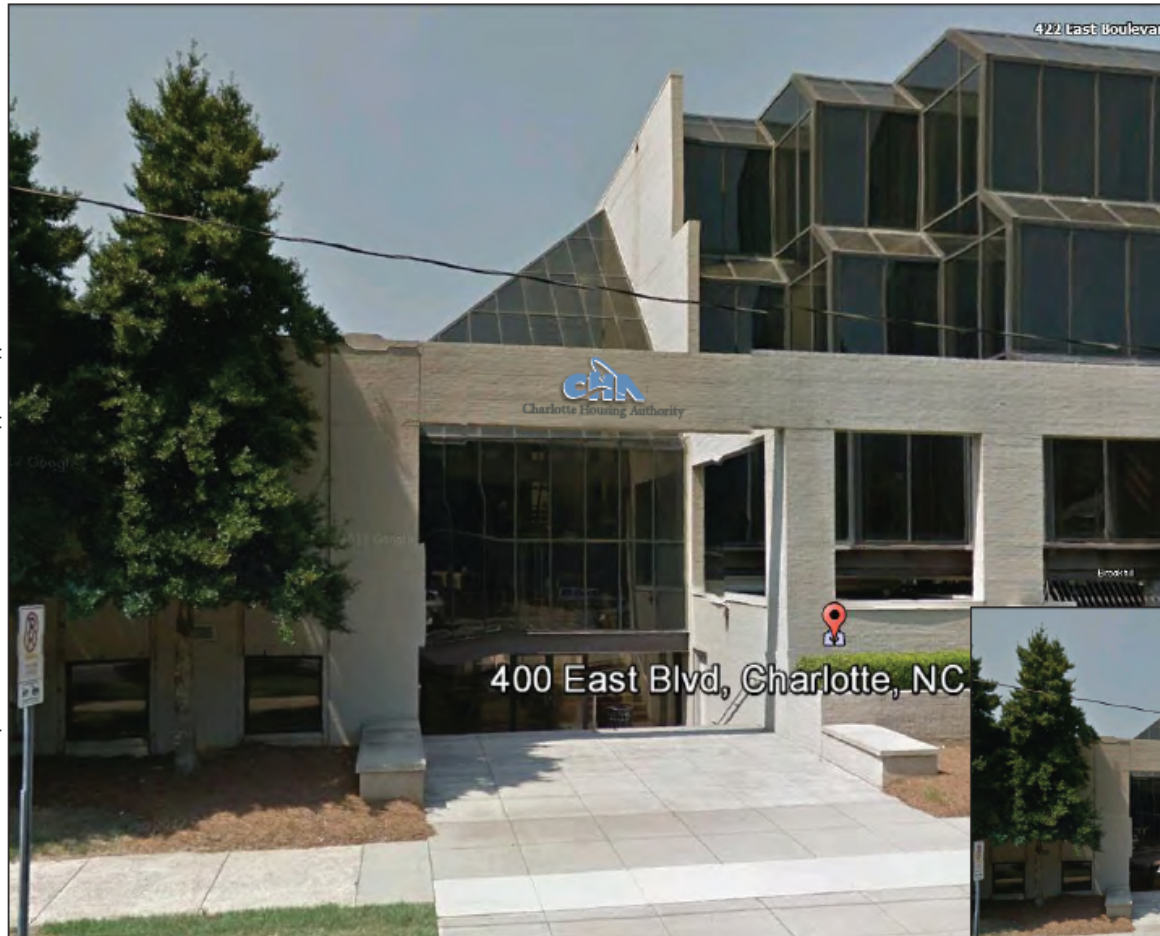
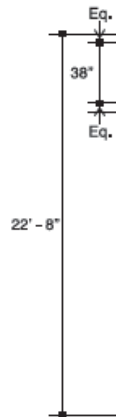
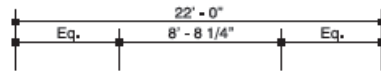

Photographic Rendering
Not to Scale



RITELITE
SIGNS, INC.
1000 Biscayne Drive 704.788.7097
Concord, NC 28027 fax: 704.788.7091

Client:



Job Location: Charlotte, NC

Designer: BCG	Sketchman: JH
Project #: 10449	Date: 29 October 12

Revision Date:

Revision # & File Location:
12,360 abc/c/charlotte housing authority

Customer Approval: _____ Date: _____

Local Lord Approval: _____ Date: _____

Production Approval: _____ Date: _____

This original design is the exclusive property of Rite Lite Signs, Inc. and is protected by federal copyright laws. Any reproduction or construction of a sign similar to the one embodied herein is expressly forbidden. Should such construction occur, Rite Lite Signs, Inc. is due \$500 as compensation for their time & effort in creating each drawing.



Charlotte Historic District Commission - Case 2013-002

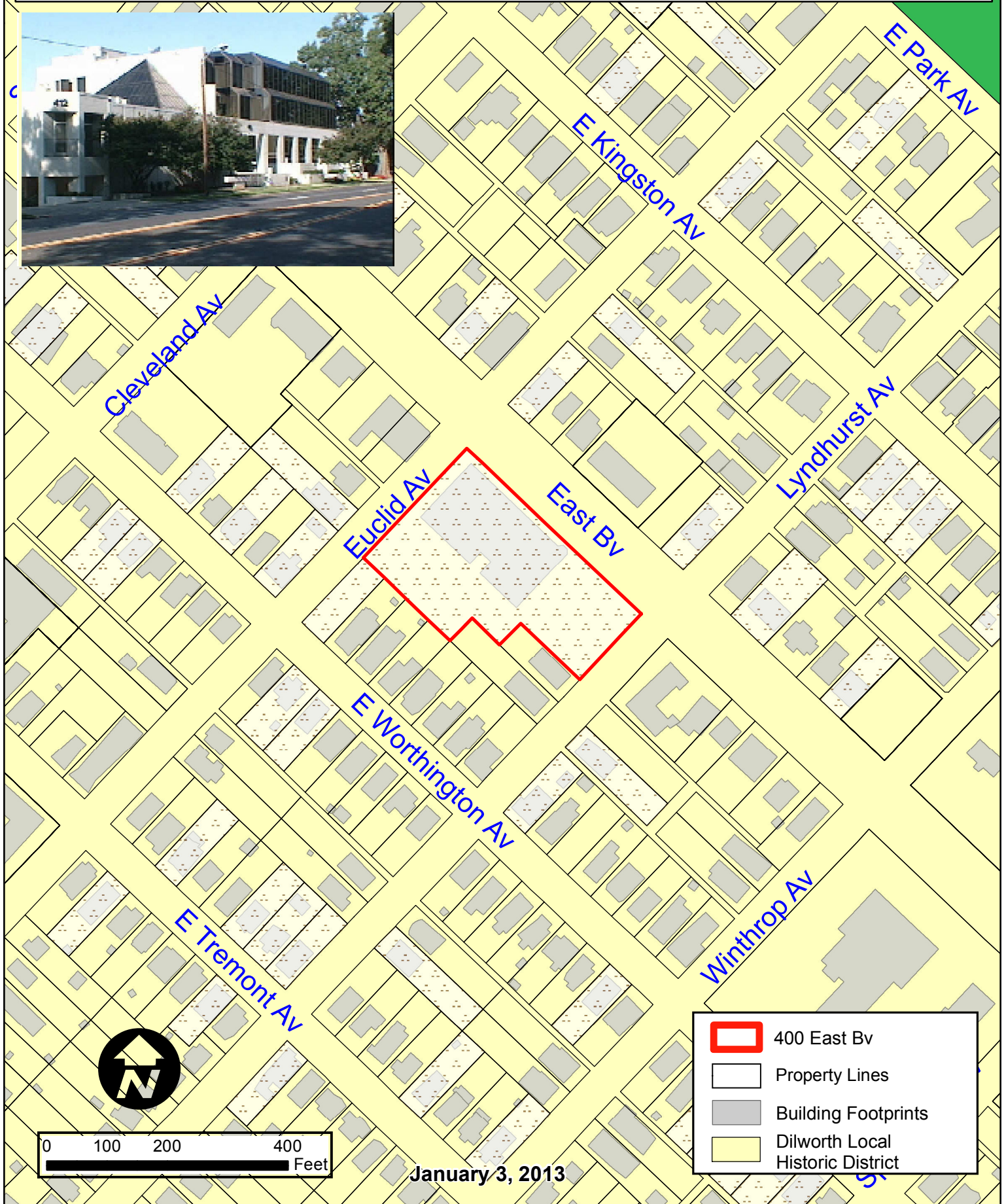

January 3, 2013